

SPORTSTER

Travel Trailer & Fifth Wheel Toy Haulers

2018 Décor



French Roast



Linen

Travel Trailer Toy Haulers

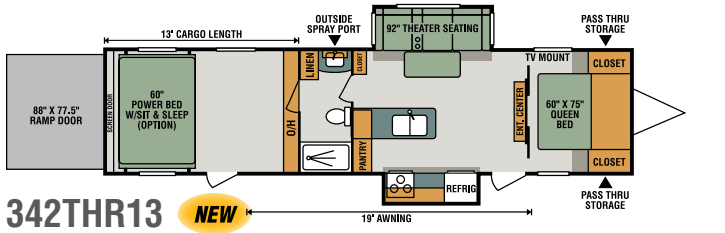
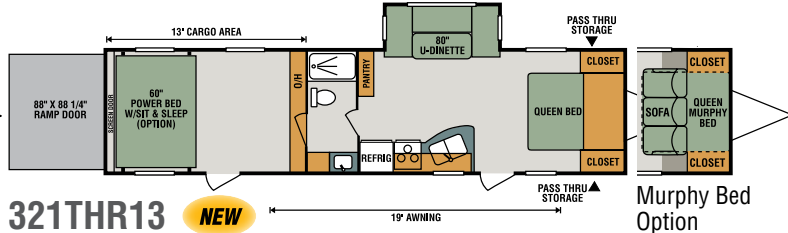
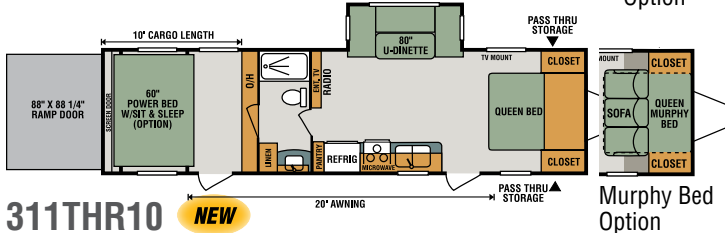
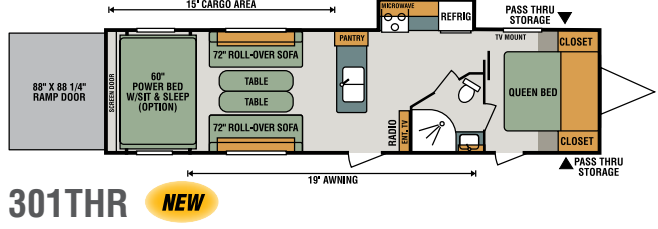
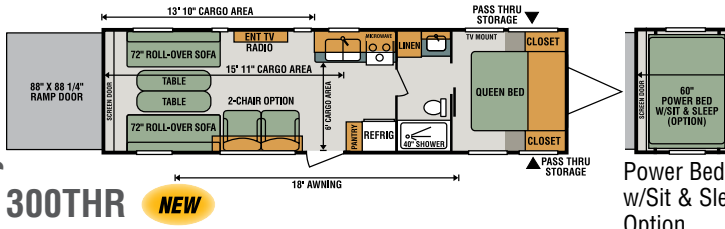

Fifth Wheel Toy Haulers

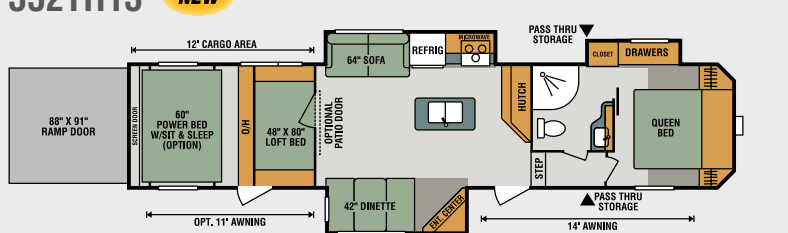
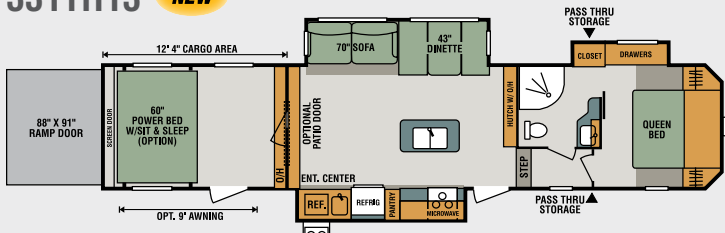
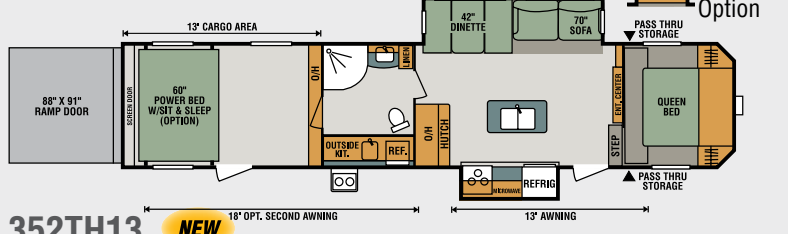
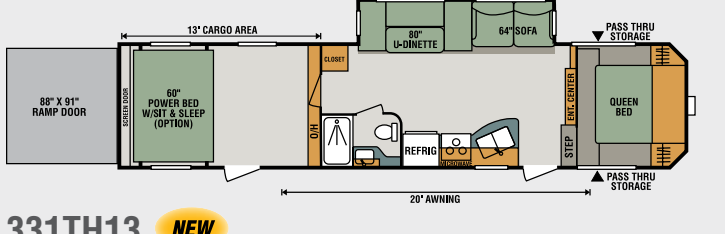
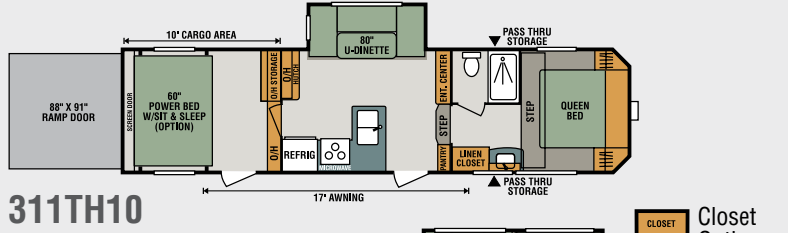
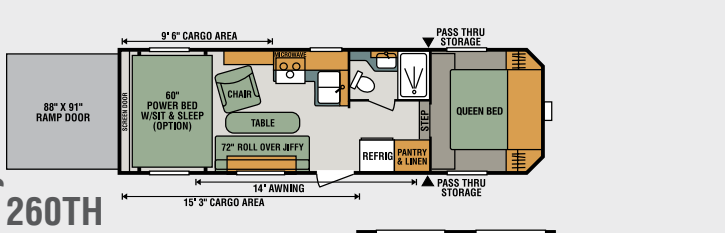

Standards

- 102" Wide Body
- 3/8" Fully Walk-On Roof Decking
- 1-Piece Seamless Roof w/ SuperFlex® Roofing Material
- Radius Truss Rafter
- 90" Interior Walls (TTs)
- Awning w/Drip Rail & Spouts
- Cargo Tie-Down Rings
- Tuff Ply® in Enclosed Cargo Areas
- (2) 20# LP Bottles w/Cover TT
- (2) 30# LP Bottles w/Cover FW
- 30 AMP Service
- 13,500 BTU A/C
- (2) or (4) Stabilizer Jacks (F/P specific)
- Enclosed Pin Box on F/Ws
- Tinted Safety Glass Windows
- Self-Adjust Brakes
- Cable Hookup
- Radius Entry Door
- Extra-Large, Smooth, Screwless Baggage Doors
- Outside Shower (F/P specific)
- LED Light in Pass-Thru Storage
- Winter Bypass Kit
- Linoleum Throughout
- Acrylic Sink w/High-Rise Faucet
- 3-Burner Cooktop
- Range Hood w/12V Light & Exhaust Fan
- Oven
- Microwave w/Turntable
- Large Overhead Cabinets
- Roller Ball Bearing Drawer Guides
- Super-Sized Panoramic Slideroom Window
- LED Interior Lighting
- Monitor Panel
- Digital TV Antenna w/Booster
- Flush-Floor Bedroom (F/Ws)
- Built-In Medicine Cabinet w/Mirror in Bathroom
- Queen Mattress
- Shower Surround
- Power Vent in Bathroom

Options

- Color-Infused Titanium Exterior Fiberglass (TTs)(required on FWs)
- 15,000 BTU A/C IPO 13,500 BTU A/C
- 50 AMP Service w/2nd A/C Prep
- 2nd A/C (13,500 BTU)
- 39" LED TV (N/A 321THR13, 260TH)
- 32" LED TV (321THR13, 260TH)
- Bedroom LED TV w/Inside/Outside Bracket
- Radiant Technology Package (foil in floor/roof/front/rear)
- F/S Dinette Table & Chairs IPO Dinette
- Theater Seating IPO Dinette (311THR, 321THR, 311TH)
- 10 CU FT Residential Refrigerator IPO 8 CU FT Gas/Electric Refrigerator
- Theater Seating IPO Jackknife (331TH, 352TH, 363TH)
- Wardrobe Slide (352TH13)
- Front & Rear Electric Stabilizer Jacks (TTs)
- Electric Rear Stabilizer Jacks (FWs)
- Fireplace (311TH10, 331TH13, 352TH13, 373TH12)
- Central Vacuum (FWs only, N/A 260TH)
- 2nd Power Awning w/LED (352TH, 363TH, 373TH)
- MaxxAir® Vent Fan (cargo and/or living room and/or bath)
- Roof Ladder
- Wireless Backup Camera System – Observation
- Patio Door (363TH12, 373TH12)
- (2) Recliner Chairs (300THR)
- Ramp Extension (N/A w/party patio package)
- Murphy Bed (311THR10, 321THR13)
- Sit-n-Sleep w/Power Bed
- Party Patio Package (railing only)

- Motion Security Sensor for Smart Arm Awning
- Wind Sensor for Smart Arm Awning
- Generator Prep w/30 GAL Fuel Tank & Pump Station
- 4.0 KW Generator (requires generator prep & 30 amp)
- 5.5 KW Generator (requires generator prep & 50 amp) (321THR12, 342THR13 & all FWs)

K-Z Advantage Package

(mandatory option)

Exterior

- Power Awning w/LED Light Strip
- Key-Alike Program for Baggage/Entry Doors
- Friction Hinge Entry Door
- Large Folding Grab Handle
- Black Tank Flush
- Power Front Jacks
- Spare Tire & Carrier
- Exterior Speakers
- Alumitread® Entry Steps
- Amber Step Light
- Solar Prep
- Backup Camera Prep
- EquaFlex® Suspension
- Battery Disconnect
- Toylok®
- Climate Package (heated, enclosed & insulated underbelly)
- Nitrogen-Filled Tires

Interior

- Bed Storage System
- Plywood Bed Base w/Gas Struts
- Seamless Countertop w/Under-Mount Kitchen Sink
- Sink Cover
- Kitchen Skylight
- Storage Bins in Dinette
- Blue LED Strip Light above Main LR Slide
- Jackknife Sofa w/Center Console & Bolster Arms

- (2) 6 1/2" Interior Speakers
- Multi-Media Stereo w/DVD, Bluetooth & NFC Wireless Connectivity
- 12V Dual USB Ports
- Foot-Flush Toilet
- Pleated Shades
- (2) Motion Sensor LED Lights
- Drop-In Cooktop w/Glass Cover
- Pillowtop Mattress
- Retractable Screen Wall
- Diamond Plate Threshold

K-Z Convenience Package

(mandatory)

Exterior

- 102" Wide Exterior
- Smart Arm Awning w/Exterior Controls
- Aluminum Wheels (TTs)
- 16" Tires w/Aluminum Wheels (FWs)
- 12" Diamond Plate on Sidewalls of Enclosed Garages
- Magnetic Catches for Baggage Doors
- Omnidirectional HDTV Antenna
- LED lights in Exterior Speakers
- Dual Rear Ramp Lights

Interior

- Armstrong® ToughGuard® Linoleum
- 8 CU FT Gas/Electric Refrigerator
- Stainless Steel Residential Kitchen Faucet w/Pulldown Sprayer
- Surfex® Wood Step in FW Hallway
- Interior Control Switches on OH End Cabinet
- Dark Accent Trim on Corners/Entry Doors
- Soft Snap Curtain in Garage Area
- Woodgrain Door to Garage Area
- Full-Width OH in Enclosed Garage Area

Toy Haulers	300THR	301THR	311THR10	321THR13	342THR13	260TH	311TH10	331TH13	352TH13	363TH12	373TH12
UVW (Unloaded Vehicle Weight)*	6,890	TBD	7,560	7,680	8,670	6,088	7,590	8,420	9,750	10,410	10,210
Dry Hitch Weight*	1,160	TBD	1,180	1,125	1,520	TBD	TBD	TBD	TBD	TBD	TBD
Dry Axle Weight*	TBD	TBD	6,380	TBD	7,150	4,732	6,220	6,720	7,850	8,530	8,170
NCC (Net Carrying Capacity)	3,110	TBD	2,440	2,320	3,030	2,712	3,410	3,580	3,450	4,830	5,030
GVWR	10,000	10,000	10,000	10,000	11,700	8,800	11,000	11,995	13,200	15,240	15,240
Interior Height	90"	90"	90"	90"	90"	91"	92"	92"	92"	92"	92"
Exterior Height	12' 3"	12' 3"	12' 3"	12' 3"	12' 3"	12' 2"	12' 3"	12' 3"	12' 7"	13' 3"	13' 3"
Exterior Width	102"	102"	102"	102"	102"	102"	102"	102"	102"	102"	102"
Exterior Length	33' 2"	34' 11"	35' 9"	37' 1"	38' 3"	29' 8"	34' 2"	37' 8"	39' 11"	40' 4"	41' 6"
Refrigerator (cu. feet)	8	8	8	8	8	8	8	8	8	8	8
Water Heater Cap. (gal. G/E w/DSI)	6	6	6	6	6	6	6	6	6	6	6
Fresh Water Cap. (gal.)	75	75	75	75	75	75	75	75	75	75	75
Waste Water Cap. (gal.)	32	32	32	32	32	32	57	32	32	57	57
Gray Water Cap. (gal.)	32	32	32	32	32	32	57	32	64	57	57
LP Gas Cap. (lbs.)	40	40	40	40	40	60	60	60	60	60	60
Furnace BTUs (1,000s)	25	25	25	25	25	25	30	25	30	30	30
Tire Size	15"	15"	15"	15"	16"	16"	16"	16"	16"	16"	16"
Awning	18'	19'	20'	19'	19'	14'	17'	20'	13'***	18'***	14'****

*This weight reflects the rolling average unit weight for each model. Your trailer weight will vary according to optional equipment.

352TH13 also available with optional 18' awning. *363TH12 also available with optional 9' awning. ****373TH12 also available with optional 11' awning.



985 N 900 W • Shipshewana, IN 46565
E-mail kz@kz-rv.com • www.kz-rv.com

Due to continual research and advances, manufacturer reserves the right to change specifications, design, price and equipment without notice, and assumes no responsibility for any error in this literature. Some items shown are not included as standard or optional equipment. ©2017KZ | 8/31/17 | 15M