

SPORTSMEN

Fifth Wheels



2017 Décor



French Roast



Linen

Standards

- New Aerodynamic Front Profile
- Diamond Plate Rock Guard on Front of Travel Trailers
- Enclosed Pin Box on FW's
- 3/8" Fully Walk-On Roof Decking
- 1-Piece Seamless Roof w/ SuperFlex® Roofing Material
- Awning w/Drip Rail & Spouts
- Tinted Windows
- Super-Sized Panoramic Slideroom Window
- Radius Entry Door
- Smooth Screwless Baggage Doors
- LED Pass-Through Storage Light
- Cable Hookup
- Digital TV Antenna w/Booster
- Self-Adjusting Electric Brakes
- Radial Tires
- Rear Bumper w/Sewer Hose Storage
- Winter Bypass Kit
- 2 or 4 Stabilizer Jacks (model specific)
- Outside Shower (N/A w/outside kitchen)
- (2) 30# Gas Bottles w/Bottle Cover
- 30 AMP Service
- 13,500 BTU A/C
- 3-Burner Cooktop
- Range Hood w/12V Light & Exhaust Fan
- Microwave w/Turntable
- Oven
- LP/Electric Double-Door Refrigerator
- Acrylic Sink w/High-Rise Faucet
- Solid Wood-Framed Mortise & Tenon Glazed Cabinet Doors

- Roller Ball Bearing Drawer Guides
- Decorative Light above Slideout Dinette
- Large Overhead Cabinets
- LED Interior Lighting
- Residential Crack-Resistant Congoleum® Linoleum Throughout
- Monitor Panel
- Built-In Medicine Cabinet w/Mirror w/Mirror in Bath
- Tub Surround
- Power Vent in Bath
- Skylight over Shower
- Queen Mattress
- Reversible Quilted Comforter
- Flush-Floor Bedroom (FW)
- Main Bedroom Roof Vent

K-Z Advantage Package (mandatory option)

- 2-Tone EXT Side Metal
- Nitrogen-Filled Tires
- Power Awning w/LED Light Strip
- 5/8" Tongue-&-Groove Plywood
- Key-Alike Program for Baggage & Entry Doors
- Bed Storage System
- Black Tank Flush
- 6-GAL LP/Electric DSI Water Heater
- Friction Hinge Entry Door
- Power Front Jack w/LED Light
- Large Folding Grab Handle
- Spare Tire
- Exterior Speakers
- Amber Step Light
- Solar Prep
- Backup Camera Prep
- Flip-Down 71" Storage Rack

- Alumi-Tread® Entry Steps
 - Equa-Flex® Suspension
 - Battery Disconnect
 - ToyLok®
 - Climate Package including Insulated/Heated/Enclosed Underbelly
 - Push-Back Recliners (STD in lieu of barrel chairs)
 - Seamless Countertops w/Under-Mount Kitchen Sink & Sink Covers
 - Dinette Doors w/36" Pullout Storage Bins
 - Upper Bunk Windows (select models)
 - Drop-In Cooktop w/Glass Cover
 - 8 CU FT Refrigerator w/Temp Controls
 - Kitchen Skylight
 - (2) LED Motion Sensor Lights
 - Blue LED Light Strip above Slideout Room (main LR only)
 - 12V Dual USB Port
 - Jackknife Sofa w/Middle Console & Sofa Arms
 - (2) 6.5" Interior Speakers
 - Multi-Media Stereo w/DVD, Bluetooth & NFC Wireless Connectivity
 - Foot-Flush Toilet
 - Pleated Shades
 - Queen Pillowtop Mattress
 - Plywood Bed Base w/Gas Struts
- ## Options
- Color-Infused Ivory Exterior Fiberglass
 - 15,000 BTU A/C IPO 13,500 BTU A/C
 - 2nd A/C (13,500 BTU)

- 50 AMP Service w/2nd A/C Prep
- 39" LED TV (N/A on 231RK)
- 32" LED TV (231RK only)
- Bedroom LED TV w/Inside/Outside Bracket
- Radiant Technology PKG (foil in floor, roof, front, rear)
- Freestanding Dinette Table & 4 Chairs IPO dinette (mandatory on 363FL)
- Tri-Fold Hide-a-Bed Sofa IPO Jackknife (mandatory on 362BH, 363FL, 333IK)
- Theater Seating IPO Jackknife (333BHK, mandatory on 333IK, 344BH)
- Plumbed for Washer/Dryer w/50 AMP (STD on 362BH, 363FL)
- Wardrobe Slide (261BH, 282IK, 301BHK)
- Front & Rear Electric Stabilizer Jacks (TT's only)
- Electric Rear Stabilizer Jacks (FW only)
- Fireplace (N/A 281RL, 231RK, 282IK, 322BHK)
- Aluminum Wheels
- 16" Tires & Wheels (FW's only)
- Central Vac (FW's only)
- MaxxAir® Vent Fan in Living Room OR Bath
- Bunk Slide Trundle Bed IPO Dinette (312BHK, 323BHK, 333BHK, 301BHK)
- Wireless Backup Camera System
- Bumper-Mount Grill
- Roof Ladder

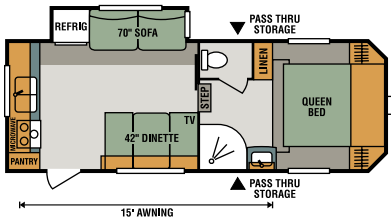

231RK

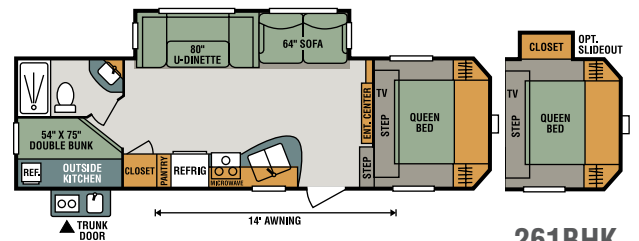

261BHK

261BHK
Closet Option

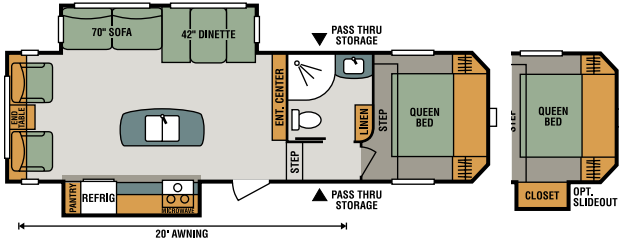

282IK

282IK
Closet Option

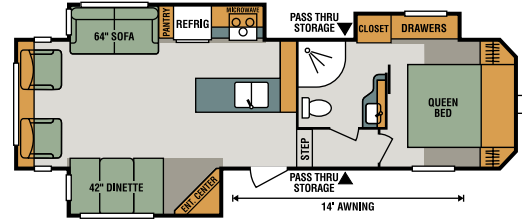

293RL

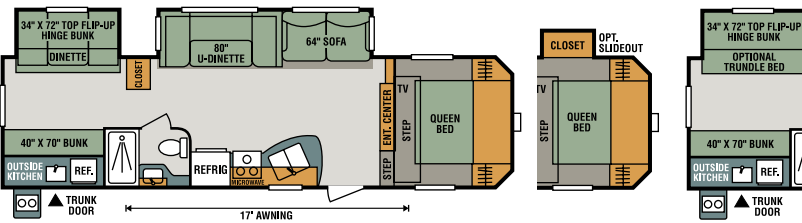

301BHK

301BHK
Closet Option
301BHK
Trundle Bed Option

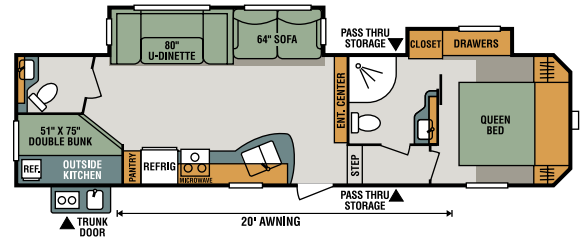

322BHK

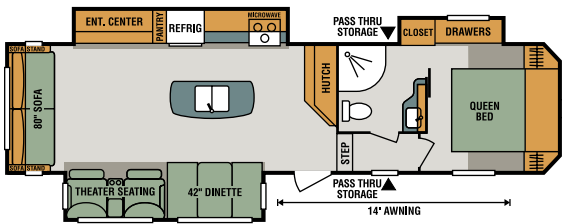

333IK

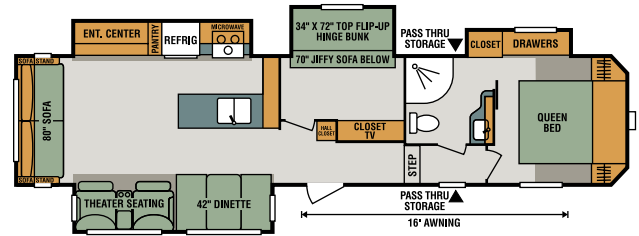

344BH **NEW**

Fifth Wheels	231RK	261BHK	282IK	293RL	301BHK	322BHK	333IK	344BH
UVW (Unloaded Vehicle Weight)*	5,925	7,130	7,540	7,860	7,830	8,270	8,510	TBD
Dry Hitch Weight*	860	1,440	1,210	1,620	1,420	1,770	1,490	TBD
Dry Axle Weight*	5,065	5,690	6,330	6,240	6,410	6,500	7,020	TBD
NCC (Net Carrying Capacity)	1,075	1,670	1,260	1,340	1,370	1,730	1,890	TBD
GVWR	7,000	8,800	8,800	9,200	9,200	10,000	10,400	12,000
Interior Height	92"	92"	92"	92"	92"	92"	92"	TBD
Exterior Height w/ A/C	11' 8"	12' 4"	12' 7"	12' 5"	11' 11"	12' 5"	11' 5"	TBD
Exterior Width	96"	96"	96"	96"	96"	96"	96"	TBD
Exterior Length	25' 2"	30' 9"	31' 4"	32' 7"	32' 11"	35' 7"	35' 7"	39' 3"
Refrigerator (cu. feet)	6	6	6	6	6	6	6	TBD
Water Heater Cap. (gal. G/E w/DSI)	6	6	6	6	6	6	6	6
Fresh Water Cap. (gal.)	38	38	38	38	38	38	38	38
Waste Water Cap. (gal.)	57	32	57	57	32	89	57	57
Gray Water Cap. (gal.)	89	32	57	57	32	57	57	89
LP Gas Cap. (lbs.)	60	60	60	60	60	60	60	60
Furnace BTUs (1,000s)	25	25	30	30	30	30	30	TBD
Tire Size	14"	15"	15"	15"	15"	15"	15"	16"
Awning	15'	14'	20'	14'	17'	20'	14'	16'

*This weight reflects the rolling average unit weight for each model. Your trailer weight will vary according to optional equipment.



985 N 900 W • Shipshewana, IN 46565
E-mail kz@kz-rv.com • www.kz-rv.com

Due to continual research and advances, manufacturer reserves the right to change specifications, design, price and equipment without notice, and assumes no responsibility for any error in this literature. Some items shown are not included as standard or optional equipment. ©2016KZ | 9/9/16 | 2.5M