

# DURANGO

## 1500



Half Ton Towable Fifth Wheels



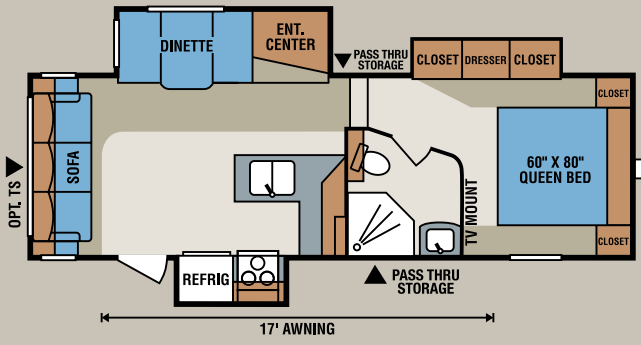

D251RLT

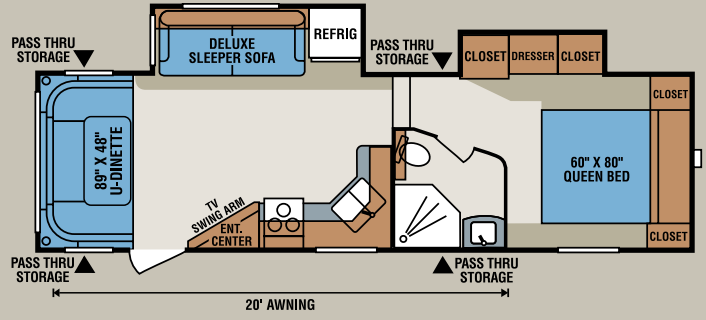

D259RDD

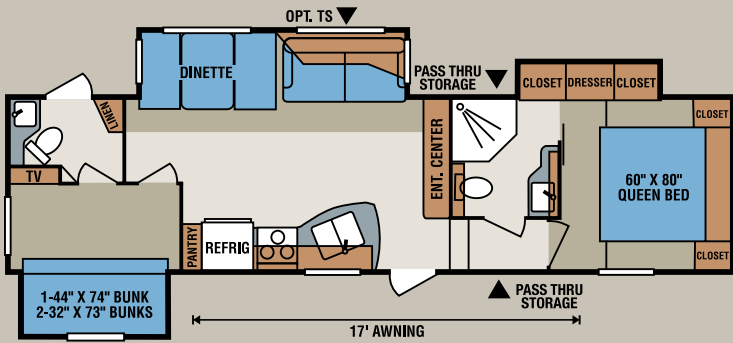

D276BHD

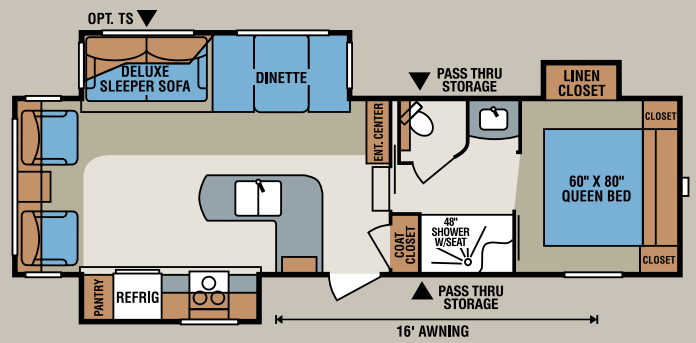

D277RLT

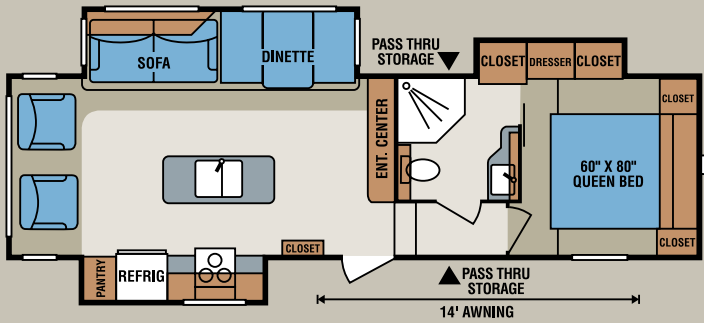

D281RLT

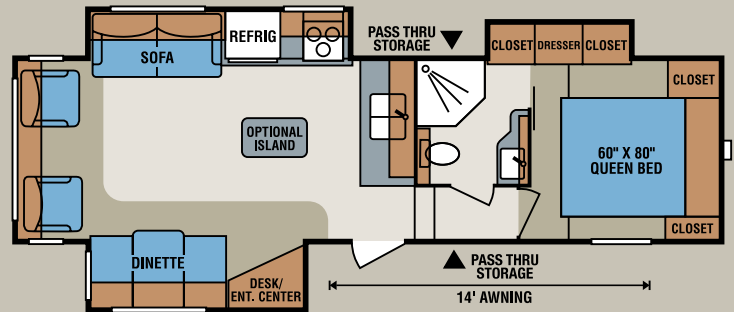

D284RLT

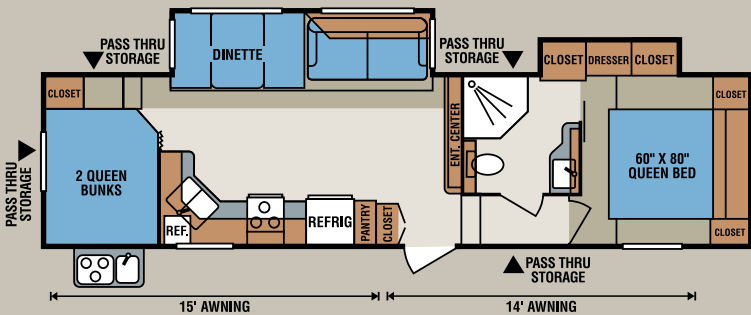

D286BHD

## Construction Features

- 100% Aluminum frame sidewalls
- 8" Steel powder coated frame
- R-11 2" Block foam bonded sidewalls w/EGS metal backing strips to hold up all interior cabinets
- Lamilux® high gloss fiberglass including sides of all slides, front & rear
- One-piece ABS slide room bottoms, slide room floors
- Additional outside frame-to-wall floor insulation
- Walk-on Super Flex TPO roof membrane
- 5/8" Tongue & groove screwed & glued plywood floor deck
- Fully-vented attic system
- Completely heated water system
- Pex® in-floor heated waterlines & kitchen gray pipes (note: all water & drains are located above all insulation)
- Heated low-point drains
- Fully-enclosed & heated underbelly
- Radius front cap for maximum turning radius on short bed trucks
- Extra reinforced heavy duty front fiberglass cap
- 6' Tall main floor slide rooms & 4' tall bedroom slide rooms
- Optional ALL WEATHER INSULATION PACKAGE (upgrades roof, floor, end caps & tanks to R-38)
- Double-insulated & heated holding tanks w/insulation upgrade package (R-38 above & below tanks)

## Exterior Features

- Dexter® axles w/auto-adjusting brakes & height adjusting hangers
- 6-Lug heavy duty aluminum rims w/D-range radial tires
- Equa-Flex® rubberized suspension
- 100% exterior LED running & taillights (note: all running lights are on fiberglass walls, not in metal lower wrap)
- LED docking light & sewer hookup light

- Dual function LED bug & floodlight by entry door
- Carefree® electric awning w/directional LED light kit at end of awning w/interior reminder switch
- Electric front jacks
- Propane bottles on same side of coach for easy access
- Painted front cap
- Frameless windows
- 3" x 14" Foam core in-floor straight line heating system w/35,000 BTU furnace.
- Heated water convenience center (incl. black tank flush, power fresh tank water fill, winterizing system, outside shower)
- Fully finished, heated & sealed basement storage compartment
- Heated & enclosed dump valves
- 12 GAL gas/electric/DSI water heater
- Swing-away assist grab handle
- Roof ladder
- No-slide rubberized basement flooring
- Dual lock slam latches on basement storage doors
- Outside speakers & prewire for exterior TV
- Battery disconnect
- Rain gutter system all the way around roofline including rear & additional gutters over slide rooms
- Optional 50A service & pre-wired for 2nd 13,500BTU bedroom AC
- Optional generator prep & optional Onan® 5500 LP Generator
- Optional tailgate storage system w/bike rack
- Optional rear electric jacks
- Optional dual pane frameless windows
- Optional 4-point automatic leveling system
- Optional One-Touch Remote for slides, awning, exterior lights & leveling jacks
- Optional Reese® Revolution Hitch Pin

## Living Room/Kitchen Features

- Solid surface kitchen countertops & sink covers
- Large residential stainless steel sinks
- Pullout high arching faucet
- Storage shelf under kitchen sink
- Heavy duty 80 LB drawer glides on every drawer
- Baltic Birch drawer boxes
- 8 CU FT double-door refrigerator
- High output oven w/broiler
- 22" Microwave
- Window in kitchen (most models)
- All-wood lumber core screwed cabinets w/hardwood doors
- 5" Stainless steel cabinet hardware
- Nightshades throughout
- 3/8" Re-bond carpet pad w/22 OZ residential carpet throughout
- Extra-large toggle light switches
- Faux vinyl ceiling
- Large ceiling crown molding
- All LED ceiling & cabinet lights w/multiple on/off switches
- Deluxe residential-style furniture
- 12V Entertainment system (DVD/radio) w/Bluetooth
- 32" LED TV & 4 living room speakers
- Satellite prewire (roof & ground)
- Adjustable shelves in pantry (most models)
- All kitchen overhead cabinets have shelve & extra-tall slide lips
- Wood-top booth dinette tables
- 5" high density foam cushions on all booth dinettes
- Dual pots & pans draws in all booth dinette seats
- Optional Maxxair® fan w/wall controls (kitchen, living room, bath, bedroom)
- Optional U.S. made free-standing table w/leaf & 4 chairs
- Optional Theater Seating (259, 284, 277, 276, 281, 286)
- Optional Dual Recliners IPO Swivel Chairs
- Optional Deluxe Sleeper Sofa IPO Jiffy Sofa

## Bathroom/Bedroom Features

- Angled shower stall w/radius doors
- Porcelain foot flush toilet
- All LED lights in bedroom & bath w/ multiple large toggle switches
- Power vent fans in all bathrooms w/ power switch on wall
- Heavy duty 80 LB drawer glides on all drawers
- Extra-large linen closet in every bathroom
- Padded headboard w/shelf & power in front of all beds
- Extra-large under-bed storage
- Luxurious bedspread & pillow shams
- Bedroom speakers
- Adjustable linen closet shelves, dual drawers & hanger area in all bedroom slide rooms
- Bedroom TV pre-wire
- Optional 13,500 BTU bedroom AC

- Optional upgraded Cotton Cloud® memory foam mattress w/gel top
- Optional 32" HD flat panel bedroom TV

## Bonus Features

- 2 Year limited warranty (see flyer)
- K-Z has won the coveted DSI award 14 years
- K-Z's 42 years of building experience, coupled with its stable and dedicated Amish workforce and commitment to superb quality and low overhead, allow us to produce the lowest-priced luxury fifth wheels available

*\* Due to continual research and advances, manufacturer reserves the right to change specifications, design, price and equipment without notice, and assumes no responsibility for any error in this literature.*

**ALUMINUM  
SUPER  
STRUCTURE**  
6 SIDED ALUMINUM FRAMING



Curry Décor



Earthen Décor



Espresso Décor

## Total Aluminum Frame ... Plus Structure on ALL Durango Fifth Wheels! 100% 6-Sided Aluminum Framing – Tongue-&-Groove Plywood Roof & Floor Decking

- 2" x 2" Welded Aluminum Sidewalls
- 14" On-Center 2" x 3" Welded Aluminum Floor Joists
- 14" On-Center Welded Aluminum Roof Trusses
- Aluminum-Framed Bathroom Door Jams
- 5/8" Tongue & Groove Plywood Floor Decking
- 3/8" Roof Decking



**Dealer Satisfaction Index:** Ratings of manufacturers, by dealers, have consistently awarded K-Z top honors for excellence of design, reliability, overall quality and value, communications and dealer support.



Portions of this brochure were used with the expressed authority of Dexter Axle, but Dexter Axle is not responsible for the accuracy of the information contained herein.



Dealer:



Join our Family Forum at  
[www.kzfamilyforum.com](http://www.kzfamilyforum.com)

For more product details and in-depth information, visit us at [www.kz-rv.com](http://www.kz-rv.com)



985 N 900 W • Shipshewana, IN 46565  
E-mail [kz@kz-rv.com](mailto:kz@kz-rv.com) • [www.kz-rv.com](http://www.kz-rv.com)



*Due to continual research and advances, manufacturer reserves the right to change specifications, design, price and equipment without notice, and assumes no responsibility for any error in this literature. Some items shown are not included as standard or optional equipment. ©2014KZ | 11/24/14 | 10M*