

A NEW ERA IN ULTRA LITES

# BULLET

**EASTERN EDITION**

**ULTRA LITE**  
by Keystone



[www.keystonerv.com/Bullet](http://www.keystonerv.com/Bullet)



**Keystone RV  
Company**



**BULLET 272BHS SHOWN IN SADDLE DECOR**



***EASY TO TOW WITH THE NEW MORE FUEL EFFICIENT CROSSOVERS, CARS AND TRUCKS, THE BULLET ULTRA LITE TRAVEL TRAILER HERALDS IN A NEW GENERATION OF RVs.***

*Sleek and smooth on the outside and loaded with features and conveniences inside, the new Bullet Ultra Lite will set you free to explore the open road.*

[www.keystonerv.com/bullet](http://www.keystonerv.com/bullet)

***BULLET***  
**ULTRA LITE**  
*by Keystone*



**BULLET 272BHS KITCHEN STORAGE**



**BULLET 272BHS BUNK BEDS**



**BULLET 272BHS BATHROOM**



**EXTERIOR KITCHEN**  
**(AVAILABLE ON 243BHS, 287QBS, 308BHS)**



**THE INDUSTRY'S FIRST LUXURY  
ULTRA LITE NOW HAS DEEPER  
SLIDES AND MORE FEATURES!**

**← 3 FEET WIDE! →**

**BULLET 269RLS SHOWN IN SADDLE DECOR**



**BULLET 269RLS SOFA AND DINETTE SHOWN IN SADDLE DECOR**

**CONVENIENCE,  
COMFORT & STYLE**

**LAUNDRY CHUTE IN EVERY  
BULLET FLOOR PLAN**



**BULLET 269RLS BEDROOM SHOWN IN SADDLE DECOR**



**BULLET 269RLS KITCHEN SHOWN IN SADDLE DECOR** 5

# BULLET'S TOP FEATURES



Bullet is the only ultra lite travel trailer to offer the following climate control features in all floor plans:

<b>BULLET</b>	<b>COMPETITION</b>
Enclosed underbelly	Exposed Tanks
2" pipe off of furnace with forced air into underbelly and radiant heat	Radiant heat Only
30,000 BTU Furnace	20,000 - 25,000 BTU Furnace
Ducted Heat and A/C	Non Ducted Heat and A/C

1. 6 cu. ft. Refrigerator
2. Exterior Kitchen (243BHS, 287QBS, 308BHS)
3. Laundry Chute in Master Bedroom
4. Systems Monitor Panel
5. Blackout Shades in Bunk Rooms
6. Storage Underneath the Bed in Master Bedroom



Includes more standard features that matter in light weight travel trailers.



## COMPARE BULLET'S DINETTE TO THE COMPETITION



**LARGE RADIUS DINETTE**



## BULLET

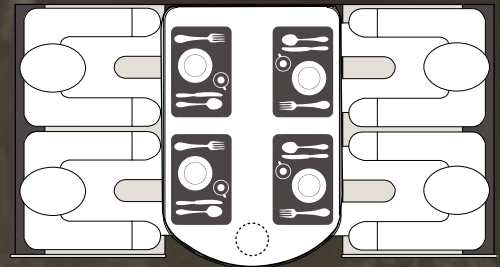

### COMFORTABLY SEATS 4 ADULTS

- PLENTY OF ROOM FOR 4 PLACEMATS
- ONLY NEEDS ONE TABLE SUPPORT
- CONVERTS TO 80" BED



## COMPETITION

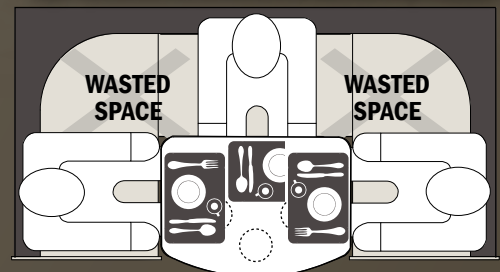

### DON'T BE FOOLED! ONLY SEATS 3 ADULTS

- ONLY ENOUGH ROOM FOR 2.5 PLACEMATS
- 3 PEDESTAL SUPPORTS REDUCE LEG ROOM
- ALSO CONVERTS TO 80" BED

- Gas Struts on Entry Doors
- 9" Deep Single Basin Kitchen Sink (N/A 220RBI, 310BHS)
- Largest Pass-Thru Storage in Class (40.3 cu. ft.)
- Jalousie Windows
- CD/DVD/AM/FM/MP3/Bluetooth Stereo
- Electric Adjustable Awning
- Hot/Cold Exterior Shower

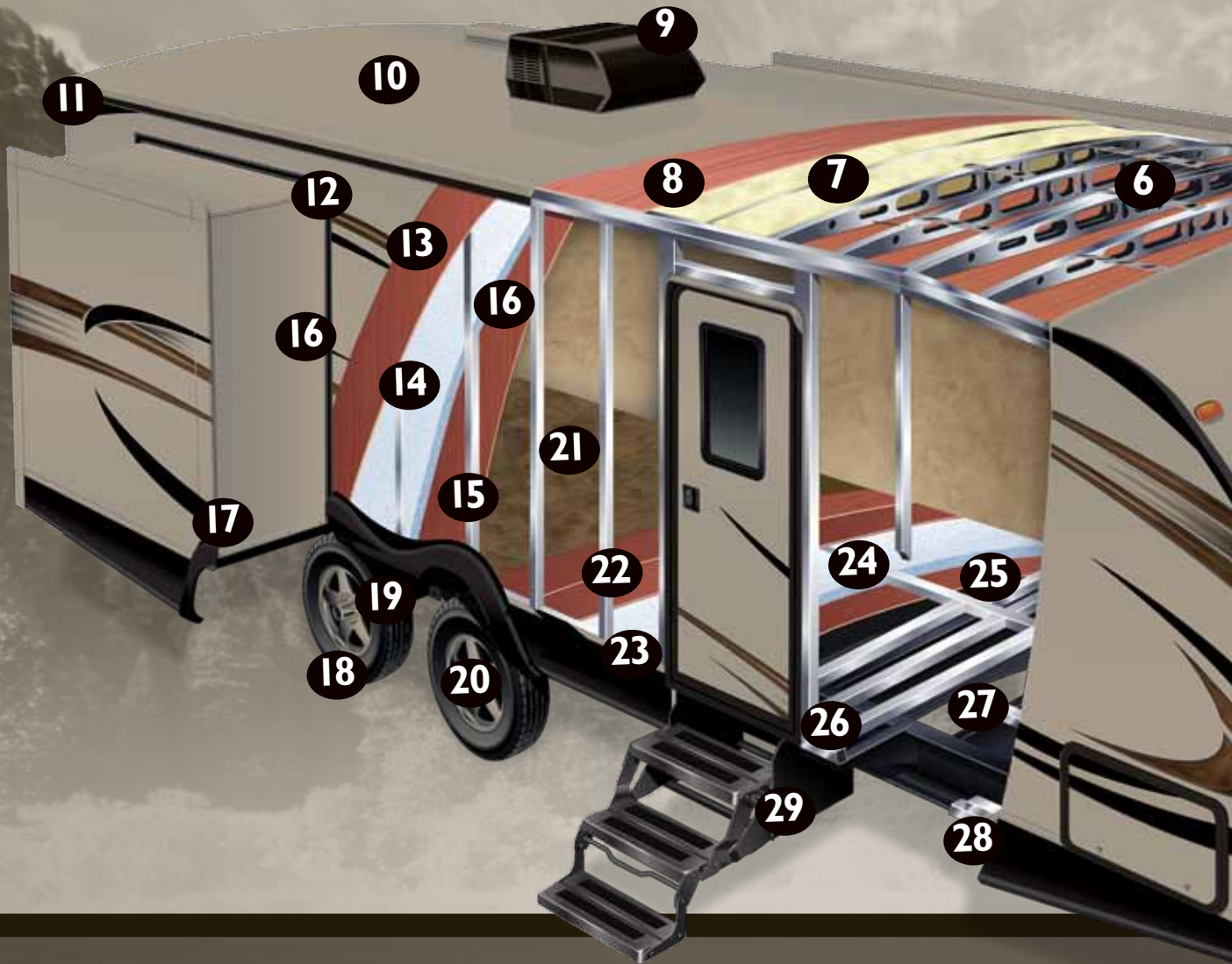

# **BEST TOWING TRAVEL TRAILER IN THE INDUSTRY**

*Increased MPG and Easier to Tow*



## **REAR DEPARTURE ANGLE**

Increases efficiency of wind flow underneath and behind the trailer



## **ENCLOSED UNDERBELLY**

Eliminates turbulence caused by exposed frame members, holding tanks, plumbing etc.



## **43" WIDE STANCE AXLES**

Wider base greatly reduces sway and bouncing

# BULLET

ULTRA LITE  
by Keystone

## LIGHTWEIGHT SOLID CONSTRUCTION



1. Quick Access LP Cover
2. Integrated Dual Battery Tray
3. Diamond Plate Stone Guard
4. Aerodynamic Front Profile
5. Hurricane Straps
6. 5" Radius Galvanized Stamped Steel Roof Trusses
7. Fully Insulated Roof
8. Durable Roof Decking
9. 13.5 Quick Cool Air Conditioning
10. One Piece TPO Roof
11. Full Length Rain Gutter and 4" Drip Spouts
12. Smooth Fiberglass Exterior
13. 1/8" Luan Wall Backing
14. Hi-Density Block Foam Insulation
15. 1 1/2" Box Welded Aluminum Frame Structure
16. Decorative Interior Wall Board
17. Bullet's Multi Seal and Track Slide System
18. Radial Tires with Electric Brakes (4)
19. Wide Stance Axle System
20. Easy Lube Axles
21. Residential Stain Resistant Trek Linoleum (resistant to cold cracking)
22. Plyvener Floor Decking (water resistant)
23. Hi-Density In Floor Block Foam Insulation
24. Double Welded Aluminum Floor Joists
25. 3rd Layer Floor Decking
26. 6.5" - 10" Steel I-Beam Frame
27. Darco Moisture Barrier Wrap
28. Heated and Enclosed Underbelly
29. Radius Triple Entry Steps



**SAVE MONEY ON FUEL**

Our lightweight floor plans are 1000-1500 lb. lighter than comparable competitors trailers



**RADIUS FRONT PROFILE VS. COMPETITION**

The radius front profile of the Bullet travel trailer gives the optimal contour to reduce wind resistance when traveling down the road.

# BULLET

ULTRA LITE  
by Keystone

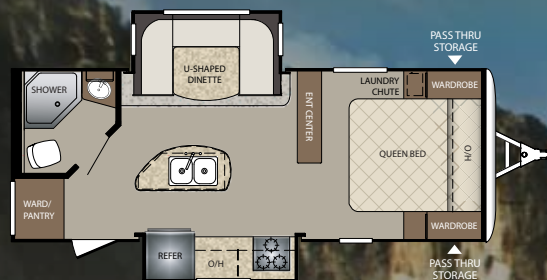

**220RBI**

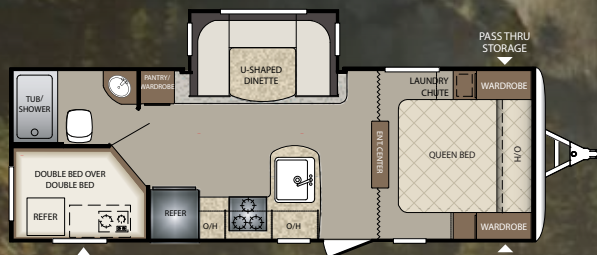

**243BHS**

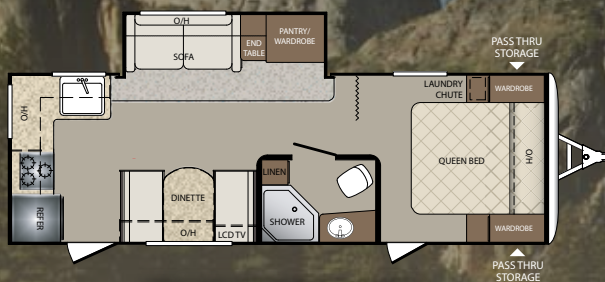

**248RKS**

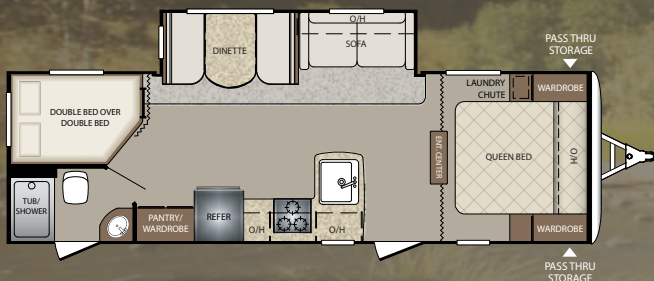

**272BHS**

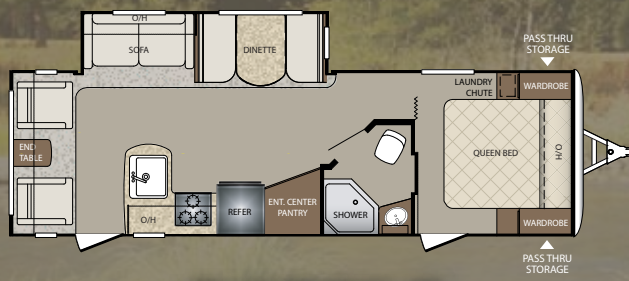

**269RLS**

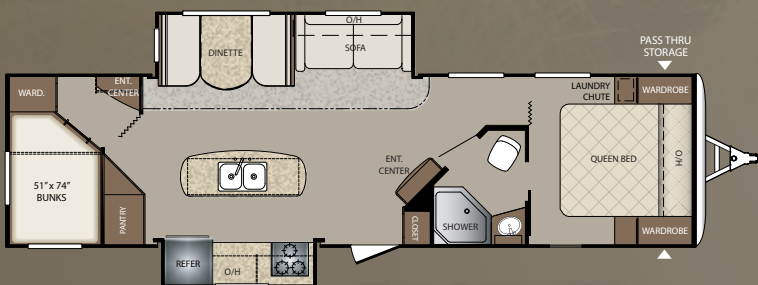

**310BHS**

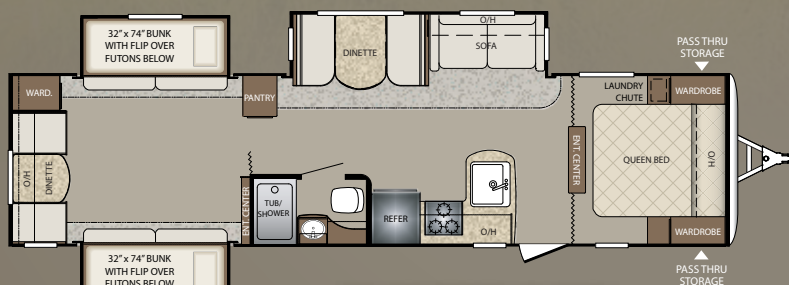

**335BHS**

Product information is as accurate as possible at the date of publication of this brochure. Features, floor plans, and specifications are subject to change without notice. Please also consult Keystone's web site at [keystonerv.com](http://keystonerv.com) for more current product information and specifications. Tow Vehicle Disclaimer. CAUTION: Owners of Keystone recreational vehicles are solely responsible for the selection and proper use of tow vehicles. All customers should consult with a motor vehicle manufacturer or their dealer concerning the purchase and use of suitable tow vehicles for Keystone products. Keystone disclaims any liability or damages suffered as a result of the selection, operation, use or misuse of a tow vehicle. KEYSTONE'S LIMITED WARRANTY DOES NOT COVER DAMAGE TO THE RECREATIONAL VEHICLE OR THE TOW VEHICLE AS A RESULT OF THE SELECTION, OPERATION, USE OR MISUSE OF THE TOW VEHICLE.

# TRAVEL TRAILER FLOOR PLANS

You'll find a Bullet floor plan to fit your lifestyle perfectly.



**251RBS**

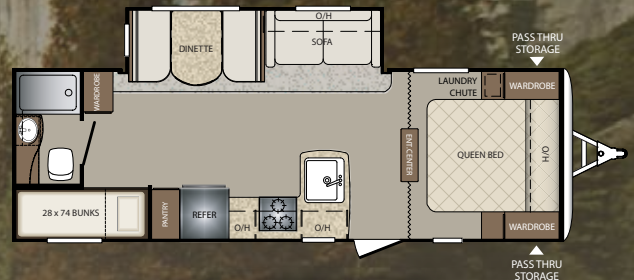

**252BHS**

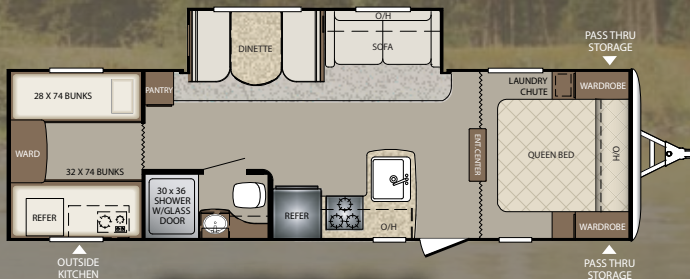

**287QBS**

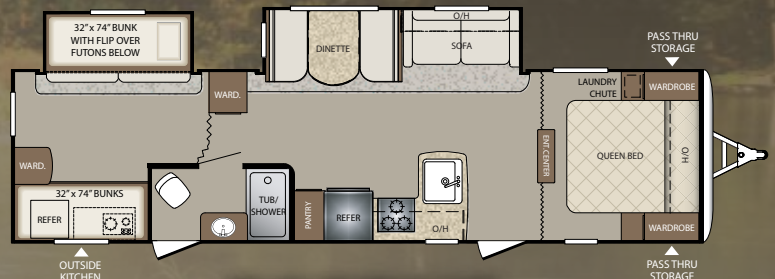

**308BHS**

## WEIGHTS & MEASUREMENTS

TRAVEL TRAILERS	220RBI	243BHS	248RKS	251RBS	252BHS	269RLS	272BHS	287QBS	308BHS	310BHS	335BHS
SHIPPING WEIGHT	4600	4685	4950	4943	4845	5185	5056	5480	6160	5977	6495
CARRYING CAPACITY	1800	1815	1550	2057	2155	2400	2484	2120	1440	1623	2105
HITCH WEIGHT	450	555	535	500	515	585	540	695	700	645	865
EXTERIOR LENGTH	25' 7"	27' 10"	28' 10"	29' 1"	29' 2"	30' 11"	30' 9"	32' 10"	35' 6"	35' 6"	37'
EXTERIOR WIDTH	8'	8'	8'	8'	8'	8'	8'	8'	8'	8'	8'
EXT. HEIGHT - A/C TOP	10' 7"	10' 7"	10' 7"	10' 7"	10' 7"	10' 7"	10' 7"	10' 7"	10' 8"	10' 8"	11'
FRESH WATER (GAL.)	43	43	43	43	43	43	43	43	43	43	43
WASTE WATER (GAL.)	30	30	30	30	30	30	30	30	30	30	30
GRAY WATER (GAL.)	30	30	60	30	30	30	30	30	30	60	30
LP CAPACITY (LBS.)	40	40	40	40	40	40	40	40	40	40	40
AWNING LENGTH	15'	19'	15'	14'	14'	15'	15'	15'	19'	19'	15'

# STANDARDS & OPTIONS

## CONSTRUCTION STANDARDS

- Aggressive Front Profile for Increased Towability
- Aluminum Framed Front, Rear, and Side Walls
- Aluminum Framed Slideouts
- Laminated Fiberglass Exterior Side Walls
- 2" Thick Laminated Aluminum Floor
- In-Frame Fresh, Grey, and Black Water Tanks
- 6.5" - 10" Steel I-Beam Frame with Welded Outriggers
- ¼" ABS Enclosed Underbelly
- Darco Moisture Barrier
- One Piece TPO Roof
- E-Z Lube Axles
- Electric Brake System (4 wheels)
- R-11 Insulation in Floor
- R-7 Insulation in Sidewalls
- R-11 Insulation in Roof

## EXTERIOR CAMPING PACKAGE

- Wide Stance E-Z Lube Axles
- 6 Gallon Gas/Electric DSI Water Heater with quick recovery
- Radius Entry Door with Gas Strut
- Outside Speakers
- Outside Shower (Hot & Cold Water)
- Tinted Safety Glass Windows
- 4 Stabilizer Jacks
- TV Antenna & Cable Hook-Up
- Electric Awning with Adjustable Arms
- Radial Tires
- Black Tank Flush

## EXTERIOR FEATURES

- Dual Propane Tanks with Cover
- Front Diamond Plate
- In Frame Dual Battery Rack
- Oversized Exterior Pass Thru Storage with Lighting
- Contoured Fender Skirts for Increased Air-Flow
- LP Quick Connect
- Amber Patio Light
- Spare Tire
- Extended 4" Down Spouts
- Triple Entry Steps
- Oversized Grab Handle
- Jalousie Windows

## INTERIOR CAMPING PACKAGE

- 13.5 BTU Ducted A/C
- Night Shades
- CD/DVD/AM/FM Bluetooth Stereo with Aux and I-Pod Hookup
- 32" LED TV
- Microwave
- 6 cu./ft. Double Door Refrigerator
- 3 Burner High Output Range
- 9" Deep Oversized Single Basin Sink with High Rise Faucet (N/A 220, 310)
- Glazed Hardwood Cabinet Doors
- Foot Flush Toilet
- Tub Surround with Shelves
- Full Extension Drawer Glides

## INTERIOR FEATURES

- 78" Interior Height
- Fiberglass Reinforced Flooring
- Residential Style Furniture
- Water Heater-By-Pass for Winterization
- Night Shades in Living Area
- 17" Oven
- Radius Dinette

## BATHROOM

- Towel Hooks
- Deluxe Curved Shower Curtain
- Power Vent Fan
- Solid Wood Medicine Cabinet
- Linen Storage

## MASTER BEDROOM

- Upgraded Foam Mattress
- Dual 110V Outlets
- Mirrored Wardrobes
- Laundry Chute
- Under Bed Storage
- Full Blackout Window Treatments
- Individual Reading Lights

## BUNK ROOMS

- Cable & TV Hookups (Per Floor Plan)
- Full Blackout Window Treatments
- Oversized Wardrobe with Rod (Some Floor Plans)

## THERMAL PACKAGE

- Ducted Heat & Enclosed Underbelly
- 2" Duct off of Furnace to Underbelly
- 30K BTU Furnace
- Residential Heat Ducts



## SAFETY EQUIPMENT

- Carbon Monoxide Detector
- Smoke Alarm
- Fire Extinguisher
- Electric Brakes
- Safety Chains
- Tinted Safety Glass Windows
- Egress Windows (Fire Escape)
- GFI Electrical Outlets

## OPTIONS

- Aluminum Wheels
- 15K A/C
- 50 AMP Service with 2nd A/C Prep (308, 335 Only)
- Bumper Mounted Aussie Grill (N/A 287, 308)
- Tri-Fold Sofa (N/A 220, 243)

DUNE

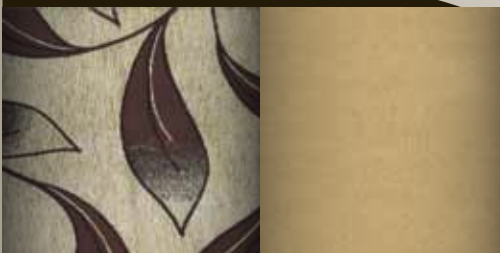

SADDLE



CHARCOAL



YOUR LOCAL DEALER:

LEARN MORE



[www.keystonerv.com/bullet](http://www.keystonerv.com/bullet)

**BULLET**  
 ULTRA LITE  
 by Keystone

 **Keystone RV Company**  
[www.keystonerv.com](http://www.keystonerv.com)

2642 Hackberry Drive | PO Box 2000  
 Goshen, IN 46527-2000  
 (574) 535-2100

November 2014