

GREY WOLF



BY FOREST RIVER

GREY WOLF



LEAD THE PACK.





[RIGHT] The deep slide out room of the Grey Wolf 27BHKS creates an openness that allows comfortable seating and meal preparation.



27BHKS

IN RYKER BROWN

The Grey Wolf by Cherokee is engineered with impeccable quality, distinctive features, superior comfort and remarkable affordability. Grey Wolf offers our customers a chance to escape the ordinary and relax, to enjoy family and friends and to see nature in all its beauty and wonder. These special life moments are the reasons we take such pride in all we do.





26BH

IN RYKER BROWN

One step into the Grey Wolf, you will notice all of the stylish details and designs. Arched dinette cushions and valances show a soft and elegant look. The over-sized dinette window offers you tremendous views and the security of being able to keep children in sight. These features are just a few reasons why Grey Wolf stands above the rest.



GREY WOLF



29BH

IN GOLDEN ESPRESSO

Designed to accommodate every camping enthusiast needs, the Grey Wolf has it all. By offering the best floor plans and features, the Grey Wolf can make your dreams a reality. Easy and light enough for your vehicle to tow, Grey Wolf makes life a little bit easier.



19RR

IN GOLDEN ESPRESSO

The Grey Wolf smart design and remarkable attention to detail is what customers experience when they step inside. A deep level of pride goes into our work and we continue to push ourselves forward when it comes to innovation.



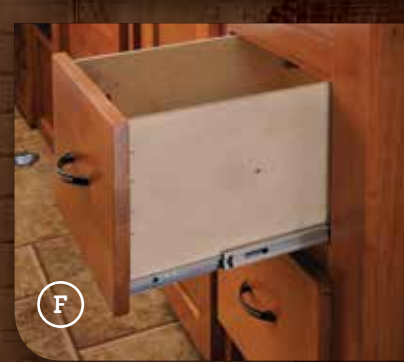
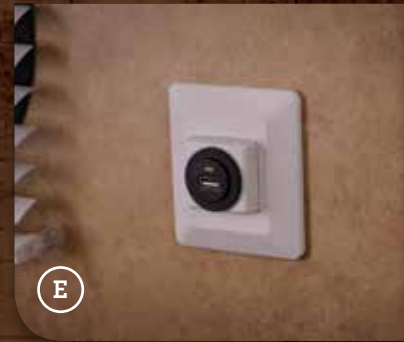
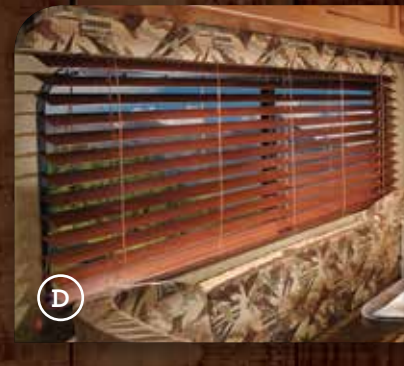

JUST A FEW OF THE FEATURES YOU'LL LOVE

- A** Our large and comfortable slide out room feature comfortable, arched back dinette cushions and extra large dinette seating. Our oversized windows usher an abundance of light into the unit.
- B** The hidden switches cabinets provide a convenient way of centrally locating the unit's controls. The exterior dry erase board allows you to write down notes and other important information.
- C** Grey Wolf's deep single bowl sink provides a large basin to wash dishes, fill pots and pans for cooking. Our high rise faucets allows you extra room to clean up with ease.
- D** The stylish, optional wooden blinds offers an upgraded look for those looking for a residential design and feel.
- E** The USB port is an important feature for those looking to utilize their electronic equipment such as iPods, cameras or MP3 players.
- F** Our smooth roller glide drawers fully extend to 16 inches in depth to accommodate any silverware or storage needs and provides easy access.
- G** The corner cube speaker found in Grey Wolf enhance the audio sound of your electronic equipment.

**ALL THE ATTENTION WE PLACE INTO
OUR INTERIORS IS REFLECTED IN
OUR EXTERIOR FEATURES.**



H Grey Wolf's optional power awning provides an easy way to shade the exterior patio area with just a push of a button.

I Grey Wolf installs 2 exterior speakers to give you excellent sound quality while you enjoy the outdoors

J Our optional rear travel rack is an ideal location to store coolers, bicycles and any extra items that you want to take with you on your adventure.



K The optional power tongue jack gives you an easy way to load your trailer with a push of a button.



L Grey Wolf's optional Equa-Flex suspension provides a smoother ride during your journey to and from your destination.



M Our extra large exterior storage door gives you ample room to store large items for your camping excursion

[Right] The graphics on the Grey Wolf are very attractive and are an eye catcher, while the lower, front diamond plate helps prevent stone chips.





29DSFB IN LEAF SAND

The many bunkhouse models of the Grey Wolf provide different living options for families as well as couples. As seen here, the 29 DSFB offers a large, main bedroom slide and a front bunk room that can convert into a large sleeping area below. The main interior offers abundant residential amenities and room to relax.



GREY WOLF FABRICS. BEAUTY ON THE INSIDE.

Ryker Brown



Earth Tan



Leaf Sand



Golden Espresso



Linoleum Floor

Cabinetry



Wall Panels



GREY WOLF STANDARDS & OPTIONS. LOAD YOUR TRAILER WITH LUXURY.

WINDOWS

- Mini Blinds on All Windows
- Hard Window Valances
- Radius Windows
- Safety Glass Windows

BEDROOM

- Bed Sheets
- Wardrobe Closet
- Dual Bulb Reading Lights
- Night Stands Each Side of Bed
- Floor To Ceiling Mirrored Wardrobe Door

KITCHEN / LIVING

- High Rise Faucet
- Self Edged Countertops and Tabletops
- Large Storage Doors
- Full Extension Roller Glide Drawers
- Monitor Panel
- Double Door Refrigerator
- Large Storage Drawer Under Cooktop
- Toe Kicks at Cabinet Bases
- Hidden Switches Cabinet With Dry Erase Board
- Large, Single Bowl Kitchen Sink

SLIDE OUT

- 40" Dinette (Selected Floorplans)

- One Piece Slide Out Side Walls
- U- Shaped Dinette with Pedestal Legs on All Bunkhouse Models (Selected Floorplans)
- Decorative Paneling On All Slide Out End Walls Décor

CABINETS

- Cherry Stained Shaker-Style Cabinets
- Large Overhead Cabinets
- High Grade Cabinet Handles
- Rounded Styled Cabinets

BATHROOM

- Acrylic Bath Sinks (Large)
- Shower Curtain
- Linoleum In Bath Area
- Double Framed Tub Bases
- Large, Mirrored, Medicine Cabinet

APPLIANCES

- High Output Cook Top
- Carousel High Output Microwave
- Digital TV Antenna With Power Booster
- 13.5 Air Conditioner
- Water Heater By Pass
- AM/FM/CD/Stereo With iPod Hookup.
- Six Gallon Turbo Water Heater

EXTERIOR

- Large Radius Luggage Doors
- 20 lb. LP Bottles w/Cover
- Awning Drip Rail And Down Spouts
- Patio Awning
- One Piece Rubber Roof
- Upgrade Graphics
- Two-Toned Exterior Metal
- Colored Front And Rear Metal
- Outside Stereo Speakers
- Radius Entry Door
- Cable Hook up
- Outside Outlet
- Radius, Double Drop Step
- Aerodynamic Radius Front Profile
- Front Diamond Plate Stone Guard

CONSTRUCTION FEATURES

- 3/8" Walkable Roof Decking
- Radius Truss Roof Rafters
- 5/8" Tongue And Groove Plywood Floor
- 2" x 3" Floor Joists
- Powder Coated, Rust Resistant Frame
- R7 Fiberglass Insulation
- Linoleum Front To Back
- Roto Cast (Seamless) Holding Tanks
- 12" On Average Side Wall Stud
- Galvanized Steel High Wind Bands

OPTIONS

- Skylight Over Dinette (Slide out models only)
- Stabilizing Jacks (Std. On Slides)
- Spare Tire w/Carrier And Cover
- 6 Gallon Gas/Electric DSI Turbo Water Heater
- Skylight Over Tub
- High Output Oven
- Scare Light
- LCD Flat Screen Television Set
- Gel Coated Sidewalls
- Ducted Air Conditioning (Available 22' and Over)
- 30 # LP Bottles
- Heavy Duty Plank Wood Linoleum
- Pull out Kitchen Faucet
- Outside Bar and Grill (26BH, 28BH, 29BH Only)
- Outside Shower
- Water Filtration System
- Sink Cover
- Under Bunk Dog Kennel
- Mini Outside Kitchen
- Pack and Play Storage Door
- Screen wall (19 RR, 21 RR, 25 RR only)
- Bedspread and Decorative Pillow
- Range Cover
- RV Bed Sheet Set

GREY WOLF FLOORPLANS. THERE'S A PERFECT PLAN FOR EVERYONE.

17BH

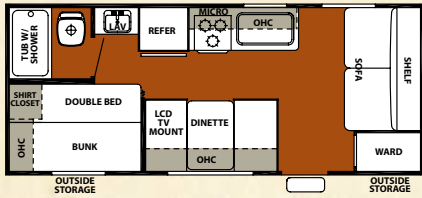

18RB

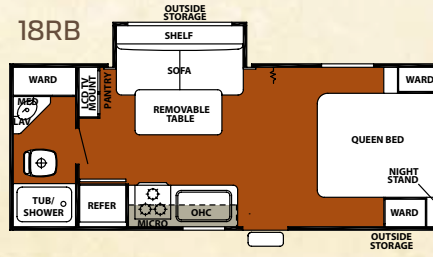

19RR

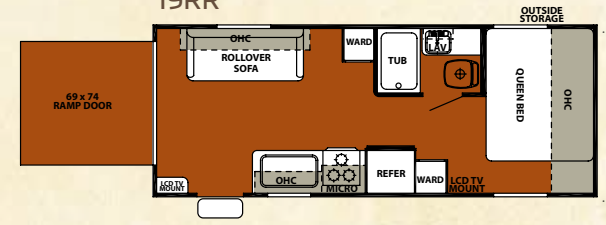

21RR

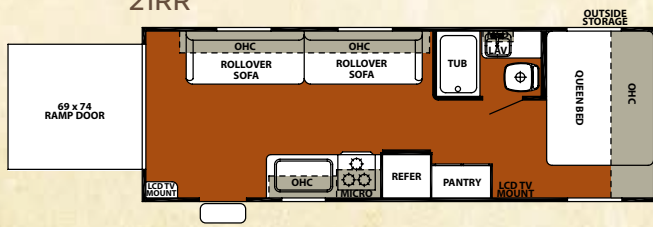

23BD

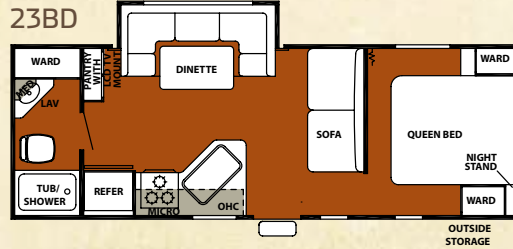

25RL

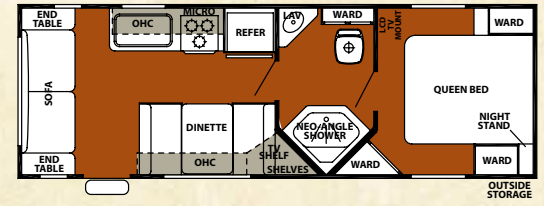

25RR

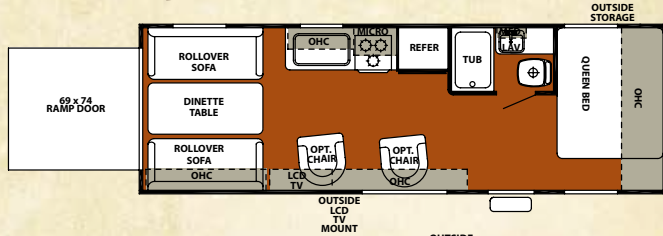

26BH

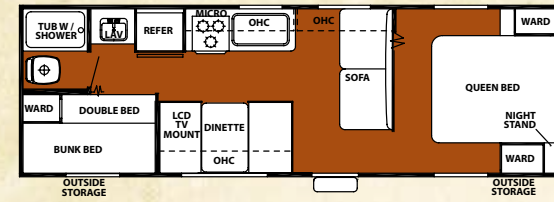

26DBH

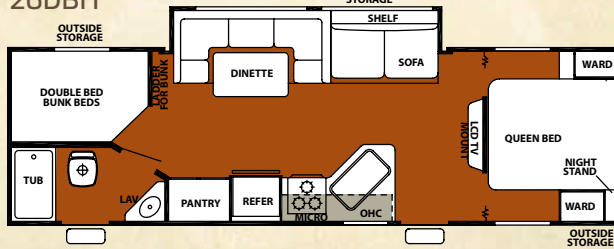

26RL

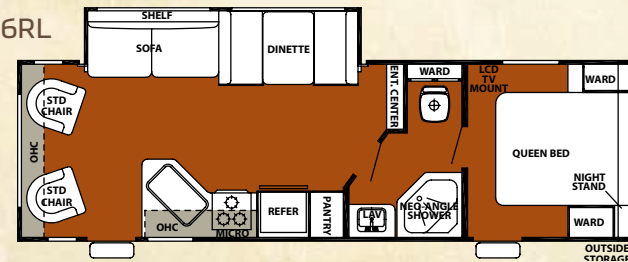

27BH

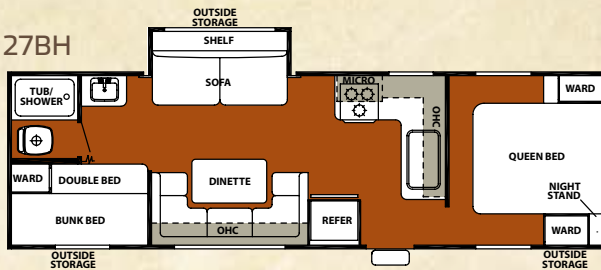

27BHKS

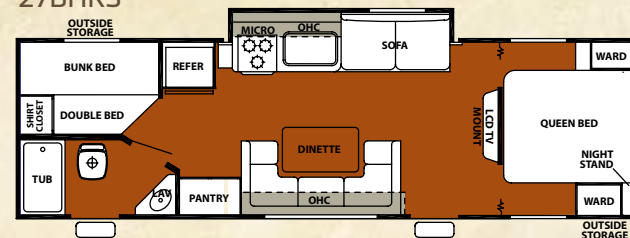

GREY WOLF

28BH

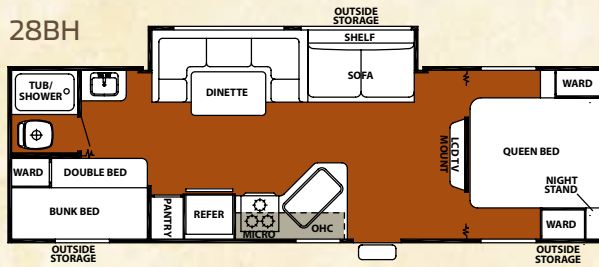

28BHKS

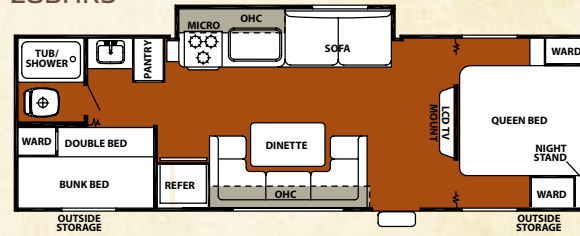

29BH

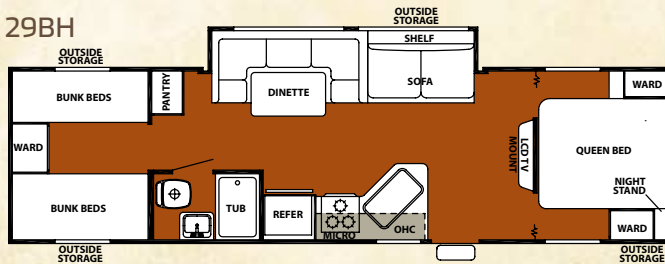

29DSFB

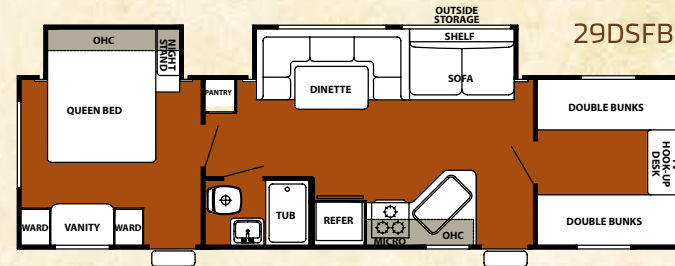

GREY WOLF WEIGHTS & MEASURES. IT'S ALL IN THE DETAILS.

	T17BH	T18RB	T19RR	T21RR	T23BD	T25RL	T25RR	T26BH	T26DBH	T26RL	T27BHKS	T27BH	T28BH	T28BHKS	T29BH	T29DSFB
DRY HITCH WEIGHT	522 lbs	467 lbs	574 lbs	693 lbs	442 lbs	660 lbs	857 lbs	402 lbs	740 lbs	778 lbs	785 lbs	686 lbs	681 lbs	752 lbs	753 lbs	722 lbs
UNLOADED VEHICLE WEIGHT	3700 lbs	4254 lbs	4142 lbs	4337 lbs	4937 lbs	4974 lbs	4697 lbs	4541 lbs	5750 lbs	5711 lbs	5826 lbs	5203 lbs	5339 lbs	5296 lbs	5969 lbs	6683 lbs
AXLE WEIGHT	3178 lbs	3787 lbs	3568 lbs	3644 lbs	4495 lbs	4314 lbs	3802 lbs	4139 lbs	5010 lbs	4933 lbs	5041 lbs	4517 lbs	4658 lbs	4544 lbs	5216 lbs	5961 lbs
SHIP WEIGHT	3700 lbs	4254 lbs	4142 lbs	4337 lbs	4937 lbs	4936 lbs	4697 lbs	4541 lbs	5750 lbs	5711 lbs	5826 lbs	5203 lbs	5339 lbs	5296 lbs	5969 lbs	6683 lbs
GVWR W/BRAKES	7522 lbs	7467 lbs	7574 lbs	7693 lbs	7442 lbs	7660 lbs	7857 lbs	7402 lbs	7740 lbs	7778 lbs	7785 lbs	7686 lbs	7681 lbs	7752 lbs	7753 lbs	7722 lbs
CARGO CARRYING CAPACITY	3822 lbs	3213 lbs	3432 lbs	3318 lbs	2467 lbs	2686 lbs	3160 lbs	2861 lbs	1952 lbs	2029 lbs	1921 lbs	2445 lbs	2302 lbs	2456 lbs	1746 lbs	1001 lbs
EXTERIOR LENGTH	22'2"	24' 8"	23'11"	27'	27'-6"	27'8"	28' 1"	29'3"	31' 7"	30'-11"	31' 7"	31' 8"	31'	31'	33'11"	34'10"
EXTERIOR HEIGHT W/ AC	10'5"	10' 5"	10'5"	10' 6"	10'5"	10'5"	10' 6"	10'5"	10'5"	10'5"	10'5"	10'5"	10'5"	10'5"	10'5"	10'5"
EXTERIOR WIDTH	97"	97"	97"	96"	97"	97"	96"	97"	97"	97"	97"	97"	97"	97"	97"	97"
BEDROOM INTERIOR HEIGHT	78"	78"	78"	NA	78"	78"	NA	97"	78"	78"	78"	78"	78"	78"	78"	78"
FURNACE BTU	20 BTU	20 BTU	20 BTU	20,000	20 BTU	20 BTU	20,000	20 BTU	20 BTU	20 BTU	20 BTU	20 BTU	20 BTU	20 BTU	20 BTU	20 BTU
GREY CAPACITY	41 Gal	41 Gal	31 Gal	41-gal	41 Gal	41 Gal	41-gal	41 Gal	41 Gal	41 Gal	41 Gal	41 Gal	41 Gal	41 Gal	41 Gal	41 Gal
BLACK CAPACITY	31 Gal	31 Gal	31 Gal	31-gal	31 Gal	31 Gal	31-gal	31 Gal	31 Gal	31 Gal	31 Gal	31 Gal	31 Gal	31 Gal	31 Gal	31 Gal
FRESH CAPACITY	50 Gal	50 Gal	50 Gal	50 Gal	50 Gal	50 Gal	50 Gal	50 Gal	50 Gal	50 Gal	50 Gal	50 Gal	50 Gal	50 Gal	50 Gal	50 Gal
SOFA SIZE	68"	68"	68"	76"	68"	68"	N/A	68"	58"	68"	58"	68"	58"	58"	58"	58"
AWNING SIZE	15'	15'	15'	15'	15'	15'	13'	15'	15'	15'	15'	18'	15'	13'	15'	15'

LET'S SEE HOTELS COMPETE WITH THIS.

Never follow.
LEAD THE PACK.



Forest River, Inc. encourages our customers to purchase their Forest River products from a local dealership whenever possible for the following reasons:

- 1) Forest River, Inc. dealers are independently owned and operated businesses so priority service and scheduling is at their discretion and is often provided to customers that purchased their unit at that dealership.
- 2) Purchasing locally allows customers to establish meaningful relationships with a dealer, enhancing the RV experience through assistance with product questions, user tips or RV regulations for your state or country, and much more!
- 3) Canadian customers must meet requirements to bring an RV purchased out of the country to their home. These requirements may involve additional inspections and certifications, taxes and fees. Your local Canadian Dealer is a professional at meeting these requirements.
- 4) Scheduling timely warranty repairs and adjustments through a local dealership provides far greater flexibility and convenience to you, the customer!

It is the goal of Forest River, Inc. that all of our RV owners fully enjoy the RV experience and that customer satisfaction meets or exceeds their expectations!



PRE-DELIVERY INSPECTION FACILITY

20,000 square feet of quality assurance. The bare essentials for a premium product. This state-of-the-art facility gives immediate daily feedback to production for quality assurance in every unit built.



Learn More
Scan this barcode using a QR Reader on your smart phone to learn more about Forest River.



A Berkshire Hathaway company.

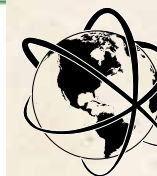

YOUR GREY WOLF DEALER

RV WHOLESALE SUPERSTORE

Quality RV's at wholesale prices

SYLVANIA OH, 43560

1-844-601-1171 | RVWSS.COM

All illustrations and specifications contained in this literature are based on the latest product information at time of publication. Forest River reserves the right to make changes in prices, colors, materials, equipment and specifications at anytime without notice and assumes no responsibility for any error in this literature. All units are shipped F.O.B. Goshen, Indiana. CONSULT YOUR LOCAL DEALER FOR WARRANTY INFORMATION. LITHO: U.S.A. FOR 0918