



# Heritage Glen

by Wildwood



SEND YOUR FAMILY ON A FIRST CLASS TRIP. SEE AMERICA IN A HERITAGE GLEN.  
VACUUM-BONDED ALUMA FRAME LUXURY TRAILERS AND FIFTH WHEELS.



**312QBUD COFFEE INTERIOR**  
 THE HERITAGE GLEN SERIES FEATURES AN ALL NEW STAINLESS STEEL KITCHEN PACKAGE AND MODERN MISSION STYLE CABINETS STANDARD ON ALL MODELS. THE EXTERIOR KITCHEN IS A NEW OPTION AVAILABLE FOR THIS MODEL. NO LONGER DOES THE COOK HAVE TO MISS OUT ON ALL OF THE FUN, THEY CAN CATCH ALL OF THE ACTION CAMP SIDE WHILE COOKING A DELICIOUS MEAL. THE 312QBUD FEATURES A SPACIOUS BUNK ROOM COMPLETE WITH IT'S OWN ENTERTAINMENT AREA. THE 312QBUD ALSO HAS A LARGE U-DINETTE AND 26" SPIN TV WHICH IS PERFECT FOR ENTERTAINING.



**292FKDS COFFEE INTERIOR**



**312QBUD REAR BEDROOM**



**312QBUD COFFEE INTERIOR**

# WILDWOOD HERITAGE GLEN TRAVEL TRAILERS

FIRST CLASS CAMPING



	262FLS	282RLSS	292FKDS	292RLSS	302QBUD	312QBUD
HITCH WEIGHT lb	750	950	1125	810	845	820
AXLE WEIGHT	5290	6115	6547	6425	6300	7235
DRY SHIP WEIGHT	6040	7065	7672	7235	7145	8055
GVWR	7750	11110	11285	10970	11005	10980
CCC cargo capacity	1651	3986	3554	3676	3801	2466
EXT LENGTH	28' 9"	34' 2"	33' 10"	34' 2"	33' 6"	35' 6"
EXT HEIGHT	10' 4"	11' 2"	11' 2"	11' 2"	11' 2"	11' 2"
INT HEIGHT	80"	80"	80"	80"	80"	80"
FRESH WATER CAP gal	42	42	42	42	42	42
BLACK WATER CAP gal	34.5	34.5	34.5	34.5	34.5	34.5
GREY WATER CAP gal	34.5	64	69	69	34.5	34.5
TIRE SIZE in	15"	15"	15"	15"	15"	15"
AWNING SIZE ft	16'	21'	21'	21'	18'	21'



**312QBUD** EXTERIOR KITCHEN IS NEW FOR THE 2010 MODEL YEAR. YOU NOW HAVE THE OPTION OF COOKING MEALS EITHER INSIDE OR OUT. A GREAT WAY TO ENJOY YOUR CAMPING EXPERIENCE OUTDOORS.





**246RLBS MOSS INTERIOR**

PICTURED ABOVE IS THE LARGE SLIDE IN THE 246RLBS FEATURING THE OPTIONAL AIR-HIDE-A-BED SOFA, FREE STANDING DINETTE AND FULLY FUNCTIONAL FLOOR TO CEILING WINDOWS THAT COME COMPLETE WITH SCREEN. BELOW YOU WILL FIND A VIEW OF OUR NEW LOFT AREA AND CATHEDRAL SLIDE, ALLOWING FOR EVEN MORE HEADROOM. ALSO PICTURED IS OUR KIDS ENTERTAINMENT ROOM COMPLETE WITH IT'S OWN STATE-OF-THE-ART AM/FM, CD, DVD, MP3 PLAYER THAT COMES STANDARD. THIS PICTURE ALSO SHOWS THE OPTIONAL JIFFY SOFA WITH EXTRA LARGE PULLOUT STORAGE DRAWERS. THE FINAL PICTURE IS OF OUR LARGE LOFT AREA, THERE TRULY IS ROOM FOR THE WHOLE FAMILY IN THE HERITAGE GLEN SERIES BY WILDWOOD.



**316TBRD WINE INTERIOR**



**316TBRD WINE INTERIOR REAR LOWER BEDROOM (TV OPTIONAL)**

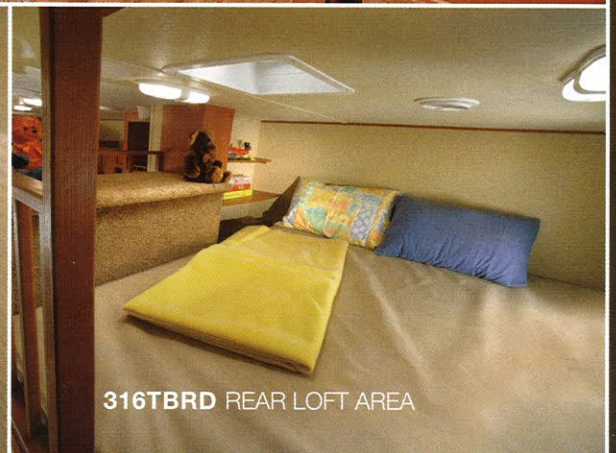

**316TBRD REAR LOFT AREA**

# WILDWOOD HERITAGE GLEN MID PROFILE FIFTH WHEELS / SPECIFICATIONS

FIRST CLASS CAMPING

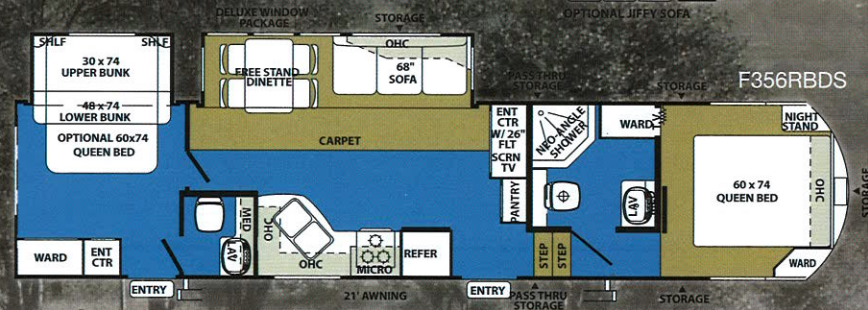
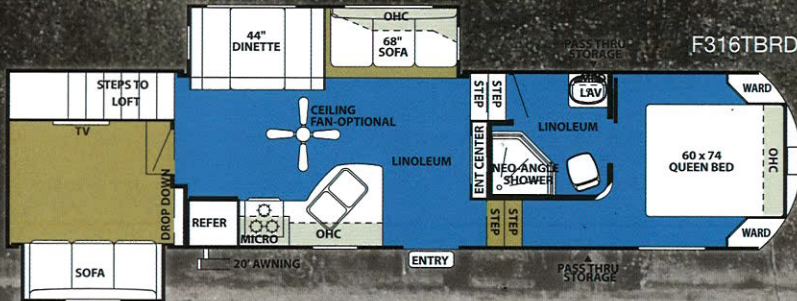
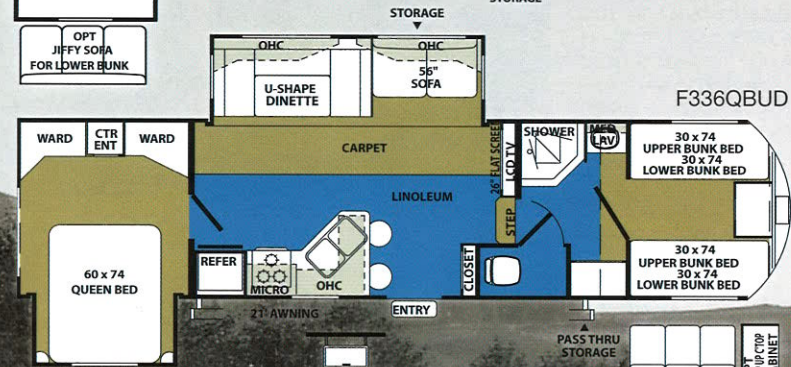
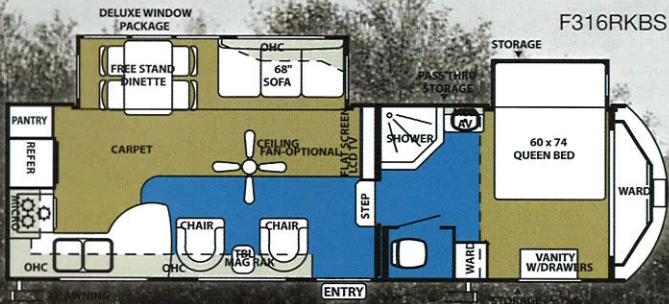
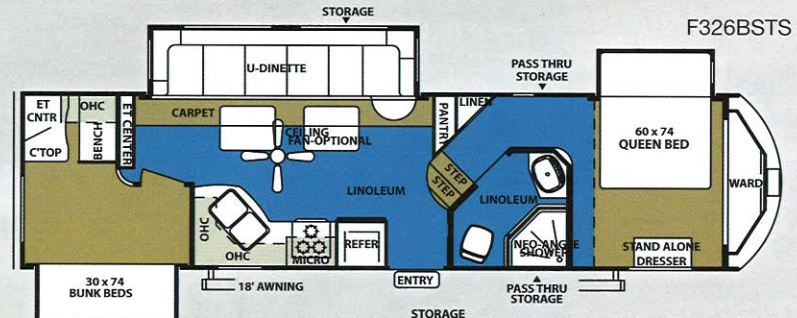
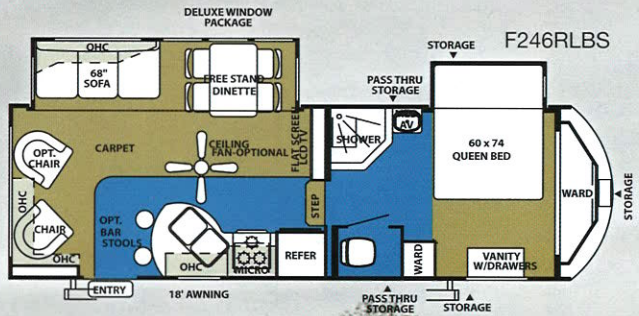

	F246RLBS	F316RKBS	F316TBRD	F326BSTS	F336QBUD	F356RBDS
HITCH WEIGHT lb	900	1575	1490	2255	1635	1420
AXLE WEIGHT	6560	6765	8195	7350	7363	7860
DRY SHIP WEIGHT	7460	8340	9545	9605	8998	9280
GVWR	11060	11735	11510	12415	11795	11580
CCC cargo capacity	3541	3336	1906	2751	2738	2240
EXT LENGTH	28' 6"	31' 0"	36' 7"	36' 3"	35' 0"	38' 2"
EXT HEIGHT	12' 2"	12' 4"	12' 4"	12' 4"	12' 4"	12' 4"
INT HEIGHT	84"	84"	84"	84"	84"	84"
FRESH WATER CAP gal	42	42	42	42	42	42
BLACK WATER CAP gal	34.5	34.5	34.5	34.5	34.5	69
GREY WATER CAP gal	34.5	69	69	69	69	69
TIRE SIZE in	15"	15"	15"	15"	15"	15"
AWNING SIZE ft	18'	21'	20'	18'	21'	21'



(from left to right) The latest technology ZX-75 AM/FM radio with CD and DVD Player, MP-3 & SD card hook-up • Heated and enclosed underbelly protects the undercarriage and provides a sturdy ride • Dometic™ one-touch electric awning. The push of a button extends and retracts your awning • Ultra-Lube™ axles for easy greasing of wheel bearings without disassembly.

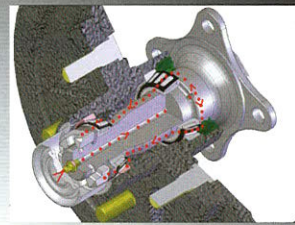
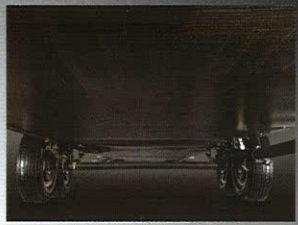

(from left to right) Folding range cover, made from countertop material, provides added countertop space • The Jalousie window keeps moisture on the outside • The 30" Radiused door makes for easy access. • Nitro Filled tires for easy towing.

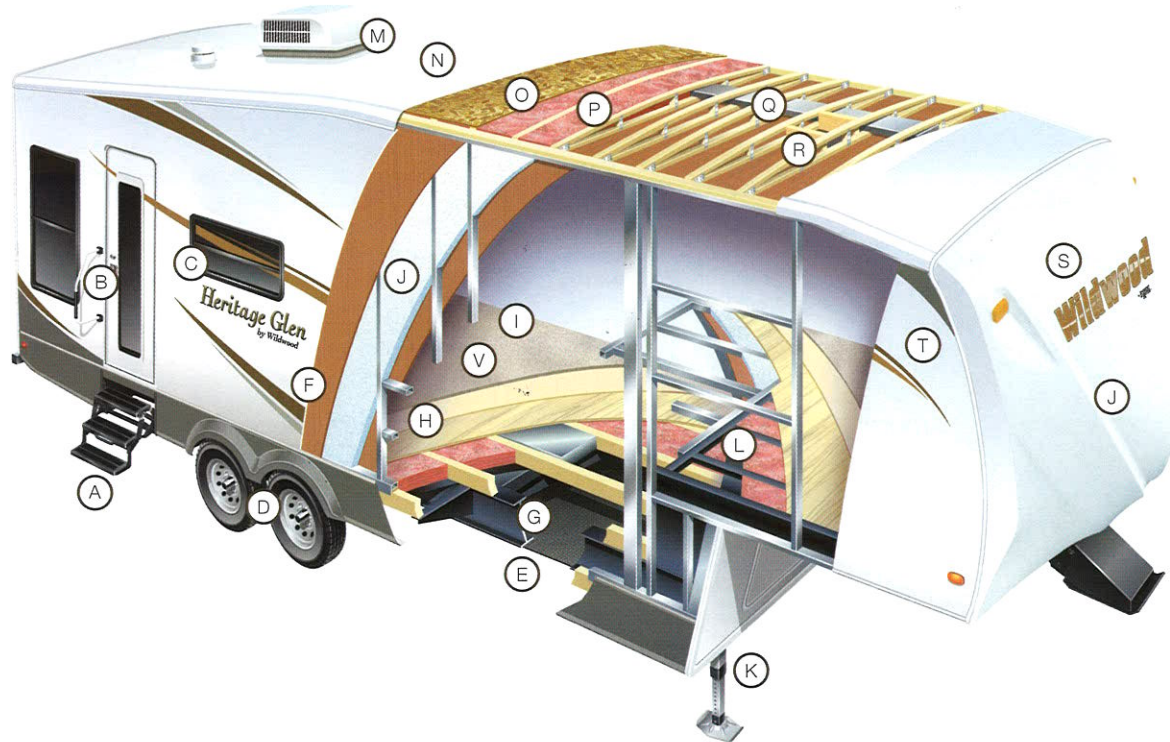

## WILDWOOD HERITAGE GLEN CONSTRUCTION

- A. Main triple entry steps
- B. Folding entry assist handle
- C. Tinted windows
- D. Ultra lube axles
- E. Heated and enclosed underbelly
- F. Laminated vacuum-bonded aluminum 2" sidewalls
- G. 10" I-beam powder-coated frame with cambered chassis
- H. 5/8" tongue & groove plywood flooring
- I. Carpet w/ padding
- J. R-9 block foam insulation
- K. Power front jacks (optional)
- L. In-Floor ducted heat
- M. Ducted 13.5 K BTU air conditioning.
- N. Seamless rubber roof (12 yr. warranty)
- O. 3/8" roof decking (full walk-on roof)
- P. R-7 fiberglass insulation floor & ceiling
- Q. Insulated duct for central air STD (all models)
- R. 5" truss roof rafters
- S. Gel coat fiberglass cap (fifth wheels only)
- T. Fiberglass exterior
- U. Hitch light
- V. Beau Flooring

## WILDWOOD HERITAGE GLEN STANDARDS, OPTIONS & INTERIOR/EXTERIOR FEATURES

### CONSTRUCTION AND EXTERIOR

- Aluminum-framed vacuum-bonded 2" laminated sidewalls
- 30" smooth fiberglass radius entry doors (26" secondary)
- Diamond plate rockguard (travel trailers)
- Swing arm entry assist handle
- Full pass through storage (per floorplan)
- Dometic™ one touch electric awning (2 yr. warranty)
- Upgraded ABS fender skirts
- EZ-Lube axles w/ 15" tires
- Powder coated I-beam frame
- Cambered chassis
- 2" x 3" floor joists 12" on center
- Water heater by-pass (fifth wheel docking station only)
- Seamless holding tanks
- Power slide-out systems (flush floor)
- 6 gal. Gas/Electric DSI water heater (2 yr. warranty)

### KITCHEN

- Dometic® double door refrigerator (2 yr. warranty)
- Deep basin stainless steel residential sink

- Sink cover (1)
- Microwave w/ carousel
- Pull-out sprayer faucet
- 3-Burner, high output range (2 yr. warranty)
- Range hood w/ 12-Volt exhaust fan and light
- Beau-Floor™ flooring
- Solid wood drawers w/ full extension ball bearing glides
- Solid wood mission style cabinet doors
- Flip-down silverware storage under sink (where applicable)
- Large overhead cabinets
- Wall-mounted systems monitor panel
- Oil rubbed bronze hardware
- Arched-Mortise & Tenon wood cabinet doors
- Knife rack (behind cooktop)
- Stove cover that extends countertop area

### LIVING ROOM

- 69" Interior slide height
- 80" Interior height (84" fifth wheels)
- 13,500 BTU ducted roof air conditioner (2 yr. warranty)
- Swivel rocker(s) (per floorplan)

- Mission style wood cabinet doors
- Flip down storage under sofa (n/a sofa hide-a-bed)
- 44" oversized dinette
- Solid wood drawers w/ full extension ball bearing glides
- Extra large 48" U-dinette (select floorplans)
- Large dinette picture window
- TV antenna and booster
- 26" LCD TV w/ DVD
- Cable TV and satellite prep
- Extra large overhead cabinets
- Decorative wall light
- 30 or 35K BTU suburban forced air DSI furnace (2 yr. warranty) w/ thermostat (per floorplan)
- In-floor heat ducting
- Drawers on each dinette base
- Night shades

### BEDROOM

- Strut lifted storage area under bed
- Oversized bunks (most models)
- Solid bedroom privacy doors (most models)
- Mirrored wardrobe w/ large drawers

### BATHROOM

- Glass shower door (neo-angle showers)
- 12-Volt power bath roof exhaust vent
- Wooden medicine cabinet w/ mirrored door
- Thetford® China foot flush toilet
- Tub surround

### SECURITY AND SAFETY

- LP leak detector
- Smoke detector
- Carbon monoxide detector
- Fire extinguisher
- Hitch light
- Amber patio light
- Welded heavy duty safety chains (travel trailers)
- Electric brakes (all wheels)
- GFI receptacles
- ANSI 119.2-certified to meet national highway traffic safety administration specifications

### POPULAR OPTIONS

- Living room ceiling paddle fan (5th wheel models)
- Roof ladder
- Safety glass tinted windows
- Extra large 8 cu. ft. double

- door refrigerator
- 15,000 BTU ducted air w/ quick cool
- Outside shower
- Double air hide-a-bed sofa
- 54" double hide-a-bed sofa (U-dinette models)
- Skylight over tub
- Slide room awning(s)
- Phone jack
- Palisades Cherry or Fulton Cherry cabinets

Contact your Wildwood dealer for a complete list of options.

(from left to right) Under sofa storage gives you extra space to put your belongings • 300# bunk rating can withstand up to 300 lbs. of weight • The Beau flooring has a woodgrain like finish and is easy to clean • Docking station



(from left to right) Self edge counter tops • Standard stainless steel sink with sprayer faucet • Toy lock • Roller bearing drawer guide makes opening and closing the drawer a snap.

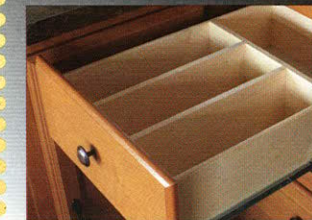
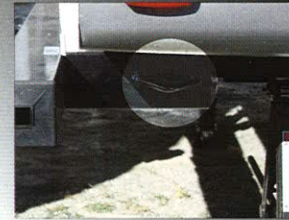

## WILDWOOD HERITAGE GLEN INTERIOR COLOR OPTIONS



Coffee interior

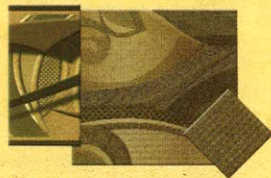

Moss interior

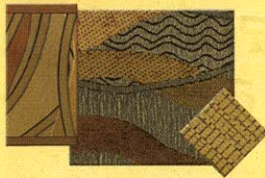

Tan interior



Wine interior



### FOREST RIVER HALLMARK OF EXCELLENCE PRE-DELIVERY INSPECTION FACILITIES



### THAT'S 20,000 SQUARE FEET OF QUALITY ASSURANCE. THE BARE ESSENTIALS FOR A PREMIUM PRODUCT.

Brought online in 2005, Forest River is proud of its state-of-the-art test facility. This beautiful building blends many of the old tried and true methods of testing our diverse types of RVs with new innovative ways of solving quality issues. Being centrally located to most Forest River manufacturing facilities, this 20,000 square foot PDI (Pre-delivery Inspection) test building gives immediate daily feedback to individual managers. This assures the production facilities that nothing has slipped by the plant's quality assurance personnel and the units are "green" and ready to ship.

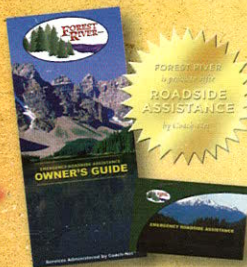

## PEACE OF MIND.

Forest River has yet another exclusive feature to offer: One year of free roadside assistance will be given to every WILDWOOD customer. This is just one more way to say "Thank you" and to ensure an enjoyable traveling experience.



Forest River, Inc.  
55470 C.R. 1  
Elkhart, IN 46514  
(574) 389-4600  
[www.forestriverinc.com/VCross](http://www.forestriverinc.com/VCross)  
[www.forestriveraccessories.com](http://www.forestriveraccessories.com)

### FOREST RIVER ENCOURAGES YOU TO BUY LOCALLY

Forest River, Inc. strongly encourages our retail customers to purchase from their local dealership whenever possible due to the following factors:

- Our dealers are as a rule, independently owned and operated businesses. Outside of those customers they personally sold products to, they are not contractually obligated to perform warranty service on Forest River products that were purchased elsewhere. There may be an occasion that you would be required to return to the point of purchase to satisfy warranty requirements.
- Although many dealerships will eventually service products not purchased at their place of business, they will usually take care of their customers and other Forest River customers who are traveling away from their local dealer as they would their own.
- Local purchases allow a customer to establish a relationship with a dealer close to home. This relationship provides the customer with a convenient location for service and support from a "home town" professional.
- The opportunity for a thorough PDI (Pre Delivery Inspection) and product orientation is an additional benefit of buying from your local dealer. Further providing the opportunity for refresher courses or the ability to get questions answered much more conveniently.
- For our Canadian customers, there are also requirements which must be met to bring an RV purchased out of the country to their home. Although not insurmountable, these requirements may involve such things as additional inspections and certifications, taxes and fees. Your local Canadian dealer is a professional at meeting these requirements.

Forest River's goal is for all RV Owners to fully enjoy their RV experience. In light of this goal, and considering the advantages of buying local, we encourage you to be thorough when determining what product to purchase and which dealer to purchase it from as both are key to your ultimate satisfaction and the realization of your dreams.

YOUR WILDWOOD DEALER

**Jerry's Trailers & Campers**  
2601 South 13th Street  
Norfolk, NE 68701  
(402) 371-1306  
[www.jerrystrailers.com](http://www.jerrystrailers.com)

All specifications contained herein are based on the latest product information at time of printing. Forest River reserves the right to make changes at any time without notice and assumes no responsibility for any errors in this brochure. PIP 041808