

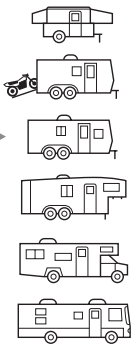

2008  
Coachmen Spirit of America®  
**Easy.**

You Work Hard All Week.  
Now Comes the Easy Part.





Spirit of America®



# It's Easy.

Easy to buy, use and enjoy, Spirit of America lets you spend more time enjoying the great outdoors and less time working at it. With an array of floorplans priced to fit your budget, it's easy to choose the one that fits your needs and your tow vehicle. 🐾 Since they're designed and built by Coachmen you know they feature loads of storage space and standard equipment that's often optional on competing models. 🐾 And, they're backed up by Coachmen's no hassle warranty. Spirit of America – the easy winner!



🐾 Spacious interiors, lots of residential amenities and easy to use features are hallmarks of the Spirit of America. Seen here on the 29RKS are a flush floor slide room, modern kitchen area, residential window treatments (including mini blinds and designer box valences), and two comfortable swivel chairs. Spirit of America also offers extra wide dinette booths and a full 81-inch tall interior ceiling height so you can stand tall. And with several bunk bed floorplans available it is definitely family friendly.



Spirit of America SE  
Spirit of America Lite  
Spirit of America Superslide

## Features that matter.



### EASY STORAGE

In the Spirit of America the easy life is right at your fingertips. Its generous pass through exterior storage bay (on most models) and the lift up queen bed storage area hold enough gear for a weekend at the campground or a week in the Rockies.



### EASY ENTERTAINMENT

After a hard day's fun, you and your family can kick back and relax with the Dolby® Digital 5.1 surround system with DVD/CD player (most models) or watch your favorite shows on the 20 inch LCD television (available in superslide models).



Talk about easy living convenience!



Visit our website anytime at [www.easyRVing.com](http://www.easyRVing.com)  
for more information, and easy shopping tools like



- Finding the right Coachmen for you.
- Comparing different Coachmen models.
- Building your own RV.

# Coachmen

AT COACHMEN, we're all about easy. Our motorhomes, fifth wheels, travel trailers and folding campers are designed to be easy to use, easy to enjoy, easy to own. And our no hassle warranty keeps them that way.

## Easy to Use. Really.

Pete, the Coachmen mascot, symbolizes our commitment to being your best friend on the road. Like Pete, we're always there to make sure everything about your Coachmen is as easy and uncomplicated as possible, so you can escape from the hassles and worries of everyday life and enjoy RVing.

Your Coachmen will be easy to buy, easy to use and easy to own. That's our promise to you. We accomplish this in big ways through clever designs and superior support after the sale. But the real measure of being "easy" is in the countless thoughtful touches we include throughout your new

Coachmen RV. As you review this brochure please check out Pete's paw print symbols that indicate many of our easy touches.

Remember, no matter where the road takes you, the going is always easier with Coachmen.



## Easy to Enjoy. Honest.

When you go RVing, there's one thing you should always leave behind: worry.

At Coachmen, our *no hassle warranty* is our commitment to you, to assure your ongoing satisfaction. This no hassle warranty means that we won't refer you back to some supplier you've never heard of. We won't bounce you back and forth between the dealership and the factory. Our dealers are authorized to solve your problems on

the spot and get you on your way without fuss, hassle or red tape.

Also, should you ever need service or repair; it is easy to find one of the hundreds of Coachmen dealers or authorized repair centers nationwide.

We take pride in working with you to keep your RV experience as enjoyable as possible. Our toll-free service hotline (1-800-453-6064) and online service support center (located at [easyRVing.com](http://easyRVing.com)) provide you access to a Coachmen

service representative as well as access to warranty coverage information, maintenance information, troubleshooting tips, dealer locations and other helpful information on demand. We're with you every step of the way. Coachmen. You couldn't ask for an easier traveling companion.

To see how Coachmen is making the easy life even easier, visit [www.easyRVing.com](http://www.easyRVing.com) or call 1.800.353.7383.

All information contained in this brochure is believed to be accurate at the time of publication. However, during the model year, it may be necessary to make revisions and Coachmen reserves the right to make all such changes without notice, including changes in prices, colors, materials, equipment and specifications, as well as the addition of new models and the discontinuance of models shown in this brochure. Therefore, please consult with your Coachmen dealer and confirm the existence of any materials, design or specifications that are material to your purchase decision.

COA-22 06.07 Printed in USA



Coachmen Recreational Vehicle Company, LLC  
P.O. Box 30, Middlebury, IN 46540





# 2008 Coachmen Spirit of America<sup>®</sup> Easy.

You Work Hard All Week.  
Now Comes the Easy Part.



From kitchen to living area to bedroom there's luxurious living and lots of storage space. The fully equipped galley sports all the important amenities of home, the slideout room increases living space and the innerspring mattress and down comforter create a warm and comfortable bedroom. From the front to back this 26RKS with Spicy Oak cabinetry is easy to like.

## Decor Choices

**FABRIC KEY**  
A. Main B. Accent C. Bedspread  
Coachmen's dazzling interiors feature top-grade fabrics that have been tested for maximum durability.

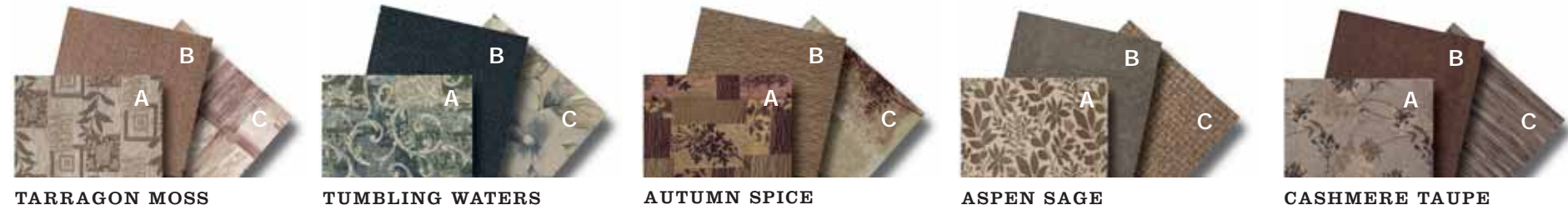

## Easy Features

	SE	LT	SS		SE	LT	SS		SE	LT	SS		SE	LT	SS
<b>LIVING APPOINTMENTS</b>															
Spicy oak cabinetry	S	S	S						S	S	S				
Hardwood mortise and tenon cabinet doors	S	S	S						S	S	S				
Raised panel cabinet doors in kitchen area	-	S	S						S	S	S				
Residential metal drawer guides	-	S	S						S	S	S				
Silverware drawer (most floorplans)	-	S	S						S	S	S				
Seamless edge countertops	S	S	S						S	S	S				
Wallpaper border	S	S	S						S	S	S				
Designer window treatments	S	S	S						S	S	S				
Mini blind window coverings	S	S	S						S	S	S				
Carpet in bedroom	-	-	-						S	S	S				
Linoleum flooring in kitchen and bath area	-	-	-						S	S	S				
Linoleum flooring throughout	S	S	S						S	S	S				
Booth dinette with pedestal table	S	S	S						S	S	S				
Jack-knife sofa (where applicable)	S	S	S						S	S	S				
<b>SLEEPING APPOINTMENTS</b>															
Sleep Easy package:	-	-	O												
Pillow top mattress in master suite,															
Sofa with inflatable hide-a-bed	-	S	S												
Innerspring mattress	-	S	S												
Pillows and down comforter	-	S	S												
Lift up bed storage	-	S	S												
<b>APPLIANCES AND ACCESSORIES</b>															
Three-burner range with oven	S	S	S												
Power and lighted range hood	S	S	S												

	Spirit of America SE				Spirit of America Lite (LT)				Spirit of America SuperSlide (SS)					
Specifications	17RDQ	19FLB	24TBQ	24RBQ	24RBQS	26RKS	26DBD	27RBS	28RLS	28DSB	29RKS	31DSB	32BHS	38DSB
Base weight	3,145	3,644	4,228	4,029	4,190	4,684	4,522	5,647†	5,869	6,032	6,043	6,794	6,449†	7,309
Carrying capacity	1,855	2,356	1,921	2,001	3,270	2,916	2,478	3,083†	2,891	2,878	2,747	3,706	3,451†	3,191
Hitch weight	383	627	549	430	460	600	610	730†	760	910	790	909	800†	931
Interior height	81"	81"	81"	81"	81"	81"	81"	81"	81"	81"	81"	81"	81"	81"
Exterior height (includes A/C)	10'6"	10'6"	10'6"	10'6"	10'6"	10'6"	10'6"	11'0"	11'0"	11'2"	11'0"	11'2"	11'0"	11'2"
Exterior length	19'5"	23'8"	26'7"	25'9"	26'2"	27'6"	30'4"	30'3"	30'2"	29'10"	31'7"	34'7"	34'7"	37'6"
Exterior width	8'	8'	8'	8'	8'	8'	8'	8'	8'	8'	8'	8'	8'	8'
Awning length	12'	16'	16'	16'	16'	18'	16'	16'	16'	12'	16'	16'	16'	21'
Sleeping capacity	4	6	6	5	5	8	8	5	5	7	5	8	11	6/8/10
Exterior storage capacity (cu. ft.)	44	44	51	51	51	51	77	51	51	51	51	84	157	51
Fresh water capacity (gal.)	36	36	36	36	36	36	36	36	36	36	36	36	36	36
Waste water capacity (gal.)	30	30	30	30	30	30	30	30	30	30	30	30	30	30
Grey water capacity (gal.)	27	27	27	27	27	30	27	30	30	57	60	30	27	30
Tire size	X	X	X	X	X	X	X	■	■	■	■	■	■	■

† = Estimated X = ST205/75D14C ■ = ST225/75D15D  
**Base Weight:** The weight of the unit with no fluids, cargo, equipment or accessories - **Carrying Capacity:** This is the amount of weight available for all fluids, cargo, optional equipment and accessories. The actual "loaded" weight will depend on the owner's individual choice of cargo, etc.



## EASY SLEEPING

For comfort, the Sleep Easy package includes a pillow top mattress in the master suite and for guests, the upgraded sofa houses an inflatable and comfortable full size hide-a-bed with built-in 12-volt/110 volt pump (optional on SuperSlide models).



Because your nights should be as easy as your days, from the innerspring mattress to designer down comforter and pillows, the master bedroom feels like home. And there's plenty of storage in the cabinets above the bed.



## Spirit of America SE — Easy Living Floorplans

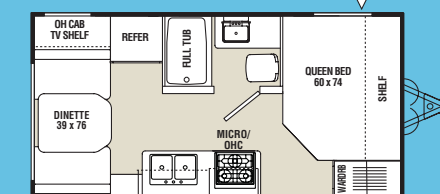

17RDQ | Base Weight: 3,145 | Sleeps 4

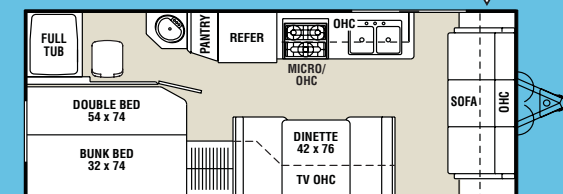

19FLB | Base Weight: 3,644 | Sleeps 6

## Spirit of America Lite (LT) — Easy Living Floorplans

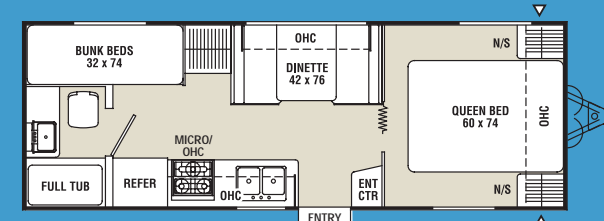

24TBQ | Base Weight: 4,228 | Sleeps 6

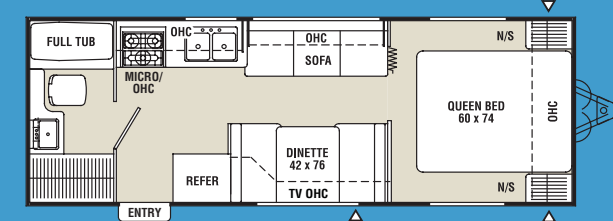

24RBQ | Base Weight: 4,029 | Sleeps 5

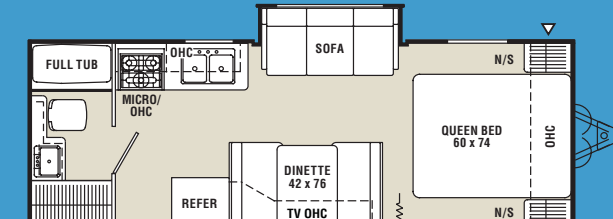

24RBQS | Base Weight: 4,190 | Sleeps 5

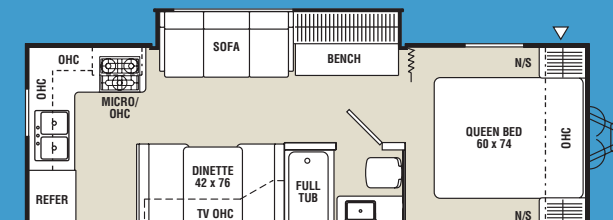

26RKS | Base Weight: 4,684 | Sleeps 5

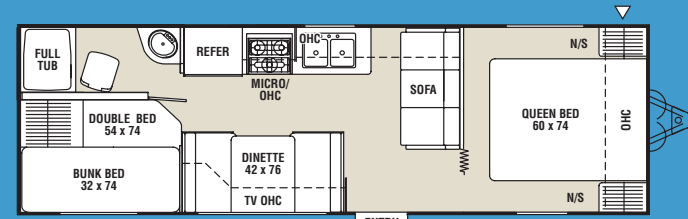

26DBD | Base Weight: 4,522 | Sleeps 8



## Spirit of America SuperSlide (SS) — Easy Living Floorplans

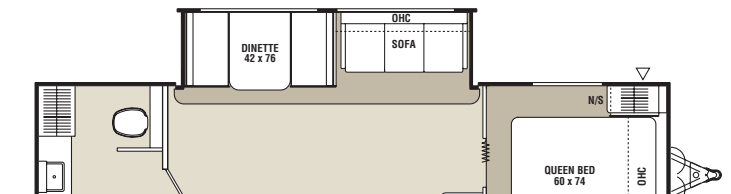

27RBS | Base Weight: 5,649† | Sleeps 5

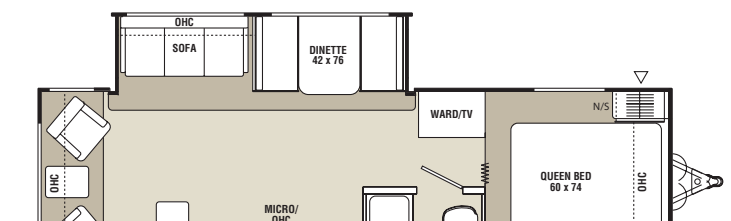

28RLS | Base Weight: 5,869 | Sleeps 5

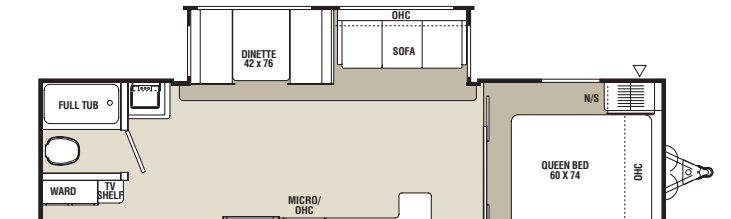

28DSB | Base Weight: 6,032 | Sleeps 7

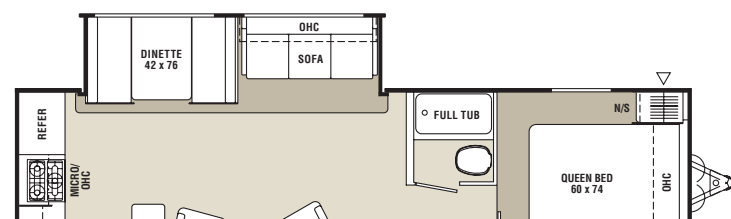

29RKS | Base Weight: 6,043 | Sleeps 5

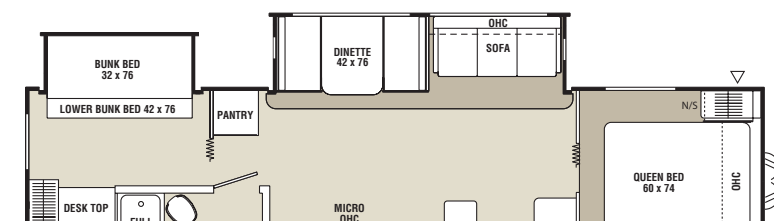

31DSB | Base Weight: 6,794 | Sleeps 8

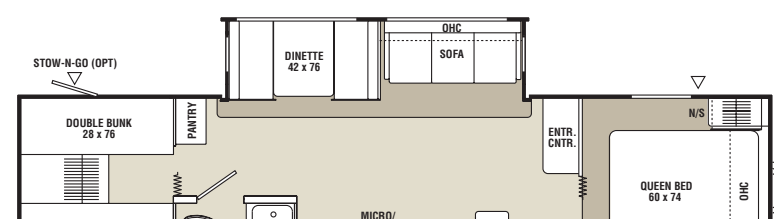

32BHS | Base Weight: 6,449† | Sleeps 11

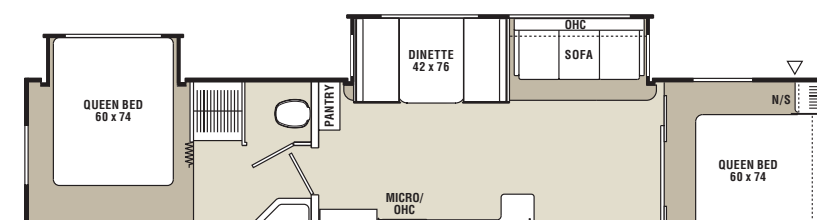

38DSB | Base Weight: 7,309 | Sleeps 6/8/10

