





The new fiberglass cap and towing diamond plate rock guard make the Sierra very attractive. The recreation-light is conveniently located under the awning for optimal nighttime use. Ultra-lube axles make maintenance a breeze.

OPEN. BEAUTIFUL.

(Above) The open floorplan for the kitchen of the 301BHD is intentionally designed with plenty of room to prepare your meals. The upper and lower, raised panel cabinet doors are made of solid oak and bring the touches of home on the road. It's residential comfort at your fingertips.

FIRST-CLASS TREATMENT.

(Right) Welcome to the "No more rainy days" room. Everything you need to occupy your time can be found right here in the rear bunk bedroom. The entertainment center and storage areas provide ample room to bring anything you'd want from home on the road.



LET THE OUTDOORS IN.

This Sierra campaign provides larger windows than the competition to make your camping experience more connected with nature. So pull up the blinds and enjoy the outdoors. It's vacation.



301BHD: TAN

Crash-out on the residential hide-a-bed sofa for the night. It comes complete with wooden accent feet, decorative throw pillows with accent fabric and fringe. Turn down the lights and watch a movie. The 100-watt in-line filter and 8-speaker surround sound of the Home Theatre System will bring the screen to life. The optional glider recliner (Right) is a comfortable captain's chair for your enjoyment.





335 RLT KITCHEN: STONE INTERIOR



SLIDING PANTRY RACK

Above: The sliding pantry comes complete with 8 baskets that are fully adjustable to fit all food options. Full-extension ball bearings provide a smooth slide and the pantry comes with a travel lock built-in.

THE KITCHEN FOR KINGS.

The 335 RLT kitchen is designed to have everything you need within arms reach to prepare your meals with ease. As a result, the microwave is intentionally placed lower, the kitchen counter light brings your ingredients into view. The optional six-panel raised refrigerator insert matches the oak cabinetry and completes the package.

335 RLT 5TH WHEEL

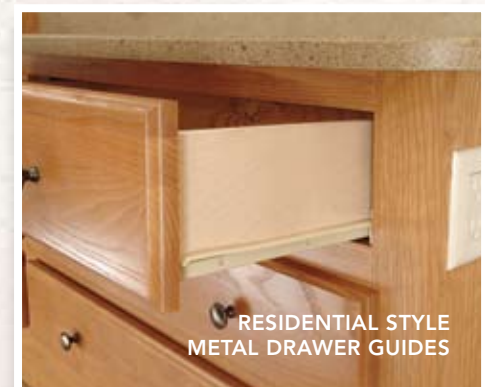

RESIDENTIAL STYLE METAL DRAWER GUIDES

BEAUTIFUL INTERIORS.

Sierra's "Let the Outdoors in Campaign" sets the stage for the 335RLT's luxurious home away from home living room. This is truly the depiction of craftsmanship, layout and comfort combined to enhance and stimulate every sense. Welcome to the new 2006 Sierra.



335RLT SPACIOUS BEDROOM



ABUNDANT DINING WITH ATRIUM WINDOW



335RLT LIVING ROOM: STONE



SPACIOUS LAVATORY

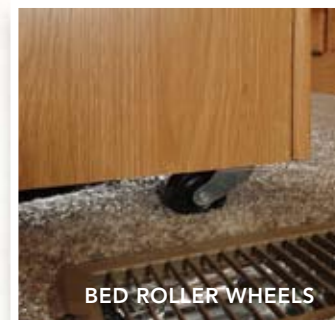

BED ROLLER WHEELS



(Left) Bring it all. The pass-thru storage compartment provides the space you need to bring all the gear you want. No pipes, wires, vents or drains to impede your storage area – Just a clean, felted travelable storage compartment. Access to the laundry chute is convenient and gives plenty of room for more.



ALUMINUM WHEELS



LP HUB-GAS STATION



LIGHTED ENTRY STEP



285RG LIVING ROOM: Sage Interior

CRAFTSMANSHIP.

Pull up a chair and stay awhile. Spend the evening catching up in the intimate conversation area while getting the evenings meal together. The rear kitchen is close at hand but secluded and creates a comfortable open floor plan for this rear galley model.

285 5TH WHEEL



285RG LIVING ROOM: SAGE INTERIOR

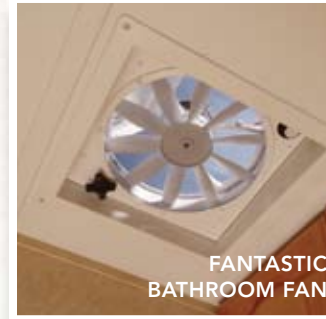

FANTASTIC
BATHROOM FAN



SANITARY FOOT
FLUSH TOILET

IT'S IN THE DETAILS.

The intimate conversation area is enhanced by the entertainment center with a full 100-watt home theatre hook-up. (Right) The bedroom stocks two large wardrobes and underbed storage to give plenty of room for your trip. No space is wasted.



285RL BEDROOM: MAUVE INTERIOR



WASHER/DRYER PREP

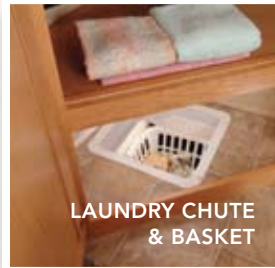

LAUNDRY CHUTE
& BASKET



CLEAR SKYLIGHT



RESIDENTIAL-STYLE
PADDLE FAN

Little details go a long way. The residential-style paddle fan brings additional circulation to enhance your heat or air-conditioning.



PASS-THRU STORAGE



305 RLW LIVING ROOM: MAUVE INTERIOR



SIERRA HIGH-PROFILE FIFTH WHEEL

Invite your neighbors to dinner. The dining room table comes with a generous dining area providing ample space for guests. Retire to the living area and catch up on old times in the comfortable conversation area. You'll feel right at home.

305 5TH WHEEL

The smooth fiberglass exterior and the new upgraded exterior graphics are just a few of the features you will enjoy.



SOLID OAK WOODWORK.

This is America's number one floorplan by choice. The ample kitchen space provides the room you need to make meals with ease. The upper and lower cabinets are glued and screwed with premium lumber-core cabinetry and topped off with solid oak framework, raised panel doors and drawers.



Details are important, and we have tried to think of everything. Hidden behind cabinet doors, even the trash can has a holder to keep it in place on the road.



Move mountains with ease. The Sierra Power Tower (hydraulic pump and battery) is more efficient and smoother than the ordinary electric slide-out mechanism. The manual override, on all Fifth wheels, is easily accessible and user-friendly.

SIERRA FEATURES AND OPTIONS

COMFORT

- Four color coordinated interiors
- 44" dinette seats
- Living Room Ceiling paddle fan
- Interior light package upgrade
- 30" radius primary entrance door, 26" secondary
- Residential style, innerspring mattress upgrade
- Jalousie windows (Crank out)
- Fantastic vent bathroom fan
- Free standing swivel rocker (per floorplan)
- Dometic 13,500 BTU central air conditioner w/quick cool feature
- Throw pillows w/ accent fringe
- Vented side windows in slideouts
- Night Shades
- 35,000 BTU Furnace

CONVENIENCE

- Skylight over tub
- 6 gal. gas/electric DSI water heater
- Built-in medicine cabinet & mirror in bath
- Large Dometic® double door refrigerator
- TV antenna w/booster
- 100-watt Surround sound TV hook-up
- Lift-up beds w/gas struts (per floorplan)
- Range cover
- 60/40 split acrylic sink
- Single lever faucet
- Two plastic sink covers
- 30 lb. double LP tanks w/auto changeover
- Rear bumper w/sewer hose carrier
- Chrome bumper cover
- Hitch light
- Porch light w/interior switch
- Lighted main entry step (Extra low first step)
- Interior access door under dinette
- Pots and pans drawer under dinette
- Solid oak drawer fronts w/pine sides
- Magic Chef three burner high output range w/ 22" oven
- Mortise & tenon solid oak framed raised panel cabinet doors
- Solid oak slideout fascia
- Neo-angle shower w/glass door

(where available)

- Extra large picture window at dinette
- Triple step w/ 9" riser
- Microwave w/ carousel
- Satellite prep
- Cable hook-up
- Laundry chute (5th wheel floorplans)
- Overhead cabinets in slideout with etched glass inserts

CONSTRUCTION

- Aluminum-framed, vacuum-bonded laminated sidewalls
- Fiberglass front cap
- Ultra-lube axles
- Stabilizer jacks
- Power front jacks (5th wheel floorplans)
- Fully enclosed underbelly with radiant heat
- Laminated bath deck
- Large exterior storage sofa
- Roto-cast holding tanks
- A & E 8500 series side awning
- 5/8" plywood tongue & groove floor decking
- 5" truss roof rafters
- 3/8" roof decking (entire roof)
- 2" x 3" floor joists 12" on center

- R-9 insulation in floors and ceilings
- R-10 sidewall insulation
- Tinted, clamp-ring windows
- Finished interior bed bases
- Rolled side metal
- Powder coated frame

SECURITY & SAFETY

- Flush door latch w/integral deadbolt lock
- Screen door w/safety latch
- Smoke detector
- Fire extinguisher
- LP leak detector
- Four (4) Electric brakes
- GFI receptacle - kitchen, bath, and outside receptacles
- Safety chains (trailers)

PROTECTION

- Gel-coated exterior fiberglass
- Awning drip rail w/downspout
- Fiberglass entry and baggage doors
- Water heater by-pass
- Seamless rubber roofing with 12-year warranty
- Full walk-on roof

POPULAR OPTIONS

- Sofa hide-a-bed (slideouts only)
- Spare tire, carrier and cover
- Outside shower
- Extra large double door refrigerator
- Raised refrigerator door oak insert
- Small exterior storage dinette
- Bar stools
- Second drawer under dinette
- Phone jack
- Aluminum wheels
- Roof ladder
- Free-standing dinette with 4 chairs
- Glider recliner IPO swivel rocker
- 15K Air conditioner IPO 13.5K
- Water heater 10 gal. gas/electric DSI
- Day/Night shades
- Washer/Dryer prep w/ 50 amp service
- "Arctic Pac" heated holding tanks
- Two (2) Exterior speakers
- Atrium window
- Slide-room awning(s)
- Four bunk option (per floorplan)
- Black tank flush
- Second air conditioner
- Chrome hub cap and ring
- King bed (where applicable)
- Fantastic vent fan with wall switch



Sierra's construction features an aluminum framed superstructure that is lighter and more durable than the competitors wood frame.



CONSTRUCTION

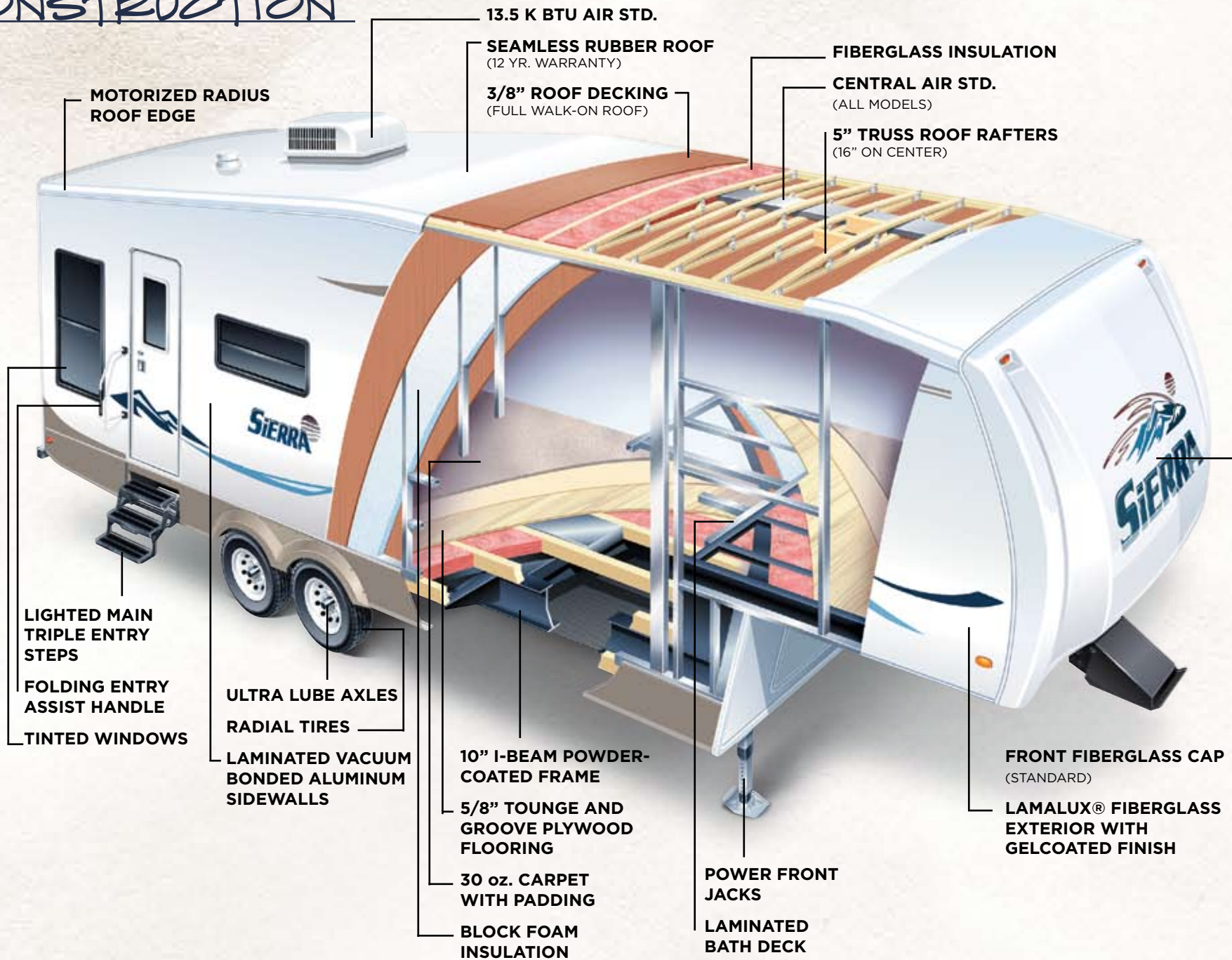

MOTORIZED RADIUS ROOF EDGE

13.5 K BTU AIR STD.

SEAMLESS RUBBER ROOF
(12 YR. WARRANTY)

3/8" ROOF DECKING
(FULL WALK-ON ROOF)

FIBERGLASS INSULATION

CENTRAL AIR STD.
(ALL MODELS)

5" TRUSS ROOF RAFTERS
(16" ON CENTER)

LIGHTED MAIN TRIPLE ENTRY STEPS

FOLDING ENTRY ASSIST HANDLE

TINTED WINDOWS

ULTRA LUBE AXLES
RADIAL TIRES

LAMINATED VACUUM BONDED ALUMINUM SIDEWALLS

10" I-BEAM POWDER-COATED FRAME

5/8" TONGUE AND GROOVE PLYWOOD FLOORING

30 oz. CARPET WITH PADDING

BLOCK FOAM INSULATION

POWER FRONT JACKS

LAMINATED BATH DECK

FRONT FIBERGLASS CAP
(STANDARD)

LAMALUX® FIBERGLASS EXTERIOR WITH GELCOATED FINISH

TRAVEL TRAILERS

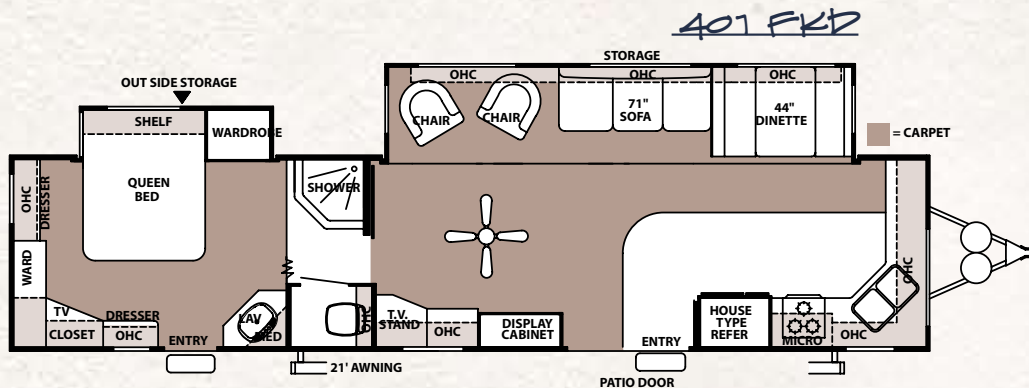
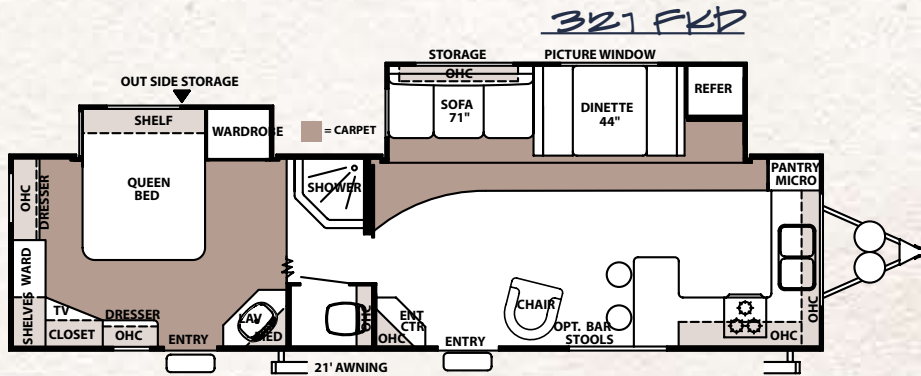
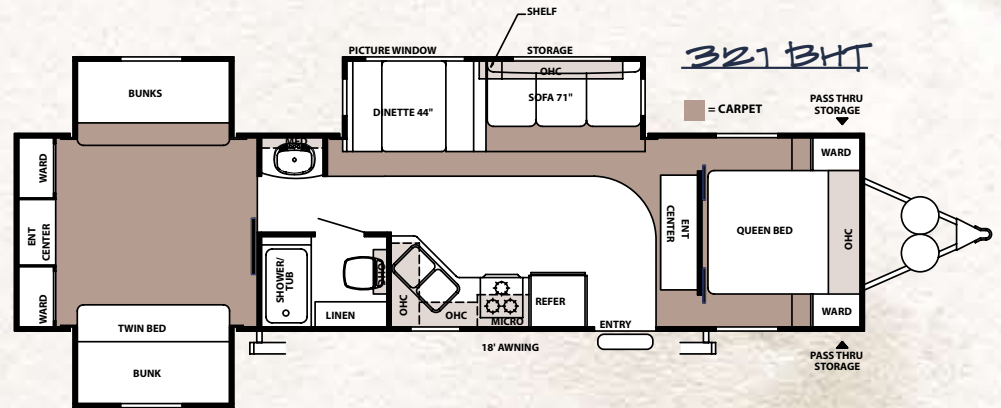
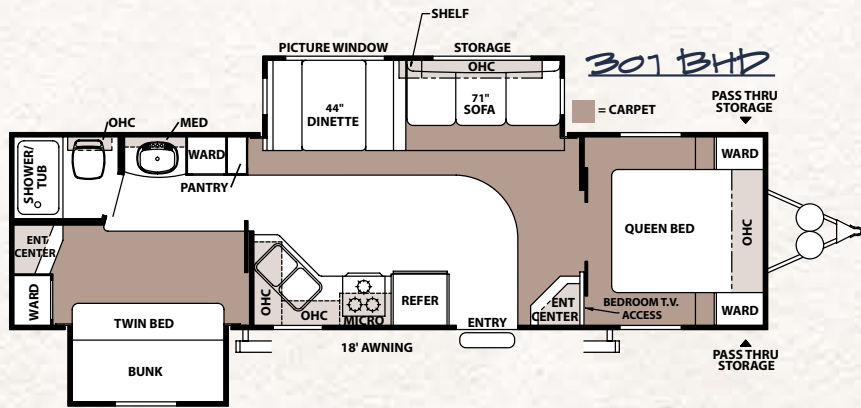

TRAVEL TRAILER SPECIFICATIONS

| Model | 301BHD | 321FKD | 321BHT | 341RLD | 401FKD |
|------------------|---------|--------|--------|---------|--------|
| Hitch weight | 750 | TBA | TBA | 1,040 | TBA |
| Axle weight | 7,220 | TBA | TBA | 7,770 | TBA |
| Ship weight* | 7,970 | TBA | TBA | 8,810 | TBA |
| GVWR | 10,910 | TBA | TBA | 11,200 | TBA |
| Exterior Length | 34' 8" | TBA | TBA | 33'9" | TBA |
| Exterior Height | 11' | TBA | TBA | 11'5" | TBA |
| Awning | 18' | TBA | TBA | 21' | TBA |
| Gray Water Cap. | 54 Gal. | TBA | TBA | 30 Gal. | TBA |
| Black Water Cap. | 30 Gal. | TBA | TBA | 27 Gal. | TBA |
| Fresh Water Cap. | 48 Gal. | TBA | TBA | 48 Gal. | TBA |

* Ship weights do not include options. "TBA" Not available at time of printing. Model number does not necessarily reflect the overall length of a particular unit.

MID-PROFILE FIFTH WHEELS

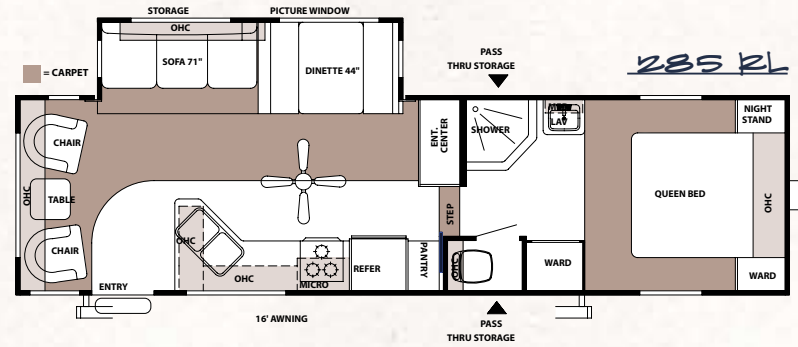
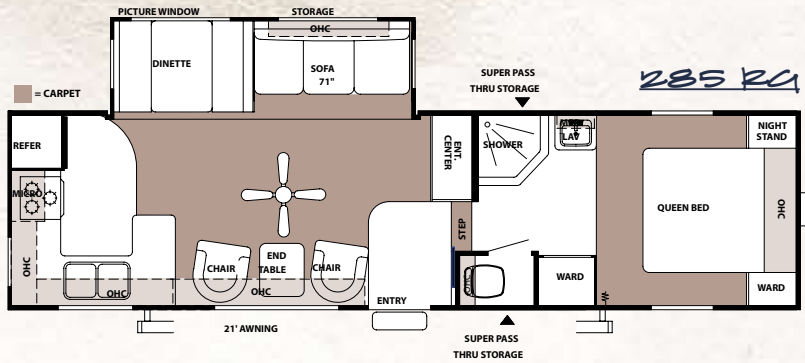

SPECIFICATIONS

| | | |
|------------------|---------|---------|
| Model Number | 285RG | 285RL |
| Hitch weight | 1,460 | 1,920 |
| Axle weight | 6,390 | 6,370 |
| Ship weight | 7,850 | 8,290 |
| GVWR | 11,620 | 12,080 |
| Exterior Length | 32' | 32' |
| Exterior Height | 12'6" | 12'6" |
| Awning | 21' | 16' |
| Gray Water Cap. | 80 Gal. | 50 Gal. |
| Black Water Cap. | 50 Gal. | 50 Gal. |
| Fresh Water Cap. | 48 Gal. | 48 Gal. |

* Ship weights do not include options. "TBA" Not available at time of printing. Model number does not necessarily reflect the overall length of a particular unit.

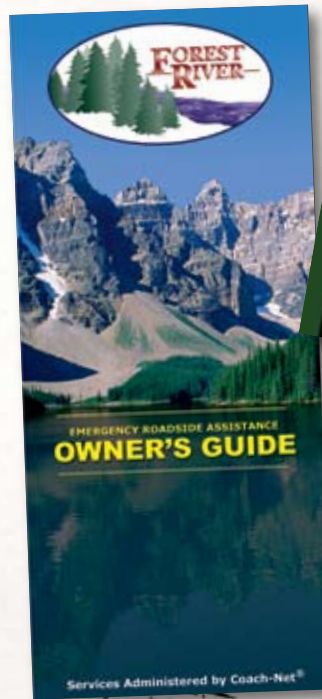

Forest River, Inc., in affiliation with Coach-Net®, is providing one (1) year of free Roadside Assistance to all retail purchasers of new Sierra 2006 Travel Trailers and Fifth Wheels. This is just one more way to say "Thank You" and to ensure you have an enjoyable camping experience.



HIGH-PROFILE FIFTH WHEELS

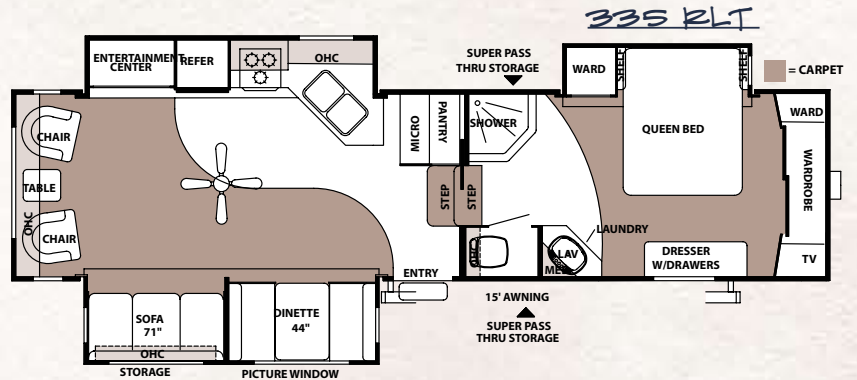
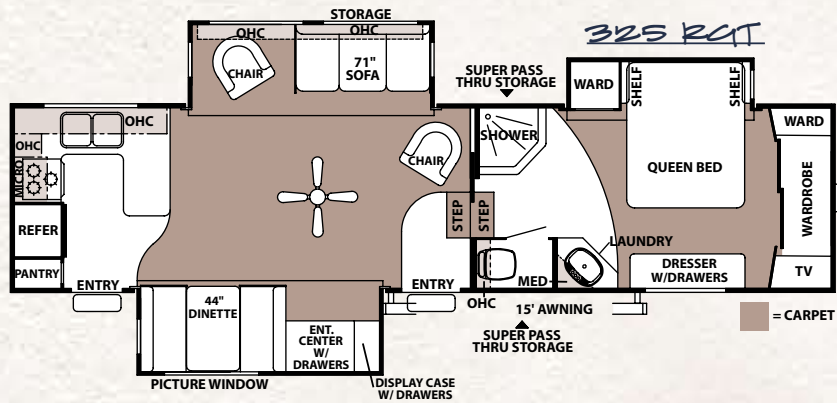
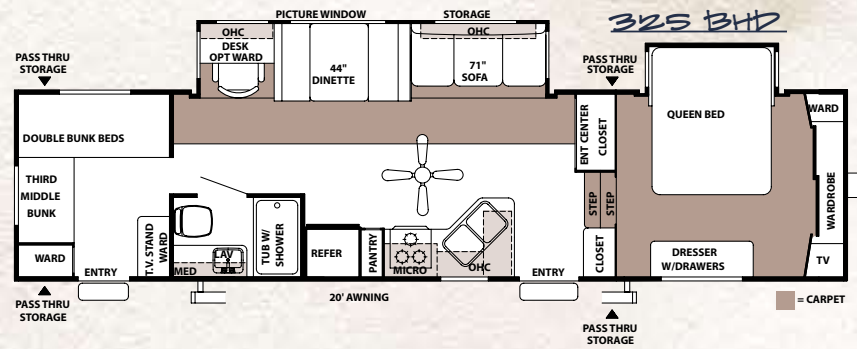
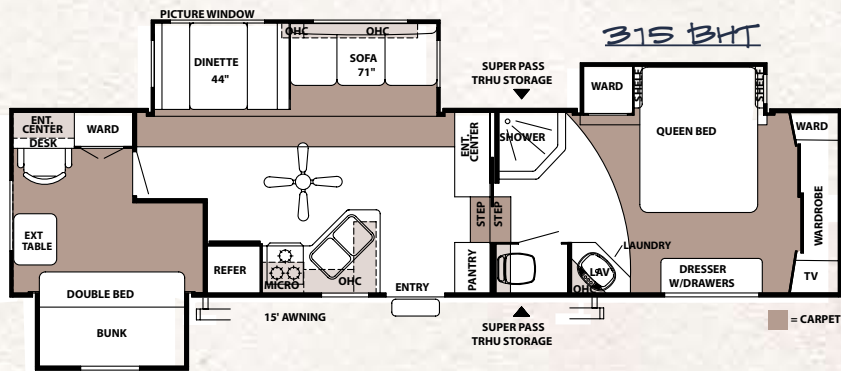
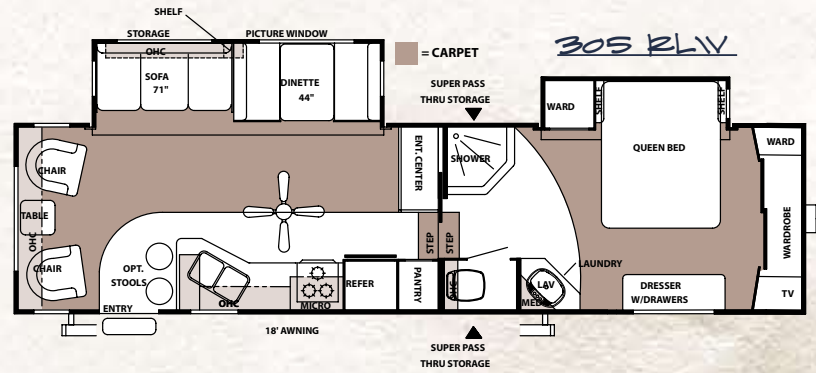
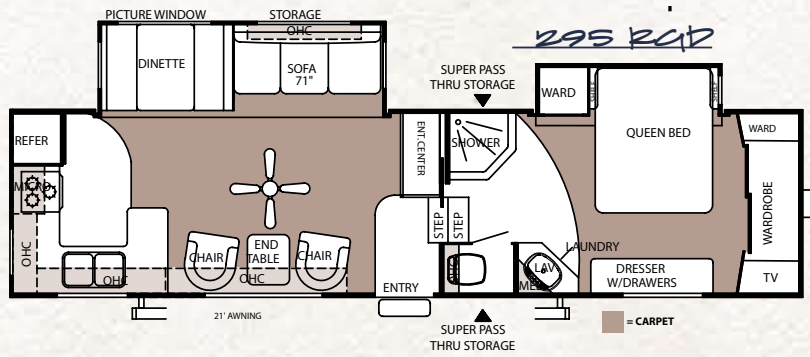

HIGH-PROFILE FIFTH WHEELS CONTINUED

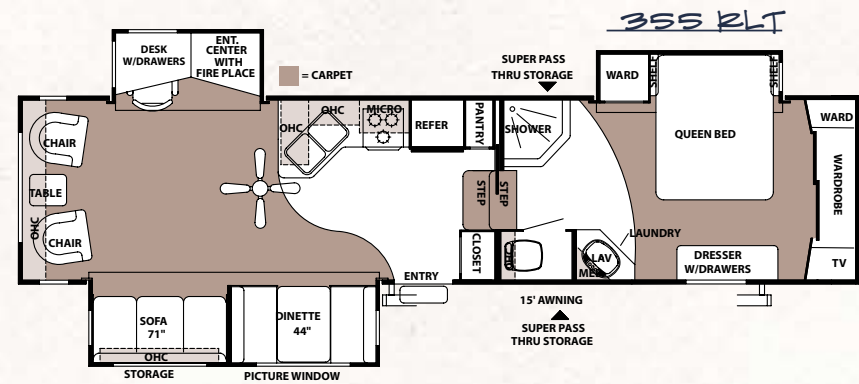
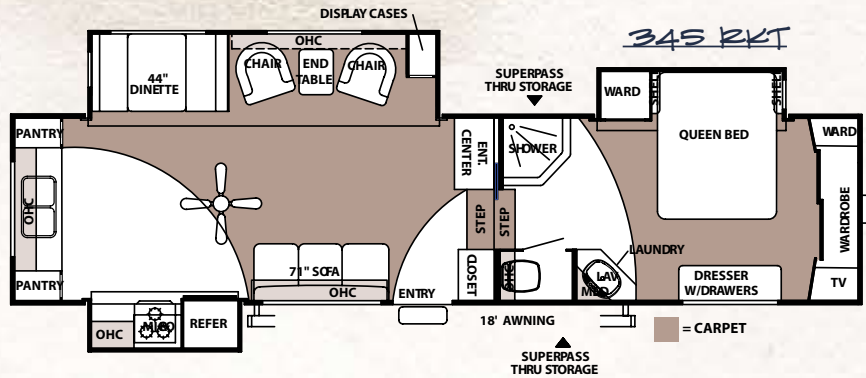

SPECIFICATIONS

| Model Number | 295RGD | 305RLW | 315BHT | 325BHD | 325RGT | 335RLT | 345RKT | 355RLT |
|------------------|---------|---------|---------|---------|---------|---------|---------|----------|
| Hitch weight | 1,920 | 2,230 | 2,170 | 2,010 | 2,080 | 2,320 | 2,150 | 2,170 |
| Axle weight | 7,890 | 6,990 | 8,440 | 8,000 | 8,360 | 8,550 | 9,160 | 8,010 |
| Ship weight | 9,810 | 9,220 | 10,610 | 10,010 | 10,440 | 10,870 | 11,310 | 10,180 |
| GVWR | 13,920 | 14,230 | 14,170 | 14,010 | 14,080 | 14,320 | 14,150 | 14,170 |
| Exterior Length | 35' | 34' | 35'9" | 35' 10" | 35' 11" | 37' | 39' 5" | 37' |
| Exterior Height | 12'8" | 12'8" | 12'8" | 13'2" | 12'8" | 12'8" | 13'4" | 13'4" |
| Awning | 21' | 18' | 15' | 20' | 15' | 15' | 15' | 15' |
| Gray Water Cap. | 87 Gal. | 50 Gal. | 77 Gal. | 80 Gal. | 80 Gal. | 80 Gal. | 80 Gal. | 100 Gal. |
| Black Water Cap. | 50 Gal. | 50 Gal. | 50 Gal. | 50 Gal. | 50 Gal. | 50 Gal. | 50 Gal. | 50 Gal. |
| Fresh Water Cap. | 61 Gal. | 61 Gal. | 51 Gal. | 61 Gal. | 61 Gal. | 61 Gal. | 61 Gal. | 61 Gal. |

* Ship weights do not include options. "TBA" Not available at time of printing.
Model number does not necessarily reflect the overall length of a particular unit.

KING BED OPTION

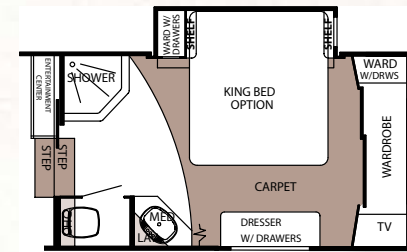

King Bed Optional in Travel Trailers & High Profile Fifth Wheels with 100" Bed Slides.



Sierra's construction features an aluminum framed superstructure that is lighter and more durable than the competitors wood frame.



MY RV CHECKLIST.

| Item | Sierra | Brand X | Brand Y |
|---|--------|---------|---------|
| Exterior Highlights | | | |
| ALUMINUM - Vacuum Bonded Super Structure | yes | _____ | _____ |
| Gel-coated Fiberglass Exterior | yes | _____ | _____ |
| Ultra Lube Axles (Easiest Maintenance Available) | yes | _____ | _____ |
| 16" Radial Tires w/ 6000# Axles (High Pro F.W.) | yes | _____ | _____ |
| 15" Radial Tires w/ 5200# Axles (Mids & Trailers) | yes | _____ | _____ |
| 10" I-Beam Frame with Mig Welded Outriggers | yes | _____ | _____ |
| Fully Enclosed Underbelly (with Radiant Heat) | yes | _____ | _____ |
| Lighted Entry Steps (9" Hickory Spring Steps) | yes | _____ | _____ |
| Folding Grab Handle at Entry Door | yes | _____ | _____ |
| Unobstructed , 130 cu. ft. of Pass-Through Storage | yes | _____ | _____ |
| Aero-Dynamic, Fiberglass Front Cap | yes | _____ | _____ |
| Motorized "Class A Style" Radius Roof | yes | _____ | _____ |
| Full Walk-on Roof Decking (Front to Back) | yes | _____ | _____ |
| 80/20 Tinted Windows (Tint Filters 80% of UV Rays) | yes | _____ | _____ |
| Recreation Light Under Awning for Optimal Lighting | yes | _____ | _____ |
| 2 - Marine Grade Exterior Speakers (optional) | yes | _____ | _____ |
| Interior Highlights | | | |
| 100% Water Purifying System (Full System) | yes | _____ | _____ |
| 100-Watt, Eight (8) Speaker Home Theater System | yes | _____ | _____ |
| Lumber-core, Glued & Screwed Cabinetry | yes | _____ | _____ |
| Raised Panel (Upper & Lower) Cabinet Doors | yes | _____ | _____ |
| Metal Drawer Glides (Throughout) | yes | _____ | _____ |
| 5/8", Tongue & Groove PLYWOOD Flooring | yes | _____ | _____ |
| F.W. LAMINATED Bath Deck (Superior Strength & Insulation) | yes | _____ | _____ |
| Foot Flush Toilet (For Sanitary Bathroom Use) | yes | _____ | _____ |
| 100" Bedroom Slide-out with Wardrobe (Per Floorplan) | yes | _____ | _____ |
| 35,000 BTU Furnace (Every Floorplan T.T. & F.W.) | yes | _____ | _____ |
| King Bed Optional (Per Floorplan) | yes | _____ | _____ |
| 6'4" Main Slide-out height (F.W.) | yes | _____ | _____ |
| Skylight over Tub | yes | _____ | _____ |
| Single Lever Faucet | yes | _____ | _____ |



COMPLIMENTS OF

Forest River, Inc. 55470 CR 1 Elkhart, IN 46515-3030
 Phone: 574.533.5934 Fax: 574.533.2965
www.forestriverinc.com www.forestriveraccessories.com



All illustrations and specifications contained in this literature are based on the latest product information at time of publication. Forest River reserves the right to make changes in prices, colors, materials, equipment and specifications at anytime without notice and assumes no responsibility for any error in this literature. All units are shipped FOB, Goshen, Indiana.
 CONSULT YOUR LOCAL DEALER FOR WARRANTY INFORMATION.