

DURANGO™

Fifth Wheels
and Travel Trailers

by K-Z



*Make Every Day
an Adventure!*

FRONTIER

ESCALADE

MONTEGO BAY

SPORTSTER

SPORTSMEN

20

20

55

16

4

12

33

62

16

62

5

62

37

5

Durango™ Fifth Wheels • Make Every Day an Adventure!



325BH shown with Sienna décor

DURANGO™

by K-Z

Whether you're planning a quiet weekend retreat or a much needed extended getaway, you'll enjoy the affordable comforts of a Durango™ fifth wheel. Space expanding slide-outs, innovative and functional use of floor space and storage combine to make your leisure time more enjoyable.

It's the little things that make all the difference... You'll appreciate Durango's™ standard features that many others only offer as options. So select the floorplan and décor that best suits your needs.

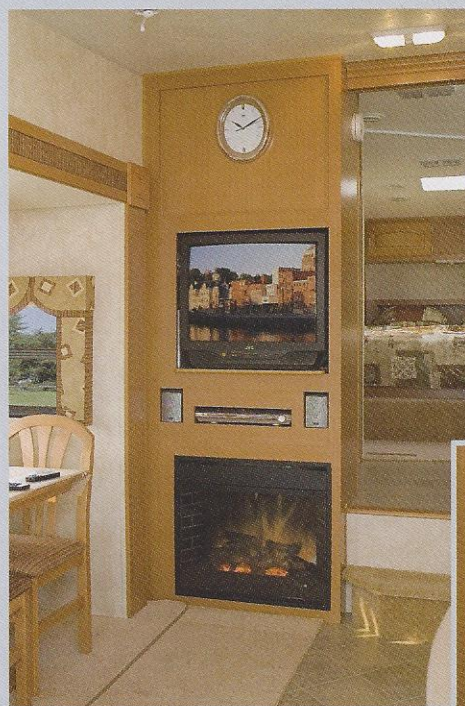

Enjoy a cozy evening in front of the optional fireplace. For the music and movie fans, Durango™ offers a color TV, AM-FM CD/DVD player with 5.1 surround sound.

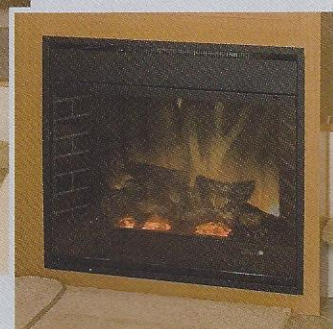



The optional queen size Posterest bed side slide out (shown here in the Sienna décor) is a wonderful space-expanding choice which allows for a full width wardrobe featuring sliding mirrored doors. The bed sports a beautiful quilted bed spread and matching quilted deluxe headboard.

A dressing vanity with deep drawer storage, sink with medicine cabinet and shower complete this bed and bath.



The queen size Posterest bed (shown here with the Amber décor) sports a beautiful quilted bed spread and convenient recessed bookshelf headboard with electrical outlet. The side wardrobes and overhead cabinets will provide plenty of storage.

You'll appreciate the safety lockbox in the floor of the bedroom closet to keep your valuables while you travel away from home.





The kitchen features a dual basin sink, microwave, oven, and refrigerator in a well organized area. But it's the little things that count, such as the combination florescent light that also doubles as a night light.



Convenience is the word that comes to mind when speaking of the Dirt Devil™ central vac system. It's great for quick clean ups or larger jobs.

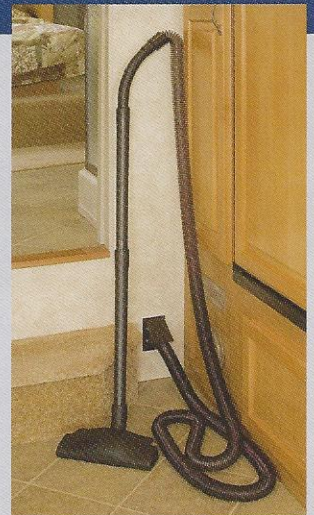

If space is an issue, select one of our models that offer a larger sleep area. Any of our BH line (shown here) have an open concept design that is spacious and inviting. They provide a queen size bed as well as dual bunks for the kids or grandchildren. Under bunk storage, a closet and TV shelf all add to the appeal of this model.

The 325BH model (shown here) comes standard with an entertainment center in the bunk area, or if you prefer, you may want to select the optional second bathroom.

Durango™ Exterior Features



Pass-Thru Storage Compartment and Hidden Under-Floor Storage



Exterior Sink with Hose Attachment



Dirt Devil™ Central Vac System



Exterior Shower



Exterior Entertainment Center



Rear Entry for Optional Second Bathroom (only available on 325BH)



Security Light



Easy Access Water Fill and Tank Flush



Entry Door with Assist Grab Handle and Triple Entry Steps

Durango™ Travel Trailer Floorplans

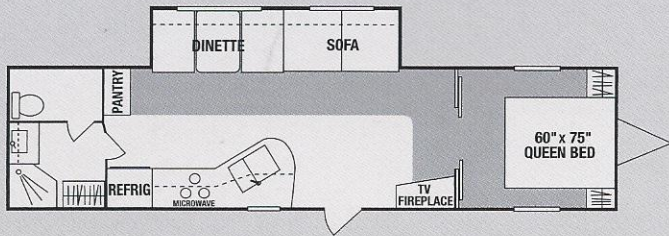

301RB • UVW N/A • Dry Hitch Wt. N/A • NCC N/A • Length N/A

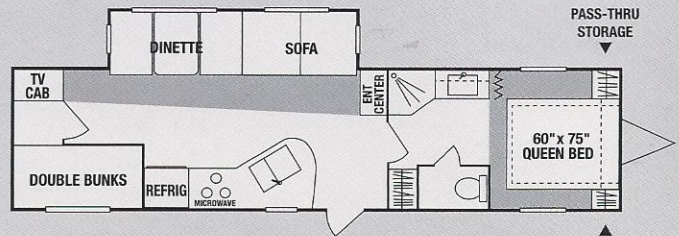

310BH • UVW N/A • Dry Hitch Wt. N/A • NCC N/A • Length N/A

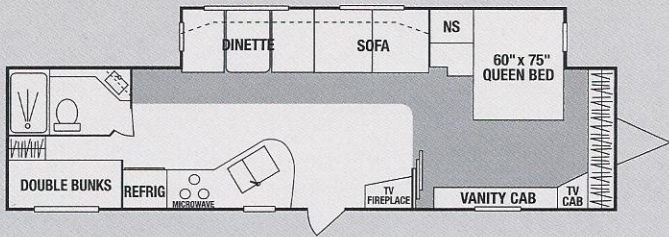

302BH • UVW N/A • Dry Hitch Wt. N/A • NCC N/A • Length N/A

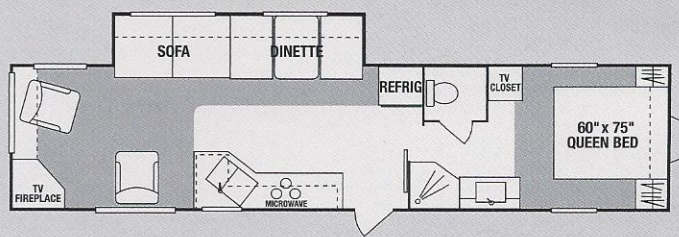

320RE • UVW N/A • Dry Hitch Wt. N/A • NCC N/A • Length N/A

Cut-Away Features

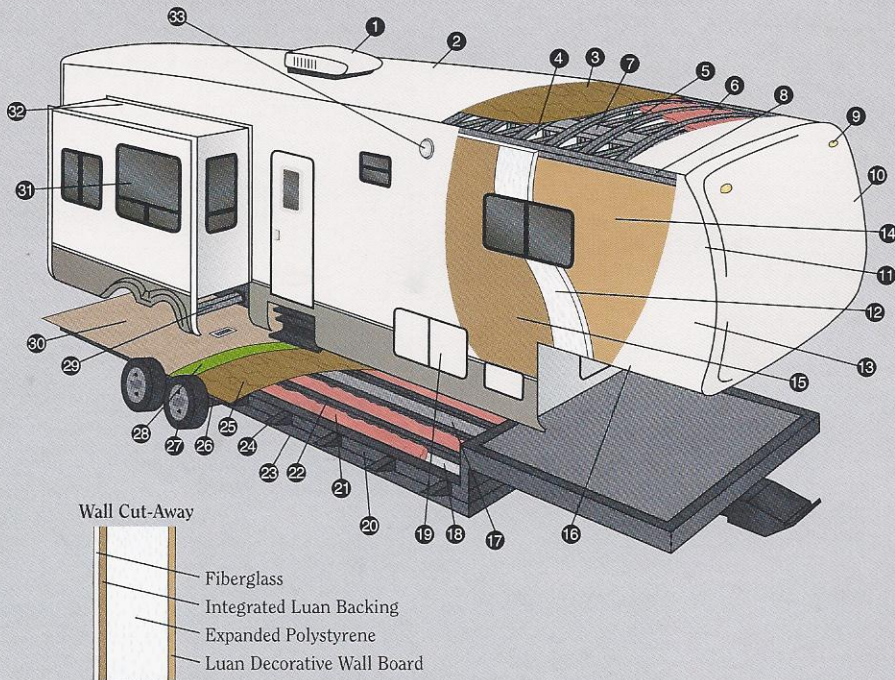

- 1 13,500 BTU A/C
- 2 One-Piece Seamless Rubber Roof
- 3 3/8" Decking
- 4 Vinyl Interior Ceiling Panel
- 5 4 1/2" Aluminum Truss Rafters, 16" O.C.
- 6 R-7 Batten Insulation
- 7 Insulated Ductwork
- 8 Heavy Duty Aluminum Headers
- 9 Exterior Clearance and Brake Lights
- 10 One-Piece Fiberglass Front Cap
- 11 Aluminum Frame Front and End Walls
- 12 Expanded Polystyrene
- 13 Fiberglass Exterior with Integrated Luan Backing
- 14 1/8" Luan Decorative Wall Board
- 15 1/8" Luan Wall Board
- 16 3" Aluminum Stringer
- 17 Residential Style Ducted Heat Run in Floor
- 18 Darco® Moisture Barrier
- 19 Large Capacity Pass-Thru Exterior Storage with Radius Doors Front and Side for Easy Access
- 20 Heavy Duty Tube Frame Construction
- 21 R-7 Batten Insulation
- 22 2x3 Double Welded Aluminum Floor Joists, 16" O.C.
- 23 Heated & Enclosed Underbelly
- 24 Fully Welded Outriggers
- 25 5/8" Tongue and Groove Plywood
- 26 Heavy Duty Leaf Springs
- 27 Heavy Duty Steel Wheels with Trim Rings and Center Caps
- 28 Residential Style Carpet Pad
- 29 Rack and Pinion Electric Slide with Manual Override with 2x3 Box Tube Slide Out Ram
- 30 28 oz. Residential Carpet or Linoleum
- 31 Tinted Safety Glass Windows
- 32 Triple Sealed Slide Outs
- 33 Exterior Security/Scare Lights

Wall Cut-Away

- Fiberglass
- Integrated Luan Backing
- Expanded Polystyrene
- Luan Decorative Wall Board

Décor

Amber



Foliage

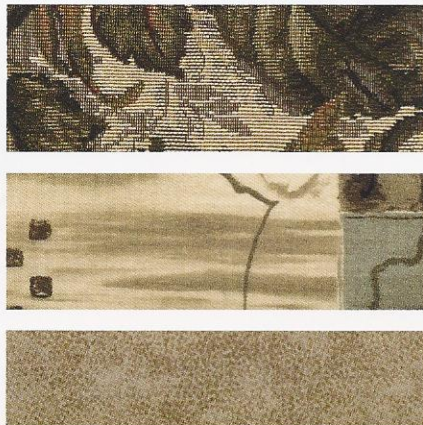

Sienna



Durango™ Fifth Wheel Floorplans

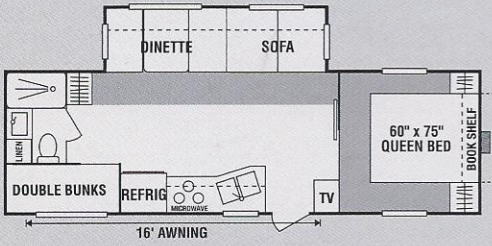

255BH • UVW 7040 • Dry Hitch Wt. 1400 • NCC 1960 • Length 26'3"

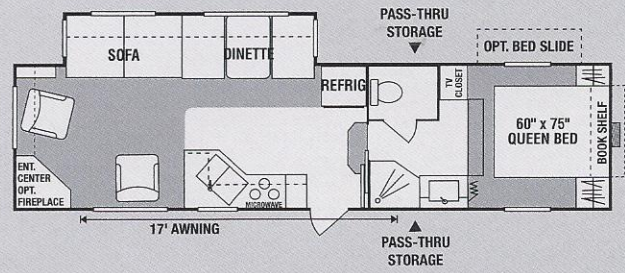

305RE • UVW 7940 • Dry Hitch Wt. 1610 • NCC 2060 • Length 32'11"

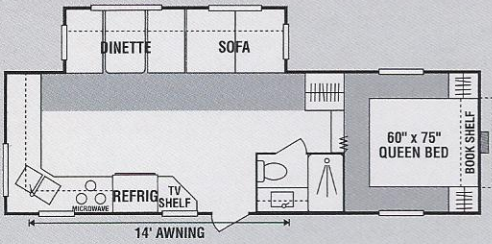

255RK • UVW 6830 • Dry Hitch Wt. 1590 • NCC 2170 • Length 26'3"

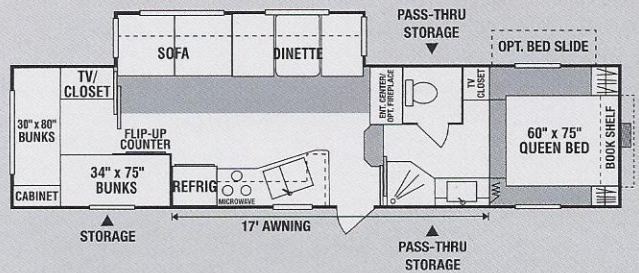

315BH • UVW 8290 • Dry Hitch Wt. 1650 • NCC 1710 • Length 33'5"

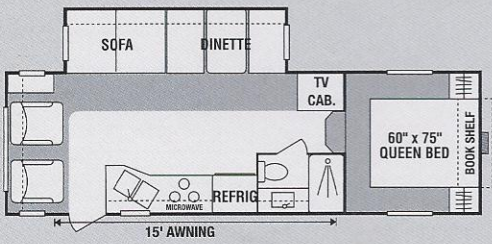

255RL • UVW 6900 • Dry Hitch Wt. 1370 • NCC 2100 • Length 26'3"

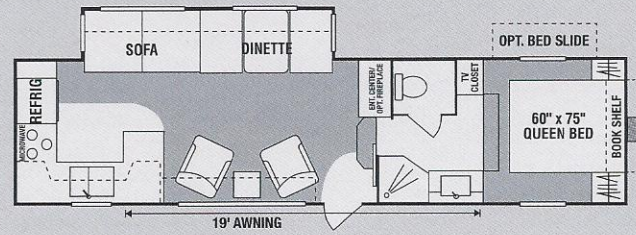

315BK • UVW 8110 • Dry Hitch Wt. 1530 • NCC 1890 • Length 32'5"

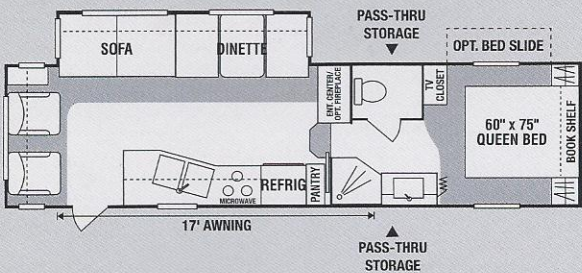

285RL • UVW 7880 • Dry Hitch Wt. 1480 • NCC 1940 • Length 30'

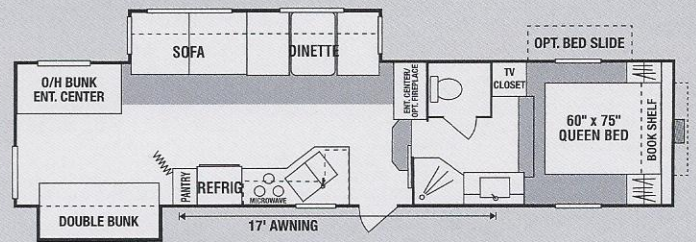

325BH • UVW 8770 • Dry Hitch Wt. 1590 • NCC 1730 • Length 33'5"

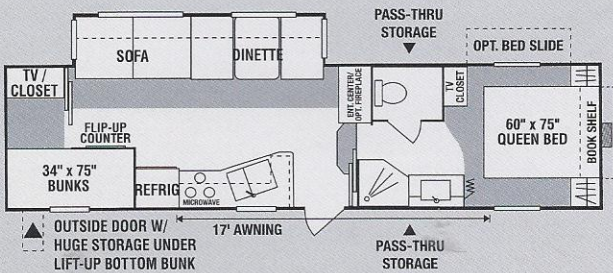

295BH • UVW 8000 • Dry Hitch Wt. 1680 • NCC 2000 • Length 30'5"

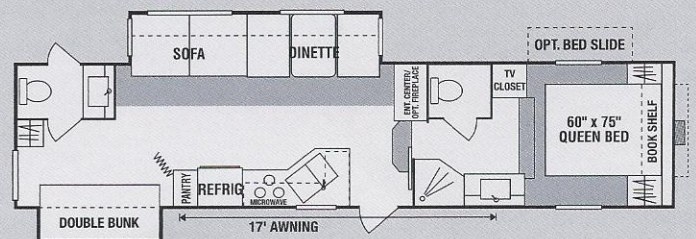

325BH • Optional Second Bathroom

	255BH	255RK	255RL	285RL	295BH	305RE	315BH	315RK	325BH
UVW (Unloaded Vehicle Wt.)	7040	6830	6900	7880	8000	7940	8290	8110	8770
Dry Hitch Wt.	1400	1590	1370	1480	1680	1610	1650	1530	1590
Dry Axle Wt.	5640	5240	5530	6400	6320	6330	6640	6580	7180
NCC (Net Carrier Capacity)	1960	2170	2100	1940	2000	2060	1710	1890	1730
GVWR	9000	9000	9000	9820	10000	10000	10000	10000	10500
Interior Height	82"	82"	82"	82"	82"	82"	82"	82"	82"
Exterior Width	96"	96"	96"	96"	96"	96"	96"	96"	96"
Exterior Length	26'3"	26'3"	26'3"	30'	30'5"	32'11"	33'5"	32'5"	33'5"
Exterior Height (with Air Conditioner)	143"	143"	143"	149"	149"	149"	149"	149"	149"
Refrigerator (cu. feet)	8	8	8	8	8	8	8	8	8
Water Heater Cap. (gal. - G/E with DSI)	6	6	6	6	6	6	6	6	6
Fresh Water Cap. (gal.)	55	55	55	55	55	55	55	55	55
Waste Water Cap. (gal.)	32	32	32	50	50	50	50	50	50
Gray Water Cap. (gal.)	32	32	32	50	50	50	50	50	50
LP Gas Cap. (lbs.)	60	60	60	60	60	60	60	60	60
Furnace BTUs (1,000's)	25	25	25	30	30	30	30	30	30
Tire Size	15"	15"	15"	15"	15"	15"	15"	15"	15"
Awning	16'	14'	15'	17'	17'	17'	17'	19'	17'

Standard Comfort Pack

- Shocks
- Stabilizer Jacks
- Triple Entry Steps
- Enclosed Pinbox
- Extended Pinbox
- Power Jacks
- Ladder
- Fiberglass Front Cap
- Slider Windows in Slide Out
- Awning
- Spare Tire
- Spare Tire Hoist
- Laminated Fiberglass Sidewalls
- All Aluminum Framing
- Heated Tanks and Enclosed Underbelly
- Tinted Safety Windows
- Chrome Rings and Center Caps
- Exterior Shower
- Black Water Tank Flush Kit
- Chrome Bumper Cover
- Security Light
- LP/CO/Smoke Detectors
- R14 Roof Insulation
- RVIA Seal

Standard Comfort Plus Pack

- 8 cu' Refrigerator
- 6 Gallon G/E Water Heater
- Postrest Mattress
- Fantastic Fan
- Color T.V.
- Folding Assist Grab Handle
- Over-the-Range Microwave
- Skylight over Tub
- Stove Cover
- Shower Door
- Catch All Tray (where applicable)
- Bathroom Accessories
- Pillows for Sofa
- Night Shades
- Phone Jack
- Laundry Hamper
- AM-FM CD/DVD Player with 5.1 Surround Sound Speakers
- TV Antenna with Booster
- Cathedral, Raised Panel Overhead Doors
- Cable Hook Up
- Wired for Satellite
- Fluorescent Light above Kitchen Sink with Nightlight

Additional Options

- 15,000 BTU A/C
- 2 Bar Stools (forced on 285RL)
- CSA
- Fireplace
- Central Vac
- Hide-a-bed
- Outside Grill
- Recliners
- Table And Four Chairs
- Raised Panel Refrigerator Door
- Outside Sink
- Outside Entertainment Center
- Bedroom Slide (N/A on 255s)
- Oak Cabinetry
- Stand Up Profile (285 and up)

2X2 WARRANTY - The K-Z 2x2 Warranty is a manufacturer's warranty. Each K-Z product is warranted to the original purchaser for twenty-four (24) months from the original date of purchase. Coverage includes appliances, components, construction and FULL structure. Our warranty is also transferable within the first two (2) years for a small processing fee. For a copy of the warranty with full terms and conditions, ask your local K-Z Dealer or visit our web site at <http://www.kz-rv.com>.

VEHICLE LOADING - Every effort has been made to provide the greatest number of options for the recreational owner. Each owner is responsible to select loads allowing the recreational vehicle to remain within the manufacturer's specified chassis weight limits. Do not overload the recreational vehicle.

UNLOADED VEHICLE WEIGHT (UVW) - The typical weight of this trailer as built at the factory. The UVW does not include cargo, LP gas, fresh water, options or dealer-installed accessories.

GROSS VEHICLE WEIGHT RATING (GVWR) - The maximum permissible weight of the trailer, including the UVW plus passengers, all cargo, personal items, fluids, options and dealer-installed accessories. The GVRW is equal to or greater than the sum of the UVW and the NCC.

NET CARRYING CAPACITY (NCC) - The maximum weight of all passengers, personal items, fresh water, food, tools, LP gas, other cargo and dealer-installed accessories* that can be carried by the trailer. NCC is equal to or less than GVWR minus UVW.

* The addition of options will decrease the NCC.

It is important for your safety and enjoyment that your tow vehicle be adequately sized and equipped to tow and handle the GVWR of the RV you select. Review weights and rating of your tow vehicle and consult a competent advisor for questions or advice. Whether you are new to RVing or a seasoned veteran, get a feel for the performance of your tow vehicle and the RV together before heading out on the roadways. When you tow an RV, you must drive differently than you do when driving a single vehicle. Practice hooking up, driving, backing up and braking in a safe environment or seek out professional instruction.

See specification chart above. K-Z affixes a weight label to each new RV which lists weight information for that vehicle.

NOTE: This information is intended as a guide only. Weights of individual vehicles are approximate. Consult your Owner's Manual for complete loading, weighing and towing instructions. All weights may vary.

Awarded to K-Z
six years in a row.



Dealer:

Jerry's Trailers & Campers, Inc.
2601 South 13th St.
Norfolk, NE 68701
(402) 371-1306
www.jerrystrailers.com

KZ DURANGOTM
K-Z • 9270 West U.S. 20 • Shipshewana, IN 46565
E-Mail kz@kz-rv.com • www.kz-rv.com

RVIA

Due to continual research and advances, manufacturer reserves the right to change specifications, design, price and equipment without notice. Some items shown are not included as standard or optional equipment.

©2006K-Z