

2006 CARRIAGE CARRI-LITE

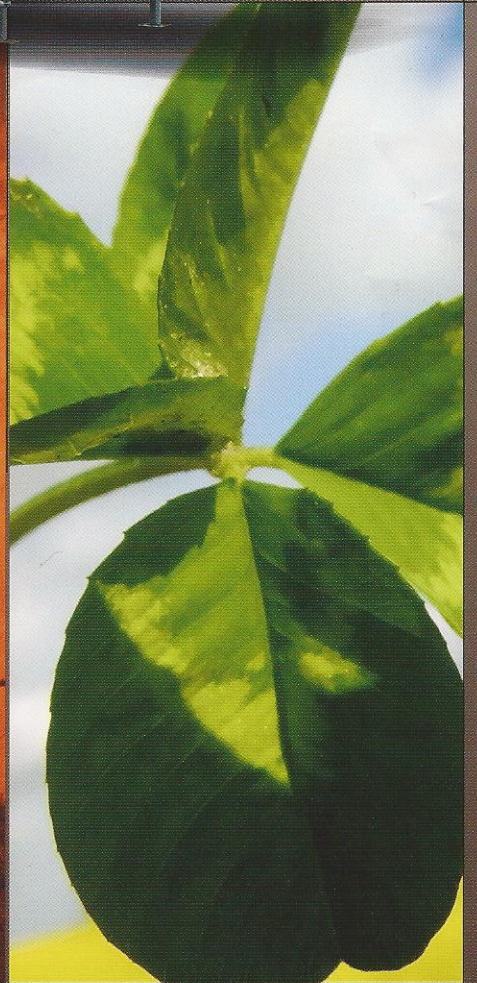

2006 CARRIAGE CARRI-LITE



CARRI-LITE MODEL 36XTRM5 IN COPPER DECOR



STANDARD LEATHER EURO SWIVEL RECLINERS

Carri-Lite's professional interior designers realize that everyone's taste is a little different and that is why we offer a choice of a broad range of decor colors and fabric selections. When you start with quality fabrics and blend them with the rich, natural hardwood finishes of Merit Oak, or optional Natural or Honey Maple cabinetry, you end up with that feeling of home.



WHY CARRIAGE?

We stress the importance of **quality** in manufacturing. With superior quality come reliability, durability, and most importantly, customer satisfaction. **Quality** that has withstood the test of time. We are a progressive thinking company mindful of the future. We continually explore new directions in search of the best equipment and designs. We devote much of our attention to the engineering of our units to maximize the full potential of every component. It's more than our stunning interiors that set us apart from other manufacturers. The **quality** of what

we use to achieve that look on the inside is just as important as what we use on the outside and underneath, even where you might not first glance. Looking below the surface of each unit is where you will begin to understand what makes a Carriage so unique. We insist on meticulous installation of all the components on every coach. Adding the exquisite interior fabrics and custom made cabinetry and furniture to the top **quality** foundation we create for every unit makes for an incomparably finished unit, unequalled and unavailable anywhere else in this industry.

WWW.CARRIAGEINC.COM

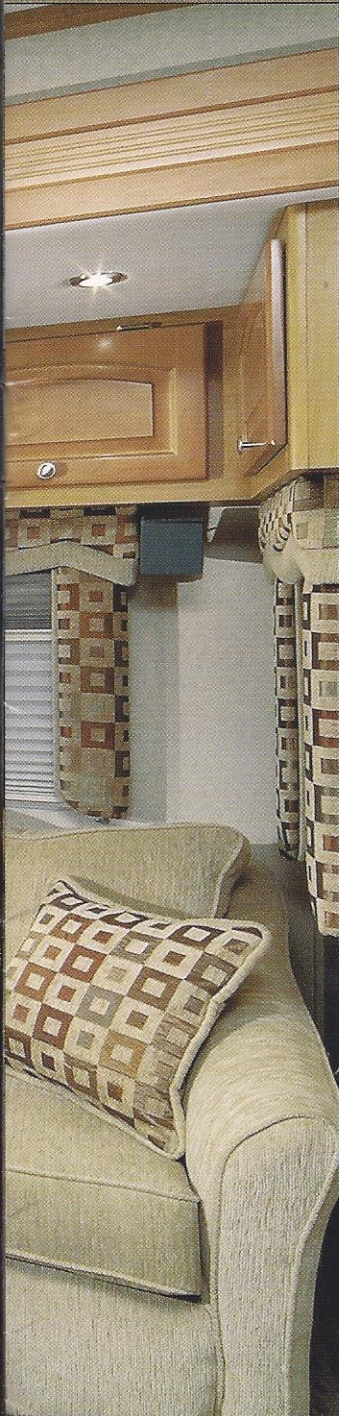

CARRI-LITE MODEL 36SLX5 IN EUCALYPTUS DECOR

2006 CARRIAGE CARRI-LITE



CARRI-LITE MODEL 36XTRM5 IN COPPER DECOR

When you're ready to call it a night, do it in style in the bedroom suite. Not only will you sleep better, but you'll also wake up refreshed and ready to tackle another day. The bedroom suite has a spacious wardrobe including numerous drawers and storage compartments to handle your personal belongings.

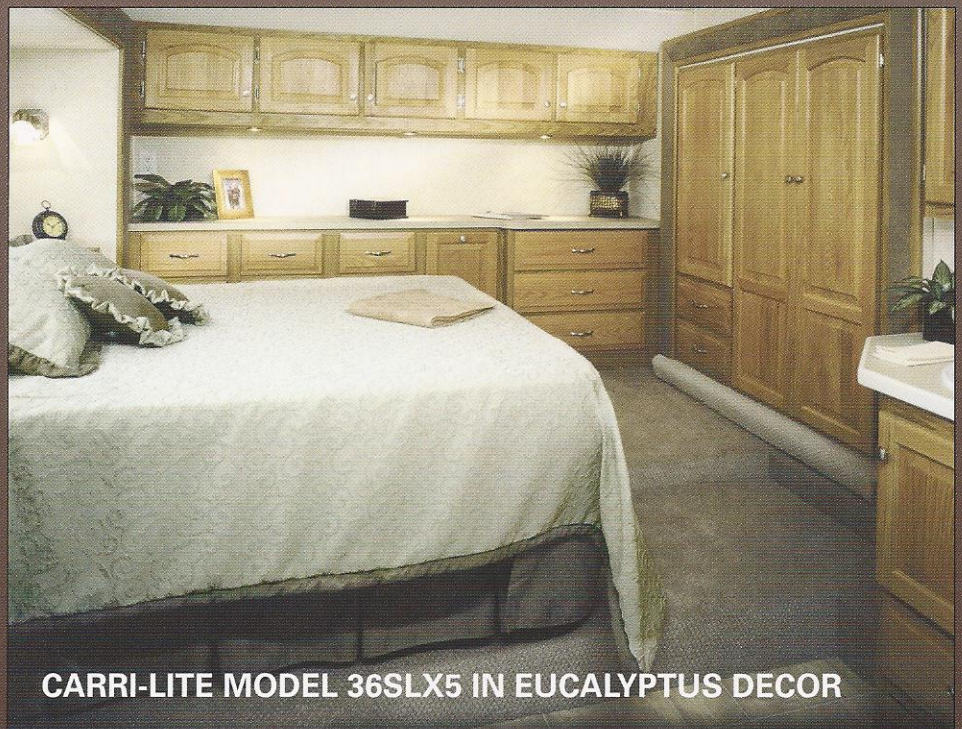

CARRI-LITE MODEL 36SLX5 IN EUCALYPTUS DECOR

Carriage

CARRI-LITE

2006 CARRI-LITE FIFTH WHEEL FLOORPLANS

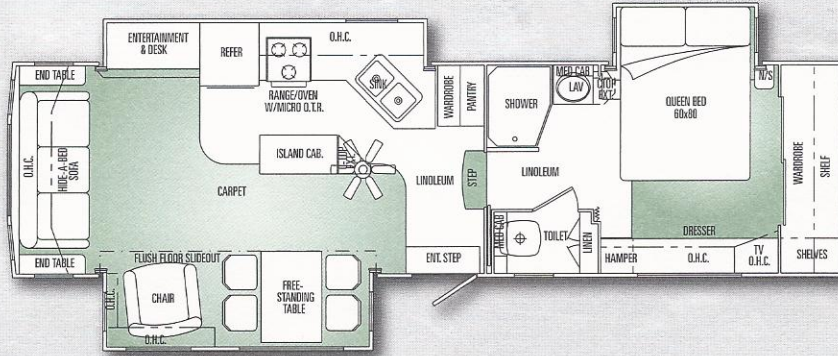

32RS3

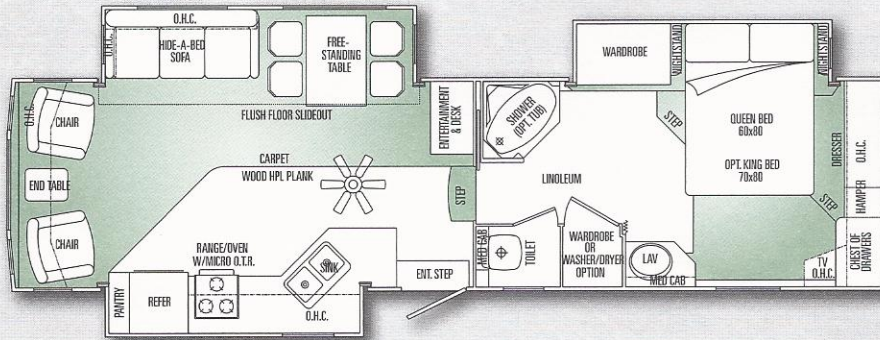

34KS3

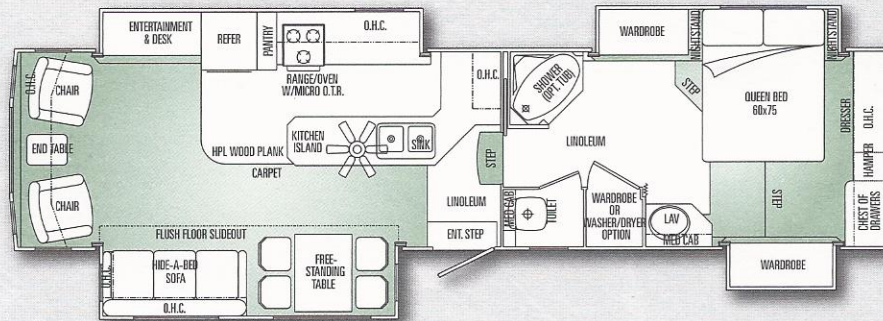

36KIQ

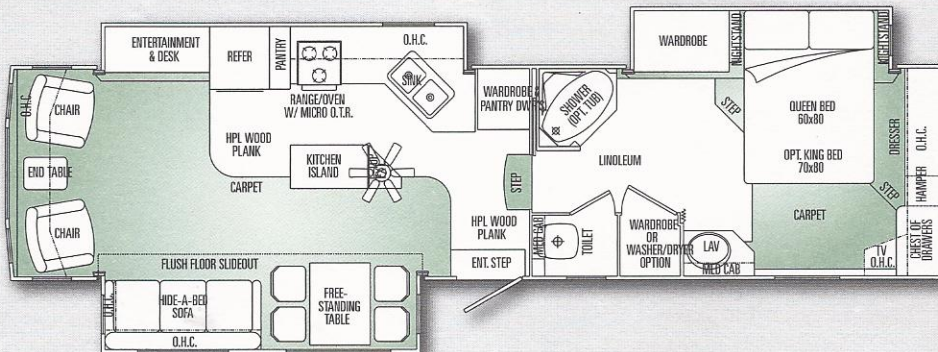

36KS3

Carriage

CARRI-LITE

2006 CARRI-LITE FIFTH WHEEL SPECIFICATIONS

STANDARD PACKAGES

"BEST BUILT" PACKAGE

- Nev-R-Lube axles
- MOR/ryde RE rubber equalizer system
- Greaseable shackles
- Exterior Shower
- 40# LP bottles w/auto change over
- 110V recept in basement (DS)
- TV outlet in basement (DS)
- Rear second basement (60 cubic feet)

"LUXURY" PACKAGE

- 24" Sony Wega flat screen TV
- Sony AM/FM/CD/DVD Home Theatre System 5.1 w/ subwoofer
- Floor safe
- Pillow top mattress
- Water purifier
- Euro swivel recliners w/foot stool
- Three zone Xelogen lighting w/dimmer switches
- Carpet runner at shower
- Decorative mirror & coat hooks

INTERIOR

STANDARD FEATURES

- Residential carpet w/pad throughout
- Armstrong® Tuffguard Linoleum @ kitchen and bath (Includes entrance on some models)
- Oak raised panel doors & drawers (Cathedral style)
- Brushed Nickel hardware on all cabinet doors/drawers
- Metal drawer guides w/nylon rollers
- Designer window treatments throughout
- Oak facer main level slide-out
- Ceiling – Soft touch vinyl
- Crown molding at ceiling, Kitchen & living room
- Chair @ desk (where applicable)
- Overhead cabinet in slide-outs above sofa
- Xelogen lighting @ kitchen overhead cabinets
- Dressing mirror on sliding door @ bath area
- Day/night shades
- Wood grab handle

- Merit oak cabinetry

OPTIONS

- Armstrong® HPL plank floor @ kitchen (Includes entrance on some models)
- Decorator kit
- Natural Maple cabinetry
- Honey Maple cabinetry
- Central Vacuum System
- Arizona Room Slideout (N/A 32RS3)
- Black-Out Day/Night shades
- Fireplace (N/A 32RS3 & 34KS3)

SYSTEMS

STANDARD FEATURES

- 12V interior lights
- Xelogen lights w/dimmer in living room, kitchen, & bedroom ceilings
- 12V lights in exterior storage compartments
- 12V entrance step light
- 12V light @ hitch
- 12V power vent in bathroom and stool room
- Winegard® TV antenna w/built-in power booster
- TV jacks in living room & bedroom
- Large capacity holding tanks
- Enclosed heated & insulated holding tanks & valves w/separate heat duct
- Holding tank evacuation system
- Large capacity fresh water tank
- Black water holding tank flush kit
- Monitor panel (full systems)
- Sewer hose carrier (built-in)
- Water system (demand large capacity)
- Water system hook-up (direct city)
- Water heater by-pass kit
- Furnace Suburban™ (pilotless) 35,000BTU (32'),
- 42,000BTU (34' and up)
- 10 gal. gas/electric water heater w/DSI
- 15,000 BTU ducted air conditioner – Carrier™
- Prep for 2nd A/C bedroom
- 50 amp marine power cord
- Washer/dryer prep. w/plumbing cover (N/A 32RS3)
- Battery shut-off switch
- 50 amp electrical service
- Heavy duty 75 amp solid state converter
- Dual 40# LP gas bottles w/ automatic change over
- 12V LP leak detector
- CSA fire extinguisher/smoke detector
- CO detector

OPTIONS

- 15,000 BTU ducted air conditioner w/heat pump – Carrier™
- Roof vent – power (extra)
- Fantastic® Vent w/wall switch
- Fantastic® Vent w/thermostat & rain sensor
- 12V battery installed
- Generator prep (auto change over)
- Generator Onan 5,500 watt Marquis Gold
- Solar panel prep
- Washer/dryer: Sense Clean DD Combo
- Washer/dryer: Kenmore 2 pc

CONSTRUCTION/SAFETY & RUNNING GEAR

STANDARD FEATURES

- 100" wide body width
- All climate insulated (engineered for full-time use)
- Enclosed underbelly w/R-14 fiberglass in-frame insulation, plus R-7 fiberglass insulation in floor. Composite "R" factor for floor R-24
- R-14 fiberglass insulation in roof. Composite "R" factor R-17
- Fully enclosed frame w/heated tanks
- Exclusive drop frame construction
- Painted frame w/stacked 2" x 12" 11 ga. Steel mains
- 5/8" tongue & groove plywood floor
- Aluminum main floor construction W/1 1/2 x 2 1/2 joist on 16" centers
- Dual insulated floor design with double vapor barrier
- Fully insulated main floor and frame for double insulation protection
- Full 2" aluminum sidewalls w/box tube welded both sides
- Fully decked roof (1/2" plywood)
- 5" aluminum trussed roof 16" oc
- Flush floor on main slide out room
- Heavy duty 12V rack & gear slide-out system
- Fully insulated 2" slide-out floors (R-8)
- Front electric power jacks
- Two rear stabilizing jacks
- Snap pins @ front jack legs
- Dexter Axles w/2" x 12" brakes
- Nev-R-Lube axles
- MOR/ryde® RE (rubber equalizer) suspension
- Greasable shackles
- Double heavy duty leaf spring suspension
- Adjustable spring hangers
- Eight-lug wheels & radial tires

- Spare tire & wheel recessed
- Shock absorbers @ all wheels
- 16" tires & wheels 32' LT235/85R16 "E" range
- 34' and up - LT235/85R16 "G" range

OPTIONS

- Dexter axles w/2 1/2" brake system – ventilated
- Front jacks w/separate motors & switches
- Hitch: 20,000 Reese
- MOR/ryde pin box

EXTERIOR

STANDARD FEATURES

- Custom molded one piece front and rear gelcoat fiberglass caps
 - Gelcoat fiberglass exterior sidewalls
 - Painted rocker panels w/ automotive clearcoat finish
 - Automotive style bumper
 - Diamond Plate Front Gooseneck
 - Mid ship turn signals
 - One piece vinyl TPO roof
 - Awning rail w/gutter & down spouts
 - Carefree patio awning
 - Prep for electric awning
 - Slider windows @ ends of living area SO room
 - Escape window (bedroom)
 - GL20 solar tinted safety glass windows
 - Flush mount baggage doors
 - Basement storage w/2-4 access doors w/12V lights
 - Large 32 cubic foot front compartment for generator
 - Storage shelves/hose rack in front gen. compartment
 - Felt lined exterior compartments
 - Pullout grab handle @ entry door
 - Dead bolt door lock
 - Breakaway switch
 - Exhaust vent in stool room
 - Patio light – 12V
 - 110V exterior recept (GFI)
 - Courtesy light @ sewer hook-up
 - Scare lights (2)
 - 110V recept in basement (DS)
 - TV outlet in basement (DS)
 - Exterior shower
 - "Big Easy" triple entrance steps w/non-slip grips
- #### OPTIONS
- Dual pane windows (w/GL20 tinted glass)
 - Rear sunshade (bay window models)
 - Man/Elect. Box awning
 - Accessory receiver w/bike rack

2006 CARRI-LITE FIFTH WHEEL SPECIFICATIONS

- Slide-out battery tray
- Slide-out LP bottle tray
- Slide-out cargo tray @ main storage area

ENTERTAINMENT

STANDARD FEATURES

- Residential style entertainment center
- Television 24" Sony Wega
- Sony AM/FM/CD/DVD Home Theater System 5.1 with subwoofer
- Cable TV hookup
- Phone jack (2)
- Satellite prep (RG-6 cable)
- Desk @ E-center

OPTIONS

- TV slide & swivel (N/A angled "E" centers)

KITCHEN

STANDARD FEATURES

- Corian counter tops
- Countertop extension (where applicable)
- Acrylic deep double bowl sink w/2 covers
- Lift-off faucet
- Water purifier w/separate faucet

- Flip down accessory drawer
- Bi-fold range cover
- Full pantry slide out drawers
- Oak dinette table w/expandable leaf & 4 chairs
- Microwave w/turn table and built-in hood vent
- Refrigerator: Norcold N821 (2 door, gas/electric 8 ft.)
- w/raised panel wood doors
- Decorative mirror with coat hooks

OPTIONS

- Microwave oven (convection)
- Platinum Package (Stainless Steel-look microwave, refer,sealed burner range)
- Range: 3 burner (hi-output)
- Cook top w/doors below IPO oven
- Refrigerator 4 door: Norcold 1200LR (N/A some models)
- Refrigerator: 10' Norcold
- Omega cutting board w/work center

LIVING ROOM

STANDARD FEATURES

- Euro swivel recliner w/foot stool - Leather
- 6' 2" slide-out height - main slide-outs

- Free standing end table w/ magazine rack
- Hide-A-Bed sofa w/pillows
- Thicker higher density foam in all furniture
- Slide-out keyboard tray @ desk (36CK3 & 36XTRM5)
- Ceiling fan
- Chair @ desk, w/knee holes

OPTIONS

- Recliner: Swivel w/"Rock 'n Lock mechanism - Carrara
- Fireplace (N/A 32RS3 & 34KS3)

BATHROOM

STANDARD FEATURES

- Full size 1pc fiberglass shower
- Acrylic sink in bathroom
- Spacious walk through bathroom
- Brushed nickel light bar - medicine cabinet
- Oversized medicine cabinet w/ extra large mirror
- Porcelain stool
- Towel bar
- Shower bubble w/shade (16 x 24)
- Drawer storage @ vanity
- Carpet runner @ shower

OPTIONS

- Garden tub lpo shower (where available)

BEDROOM

STANDARD FEATURES

- Piston lift queen bed w/felt lining (32RS3 only)
- Pillow top queen mattress
- Duvet cover w/pillows
- Accent prism lights - 2 each side of bed
- Privacy door in bedroom
- Stand-up bedroom w/6' head room
- Bedroom night stand(s)
- Clothes hamper - built in
- Cedar lined wardrobes
- Drawer under bed (all suite models)
- Floor safe
- Bedroom bench (34KS3 & 36KS3)

OPTIONS

- King bed (34KS3, 36KS3)

CARRI-LITE	CL 32RS3	CL 34KS3	CL 36KS3	CL 36KSO	CL 36KIQ	CL 36XTRM5	CL 36SLX5
Approx. Exterior length	32' 11"	34' 11"	36' 11"	36' 11"	36' 11"	36' 11"	36' 11"
Approx. Exterior width	100"	100"	100"	100"	100"	100"	100"
Approx. Exterior Height w/AC1	12' 8"	12' 8"	12' 8"	12' 8"	12' 8"	12' 8"	12' 8"
Approx. Dry Axle Weight (lb)*	9,490	10,225	10,510	10,665	10,580	11,045	11,330
Approx. Hitch Weight (lb)*	2,270	2,435	2,550	2,735	2,745	2,830	2,570
Approx. Total Dry Weight (lb)*	11,760	12,660	13,060	13,400	13,325	13,875	13,900
Approx. Average Load Capacity (lb)*	2,678	3,775	3,490	3,335	3,420	2,955	2,670
Axles (number of)	2	2	2	2	2	2	2
Fresh Water Capacity w/ water heater**	82 Gal.	82 Gal.	82 Gal.	82 Gal.	82 Gal.	82 Gal.	82 Gal.
Black/Gray Holding Tank Capacity	38/72 Gal.	38/72 Gal.	38/72 Gal.	38/72 Gal.	38/72 Gal.	38/72 Gal.	38/72 Gal.

* Above listed weights are actual units that include all slide out rooms and all popular options ordered on most coaches. These weights are provided as a guideline only. The actual weight of each individual unit (all units are weighed as they come off the production line) is posted inside each vehicle.

** Fresh water capacity includes the combined capacity of the fresh water tanks and the water heater.



Carriage

CARRI-LITE



Visit our Website.

www.carriageinc.com

Post Office Box 246 • Millersburg, Indiana 46543 • (574) 642-3622

© 2006 Carriage, Inc. Printed in U.S.A.

Due to continual improvement of Carriage Inc. products, we reserve the right to change material, colors, specifications and prices at any time without prior notification. Selected decorator items used in the photos are not part of the product. Carriage, Inc. assumes no responsibility for any error in type or print reproduction of specifications or color in this brochure.

COPPER INTERIOR

EUCALYPTUS INTERIOR

MOSS INTERIOR



SOFA



RECLINER



SOFA

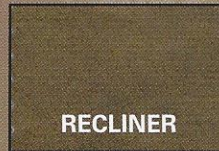

RECLINER



SOFA



RECLINER



DINETTE



BED SPREAD



DINETTE



BED SPREAD



DINETTE



BED SPREAD



BEDROOM ACC



CARPET



BEDROOM ACC



CARPET



BEDROOM ACC



CARPET



Standard Merit Oak

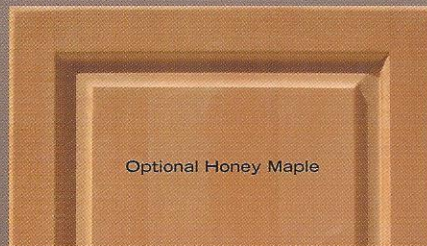

Optional Honey Maple

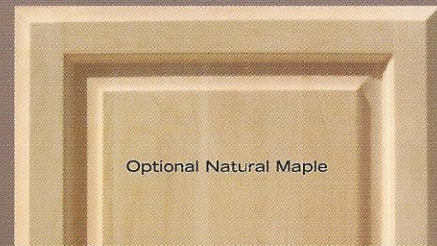

Optional Natural Maple



CARRI-LITE MODEL 36KSO IN MOSS DECOR

2006 CARRIAGE CARRI-LITE



CARRI-LITE MODEL 36KSO IN MOSS DECOR

Carri-Lite opens the door to the best that Carriage has to offer. You'll appreciate the convenience of the large deep interior cabinets throughout. Oak raised panel doors and drawers, stain-resistant fabrics and overhead cabinets in slide-outs. The Carri-Lite is the popular choice for those who refuse to compromise quality for value. Practical

and efficient interiors are beautifully appointed with all the amenities and conveniences you need and desire for pleasurable travels. The Carri-Lite is available in fifth wheel models with a variety of floorplans and stylish decors to choose from. Carri-Lite features the "XTRM5" & SLX5, the industry's first fifth wheels with 5 slide-outs.

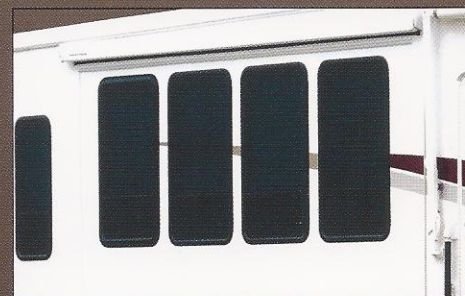

**ARIZONA SUN ROOM
SLIDE-OUT**

2006 CARRI-LITE CONSTRUCTION

MAIN FRAMES



WE DESIGN AND MANUFACTURE OUR OWN FRAMES

ADVANTAGE: We engineer additional support into our coach for superior frame design, (stiffness and rigidity). We also design them to maximize exterior storage.

BENEFIT: We offer a stronger frame than the standard I-beam or C-Channel frame our competitors use. We also have the confidence to offer an exclusive 5 or 7 yr frame warranty. The BEST warranty in the RV Industry.

2" X 6" DOUBLE STACKED BOX TUBE STEEL (7 ga. front & 11 ga. rear)

ADVANTAGE: Eliminates frame flex, and offers greater strength vs. typical 10" or 12" I-Beam frame.

BENEFIT: By eliminating flex, the unit will ride better, respond to road conditions better, and will last longer than the competition, protecting your investment.

OUR SLIDE MECHANISMS ARE WELDED TO THE TOP OF OUR FRAMES

ADVANTAGE: No "holes" are cut into mainframe that will weaken the structure of your coach.

BENEFIT: With already having a more superior frame than the competition, Carriage's frames become the strongest, after the competition torches 2, 4, 6, or even 8 holes to get their slide mechanisms to extend out past their frames.

WE MANUFACTURE OUR OWN COMPONENTS

COUNTERTOPS

ADVANTAGE: While working from raw material, we manufacture our countertops, we can maintain our own style and quality not having to depend on outside suppliers.

BENEFIT: To ensure Quality in our Countertop Dept., we hold them to the highest standard. If any issues come up for you down the road, a replacement is readily available.

CABINET DOORS AND DRAWER FRONTS

ADVANTAGE: We have the ability to sort thru the mismatched stained wood for a consistent look, instead of after it is in the coach, at the dealer's lot.

BENEFIT: To ensure Quality in our Cabinet Shop, we hold them to the highest standard. If any issues come up for you down the road, a replacement is readily available.

WINDOW TREATMENTS

ADVANTAGE: A unique style with each coach, made of quality materials. With other manufacturers that outsource window treatments, all you get is a "cookie cutter" style valance.

BENEFIT: To ensure Quality in our Sewing Dept., we hold them to the highest standard. If any issues come up for you down the road, a replacement is readily available.

Brad Salzbrun
12 years
Woodshop



Lois Willard
23 years - Sewing



Dean Miller
17 years - Countertops

2006 CARRIAGE CARRI-LITE

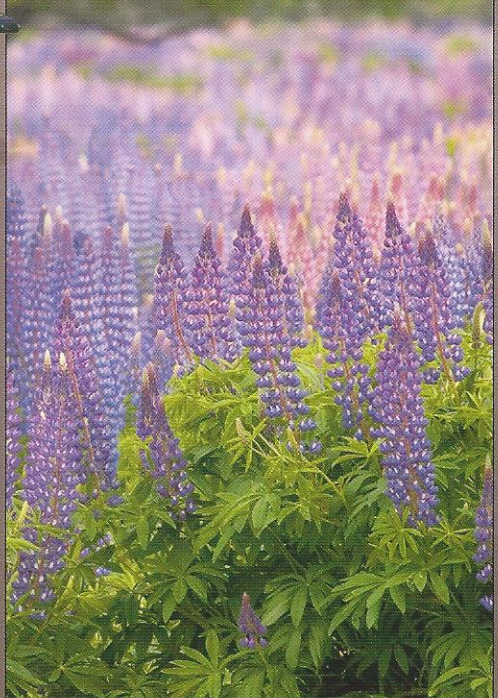

CARRIAGE EXCLUSIVE WARRANTY
THE BEST WARRANTY AVAILABLE PERIOD.



THIS IS THE BEST WARRANTY IN THE RV INDUSTRY. NO EXCLUSIONS FOR FULL TIMERS. UNLIKE OUR COMPETITION, WE WANT YOU TO ENJOY OUR COACHES YEAR-ROUND.

CARRIAGE USES QUALITY COMPONENTS FROM THESE MANUFACTURERS:



YOUR LOCAL CARRIAGE DEALER:



POST OFFICE BOX 246
MILLERSBURG, INDIANA 46543
(574)-642-3622
WWW.CARRIAGEINC.COM



INDUSTRY LEADING SIXTH TIME QUALITY CIRCLE AWARD WINNER

Carriage Inc. received it's industry leading sixth (6) Quality Circle Award in December 2004. Dealer Satisfaction in areas such as sales, product management, and service/warranty support. It is in these products, that are designed and built by our outstanding groups of employees, that makes this award possible. We are most proud of this recognition, because it is voted on by our dealer body, not industry peers.

Due to continual improvement of Carriage Inc. products, we reserve the right to change material, colors, specifications and prices at any time without prior notification. Selected decorator items used in the photos are not part of the product, Carriage, Inc. assumes no responsibility for any error in type or print reproduction of specifications or color in this brochure.