

# 2006 CARRIAGE



**BUILT FOR THE ROAD THAT LEADS ANYWHERE.**



# 2006 CARRIAGE



# 2006 CARRIAGE



## LUXURY BEYOND ALL EXPECTATIONS

**A PLACE YOU CAN CALL HOME.**

For over thirty years, Carriage has been synonymous with excellence in RV living. We've built our reputation on our flagship line of Carriage fifth wheels. That's why so many full-time RV'ers choose Carriage for their travel homes. Carriage is specially engineered for full time, all climate use and loaded with appointments and amenities for easy living. Structurally sound, beautifully comfortable, and fashionably styled....you really can have it all with a Carriage.

**[WWW.CARRIAGEINC.COM](http://WWW.CARRIAGEINC.COM)**



**CARRIAGE MODEL 378 IN CYPRESS DECOR**

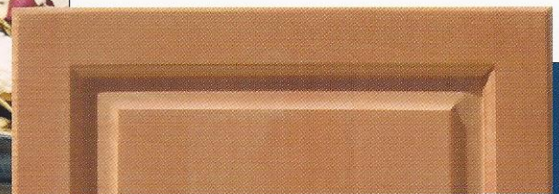

**HONEY MAPLE**



**NATURAL MAPLE**

# 2006 CARRIAGE



**KITCHEN ISLAND WITH CHROME  
PULL-OUT PANTRY**

# Carriage

## 2006 CARRIAGE FLOORPLANS

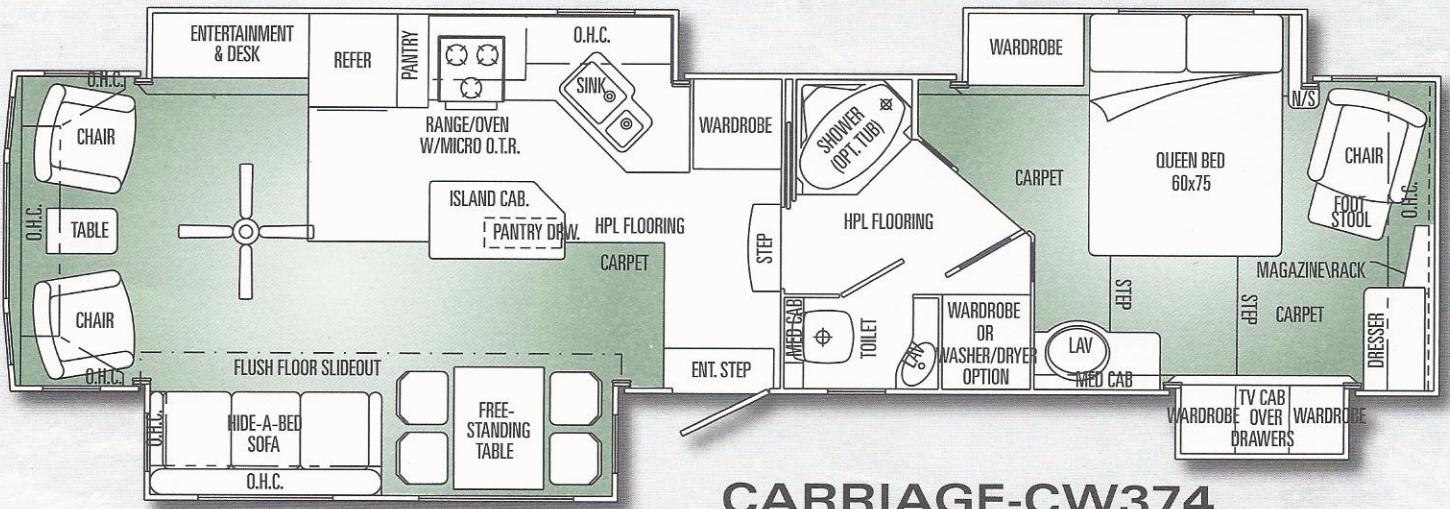

**CARRIAGE-CW374**

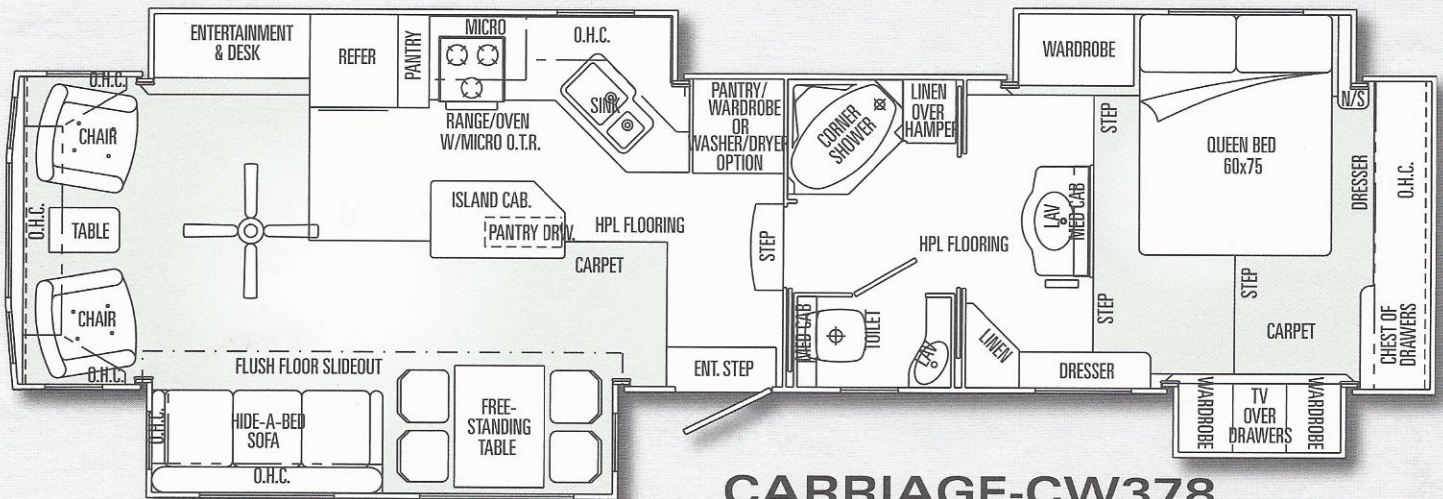

**CARRIAGE-CW378**

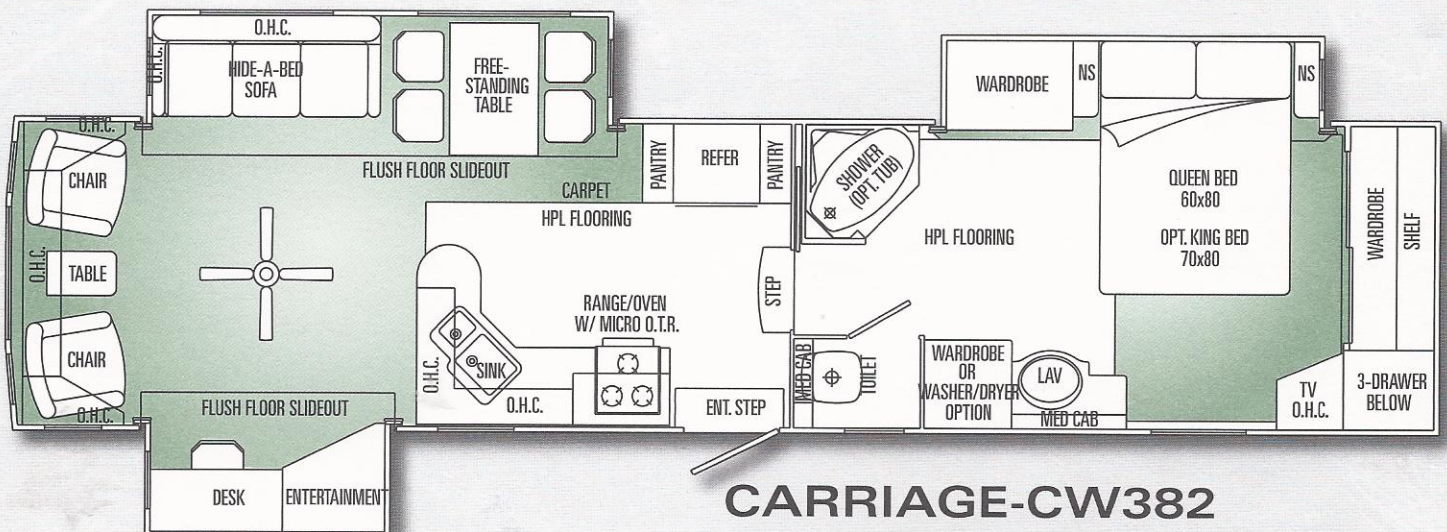

**CARRIAGE-CW382**

# Carriage

## 2006 CARRIAGE SPECIFICATIONS

### INTERIOR

#### STANDARD FEATURES

- Armstrong® HPL "ceramic look" tile @ kitchen & bathroom
- Residential carpet w/pad throughout
- Tufted Day/Night shades
- Decorator wall border in kitchen & bathroom
- Xelogen lights with dimmers
- Deluxe interior light switches
- Deluxe xelogen lighting under kitchen overhead cabinets
- Accent lighting behind all glass doors
- Wood grab handles
- Designer window treatments throughout
- Wood valance at kitchen & bath windows
- Solid wood paneling
- Maple raised panel doors & solid drawers
- Custom fluted slide-out facer
- Radius hardwood cabinets hand stained
- Solid hardwood trim & interior door frames
- Brushed Nickel handles on all cabinet doors/drawers
- Deluxe hidden hinge cabinet doors
- Metal center drawer guides w/bearings
- Dovetailed drawer box
- Residential pocket doors in bathroom
- Crown molding around ceiling

#### OPTIONS

- Decorator kit
- Central vacuum system
- 2000 watt Inverter system w/3 batteries
- Black-Out Day/Night shades
- Arizona room slide-out room
- Fireplace (374 & 378)

### SYSTEMS

#### STANDARD FEATURES

- Interior step lights
- 12V lights in exterior storage compartments
- 12V entrance step light
- 12V light @ hitch
- 12V power vent in stool room
- Fantastic® vent w/thermostat & rain sensor bath hall
- Washer/dryer prep

- Winegard® TV antenna w/built in power booster
- TV Jacks in Living room & Bedroom
- Phone jacks - 3 std
- Battery shut off switch
- Batteries
- Heavy duty 75 amp solid state converter
- Kwiikee slide battery tray
- Dual 40# LP gas bottles w/slide tray
- 12V gas detector
- Smoke detector
- CO detector
- Monitor panel
- Sewer hose carrier (built-in)
- Black water holding tank flush kit
- Water heater by-pass kit
- Water system (demand large capacity)
- Water system hook-up (direct city)
- Enclosed low point drains
- Holding tank evacuation system
- Furnace Suburban™ (pilotless) 42,000 BTU
- 12 gal gas/electric water heater w/DSI
- 50 amp service
- 50 amp marine power cord
- Solar panel prep
- 15,000 BTU ducted air conditioner - Carrier™
- Generator Prep w/auto change over

#### OPTIONS

- 2nd 15,000 BTU ducted air conditioner - Carrier™
- 15,000 BTU ducted w/heat pump - Carrier™
- Generator Onan 5,500 watt Marquis Gold
- Washer/dryer: Sense Clean "DD" Combo
- Washer/dryer: Kenmore 2 pc (N/A CW378)
- Fantastic® vent w/wall switch
- Fantastic Vent w/Ther & rain sensor
- Battery 12v installed (extra)(1 std)

### CONSTRUCTION/SAFETY & RUNNING GEAR

#### STANDARD FEATURES

- All-climate insulated (engineered for full-time use)
- 100" wide body width
- Enclosed underbelly w/R14 fiberglass

- insulation, plus R7 fiberglass insulation in main floor & roof R24 composite
- Fiberglass insulation glued in place
- Owens Corning™ insulation floors, walls & roof system
- Dual insulated floor design double vapor barrier
- Painted frame w/stacked 2"x 12" 11 gauge steel mains
- Drop frame construction
- Aluminum main floor construction
- 5/8" plywood floor tongue and groove
- Sidewall incorporates built-in vapor barrier in addition to full fiberglass insulation w/2 x 3 joist on 16" centers
- Fully insulated slide-out floors 2-1/4" thick
- Fully decked roof (1/2" exterior grade plywood)
- Eight-lug wheels w/radial tires
- 215/75R17.5 H-range Tires
- Front electric power jacks (independent motors & switches)
- Two rear stabilizing jacks
- Snap pins @ front jack legs
- Heavy duty 12V rack & gear slide-out systems
- "Big Easy" entry step
- Spare tire - crank down
- Bilstein™ shock absorbers at all wheels
- MOR/ryde® suspension IRE (Integrated Rubber Equalizer)
- Nev-R-Lube axles
- Dexter 3-3/8" x 12-1/4" self-adjusting electric brake aluminum welded both sides
- Commercial rated slipper springs suspension

#### OPTIONS

- Astro Foil™ insulation package
- Astro Foil™ in roof
- MOR/ryde® suspension IS (Independent Suspension)
- MOR/ryde pin box
- Electric/Hydraulic Disc Brakes
- Power rear stabilizing jacks
- Electric step (Kwiikee)

## **EXTERIOR**

### **STANDARD FEATURES**

- Slider windows @ ends of living area
- Escape window (bedroom)
- Radius safety glass windows
- GL 20 solar tinted glass
- Carefree patio awning w/metal wrap
- Prep for electric awning
- Awning rail w/gutter & down spouts
- Breakaway switch
- Custom molded one piece front & rear fiberglass caps
- Automotive style bumper
- Molded fiberglass cap under gooseneck
- Gelcoat fiberglass exterior sidewalls
- Custom painted graphics
- Custom raised decal package
- Gelcoat fiberglass rocker panels (dent resistant)
- Flush mount baggage doors 1" thick insulated w/struts
- Dead bolt door lock
- Mid ship turn signals
- Patio light - 12V
- 110V exterior recept (GFI)
- 110V recept in basement doorside
- TV outlet in basement doorside
- Rear Ladder (detachable)
- TPO vinyl roof
- Felt lined exterior compartments
- Basement storage w/2 - 4 access doors w/12V lights
- Fully enclosed polyflex underbelly
- Large 32 cubic foot front compartment for generator or added storage
- Courtesy light @ sewer hook-up
- Scare lights (4)
- LP tray - slide out
- Slider tray in storage compartment under bath area
- Exterior shower
- Fiber-optic lighted grab handle

### **OPTIONS**

- Accessory receiver w/bike rack
- Dual pane windows (w/GL 20 tinted glass)
- Carefree window awnings
- Electric Awning w/remote and auto retract
- Rear bay window awning
- Awning cover over slide-out (N/A Arizona room)
- Omega slide-out awning (where applicable N/A Arizona room)
- Manual box awning for Arizona room
- Electric box awning for Arizona room

## **ENTERTAINMENT**

### **STANDARD FEATURES**

- Cable TV hookup
- Satellite prep (RG-6 cable)
- RV video control center
- TV slide & swivel (N/A angled "E" centers)
- Television 27" Sony Wega
- VCR (stereo) Sony
- Stereo System - Sony Home Theatre Stereo System w/DVD

### **OPTIONS**

- KVH® auto satellite system

## **KITCHEN**

### **STANDARD FEATURES**

- Xelogen lights w/dimmer
- Corian counter tops - kitchen & bath w/ molded sink bowls, recessed range and cover
- Sink covers (2)
- Lift-off faucet
- Water purifier w/separate faucet
- Full pantry
- Kitchen island w/chrome pull-out pantry (374 & 378)
- Maytag sealed burner range
- Refrigerator: Norcold N821
- Solid oak expandable leaf dinette table w/ corian inlay
- Sharp Microwave (over range)

### **OPTIONS**

- Sharp Microwave (convection over range)
- Omega Cutting Board w/Work Center
- Stainless Steel Package (Microwave, Range, Refrigerator)
- Cooktop w/doors below (IPO oven)
- Refrigerator: Norcold N841 (w/ice maker)
- Refrigerator: Norcold 1200LR 4 door
- Refrigerator: Norcold 1200LRIM 4 door w/ice maker
- Refrigerator: Norcold 1200LRIDM 4 door w/ water in door (available w/ice maker only)
- Refrigerator: Norcold 10' N1095
- Refrigerator: Norcold 10' w/ice maker N1095IM
- Fisher/Paykel dish drawer (When cook top only)

## **LIVING ROOM**

### **STANDARD FEATURES**

- End table
- 12V wall lights above sofa
- Hide-A-Bed sofa w/pillows
- Thicker higher density foam in all furniture
- Stain resistant furniture fabric

- Recliner: wing back carrara
- Ceiling fan
- Chair @ desks w/knee holes
- Xelogen lights w/dimmer

### **OPTIONS**

- Recliner: leather swivel glider- flexsteel
- Coffee table
- Slide-Out Keyboard Tray @ desk

## **BATHROOM**

### **STANDARD FEATURES**

- Lav in stool room (374 & 378)
- Decorator brushed nickel shower enclosure
- Corian lavatory top w/stainless steel sink
- Bath towel rings
- Bath towel bars
- Brushed nickel light bar - medicine cabinet
- Oversized medicine cabinet
- Brushed nickel single lever faucet
- Porcelain stool (elongated bowl) & tissue holder
- 12V Vent in stool room
- Shower bubble w/shade (16 x 24)
- Neo-angle shower
- Armstrong® HPL Flooring
- Carpet runner @ shower

### **OPTION**

- Full size garden tub (fiberglass)(N/A 374/378)

## **BEDROOM**

### **STANDARD FEATURES**

- Prep for 2nd air conditioner in bedroom
- Deluxe fitted bedspread w/pleated skirt & pillows
- Wood headboard with fabric inlay
- Deluxe brushed nickel mirrored sliding wardrobe doors (select models)
- Built in night stands each side of bed (select models)
- Accent prism lights 2 each side of bed
- Bedroom slide-out
- Wood facer on slide-out
- Cedar lined wardrobes
- Queen Pillow Top mattress
- Floor safe
- Bedroom Bench Seat (CW382)
- Xelogen lights w/dimmer

### **OPTIONS**

- King bed (382 only)
- Television 13" Sony Wega (Bedroom)
- Work station IPO chair (374 only)

# Carriage

## 2006 CARRIAGE SPECIFICATIONS

CARRIAGE	CW374	CW378	CW382
Approx. Exterior length	37' 11"	37' 11"	38' 5"
Approx. Exterior width	100"	100"	100"
Approx. Exterior Height w/AC1	12' 11"	12' 11"	12' 11"
Approx. Dry Axle Weight*	12,055	11,920	11,680
Approx. Hitch Weight*	2,815	2,915	2,740
Approx. Total Dry Weight*	14,870	14,835	14,420
Approx. Average Load Capacity	3,945	4,080	4,320
Axles ( number of )	2	2	2
Fresh Water Capacity w/water heater **	82 Gal.	82 Gal.	82 Gal.
Black/Gray Holding Tank Capacity	38/72 Gal.	38/72 Gal.	38/72 Gal.

\* Above listed weights are actual units that include all slide out rooms and all popular options ordered on most coaches. These weights are provided as a guideline only. The actual weight of each individual unit (all units are weighed as they come off the production line) is posted inside each vehicle.

\*\* Fresh water capacity includes the combined capacity of the fresh water tanks and the water heater.



# Carriage



Visit our Website.

[www.carriageinc.com](http://www.carriageinc.com)

Post Office Box 246 • Millersburg, Indiana 46543 • (574) 642-3622

© 2006 Carriage, Inc. Printed in U.S.A.

Due to continual improvement of Carriage Inc. products, we reserve the right to change material, colors, specifications and prices at any time without prior notification. Selected decorator items used in the photos are not part of the product. Carriage, Inc. assumes no responsibility for any error in type or print reproduction of specifications or color in this brochure.



## LUXURY BEYOND ALL EXPECTATIONS

A PLACE YOU CAN CALL HOME.

Our kitchens are designed for work efficiency as well as beauty with full-size name brand appliances, double bowl molded sink, and deep solid wood cabinets to go along with the upscale solid surface countertops.



FULL PANTRY AND LOCATION OF OPTIONAL WASHER AND DRYER COMBO



CARRIAGE MODEL 374 IN SANDLEWOOD DECOR



OPTIONAL 4-DOOR REFRIGERATOR WITH WATER IN THE DOOR



[WWW.CARRIAGEINC.COM](http://WWW.CARRIAGEINC.COM)

Bedroom Vanity: the CW378 features this large island vanity located in the bedroom. On all floorplans, you'll enjoy the style and convenience of a solid surface vanity counter-top with integrated sink.

**LUXURY BEYOND ALL EXPECTATIONS  
A PLACE YOU CAN CALL HOME.**



CARRIAGE MODEL 378 IN CYPRESS DECOR

# 2006 CARRIAGE



## QUALITY CRAFTSMANSHIP

After building RVs for over 37 years, we have gained our customers' respect through hard work and unwavering support. We have earned a reputation as the industry innovator, leading the way in style and design. We have always been dedicated to using the finest quality materials to create an RV that delivers you to what we refer to as the best fifth wheel in the industry. Our units are built for those with discriminating taste who can appreciate the Carriage difference. Quality craftsmanship and the underlying sense of family pride that is built into each unit. We have a history in this business. We have been committed to excellence for over 37 years and will be there for you in the future.



**THIS IS THE BEST WARRANTY IN THE RV INDUSTRY.**

No Exclusions for full timers. Unlike our competition, we want you to enjoy our coaches year-round.



## WHY CARRIAGE

We stress the importance of quality in manufacturing. With superior quality come reliability, durability, and most importantly, customer satisfaction.

Quality that has withstood the test of time. We are a progressive thinking company mindful of the future. We continually explore new directions in search of the best equipment and designs. We devote much of our attention to the engineering of our units to maximize the full potential of every component. It's more than our stunning interiors that set us apart from other manufacturers. The quality of what we use to achieve that look on the inside is just as important as what we use on the outside and underneath, even where you might not first glance. Looking below the surface of each unit is where you will begin to understand what makes a Carriage so unique. We insist on meticulous installation of all the components on every coach. Adding the exquisite interior fabrics and custom made cabinetry and furniture to the top quality foundation we create for every unit makes for an incomparably finished unit, unequalled and unavailable anywhere else in the industry.

The Carriage has exterior pass-through storage. It's the perfect place for golf clubs, tennis rackets and any other sports equipment to make your time on the road more enjoyable.

### CYPRESS



### JUNIPER BERRY



### SANDALWOOD

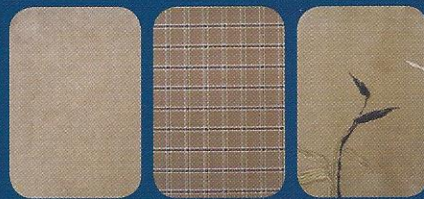

**TIMELESS DESIGN COBBLESTONE | CARPET FOR ALL**



**CORIAN TOP EDGING**

# 2006 CARRIAGE



**CARRIAGE EXCLUSIVE WARRANTY  
THE BEST WARRANTY AVAILABLE PERIOD.**



**THIS IS THE BEST WARRANTY IN THE RV INDUSTRY.**  
No Exclusions for full timers. Unlike our competition, we want you to enjoy our coaches year-round.



**INDUSTRY LEADING SIXTH TIME  
QUALITY CIRCLE AWARD WINNER**

Carriage Inc. received it's industry leading sixth (6) Quality Circle Award in December 2004. Dealer Satisfaction in areas such as sales, product management, and service/warranty support. It is in these products, that are designed and built by our outstanding groups of employees, that makes this award possible. We are most proud of this recognition, because it is voted on by our dealer body, not industry peers.

**CARRIAGE USES QUALITY COMPONENTS FROM THESE MANUFACTURERS:**



**YOUR LOCAL CARRIAGE DEALER:**

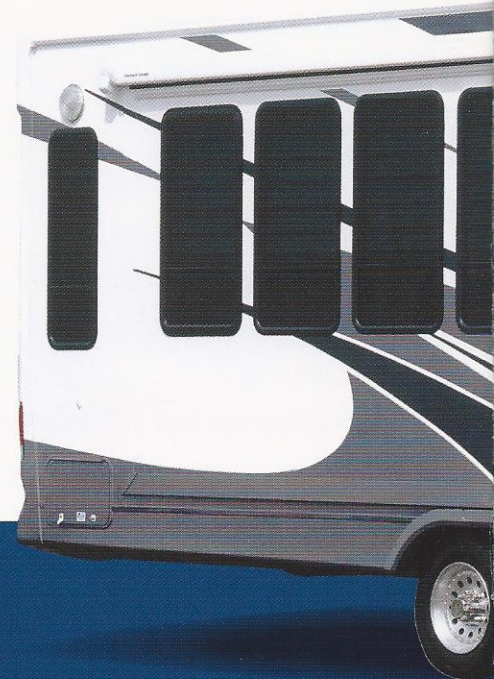

**POST OFFICE BOX 246 MILLERSBURG, INDIANA 46543  
(574)-642-3622**

**WWW.CARRIAGEINC.COM**



Due to continual improvement of Carriage Inc. products, we reserve the right to change material, colors, specifications and prices at any time without prior notification. Selected decorator items used in the photos are not part of the product. Carriage, Inc. assumes no responsibility for any error in type or print reproduction of specifications or color in this brochure.