

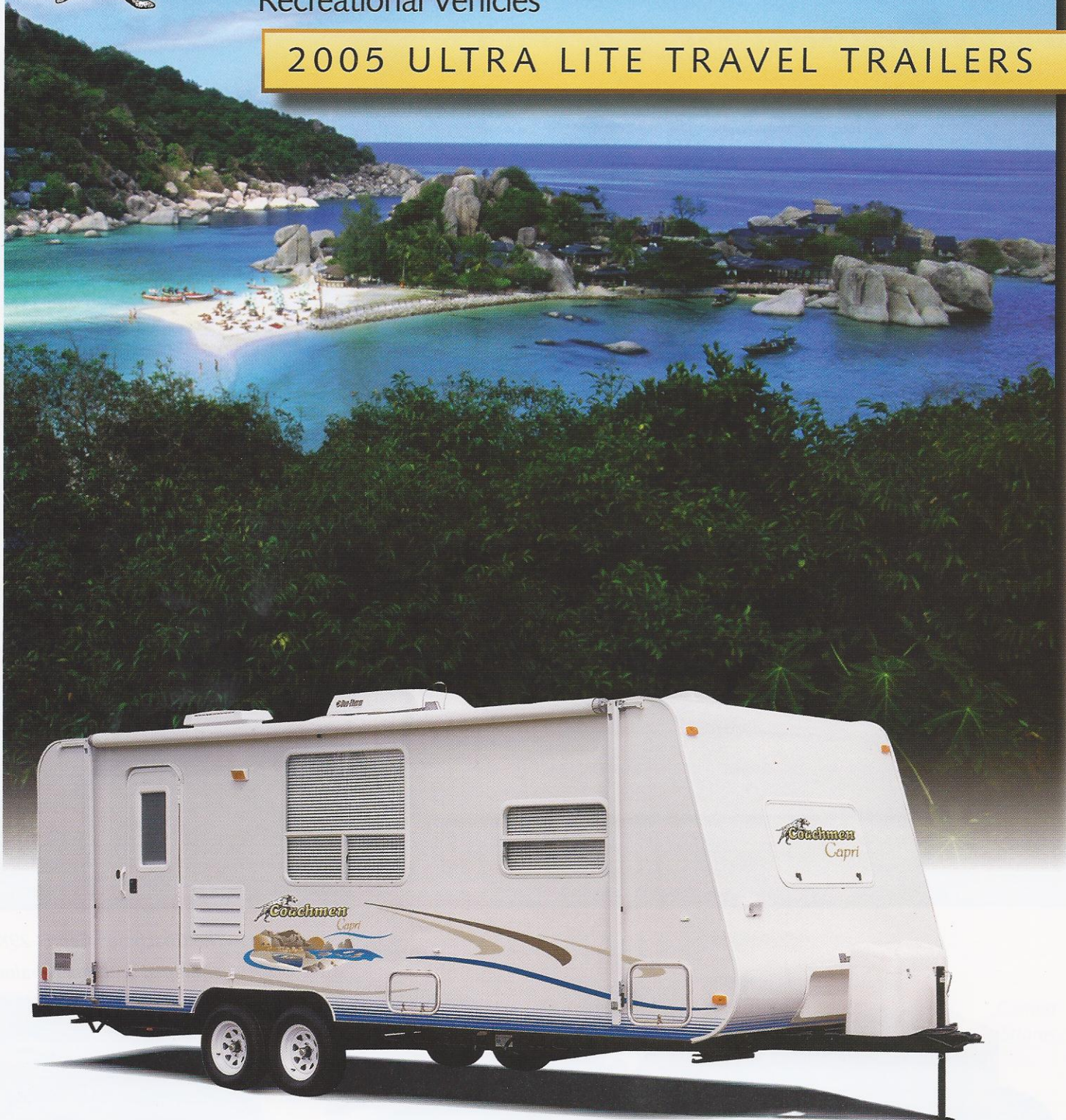

Coachmen[®] CAPRI[™]

Recreational Vehicles

2005 ULTRA LITE TRAVEL TRAILERS



SHARE GREAT TIMES TOGETHER



Coachmen CAPRI™

Recreational Vehicles

2005 ULTRA LITE TRAVEL TRAILERS

Make every moment count.

It's time to get away from it all with the Coachmen Capri™. Take along friends, the kids...even the family pet! Travel with the comforts and conveniences of home.

Make your own schedule.

Go where you want...when you want.

Ample storage means you can pack as little or as much as you need. Experience the freedom of the open road.



The Coachmen Capri™ 29KS is equipped with many valuable features, such as a high spout faucet, laminated self edge countertops, undersink silverware drawer, durable mortise and tenon cabinet door construction, and designer box valances... just to name a few.

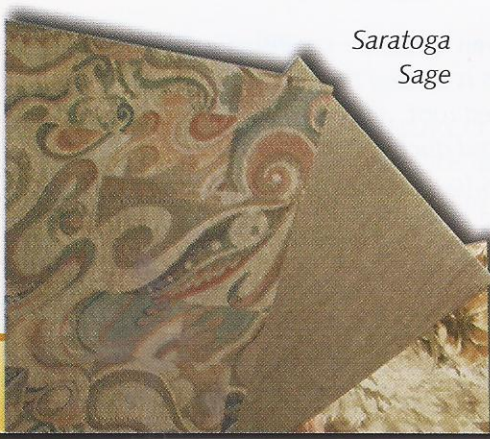

*Saratoga
Sage*

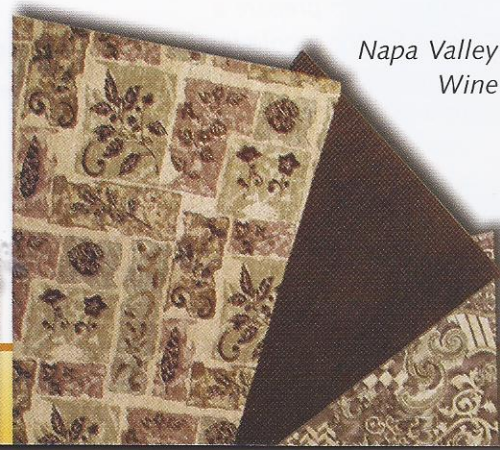

*Napa Valley
Wine*



*Cameo
Shores*



Coachmen®

Recreational Vehicles

CAPRI™

2005 ULTRA LITE TRAVEL TRAILERS



The deluxe 12V AM/FM stereo with CD player is conveniently mounted underneath the overhead cabinets so it is up and out of the way. (Key Largo package)



Our standard metal drawer guides with glide wheels provide a friction free sliding drawer that is extremely durable. The drawer glides also act as a catch so that the drawer will not slide open during travel. Simply lift up and pull to open the drawers.



The double door refrigerator is designed for maximum storage capacity with door storage and a handy freezer shelf. A convenient refrigerator light is also standard for those midnight cravings. (Key Largo package)



Even Cool™
By Coachmen

The Even Cool™ air conditioning system is ducted through the crowned roof, and utilizes AMOCO® insulated ductwork with radiused corners to provide for maximum cooling efficiency. (19DB non-ducted)



The Capri™ galley is fully equipped to prepare a feast for the whole family with a high spout faucet, optional microwave and conventional oven. An under sink silverware/utensil drawer is included to maximize interior storage space.

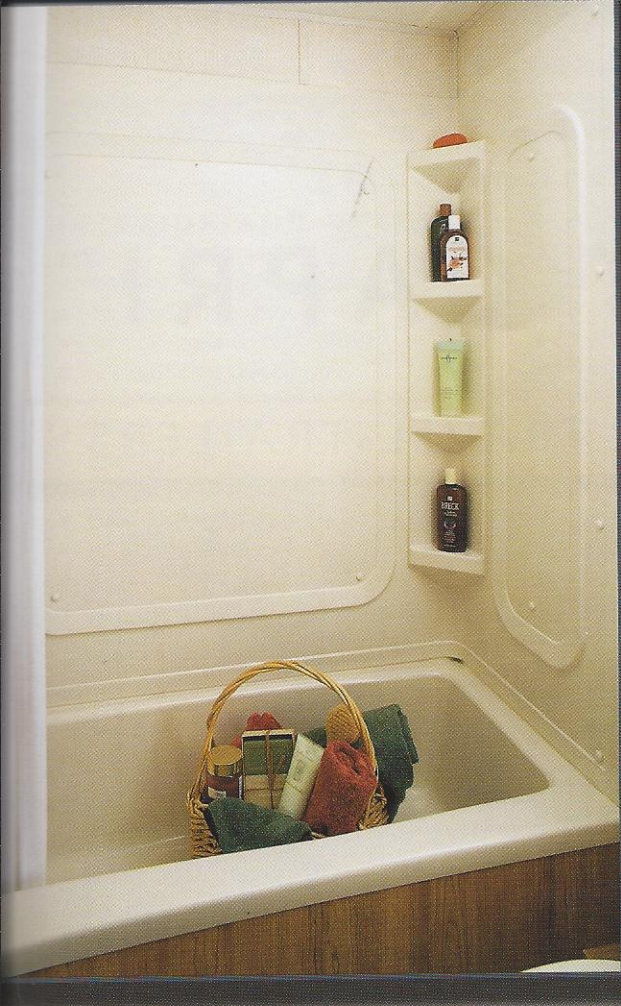

A one piece ABS tub surround provides a protective wall barrier with an easy to clean seamless surface, and built in shelving for your shower supplies. (Key Largo package)

Capri™ features fully independent torflex suspension for improved towability and a smoother ride for the trailer.

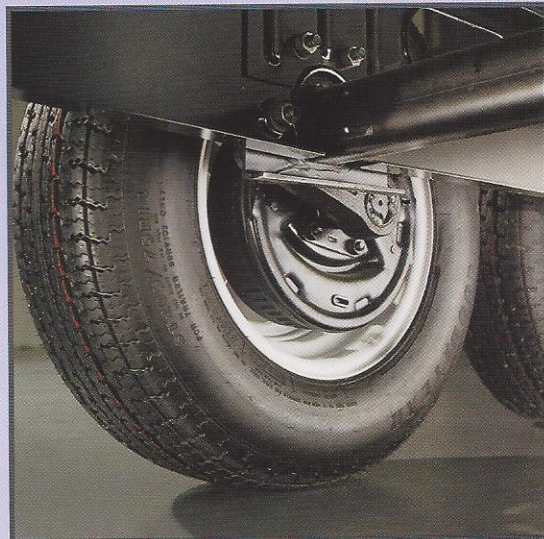

ALUMICAGE™ CONSTRUCTION

By Coachmen

All Coachmen Capri™ Ultra Lite travel trailers feature **Alumicage™ construction**. This lightweight, corrosion resistant, aircraft grade aluminum material is utilized throughout the roof, walls and floor for superior strength and ultra light weight.



The Flair-It™ compression fitting water line system uses radius bends to reduce the number of fittings used by over 50%. Where connectors are needed, a compression fitting ensures a long term, tight seal.

All Coachmen Capri™ travel trailers utilize **Duratube™ full length copper LP lines** with double flared ends to ensure a tight seal and years of corrosion free use. Coachmen builds in quality for the long haul.

The lightweight **NORCO sectional frame** is fastened together with huck fasteners (the same fasteners used on the HUMMER). This frame is the ultimate combination of lightweight and durability.





Couchmen®

Recreational Vehicles

CAPRI™

2005 ULTRA LITE TRAVEL TRAILERS

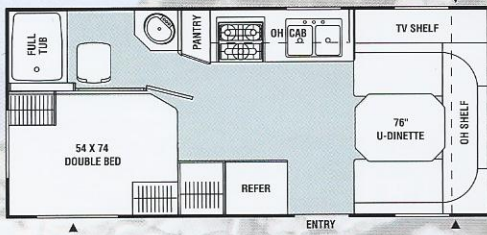

19DB/Double Bed

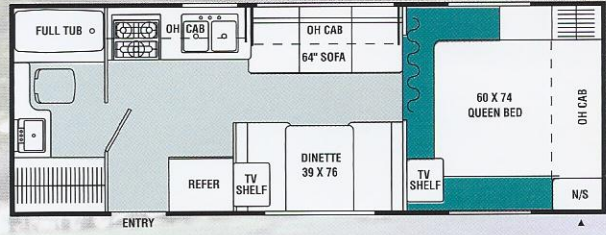

24QRB/Queen Bed

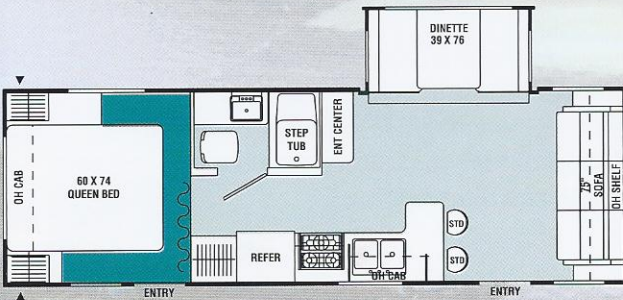

27DS/Dinette/Slide Out

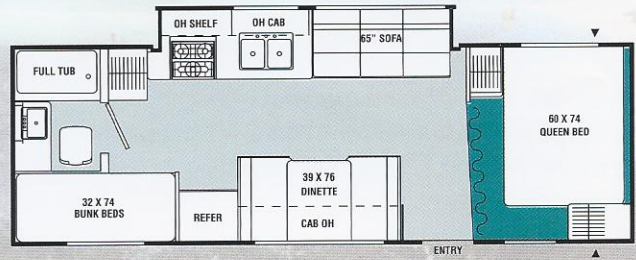

27TBS/Two Bedroom/Slide Out

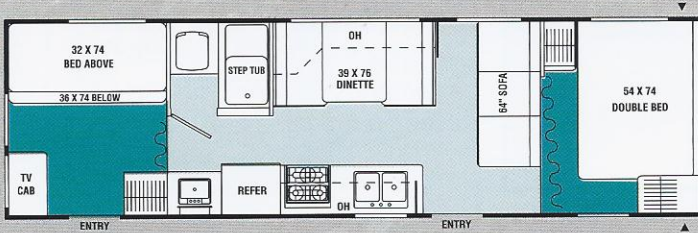

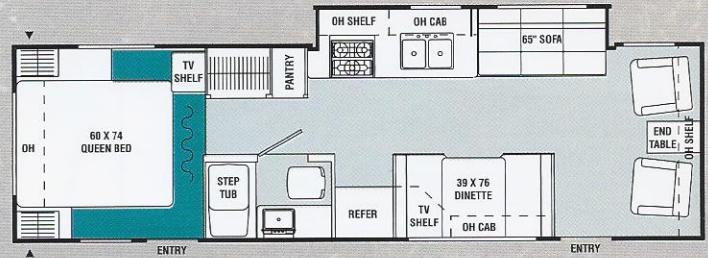

29TB/Two Bedroom

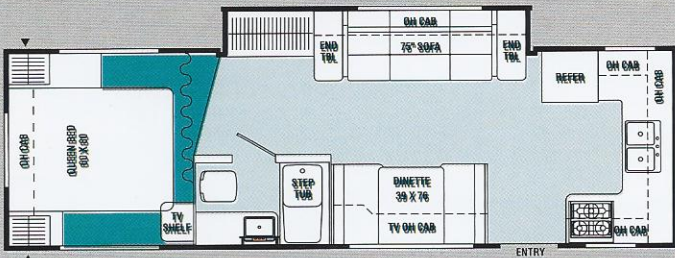

29KS/Kitchen Slide Out



29FKS/Front Kitchen/Slide Out

-  Optional Carpet
-  Linoleum
-  Storage Areas

COACHMEN CAPRI™ TRAVEL TRAILERS

STANDARD FEATURES

INTERIOR AND DECOR

- Ashland Oak Cabinetry
- Linoleum Flooring Throughout
- Mini Blinds Throughout
- Jack Knife Sofa (Except 19DB)
- Two Bar Stools (27DS)
- Dinette
- TV Antenna Ready
- Cable TV Jack
- LP Leak Alarm
- Techwood® Drawers
- Fire Extinguisher
- Smoke Detector
- Mortise & Tenon Cabinet Doors

GALLEY

- Microwave Ready
- 3-Burner High Output Range Top
- Power Range Hood
- Large Single Door Refrigerator
- Monitor Panel
- White Composite Double Bowl Sink
- High Spout Faucet
- Silverware Drawer

SLEEPING

- Double Bed (29TB)
- Corner Double Bed (19DB)
- Queen Bed (24QRB, 27DS, 27TBS, 29KS)
- 80" Queen Bed (29FKS)
- Bunk Beds (27TBS)
- Twin Bed w/Bunk Above (29TB)

ELECTRICAL/HEATING/ AIR CONDITIONING

- GFI Circuit
- Outside Receptacle GFI
- Patio Light

- LP Light
- Double 20 LB LP Bottles w/Auto Change-Over
- 20,000 BTU E.I. Furnace (19DB)
- 25,000 BTU E.I. Furnace (Except 19DB)
- Wiring for Radio
- 12V Outlets (3)

BATH AND WATER

- Marine Toilet
- Power Bath Vent
- 6-Gallon Gas E.I. Water Heater
- Water Heater By-Pass Valve
- Demand Water Pump
- Decorative Bath Hardware
- Medicine Cabinet

EXTERIOR/CONSTRUCTION

- Filon® Fiberglass Sidewalls
- Radius Windows w/Safety Glass
- Rigid Insulation (Walls/Floor)
- Fiberglass Insulation (Roof)
- Aluminum Cage Construction
- Gutter Rail with Awning Rail
- Single Entry Step
- Dead Bolt Lock(s)
- Radial Tires
- Rally Wheels
- Pass Through Storage
- Galvanized Wheel Wells
- Break Away Switch
- Rubber Roof
- Retractable Stabilizer Jacks (Std. on Slide Out Units)
- Norco Lightweight Sectional Frame
- Electric Slide Out (All Slide Models)
- Owner's Information Guide

OPTIONAL FEATURES

KEY LARGO

PACKAGE INCLUDES:

- Innerspring Mattress (Main Bed)
- Bedspread(s) & Shams (All Beds)
- Partial Carpet (Except 19DB)
- TV Antenna
- 12V AM/FM CD Stereo
- Flush Mount, Double Door Refrigerator
- Microwave Oven
- 3-Burner Range w/Oven (N/A 27TBS & 29KS)
- One-Piece ABS Tub Surround
- Skylight Over Tub (Except 19DB)
- 13,500 BTU Ducted Roof Air (Non-ducted 19DB)
- Double 30# LP Bottles w/Auto Change-over
- Patio Awning
- Front Window w/Stoneguard Awning
- Pull-out Storage Tray (Except 19DB)

ADDITIONAL OPTIONS:

- CSA Upfit
- Double Bed Down/Bunk Up (19DB)
- Spare tire

During the product year, it may become necessary to produce Coachmen products with different components than initially specified. All such changes are approved for use by Coachmen in order to maintain the quality standards associated with the Coachmen name. All illustrations and specifications contained in this literature are based on the latest product information at time of publication. Coachmen reserves the right to make changes in prices, colors, materials, equipment and specifications, and to discontinue models at any time without notice. Check with your Coachmen dealer for more information if you have specific questions.

COACHMEN CAPRI™ TRAVEL TRAILER SPECIFICATIONS

	19DB	24QRB	27DS	27TBS	29TB	29FKS	29KS
Base Weight	3,301	3,818	4,510	4,374	4,438	4,751	4,746
GVWR (lbs.)	5,260	6,030	6,340	6,300	6,390	6,290	6,250
Carrying Capacity	1,959	2,212	1,830	1,926	1,952	1,539	1,504
Hitch Weight	460	470	620	580	670	570	530
Axle Weight	2,841	3,348	3,890	3,794	3,768	4,181	4,216
Interior Height	76"	76"	76"	76"	76"	76"	76"
Exterior Height*	8'9"	8'9"	8'9"	8'9"	8'9"	8'9"	8'9"
Exterior Length	21'8"	25'2"	27'11"	27'11"	30'11"	30'11"	30'11"
Exterior Width	7'10"	7'10"	7'10"	7'10"	7'10"	7'10"	7'10"
Hitch Pin Height	18"	18"	18"	18"	18"	18"	18"
Sleeping Capacity	4	6	6	8	8	6	6
Fresh Water Capacity (gal.)	29	29	29	29	29	29	29
Waste Water Capacity (gal.)	28	28	28	28	28	28	28
Grey Water Capacity (gal.)	32	32	32	32	32	32	32
Water Heater Capacity (gal.)	6	6	6	6	6	6	6
LP Gas Capacity (lbs.)	40/60	40/60	40/60	40/60	40/60	40/60	40/60
Furnace Rating (x1,000) BTU	20	25	25	25	25	25	25
Tire Size	ST205/75R14B	ST205/75R14B	ST205/75R14B	ST205/75R14B	ST205/75R14B	ST205/75R14B	ST205/75R14B

*Add 8" for Roof Air Conditioner



Coachmen®

Recreational Vehicles

CAPRI™

2005 ULTRA LITE TRAVEL TRAILERS

YOUR AUTHORIZED DEALER

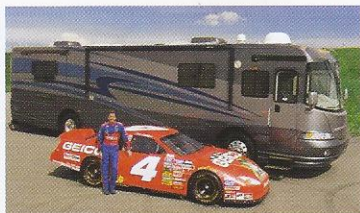

LIFE IN THE FAST LANE

NASCAR driver Mike Wallace makes a Coachmen RV motorhome his home on the road. The middle brother of auto racing's famed Wallace family, Mike is a veteran of NASCAR's racing circuit.

Jerry's Trailers & Campers
2601 South 13th St.
Norfolk, NE 68701
(402) 371-1306



Leader to the Great Outdoors®

Coachmen Recreational Vehicle Company, LLC ■ P.O. Box 30 ■ Middlebury, IN 46540
Visit our website at: www.coachmenrv.com

©2004 Coachmen Recreational Vehicle Company, LLC. ■ All Rights Reserved ■ Litho in USA 6/04