

# Tail-gator



*Cargo Travel Trailers and Fifth Wheels*

*E-Z Load and Hit the Road*



*Tail-gator is loaded with innovative features to make traveling with your toys and other large cargo a pleasant adventure instead of a chore...*

**2002**

# Tail-gator

**“Room for the Things That Move You**

Tail-gator makes traveling with your toys and any other large items a pleasant adventure, never a chore. The warm, carefully designed interiors make your adventurous life completely relaxing and convenient. You and your toys will be safe, secure, and comfortable.



## Interiors Designed for Your Pleasant Journey

Above, Tail-gator's 278RR in Sage Green. Tail-gator's innovative models offer incredible fashion and comfort while still providing secure transportation of your favorite toys! The 278RR sports a popular feature, the front bedroom with private bathroom. The twin hideaway sofas offer comfortable seating/sleeping, yet take up little cargo space while in the "up" position. Tail-gator's new pull-down queen bed is available in all four travel trailer models. At right, note the residential-style deep-bowl sink with high-arch faucet and the tip-out drawer for extra storage.

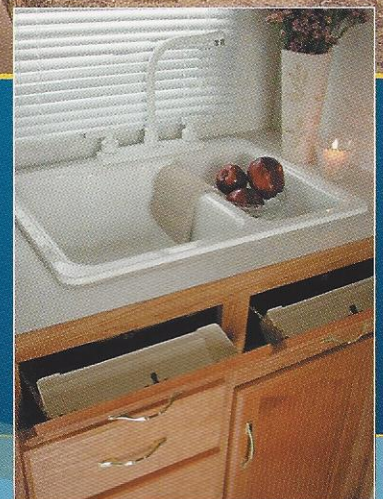

**EASY C  
LONGE**

cargo  
signed  
portable.

## Exterior Details



Optional "RV-Que" Gas Grill

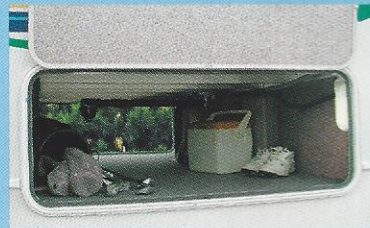

Lighted Pass-Thru  
Storage Compartment



Optional Fueling Station



Recessed Floor Tie-Downs

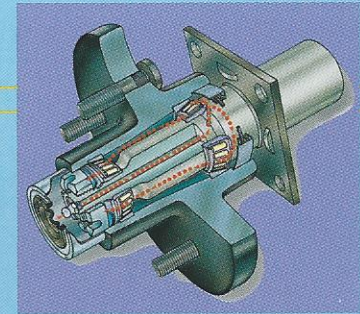

ALKO EZ-Lube Axles



### **TAIL-GATOR FIFTH WHEEL CONSTRUCTION— STRONG, YET LIGHTWEIGHT FOR OPTIMUM TOWABILITY**

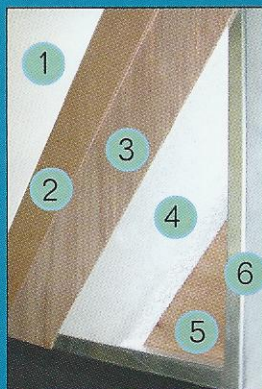

*Tail-gator Fifth Wheel  
Six-layer Laminated  
Construction*

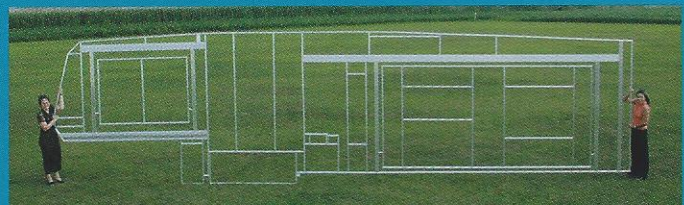

Because of the increased size, Tail-gator high-profile fifth wheels use the latest in engineering design and construction techniques. By utilizing a state-of-the-art, six-layer lamination process with aluminum sidewall framing, we have achieved the ultimate balance in strength and towability.

### **HIGH-PROFILE FIFTH WHEEL CONSTRUCTION**

1. Fiberglass Exterior
2. Outer Luan Panel
3. Inner Luan Panel
4. Dense Block Foam Insulation
5. Interior Paneling
6. Tubular Aluminum Frame

### **OPEN-AND-CLOSE RAMP— R DOOR PROVIDES LOWER RAMP ANGLE**



# Tail-gator

MODEL	210RR	251RR	278RR	298RR	329T5
GVWR	10190	10800	11220	11180	12140
Gross Dry Weight	5190	5800	6790	7130	7880
Carrying Cap.	5000	5000	4430	4030	4260
Hitch	720	850	775	875	1980
Dry Axle Weight	4940	5530	6140	6590	6200
Ext. Length	24' 0"	28' 0"	30' 10"	33' 11"	34' 6"
Ext. Width	8'	8'	8'	8'	8'
Ext. Height (Top of A/C)	11' 2"	11' 2"	11' 2"	11' 2"	12' 8"
Fresh Water Cap.	100	100	100	100	122
Waste Water Cap.	28	28	38	38	38
Grey Water Cap.	32	32	42	42	43
LPG Cap. (lb.)	60	60	60	60	60
Tire Size	225/ 75R15	225/ 75R15	225/ 75R15	225/ 75R15	225/ 75R15

## ROOM FOR THE THINGS THAT MOVE YOU

## STANDARD FEATURES

- Outside Shower • Patio Awning
- 3-Burner High-Output Range w/ Oven • AM/FM Stereo Cassette
- Cable TV Hook-up • Power Vent in Bathroom • LP Leak Detector • Double-Door Refrigerator • Four Stabilizer Jacks • 13,500 BTU Air Conditioner • Large Microwave
- TV Antenna and Booster
- Furnace • Skylight in Bathroom
- Front Ladder • Walk-On Rubber Roof • Sink Cover • Water Heater Bypass Kit • Recessed Tie-Downs
- Mini Blinds • High-Rise Kitchen Faucet • 60/40 Large Bowl Designer Sink • Rain Gutters with Spouts • Electric Front Jacks (329T5 Only) • Extra-Wide EZ-Lube Axles

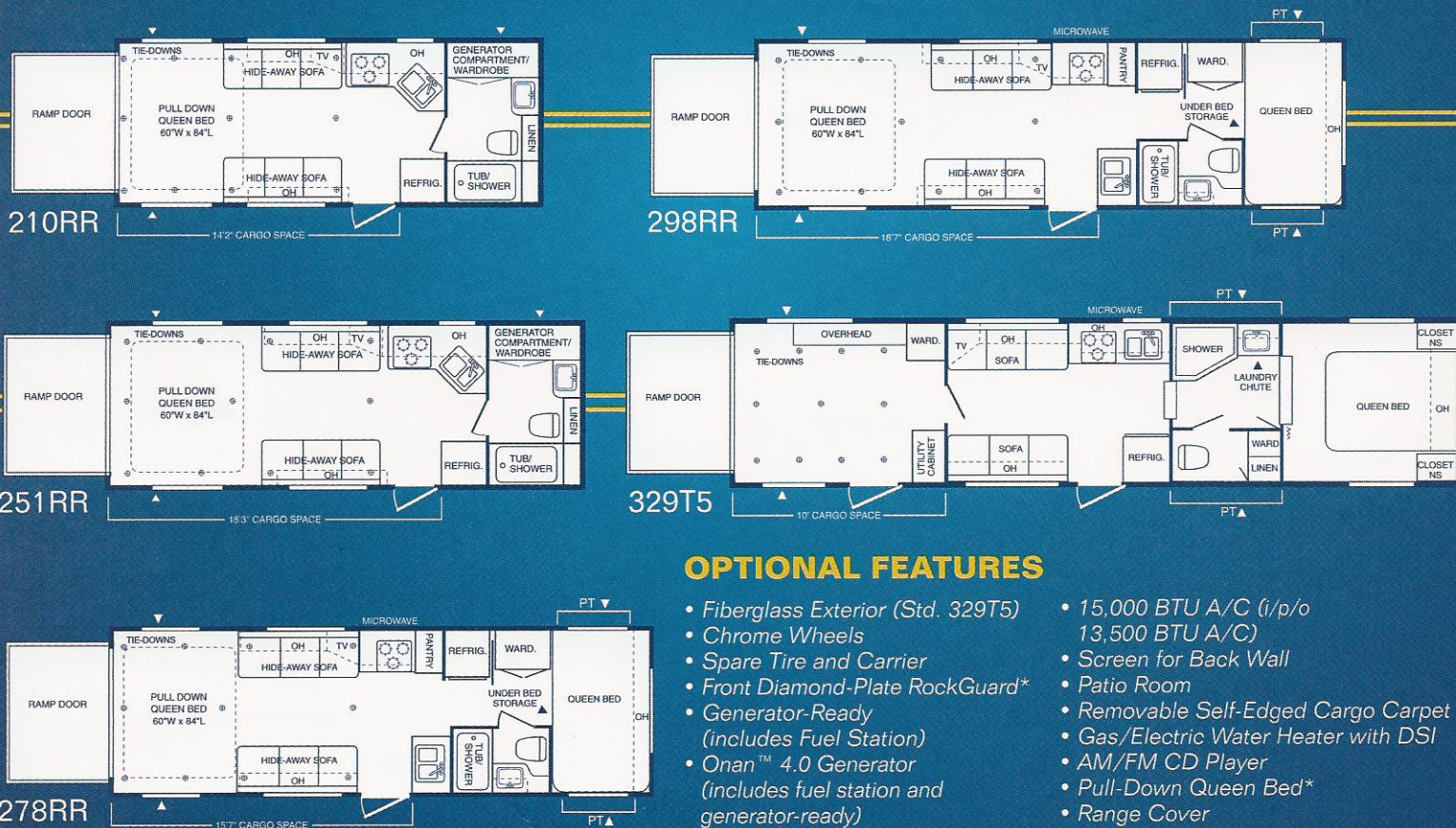

## OPTIONAL FEATURES

- Fiberglass Exterior (Std. 329T5)
- Chrome Wheels
- Spare Tire and Carrier
- Front Diamond-Plate RockGuard\*
- Generator-Ready (includes Fuel Station)
- Onan™ 4.0 Generator (includes fuel station and generator-ready)
- "RV-que" - Outside Grill
- Fiberglass Front Cap (329T5 Only) (Deletes Front Ladder)
- 15,000 BTU A/C (i/p/o 13,500 BTU A/C)
- Screen for Back Wall
- Screen Room
- Removable Self-Edged Cargo Carpet
- Gas/Electric Water Heater with DSI
- AM/FM CD Player
- Pull-Down Queen Bed\*
- Range Cover
- Bedroom Cable TV Hook-up

\*Travel Trailers Only

## Your Tail-gator Dealer:

**JERRY'S TRAILERS & CAMPERS**  
 2601 S. 13th St.  
 Norfolk, NE 68701  
 (402) 371-1306



**Keystone RV Company**

17400 Hackberry Drive Goshen, IN 46526  
 (219) 642-4590 www.keystone-goshen.com

Product information and photography are as accurate as possible at the time of publication. Colors and finishes are photographic representations and may appear differently when viewing actual materials. Some features shown are optional. Features, floorplans, and specifications are subject to change without notice. \*Carrying capacity is based on an even distribution of loading throughout the vehicle. Owners should use good judgment when loading. Overloading or misuse may void all warranties. 10/01

