

2002 CAPTIVA *Ultra Lite* TRAVEL TRAILERS & FIFTH WHEELS

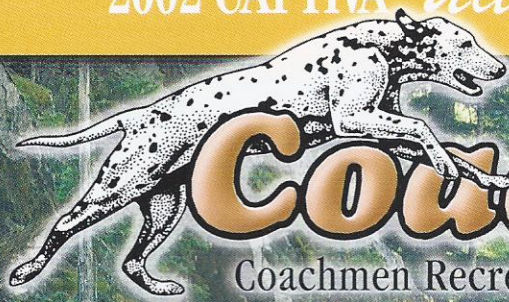

Coachmen[®]

Coachmen Recreational Vehicle Company, LLC

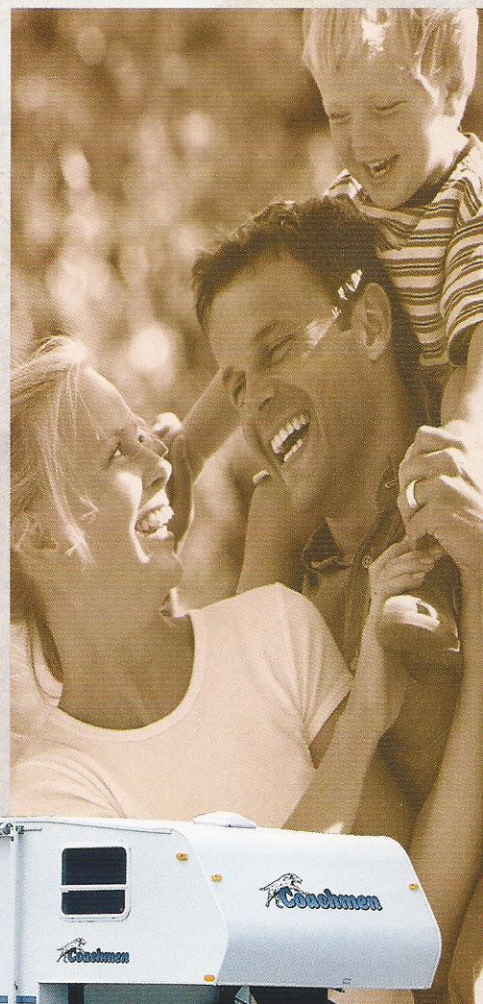
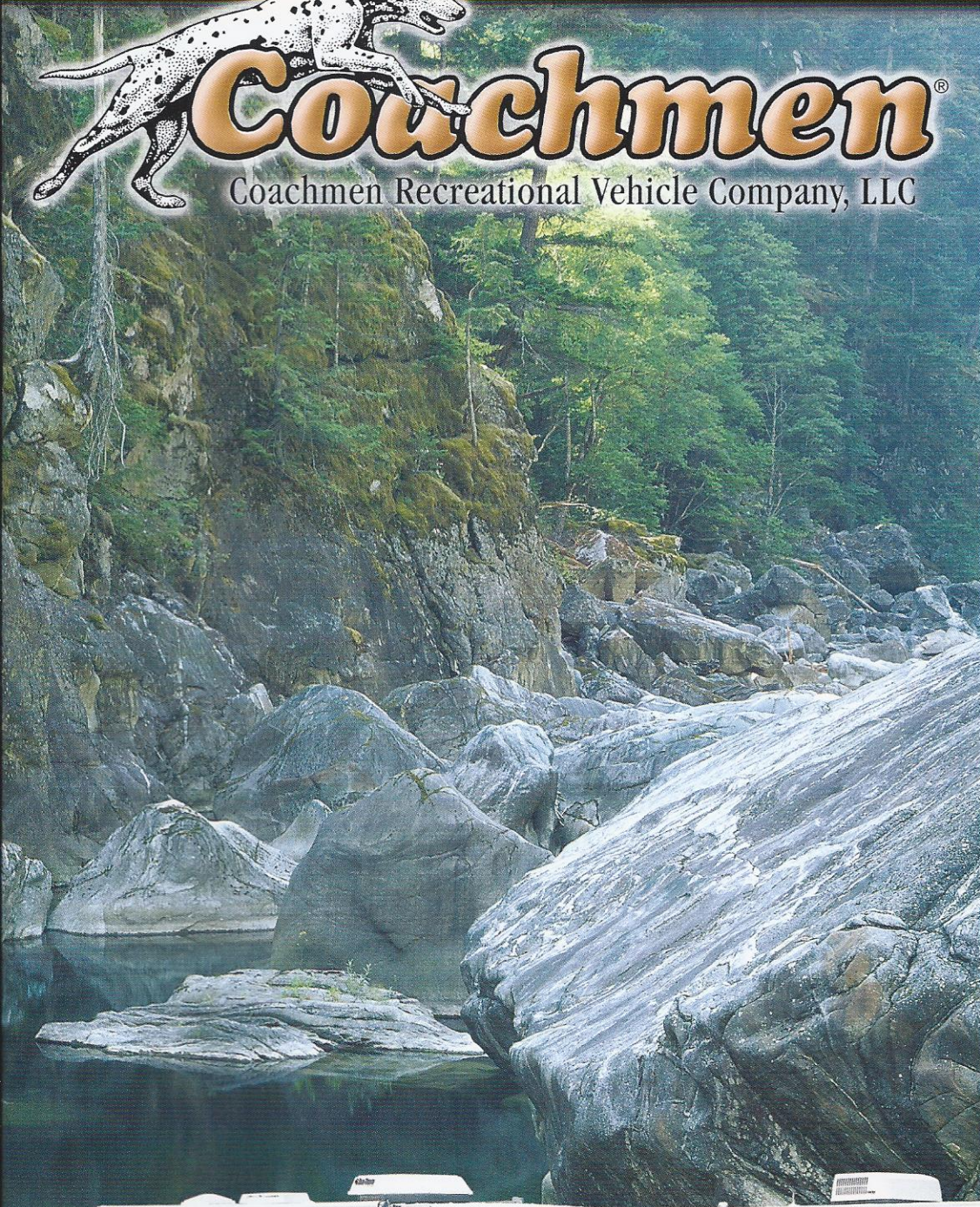

“Leader to the Great Outdoors”

Put Some Adventure in Your Life!

The exciting new Captiva line of travel trailers and fifth wheels by Coachmen RV is designed with the light truck, mini-van and sport utility owner in mind. The travel trailer boasts a pre-engineered, ultra lite weight steel frame for a solid foundation with easy towability. Standard Torflex® axles allow for increased ground clearance while still maintaining a low aerodynamic profile. Computer aided weight distribution provides a smoother more stable tow on bumpy roads or windy days. The Captiva line is value equipped with aluminum cage construction, laminated floors and sidewalls, mortise and tenon cabinets, large pass through storage and countless other amenities.

The new Captiva is a reliable, value added, light weight unit backed by a Company you can count on. With the sleek, light weight design of the Captiva, towing has never been easier.

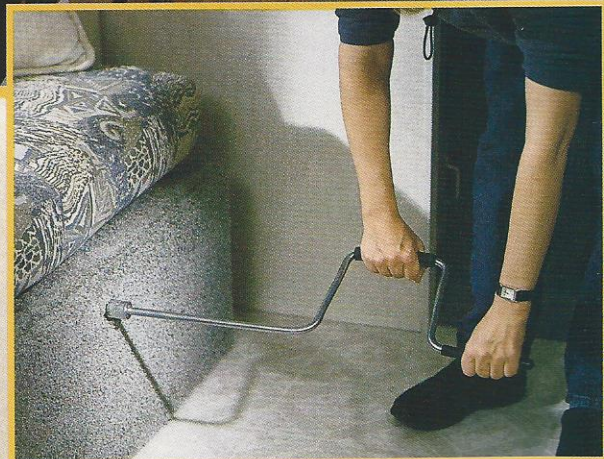
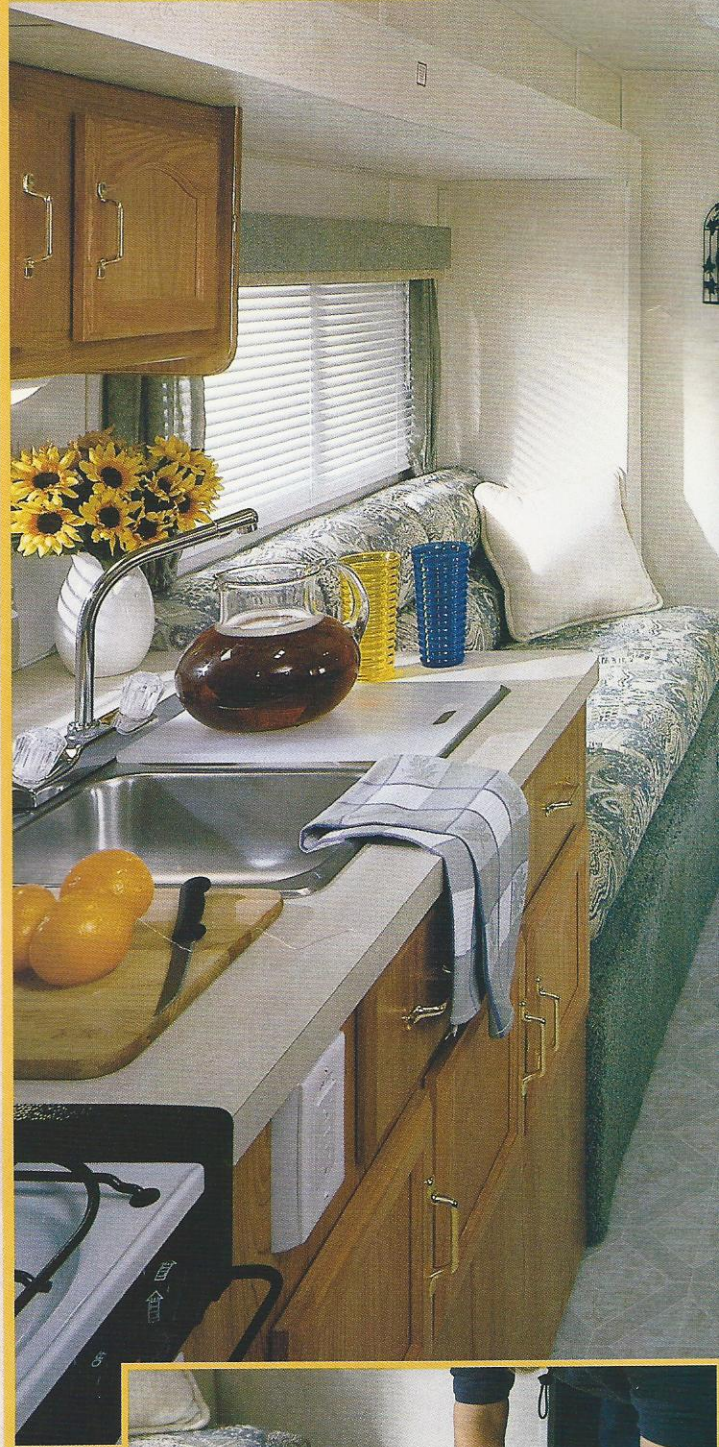

Easy access to the manual slide mechanism increases your living space quickly and efficiently. The slide mechanism is also drill adaptable.

2002 CAPTIVA *Ultra Lite* TRAVEL TRAILERS & FIFTH WHEELS



The spacious slide room in the Captiva 277TBS offers a huge livable area with a residential feel.



Roomy pass through storage makes short work of stowing gear.

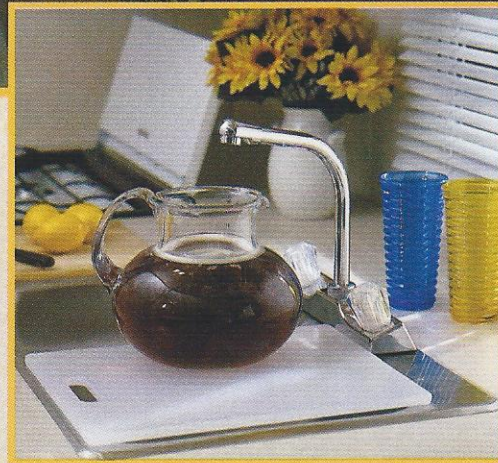

High faucets make kitchen duties a snap.

Outstanding Service and Warranty

For over 35 years Coachmen RV has been leading the RV Industry in product design, dependability and customer service support. We work very hard to have our products exceed your expectations. Equally important is the service that we provide during your ownership experience. Whether it be information about your unit, reliable warranties, or industry leading service support... Coachmen RV ranks second to no one.



(Optional owner's information packet)

Buckstopper Warranty

Your Owner's registration card and our famous Buckstopper Limited Warranty is your passport to worry free travel. Our nationwide network of approximately 300 authorized Coachmen Service Centers stand ready to provide you with courteous, dependable and timely service.

Two Year Structural & Major Components Manufacturers Warranty

In addition to your One Year Buckstopper Limited Warranty, you can travel with confidence knowing that select major structural components such as walls, ceilings, and floors are covered for two years by Coachmen's extended Structural Limited Warranty. Coachmen product also comes with a limited Two Year Major Component Manufacturer's Warranty on select components. Please refer to our Product Warranty Summary Guide for complete details.

Service Assistance

Coachmen's Service & Parts Department is staffed with trained professionals that are committed to satisfying your needs. Coachmen provides a toll free service number for your assistance and convenience. And for those rare instances that a replacement part is required for your coach, Coachmen RV provides a Priority Customer Parts Order program for overnight part shipments in critical repair situations.



Coachmen RV features a complete parts and service center at the Middlebury, Indiana complex. Relax during your visit in our comfortable parts and service lounge.

Service Support Center Web Site

Presented as an option under the Coachmen RV Company web site (coachmenrv.com), this informative site offers:

- A Service Dealer Locator System
- Maintenance Information
- Troubleshooting Information
- Product Warranty Summary Information
- Customer "E-Assistance" Access ...and more

Visit our site and see for yourself that Coachmen RV is committed to taking care of our customers.

Ultimate Satisfaction – First®

Coachmen RV owners regularly receive comprehensive surveys through our Ultimate Satisfaction – First (US1 Program). US1 questionnaires provide us with valuable information regarding our customers' products as well as the purchase and ownership experience. Listening to our customers helps us achieve your...**"Ultimate Satisfaction – First"**.





2002 CAPTIVA ULTRA LITE TRAVEL TRAILERS & FIFTH WHEELS FLOORPLANS AND SPECIFICATIONS



2002 CAPTIVA *Ultra Lite* TRAVEL TRAILERS & FIFTH WHEELS

"Leader to the Great Outdoors"

Travel Trailer Floorplans

199db / Double Bed



249qb / Queen Bed

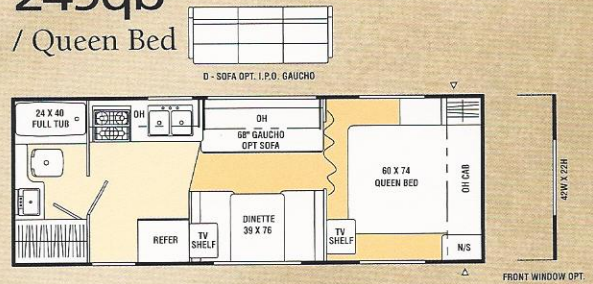

275ds / Dinette Slide Out

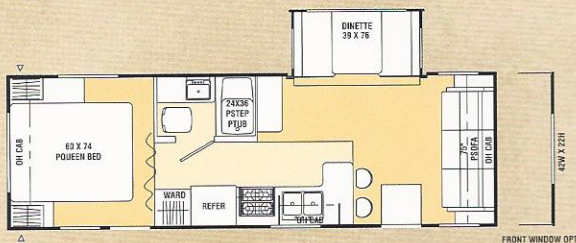

277tbs / Two Bedroom/ Slide Out

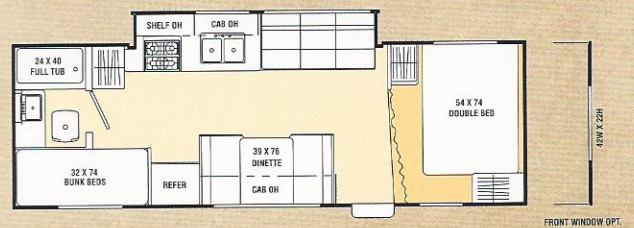

Travel Trailer Specifications

	199DB	249QB	275DS	277TBS	293TB	295FKS	296KS
Base Weight	3,078	3,645†	3,925†	3,995	4,285†	4,590†	4,343
GVWR (lbs.)	5,180	5,640†	5,965†	6,190	6,310†	6,545†	6,210
Carrying Capacity	2,102	1,995†	2,040†	2,195	2,025†	1,955†	1,867
Hitch Weight	380	440†	465†	470	510†	545†	490
Axle Weight	2,698	3,205†	3,460†	3,525	3,775†	4,045†	3,853
Interior Height	76"	76"	76"	76"	76"	76"	76"
Exterior Height*	8'9"	8'9"	8'9"	8'9"	8'9"	8'9"	8'9"
Exterior Length	21'8"	25'2"	27'11"	27'11"	30'11"	30'11"	30'11"
Exterior Width	7'10"	7'10"	7'10"	7'10"	7'10"	7'10"	7'10"
Hitch Pin Height	18"	18"	18"	18"	18"	18"	18"
Sleeping Capacity	4/5	6	6	8	8	6	6
Fresh Water Capacity (gal.)	29	29	29	29	29	29	29
Waste Water Capacity (gal.)	28	28	28	28	28	28	28
Grey Water Capacity (gal.)	32	32	32	32	32	32	32
Water Heater Capacity (gal.)	6	6	6	6	6	6	6
LP Gas Capacity (lbs.)	40/60	40/60	40/60	40/60	40/60	40/60	40/60
Furnace Rating (x1,000) BTU	20	25	25	25	25	25	25
Tire Size	ST205/75R14B	ST205/75R14B	ST205/75R14B	ST205/75R14B	ST205/75R14B	ST205/75R14B	ST205/75R14B

*Add 6" for Roof Air Conditioner † = Estimated at time of printing

Base Weight: The weight of the unit with no fluids, cargo, optional equipment or accessories.

GVWR (Gross Vehicle Weight Rating): The maximum permissible weight of the unit, including the Base Weight plus all fluids, cargo, optional equipment and accessories. For safety and product performance, do not exceed the GVWR.

Carrying Capacity: The difference between the Base Weight and the GVWR. This is the amount of weight available for all fluids, cargo, optional equipment and accessories. The actual "loaded" weight will depend on the equipped unit and the owner's individual choice of cargo, etc.

All information contained in this brochure is believed to be accurate at the time of publication. However, during the model year, it may be necessary to make revisions and Coachmen reserves the right to make all such changes without notice, including changes in prices, colors, materials, equipment and specifications, as well as the addition of new models and the discontinuance of models shown in this brochure. Therefore, please consult with your Coachmen dealer and confirm the existence of any materials, design or specifications that are material to your purchase decision.

293tb/ Two Bedroom

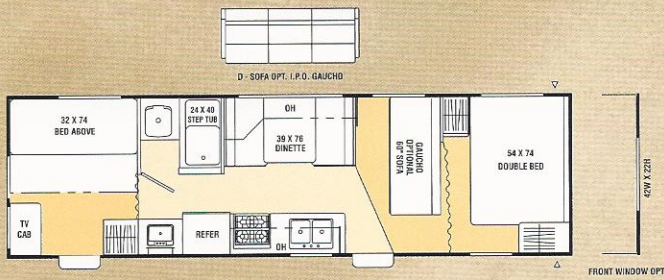

296ks / Kitchen Slide Out

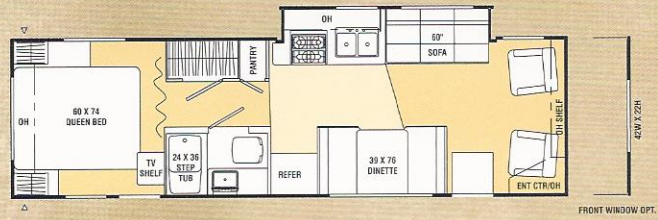

295fks / Front Kitchen/ Slide Out

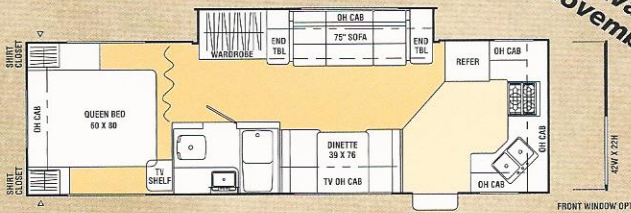

Available
November 2001

Optional Carpeting

Indicates Outside Storage Location

Travel Trailer Standard Features

INTERIOR AND DECOR

Golden Cherry Cabinets
Linoleum Flooring Throughout
Mini Blinds – Coach
Mini Blinds – Bedroom
Radius Windows – Safety Glass
Gaucho (249QB, 293TB)
Jack Knife Sofa (275DS, 277TBS, 295FKS, 296KS)

Dinette
TV Antenna Ready
Cable TV Jack
LP Leak Alarm
Techwood® Drawers
Fire Extinguisher
Smoke Detector
Mortise & Tenon Cabinet Doors

GALLEY

Microwave Ready
3-Burner Hi Output Range
Power Range Hood
Flush Mount, Large Single Door
Refrigerator – 6 c.f.
Monitor Panel
Stainless Steel Sink
Silverware Drawer

SLEEPING

Double Bed (199DB, 277TBS, 293TB)
Queen Bed (249QB, 275DS, 295FKS, 296KS)
Bunk Beds (277TBS, 293TB)

ELECTRICAL/HEATING/ AIR CONDITIONING

GFI Circuit
Outside Receptacle GFI
Patio Light
LP Light

Double 20 LB LP Bottles w/Auto Change-Over
20,000 BTU E.I. Furnace (199DB)
25,000 BTU E.I. Furnace (Except 199DB)
Speakers and Wiring for Radio
12V Outlets (3)

BATH AND WATER

Marine Toilet
Power Bath Vent
6-Gallon Gas Water Heater
Water Heater By-Pass Valve
Demand Water Pump
Decorative Bath Hardware
Medicine Cabinet

EXTERIOR/CONSTRUCTION

White Framed Windows
Rigid Insulation (Walls/Floor)
Fiberglass Insulation (Roof)
Gutter Rail with Awning Rail
Single Entry Step
Dead Bolt Lock
Radial Tires
Rally Wheels
Pass Through Storage
Galvanized Wheel Wells
Break Away Switch
Rubber Roof
Retractable Stabilizer Jacks (Std. on Slide Out Units)
Filon® Fiberglass Sidewalls
Push/Pull Manual Slide Mechanism (275DS)
Acme Screw Slide Mechanism (277TBS, 295FKS, 296KS)
Norco Lightweight Sectional Frame

Travel Trailer Optional Features & Weights*

- Innerspring Mattress w/Bedsread & Shams (23 lbs.)
- Bunk Bed (above Dinette -199DB) (21 lbs.)
- Jack Knife Sofa (249QB, 293TB) (75 lbs.)
- Partial Carpet w/Pad, Living Room & Bedroom (Except 199DB) (15 lbs.)
- Satellite TV Antenna System (22 lbs.)
- TV Antenna (15 lbs.)
- 12V AM/FM CD Stereo (10 lbs.)
- Flush Mount, Double Door Refrigerator - 8 c.f. (11 lbs.)
- Range Cover (10 lbs.)
- Microwave Oven (43 lbs.)
- 6-Gallon Gas/Elec. Water Heater (2 lbs.)
- 6-Gallon E.I. Water Heater (1 lbs.)
- One-Piece ABS Tub Surround (17 lbs.)
- Outside Shower (2 lbs.)
- Skylight – 14" (Except 199DB) (2 lbs.)
- Front Window w/Stone Guard Awning (24 lbs.)
- Tinted Safety Glass – Radius Windows (0 lbs.)
- 13,500 BTU Ducted Roof Air (Except 199DB) (112 lbs.)
- 13,500 BTU Non-Ducted Roof Air (199DB) (115 lbs.)
- Double 30# LP Bottles w/Auto C/O (14 lbs.)
- LP Bottle Cover (13 lbs.)
- Spare Tire Kit (50* lbs.)
- Ladder (8 lbs.)
- Retractable Stabilizer Jacks (Opt. 199DB, 249QB, 293TB) (26 lbs.)
- Patio Awning (94 lbs.)
- CSA Upfit (0 lbs.)
- Owners Information Package (5 lbs.)
- Convenience Package (Rechargeable Wall Mount Flashlight and Rechargeable Wall Mount Hand Held Wet/Dry Vac) (8 lbs.)

*Weights are approximate

Fifth Wheel Floorplans

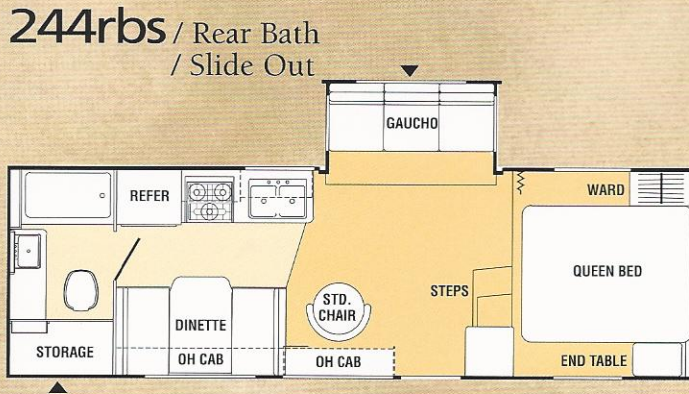
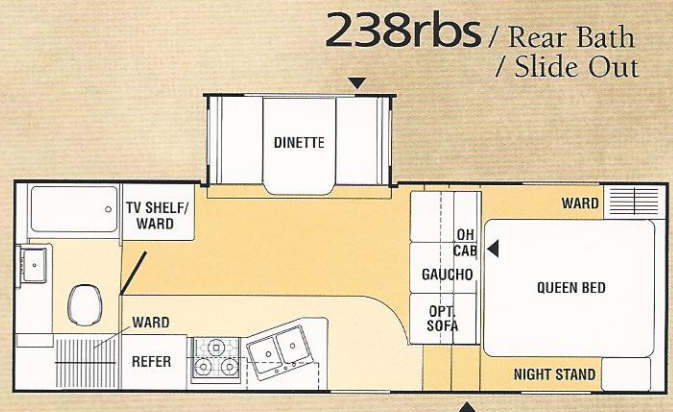

- Indicates Carpeting
- △ Indicates Outside Storage Location

Fifth Wheel Specifications

	236RKS	238RBS	244RBS
Base Weight	4,601	4,272	4,325
GVWR (lbs.)	6,473	6,340	6,390
Carrying Capacity	1,872	2,068	2,065
Hitch Weight	873	740	790
Axle Weight	3,728	3,532	3,535
Interior Height	6'6"	6'6"	6'6"
Exterior Height*	9'6"	9'6"	9'1"
Exterior Length	23'10"	23'10"	25'3"
Exterior Width	7'9"	7'9"	7'9"
Hitch Pin Height	45"	45"	45"
Sleeping Capacity	6	4	6
Fresh Water Capacity (gal.)	35	33	33
Waste Water Capacity (gal.)	29	29	29
Grey Water Capacity (gal.)	29	29	29
Water Heater Capacity (gal.)	6	6	6
LP Gas Capacity (lb.)	40/60	40/60	40/60
Furnace Rating (x1,000) BTU	25	25	25
Tire Size	ST205/75R14B	ST205/75R14B	ST205/75R14B

Base Weight: The weight of the unit with no fluids, cargo, optional equipment or accessories.

GVWR (Gross Vehicle Weight Rating): The maximum permissible weight of the unit, including the Base Weight plus all fluids, cargo, optional equipment and accessories. For safety and product performance, do not exceed the GVWR.

Carrying Capacity: The difference between the Base Weight and the GVWR. This is the amount of weight available for all fluids, cargo, optional equipment and accessories. The actual "loaded" weight will depend on the equipped unit and the owner's individual choice of cargo, etc.

All information contained in this brochure is believed to be accurate at the time of publication. However, during the model year, it may be necessary to make revisions and Coachmen reserves the right to make all such changes without notice, including changes in prices, colors, materials, equipment and specifications, as well as the addition of new models and the discontinuance of models shown in this brochure. Therefore, please consult with your Coachmen dealer and confirm the existence of any materials, design or specifications that are material to your purchase decision.

*Add 10" for Roof Air Conditioner

Fifth Wheel Standard Features

INTERIOR AND DECOR

- Golden Cherry Cabinets
- Linoleum Flooring (Bath and Kitchen)
- Partial Carpet w/Pad (Living and Bedroom)
- Mini Blinds – Coach
- Mini Blinds – Bedroom
- Radius Windows – Safety Glass
- Gaucht (238RBS)
- Jack Knife Sofa (244RBS)
- Dinette
- TV Antenna Ready
- Cable TV Jack
- LP Leak Alarm
- Techwood® Drawers
- Fire Extinguisher
- Smoke Detector
- Chair (244RBS)
- Mortise & Tenon Cabinet Doors

GALLEY

- Microwave Ready
- 3-Burner Hi Output Range Top w/Pots & Pans Drawer
- Power Range Hood
- Large, Flush Mount, Single Door Refrigerator - 6 c.f.
- Monitor Panel
- Stainless Steel Sink
- Silverware Drawer

SLEEPING

- Queen Bed
- Pillow Shams
- Bedsprad

ELECTRICAL/HEATING/AIR CONDITIONING

- GFI Circuit
- Outside Receptacle GFI
- Patio Light
- LP Light
- Double 20 LB LP Bottles w/Auto Change-Over
- 25,000 BTU E.I. Furance
- Speakers and Wiring for Radio

BATH AND WATER

- Marine Toilet
- Power Bath Vent
- 6-Gallon E.I. Water Heater
- Water Heater By-Pass Valve
- Demand Water Pump
- Decorative Bath Hardware
- Medicine Cabinet
- Tub Surround

EXTERIOR/CONSTRUCTION

- White Framed Windows
- Fiberglass Insulation
- Gutter Rail with Awning Rail
- Single Entry Step
- Dead Bolt Lock
- Radial Tires
- Rally Wheels
- Galvanized Wheel Wells
- Break Away Switch
- Rubber Roof
- Retractable Stabilizer Jacks
- Filon® Fiberglass Sidewalls
- Electric Slide Mechanism

Fifth Wheel Optional Features & Weights*

- Twin Beds (0 lbs.)
- Jack Knife Sofa (238RBS) (75 lbs.)
- VCR (7 lbs.)
- 13" Color TV (21 lbs.)
- TV Antenna (15 lbs.)
- 12V/120V AM/FM CD Stereo (10 lbs.)
- Flush Mount, Double Door Refrigerator - 8 c.f. (11 lbs.)
- Range Cover (10 lbs.)
- 3-Burner High Output Range w/Oven (13 lbs.)
- Microwave Oven (43 lbs.)
- 6 Gallon Glas/Electric Water Heater (2 lbs.)
- Tub Enclosure (17 lbs.)
- Tinted Safety Glass – Radius Windows (0 lbs.)
- 13,500 BTU Roof Air (115 lbs.)
- Water Purifier w/Faucet (2 lbs.)
- Double 30# LP Bottles w/Auto Change Over (14 lbs.)
- Power Jacks (8 lbs.)
- Spare Tire Kit (48 lbs.)
- Awning (94 lbs.)
- CSA Upfit (0 lbs.)
- Owners Information Package (5 lbs.)
- Convenience Package (Rechargeable Flashlight, Rechargeable Hand Held Wet/Dry Vac) (8 lbs.)

*Weights are approximate



A Proud History of Quality & Value

Coachmen RV Company has a long and proud history of quality product with unparalleled value and true commitment to the thousands of RV enthusiasts that have chosen Coachmen as their RV of choice.

Coachmen RV Company is a proven leader in the RV Industry with over 35 years of experience. Our mission is to make your total RV ownership experience the best possible by offering you the highest quality and reliability on the market today. Whether you look at our full breadth of product and model offerings, our Industry first Buckstopper Warranty, our customer driven service assistance, our Coachmen Caravan camping club, or our proven track record... Coachmen RV Company is understandably the "Leader to the Great Outdoors".

In 1964 Coachmen Industries, Inc. was founded by three brothers, Tom, Keith and Claude Corson with a dream and a vision of dedication to the enrichment of your life through enjoyment of the RV

lifestyle. They built Coachmen on principles such as:

- Practice the Golden Rule
- Our Word is Our Bond
- Business goes where it is invited and stays where it is well cared for

Through these principles, Coachmen has flourished over the years and become the leader throughout the RV Industry.

We've learned what makes an RV reliable, practical, and enjoyable, as well as how to enhance the RV lifestyle once you have chosen a Coachmen RV. We have accomplished this by listening to our customers. Our product's design, features, and amenities are driven by our customers. We listen because we care! And because we listen, our products, our services, and our programs are the best in the Industry. Coachmen products are designed with your needs in mind!

Come and enjoy the RV lifestyle. Create memories of a lifetime with your family and friends. Take a closer look at the...

"Leader to the Great Outdoors"
- Coachmen RV Company.

A Decade of Dominance

Coachmen RV cumulative growth for the past ten years (1991-2000)

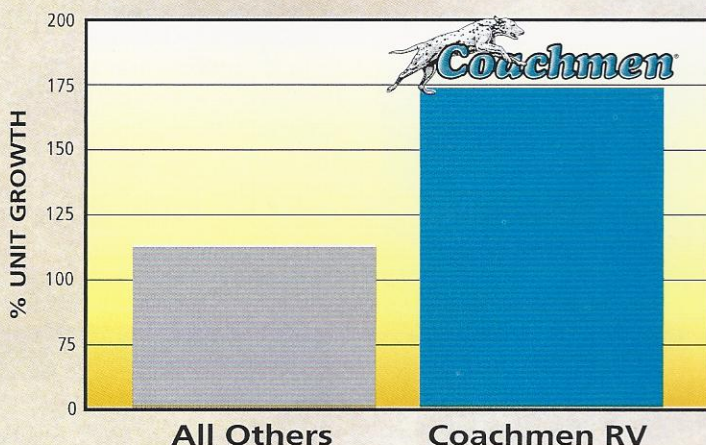

Source: Statistical Surveys (December 2000 YTD)

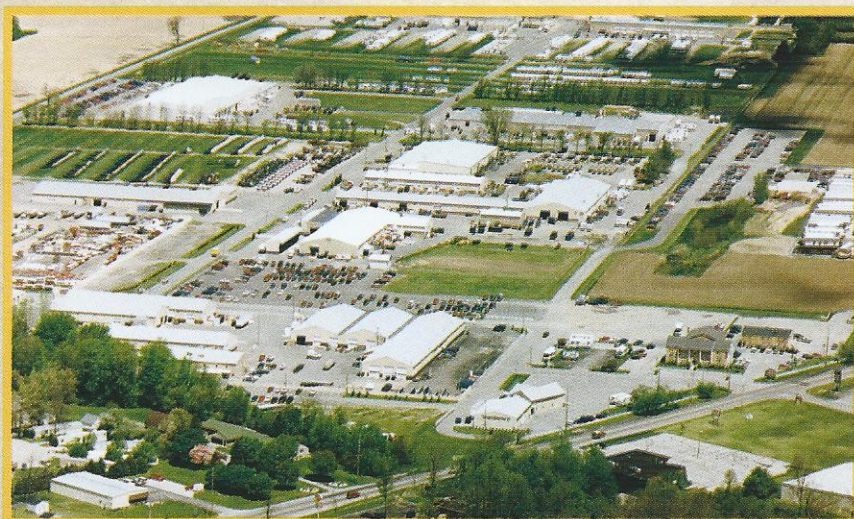

Come visit us at our Complex in Middlebury, Indiana (above) where you can relax at our Visitor's Center and enjoy guided tours of the assembly plants. Also visit us at our facilities in Fitzgerald, Georgia and Goshen, Indiana.



Advanced Engineering

Up-Front Design for Long Term Comfort

Founded in 1964, Coachmen is one of the oldest, continuous producing manufacturers of recreational vehicles. A secret of our success is our commitment to the continuous improvement of our products.

We have learned that quality must be designed and built into the products, up front. Combining experience and technology, we are able to prevent many problems before they arise, through proper analysis and testing.

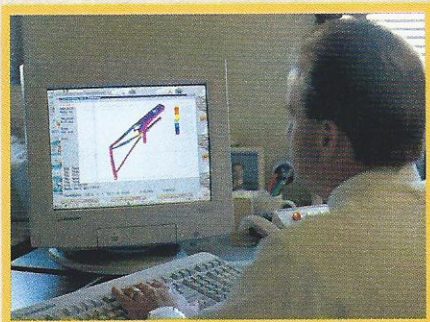

Design & Analysis

Unlike most companies, Coachmen uses computerized technology for much more than simple drafting applications.

At Coachmen RV, we utilize and rely on advanced computer technology to design and engineer a reliable and safe vehicle for you and your family. Finite Element Analysis helps evaluate structural integrity of components and systems quickly and efficiently. 3D model simulations and numerous other process and software systems are also used in the design and development of Coachmen recreational vehicles.

Computer weight testing is performed on every new model. Before a floorplan is approved, we know the approximate weights, including dry and loaded, front and rear axle weights and even side-to-side weights which affect towing. After a model is built, the computer analysis is manually verified.



Performance Testing

Coachmen subjects its new models to a myriad of stringent tests, before introduction to the customer. Rigorous road tests are performed on actual production units, to verify computer modeling. Studies are made of structural integrity, stress analysis, cabinetry dura-

bility, weight loading, vibration analysis and handling.

There can be little doubt that Coachmen has superior quality – by design.

Accurate & Specific Weights

Every Coachmen model has a weight label to provide you with specific and accurate weights and ratings of your unit. These comprehensive weight information labels are posted in your vehicle providing you with critical information such as the unit's Gross Vehicle Weight Rating and Carrying Capacity.



Leak Prevention

Every unit we produce is tested for leaks in a high-pressure rain chamber, designed to simulate a driving rain, not just a spring shower.

Every corner – at the roof, floor and sidewall is wrapped, sealed and secured. All roof and sidewall openings receive framing reinforcement, and are sealed with a non-shrinking, pliable silicone.

To promote water drainage and leak protection, all roofs have tapered rafters.

Coachmen goes the extra mile to ensure a quality hassle free RV.



International Coachmen Caravan Offers Friends and Fun for Life

With your purchase of a Coachmen RV you are invited to join the nation's largest manufacturer sponsored RV club at a discounted rate...International Coachmen Caravan.

The Coachmen Caravan was established in 1966 to help our owners enjoy RV ownership to its fullest.

With the Coachmen Caravan there are unlimited opportunities for you and your family to form lifelong friendships; improve and share your unique talents, skills and crafts; be active in running your club; and exchange ideas, information and helpful hints – all these, plus the

many benefits outlined below, are uniquely yours through the International Coachmen Caravan.

Incredible Membership Benefits. Your Caravan membership brings you a multitude of benefits that will help to ensure your safety and enjoyment throughout your RV experiences:

- Free \$5,000 Accidental Death and Dismemberment Insurance policy
- Emergency road service and RV insurance available at special low rates
- Free trip-planning service
- 10% Discounts at over 4,000 campgrounds in the U.S. and Canada
- Free annual Campground Directory
- Hassle-free group travel to popular destinations
- Organized campouts, meeting and parties
- Free subscription to Coachmen Capers, the club's quarterly magazine
- Annual International Rally Week
- A Coachmen Caravan MasterCard
- Free I.D. card, caravan key ring, vehicle decals and I.D. numbers
- Discounts on club clothing, accessories, film developing and selected RV publications

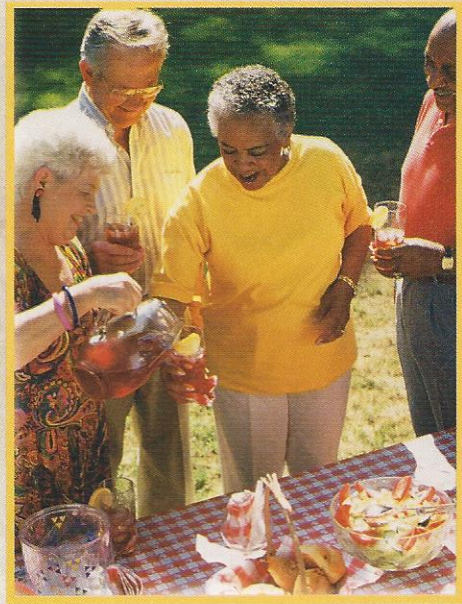

Decor Selections

Coachmen RV Invites Public to Tour Facilities

The Coachmen Visitor's Center in Middlebury, Indiana is your starting point for weekday tours of our motorhome, travel trailer and fifth wheel manufacturing plants. Also located at the Visitor's Center is the headquarters of the International Coachmen Caravan Owners Club and the Coachmen RV store, "Pete's Market", loaded with a large selection of Coachmen RV clothes and merchandise. Please call ahead for tour information and times. The Coachmen RV plants in Fitzgerald, Georgia and Goshen, Indiana produce travel trailers and fifth wheels only. Motorhome production tours are available only at the Middlebury location.



Blue Marble



Silver Sage



Prairie Sand



Dazzling interiors feature skillfully coordinated upholstery and window treatments. Coachmen RV chooses only top-grade fabrics wear-dated as heavy-duty. These fabrics have been tested for durability beyond 15,000 double rubs (in and out action) to simulate heavy usage. An average chair in an American home is subjected to only 3,000 double rubs per year.

A Company You Can Trust Since 1964

Coachmen Recreational Vehicle Company is one of the industry's largest recreational vehicle manufacturers. The company markets travel trailers, fifth wheel trailers, class C motorhomes and class A motorhomes.

A subsidiary of the Elkhart, Indiana-based Coachmen Industries, Coachmen RV Company was founded in 1964 in Middlebury, Indiana where its headquar-

ters and largest manufacturing facility are located. Manufacturing sites are also located in Goshen, Indiana and Fitzgerald, Georgia.

From the beginning it was obvious that Coachmen is a company that cares about the products it produces

and the people who enjoy them; always looking for better ways to bring the pure enjoyment of the RV Lifestyle to more and more families.

In the nearly four decades since Coachmen's modest

beginnings, countless companies have come and gone while Coachmen has stayed the course. From product development to service after the sale, Coachmen has helped set



the standards for others to follow. Many of today's product designs, manufacturing techniques and product warranties are a result of Coachmen innovations. Coachmen RV – Celebrating 37 years as "Leader to the Great Outdoors."

Coachmen RV Forms Alliance With Disney

WALT DISNEY WORLD® Resort has designated Coachmen RV as the official recreational vehicle of Disney's Fort Wilderness Resort and Campground and Disney's Wide World of Sports™ complex in Florida. Check out the Coachmen RV on display near Pioneer Hall, home of the popular "Hoop-Dee-Do" Musical Revue, the longest running dinner show at Walt Disney World Resort. Come on and discover the Disney magic in a Coachmen RV.



Visit our website at: www.coachmenrv.com

COACHMEN RECREATIONAL VEHICLE COMPANY, LLC
P.O. Box 30, Middlebury, IN 46540 • P.O. Box 948, Fitzgerald, GA 31750

