



# Barnstormer



by R-Vision

The Original Expandable Travel Trailer

U.S. Patent Nos. 6135539  
and 5992920



## Towable and Affordable

LIKE A FOLDING CAMPING TRAILER

## Accommodates

LIKE A BIG TRAVEL TRAILER

JERRY'S TRAILERS & CAMPERS  
2601 S. 13th St.  
Norfolk, NE 68701  
(402) 371-1306

*North America's Favorite Super Lite Weight Travel Trailers*

### Aluminum Framed, Laminated Construction

# Super Lightweight

EXPANDABLE TRAVEL TRAILERS



# Bantam

## SPECIFICATIONS

U.S. Pat. Nos. 613553 and 95992920

B-17-B

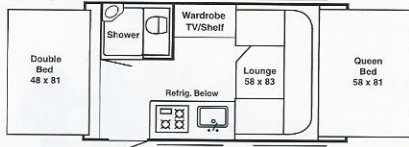

B-19

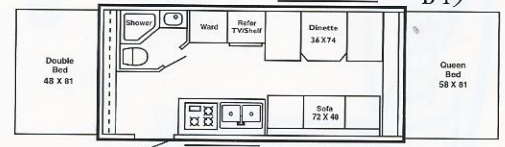

B-21-B

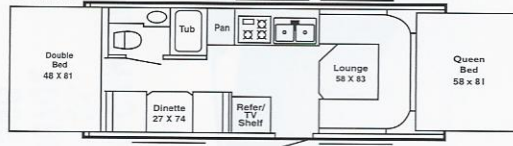

B-22-S



B-23-S

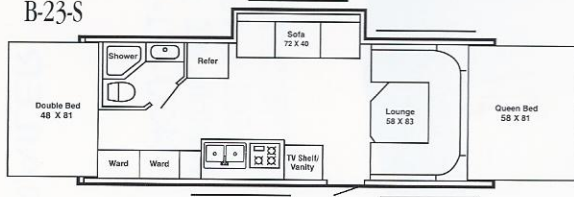

B-23-SB

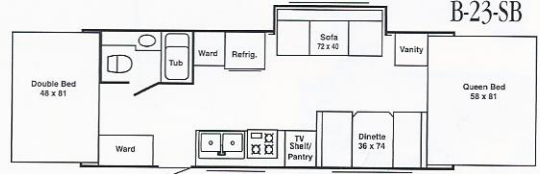

### Appliances/Equipment

- Dometic refrigerator
- 3 Burner Range Top
- Power Range Hood with Light
- Six Gallon Water Heater
- Furnace (16,000 BTU) 17' - 19' (18,000 BTU) 21's - 23's
- Air Conditioner Ready
- Demand Water Pump
- Copper Gas Lines
- PEX Water Lines
- Microwave Ready

### Bath

- ABS Shower Pan or Tub
- Shower Curtain
- Thetford Toilet
- Power Roof Vent
- Adjustable Shower Head

### Construction

- Welded, Aluminum Framed, Laminated Roof with 1-1/2" Polystyrene Block Foam Insulation (R-7) Rubber Roof
- Welded, Aluminum Framed, Laminated Walls with 1-1/2" Polystyrene Block Foam Insulation (R-7) Filon Fiberglass Exterior Covering
- Welded, Aluminum Framed, Laminated Floor with 1-1/2" Polystyrene Block Foam Insulation (R-7)
- Clean Bond Painted Tubular Steel Chassis
- Framed, Braced and Wired for Air Conditioning
- Butyl Tape Sealant on All Exterior Seams

## Bantam Specifications

	B-17-B	B-19	B-21-B	B-22-S	B-23-S	B-23-SB		B-17-B	B-19	B-21-B	B-22-S	B-23-S	B-23-SB
Total Dry Weight	2087*	2484*	2701*	3147*	3081*	3351*	Exterior Width	7'3"	7'3"	7'3"	7'3"	7'3"	7'3"
Load Capacity	773*	1314*	1099*	1583*	1503*	1331*	Exterior Height (Roof Edge)	8'0"	8'0"	8'0"	8'0"	8'0"	8'0"
Hitch Weight	140*	270*	320*	330*	245*	282*	Fresh Water (Gal.)	25	25	25	25	25	25
Length Closed	17'	20'5"	21'7"	22'9"	23'10"	23'10"	Grey Water (Gal.)	30	30	30	30	30	30
Length Open	21'	23'3"	24'5"	25'5"	26'8"	26'8"	Black Water (Gal.)	14	30	30	30	30	30
							Tire Size	175/80R	175/80R	175/80R	175/80R	175/80R	175/80R
								13	13	13	13	13	13

### Electrical

- Patio Light with Amber Lens
- Ceiling Lights
- 120 Volt GFI Protected Circuit(s)
- 120 Volt Breaker Panel
- Outside 120 Volt Receptacle
- 30 Amp, 28' Power Cord
- 45 Amp Whisper Quiet Converter with Charger
- Battery Tray
- Pre-wired for Air Conditioning
- Pre-wired for Microwave

### Exterior

- Rubber Roof
- Filon Fiberglass Skin
- Clean Bond Painted Chassis
- Radius Corner Windows
- Radius Corner Entry Door with Screen, Flush Mount Latch, Dead Bolt Lock
- Generous Outside Storage Compartment
- Self-Storing Step
- 20# LP Tanks
- 4 Stabilizer Jacks - Crank Down Type
- Liftco Screw Drive Self-Locking Slideout Mechanism on Slide Models w/5 Year Warranty, Operates from Inside

### Interior

- Large Galley Window
- Reversible Dinette and Bunk Cushions
- Mini Blinds w/Valances Throughout
- No-Wax Vinyl Flooring

- "Euro Look" Overhead Cabinet with Under Cabinet Shelf
- Oak Framed, Mortise and Tenon Cabinet Doors
- Roof Vent (Deleted with Optional Air Conditioning B-17-B)
- Inside/Outside Table on Some Models
- Laminated Galley Countertops/Table Tops

### Running Gear

- Radial Trailer Tires
- White Spoke Wheels
- 10" Electric Brakes
- Independent Torsion Suspension System, Rubber Ride

### Bed Ends

- Gencore Weathershield Tent (attached inside c-channel to prevent water entry.)
- Continuous Piano Hinge for Added Strength
- Key Locked for Security
- Compression Clamps ensure tight bond of bunk seals
- 5" Bunk End Cushions for Comfort
- Pre-wired for Bunk Lights

### Safety

- Breakaway Switch
- Fire Extinguisher
- Smoke Detector
- LP Detector
- Safety Chains
- Ground Fault Protected Circuit(s)
- Dead Bolt Door Lock

### Options

- |  |   |
|--|---|
| • Air Conditioning 13,500 BTU . . . . . 104# | • Stove Cover . . . . . 5#                      |
| • AM/FM CD Player . . . . . 4#               | • TV Antenna/Cable/Satellite Ready . . . . . 6# |
| • Awning, A&E . . . . . 40#                  | • Outside Grill . . . . . 15#                   |
| • Spare Tire, Wheel, Carrier . . . . . 35#   | • Outside Shower . . . . . 3#                   |

