



Coachmen

1997 CAMPING TRAILERS

**FEATURES & VALUE
BEYOND COMPARE**

**FREE!
OWNER'S CLUB
MEMBERSHIP &
BENEFITS!**



**WARRANTY
COVERAGE YOU
CAN COUNT ON**

GREAT FAMILY CAMPING FUN

Coachmen's complete line of Folding Camping Trailers provides a wide selection of floorplans for nearly any budget and camping need. Choose from the popular Clipper and Sport series, featuring wide-body design and a variety of versatile floorplans, or the Hunter model, which combines outstanding economy and value.

Take a close look at Coachmen Folding Camping Trailers and you'll see why they are favorite choices for both beginning and veteran campers alike. Here are just some of the great features:

- **Independent Rubberized Suspension.** This specially designed system helps prevent excessive swaying and bouncing when you're towing Clipper.

- **Wide Track Tires.** Coachmen uses larger tires than most manufacturers to assure better performance and safety. All eight and ten foot box campers feature 12" wheels while all 12 foot models are equipped with 13" wheels.

- **E-Z Lube Hub.** All Coachmen Camping Trailers feature the E-Z Lube axle which provides a grease zerk fitting right on the wheel hub for easy lubrication.

- **Sectionalized Vinyl Tent.** The five-piece sectionalized vinyl tent provides durable, practical and reliable alternative to other materials being used in many camping trailers today. It's much easier to maintain, water resistant and less likely to mold or mildew.

- **Crank Down Jacks.** Setting your leveling jacks is simple with Clipper's easy to use crank down jacks.

- **Structurwood Flooring.** The 5/8" Structurwood flooring provides a sturdy foundation. Structurwood is 10% stronger than plywood. It's also more resistant to water and has no seams that can buckle or bow.

Compare Coachmen's Camping Trailers with any other brand of camper on the market today. You'll see why Coachmen is "Leader To The Great Outdoors."



The Clipper (pictured on the cover) offers five wide-body floorplans with sleeping capacities of up to eight people in some models.



The popular Sport, shown with the optional awning, combines comfort with the value of Coachmen quality.



The economical Hunter still provides plenty of livability features for the budget minded camper.

FLOORPLANS

X

086 Hunter

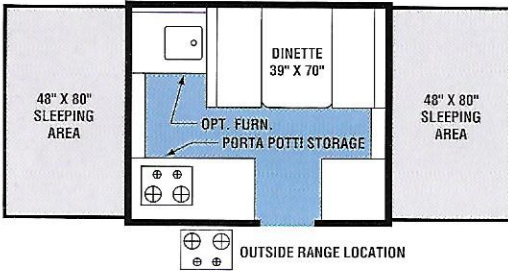

1080 Clipper

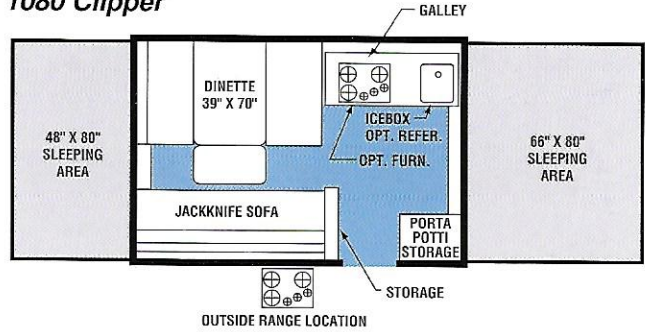

086 Sport

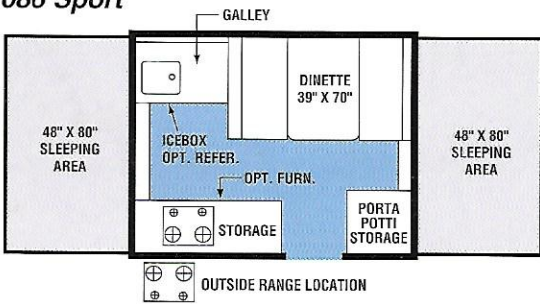

1260 Clipper

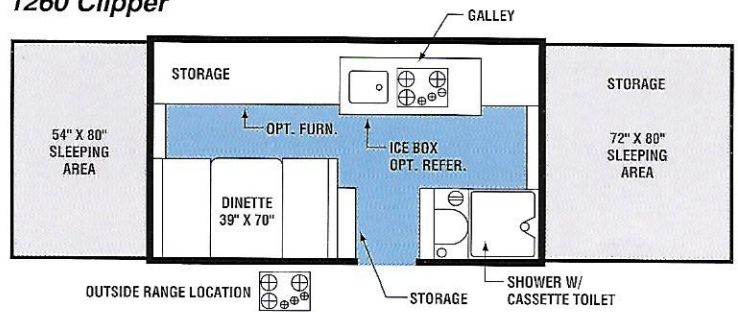

106 Sport

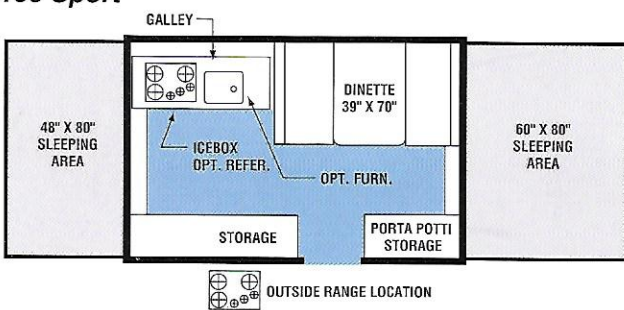

1270 Clipper

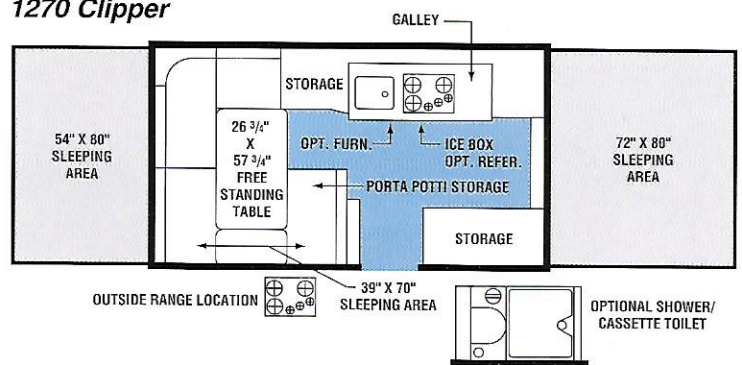

1060ST Clipper

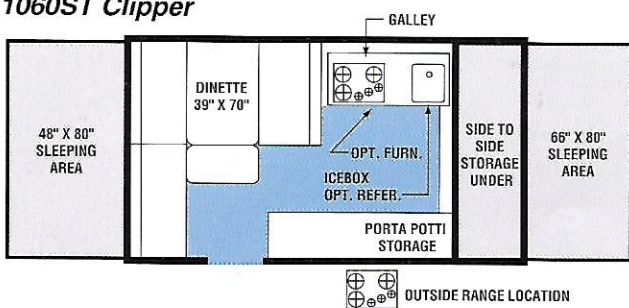

1280 Clipper

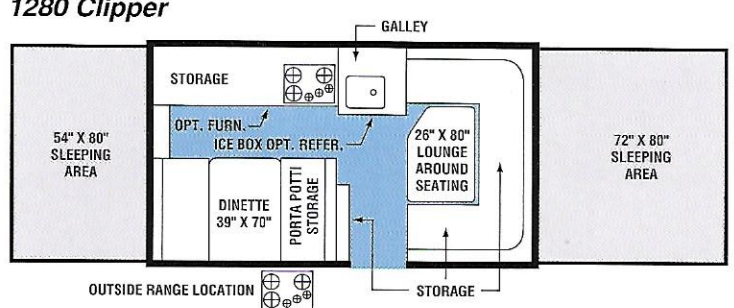

SPECIFICATIONS STANDARDS & OPTIONS



SPECIFICATIONS

Model	Hunter	Sport			Clipper			
	086 HNTR	086 Sport	106 Sport	1060 ST	1080	1260	1270	1280
Travel Length	12'2"	12'8"	13'10"	16'4"	13'10"	16'1"	16'1"	16'1"
Travel Width	85"	85"	85"	85"	85"	85"	85"	85"
Travel Height	52"	52"	52"	50"	50"	50"	50"	50"
Int. Open Length	17'1"	17'7"	20'2"	20'8"	20'8"	23'10"	23'10"	23'10"
Int. Open Height	6'6"	6'6"	6'6"	6'6"	6'6"	6'6"	6'6"	6'6"
Sleep Capacity	6	6	6	6	8	6	7	8
Front Sleep Area	48 x 80	48 x 80	60 x 80	66 x 80	66 x 80	72 x 80	72 x 80	72 x 80
Rear Sleep Area	48 x 80	48 x 80	48 x 80	48 x 80	48 x 80	54 x 80	54 x 80	54 x 80
Dinette	39 x 70	39 x 70	39 x 70	39 x 70	39 x 70	39 x 70	39 x 70	39 x 70
"U" Dinette	—	—	—	—	—	—	—	48 x 80
Folding Sofa	—	—	—	—	36 x 60	—	—	—
Tire Size	4.80 x 12C	4.80 x 12C	4.80 x 12C	B78 x 13C	B78 x 13C	B78 x 13C	B78 x 13C	B78 x 13C
Hitch Weight (approx.)	160	130	190	110	200	270	240	240
Axle Weight (approx.)	1100	1210	1230	1580	1350	1610	1490	1500
Cargo Capacity (approx.)	880	770	750	590	850	590	710	700
Coupler Size	2"	2"	2"	2"	2"	2"	2"	2"
STANDARDS								
Cable Crank Lift	STD	STD	STD	STD	STD	STD	STD	STD
Dinette Cushions	4"	4"	4"	4"	4"	4"	4"	4"
Bunk Mattresses	3"	4"	4"	4"	4"	4"	4"	4"
Side Curtains	STD	STD	STD	STD	STD	STD	STD	STD
Ceiling Valances	—	STD	STD	STD	STD	STD	STD	STD
Bedend Privacy Curtains	STD	STD	STD	STD	STD	STD	STD	STD
Flip-over Galley	STD	STD	STD	STD	STD	STD	STD	STD
Range, Burners	2	2	3	3	3	3	3	3
In/Out Cooking	STD	STD	STD	STD	STD	STD	STD	STD
20 lb. L.P. Bottle	STD	STD	STD	STD	STD	STD	STD	STD
S.S. Sink	STD	STD	STD	STD	STD	STD	STD	STD
City Water Hookup	STD	STD	STD	STD	STD	STD	STD	STD
Hand Water Pump	STD	STD	STD	STD	STD	STD	STD	STD
12 gal. Water Tank	STD	STD	STD	STD	STD	STD	STD	STD
Built-in Icebox	—	STD	STD	STD	STD	STD	STD	STD
Free Standing Table	STD	STD	STD	STD	STD	STD	STD	STD
25' Power Cord	STD	STD	STD	STD	STD	STD	STD	STD
Power Converter	6 amp	9 amp	9 amp	12 amp	12 amp	20 amp	12 amp	12 amp
120V Outlets	2	2	3	3	3	4	4	4
Ceiling Lights	1	2	2	6	6	6	6	6
Front Bunk Light	—	—	—	STD	STD	STD	STD	STD
Exterior Trunk Door	—	—	—	STD	—	—	—	STD
23 cu. ft. Front Storage	—	—	—	STD	—	—	—	—
14 x 14 Roof Vent	—	STD	STD	STD	STD	STD	STD	STD
AC Roof Reinforcement	STD	STD	STD	STD	STD	STD	STD	STD
Clothes Bar	STD	STD	STD	STD	STD	STD	STD	STD
Patio Light	—	STD	STD	STD	STD	STD	STD	STD
Exterior 120V Outlet	—	STD	STD	STD	STD	STD	STD	STD
Bolt-on Step	STD	STD	STD	STD	STD	STD	STD	STD
4 Leaf Spring Suspension	STD	STD	STD	—	—	—	—	—
Torsion Suspension	—	—	—	STD	STD	STD	STD	STD
E-Z Lube Axle	STD	STD	STD	STD	STD	STD	STD	STD
13" Styled Wheels	—	—	—	STD	STD	STD	STD	STD
12" Styled Wheels	STD	STD	STD	—	—	—	—	—
Spare Tire Bracket	STD	STD	STD	STD	STD	STD	STD	STD
Spare Tire with Cover	STD	STD	STD	STD	STD	STD	STD	STD
Steel Bumper	STD	STD	STD	STD	STD	STD	STD	STD
Stacker Jacks	2	—	—	—	—	—	—	—
Welded-on Stab. Jacks	—	2	4	—	—	—	—	—
Screwdown Leveling Jacks	—	—	—	4	4	4	4	4
OPTIONS								
Awning	Avail.	Avail.	Avail.	Avail.	Avail.	Avail.	Avail.	Avail.
Screen Room	Avail.	Avail.	Avail.	Avail.	Avail.	Avail.	Avail.	Avail.
3-Way Refrigerator	—	Avail.	Avail.	Avail.	Avail.	Avail.	Avail.	Avail.
16,000 BTU Furnace	Avail.	Avail.	Avail.	Avail.	Avail.	Avail.	Avail.	Avail.
Shower/Cassette Toilet	—	—	—	—	—	STD	Avail.	—
Electric Brakes	Avail.	Avail.	Avail.	Avail.	Avail.	Avail.	Avail.	Avail.
Battery rack, box & wiring	Avail.	Avail.	Avail.	Avail.	Avail.	Avail.	Avail.	Avail.

All information contained in this brochure is believed to be accurate at the time of publication. However, during the model year, it may be necessary to make revisions and Coachmen reserves the right to make all such changes without notice, including changes in prices, colors, equipment

and specifications as well as the addition of new models and the discontinuance of models shown in this brochure. Therefore, please consult with your Coachmen dealer and confirm the existence of any materials, design or specifications that are material to your purchase decision.

FEATURES GALORE!

A complete photo album would be required to fully display the many features and innovations of Coachmen's affordable camping trailers. Here are just a few.

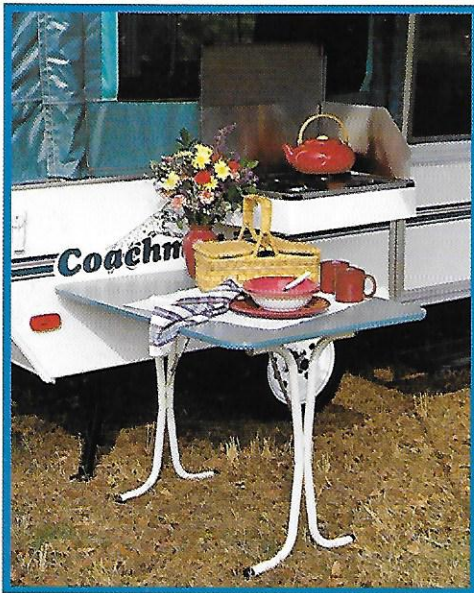

▲ Range tops are designed for use both inside and outside the camper. Dinette tables also are portable for dining under the sun or stars.

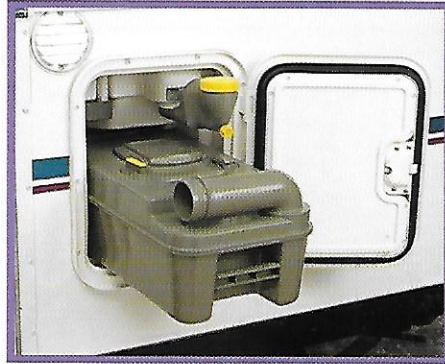

▲ The removable waste dump tank is both a handy and convenient feature. Available on Models 1260 and 1270.



▲ Bunk areas feature firm and comfortable 4" high density closed cell foam cushions for outstanding durability. Bunk lights are standard on Clipper Models to add even more convenience and livability.

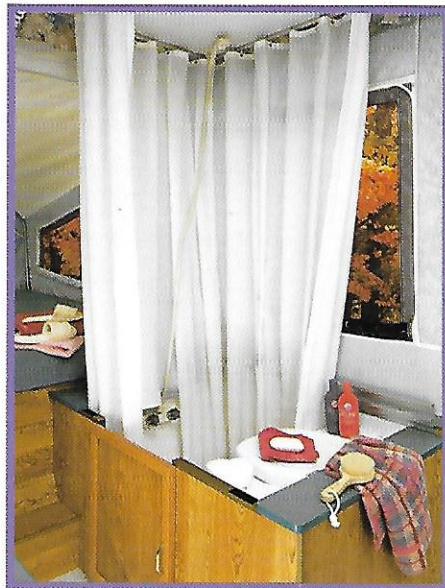

▲ Showers and toilets are available in two Clipper floorplans.

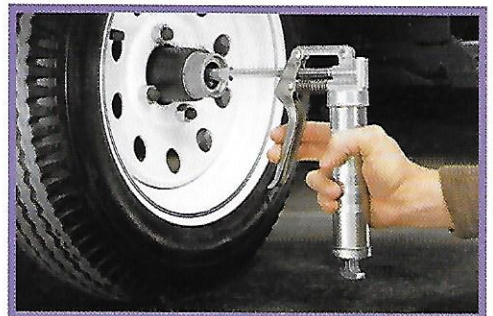

▲ Keep your bearings lubricated with the easy access of the E-Z Lube hub.



▲ The Clipper 1060ST features 20.8 cubic feet of front trunk storage. This storage area is accessible from both inside and outside the camper. The outside doors are lockable.



▲ Lowering your leveling jacks is easy with Clipper's standard crank down jacks.

COACHMEN: LEADER TO THE GREAT OUTDOORS.

Coachmen Recreational Vehicle Company has manufacturing facilities in Middlebury, Indiana, and Fitzgerald, Georgia, and occupies over 600,000 square feet on nearly 120 acres. The Coachmen name is one of the most recognized names in our industry, and our products provide recreational enjoyment throughout North America and Europe.

From our beginning in 1964, we have been, "Dedicated to the Enrichment of Your Life." You will find proof of this dedication in our innovative and user-friendly products and our smorgasbord of customer benefits and services.

We are driven by a deep concern for your safety, comfort, pride of ownership and pleasure—in short, **your satisfaction.**

Coachmen knows what it takes to make an RV great. Join us! We'll lead the way to the great outdoors.

Come visit us at our new Oregon facility, our Georgia facility or our Complex in Indiana (pictured), where you can relax at our Visitor's Center and enjoy guided tours of the assembly plants.



A WARRANTY TO COUNT ON.

BUCKSTOPPER WARRANTY

We work very hard to see that our products out-perform your expectations. But, should something go wrong with the workmanship or materials during the warranty period, we will fix it. As the saying goes, the buck stops here.

Your Owner's Registration Card and our famous Buckstopper Warranty are your passport to worry-free travel. Throughout the United States and Canada, our network of over 300 independent dealers stands ready to provide you with courteous, dependable service.

ADDITIONAL COVERAGE.

Clipper Warranty coverage is comprehensive. Aside from the one-year Buckstopper Warranty, Clipper camping trailers feature additional warranty protection on several components and systems.

- **Structurwood Floor**— 10 year warranty.
- **Vinyl Tent**— 5 year warranty covering functional defects and workmanship.
- **Crank Lift System**— Lifetime limited warranty covering function

al defects and workmanship.

- **Independent Suspension**— 5 year warranty covering functional defects and workmanship.

When making your purchase decision, you should select a company you can count on, with a warranty you can depend on. **Nobody protects you better than Coachmen..for the long haul!**

See your Coachmen dealer for complete details on our generous warranty program.

COACHMEN CARAVAN FRIENDS & FUN FOR LIFE.

Your purchase of a Coachmen recreational vehicle qualifies you for a **free, one-year membership** in the International Coachmen Caravan, the nation's largest manufacturer sponsored RV club. Consisting of over 20,000 member families, the Coachmen Caravan was formed in 1966 to help our owners enjoy RV ownership to the fullest.

With Coachmen, unlimited opportunities exist for you and your family to form lifelong friendships; improve and share your unique talents, skills and crafts; be active in running your club; and exchange ideas, information and helpful hints—all these, plus the many benefits outlined below, are uniquely yours through the International Coachmen Caravan.

INCREDIBLE MEMBERSHIP BENEFITS!

In addition to automatically expanding your circle of friends, your Caravan membership brings you a multitude of benefits:

- Free \$5,000 Accidental Death and Dismemberment Insurance policy, with additional policies available for \$5 a year.
- Emergency road service and RV insurance at low rates.
- Free trip-planning service.
- 10% Discounts at over 3,500 campgrounds in the U.S. and Canada.
- Free annual Campground Directory.
- Hassle-free group travel to popular destinations.
- Free lost-key return service.
- Organized campouts, meetings and parties.
- Free subscription to COACHMEN CAPERS, the club's quarterly magazine.
- Annual International Rally Week.
- Free I.D. card, Caravan key ring, vehicle decals and I.D. numbers.
- A Coachmen Caravan MasterCard with no annual fee and low interest.
- Discounts on club clothing, accessories, film developing and selected RV publications.



P.O. Box 30, Middlebury, IN 46540 • P.O. Box 948, Fitzgerald, GA 31750

