



# **Couchmen<sup>®</sup>**

**1996 ROYAL TRAVEL TRAILERS & FIFTH WHEELS**

**ROYAL LUXURY AND  
LIVABILITY WITHOUT  
A KING'S RANSOM**

**SLIDE OUT SELECTIONS  
BEYOND COMPARE**



**TWO-YEAR  
STRUCTURAL  
WARRANTY**

**FREE!  
OWNER'S CLUB  
MEMBERSHIP &  
BENEFITS!**





.....

# A ROYAL COMBINATION OF

Royal travel trailers and fifth wheels prove that fine luxury does not require a King's ransom. Royal towables are outstanding examples of Coachmen's unbeatable combination of fine craftsmanship and long term value.

Appointed with elegant and stylish features, Royal certainly lives up to its name. But upon closer inspection, you'll equally appreciate Coachmen's attention to quality and durability. So often, a recreational vehicle will look the part of a finely crafted coach, but in reality lack the design and construction necessary for true quality. There are important differences with other travel trailers and fifth wheels which will affect your long term satisfaction, and even resale value.

This brochure will show you why Coachmen is the clear choice for overall luxury, quality and livability.

## EVERLASTING BEAUTY AND LIVABILITY

As you step inside Royal travel trailers and fifth wheels you'll immediately feel the elegance that is created from beautiful upgraded fabrics, stylish residential fixtures and tasteful decors.

Our designers work diligently to insure lasting appeal, because at Coachmen we believe that beauty should be "more than skin-deep."

Here are some of the differences that set Coachmen interiors apart from other brands:

- Coachmen selects only fabrics that are wear-rated as "Heavy Duty." This means that Coachmen fabrics have been tested for durability beyond 15,000 double rubs (in and out action) to simulate heavy usage. To put this in perspective, a chair in

the average American home is typically subjected to 3,000 double rubs *per year*.

- Beneath its heavy duty fabrics, Coachmen uses high density foam in its furniture and cushions to protect against premature compression and breakdown. And, dinette cushions are backed with durable, waterproof vinyl.

- Coachmen uses only man-made continuous filament fiber carpeting that is pre-treated for stain resistance. For long term wear, the carpet padding is equally important. Coachmen uses a 3/8" pad that is 70% denser than the industry standard, with an 80 lb. ILD (Indentation Load Deflection) versus the 33 lb. ILD most commonly used.

- Unlike other brands, Coachmen's decorative cabinet insert panels are tempered glass for added safety and durability.

- Royal's beautiful cabinet doors and drawer fronts feature hardwood raised panel oak. Unlike other brands that use an MDF construction, Coachmen's cabinet fronts are real laminated wood, solidly screwed and secured to reinforced sidewalls.

- Window sizes and configurations are chosen with care, to give you enormous panoramic views in the living areas and important ventilation in the sleeping areas with multi pane jalousie windows.



*LEFT: The 360 Rear Kitchen provides for a large and efficient galley and plenty of room to enjoy a great meal. Shown in Meadowland.*

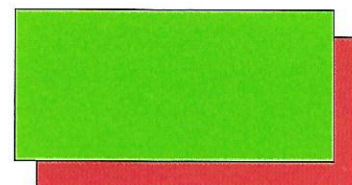

# ELEGANCE AND STYLE



• Window treatments are designed for beauty, flexibility of lighting and ventilation, and, most of all, privacy.

The Royal features a non-flammable adjustable mini-blind in the galley, and niteshades in the coach and bedroom for privacy.

*ABOVE: The Wedgewood decor in this 360 RK accentuates the residential style of this expansive floorplan. An optional sleeper sofa offers even more livability.*

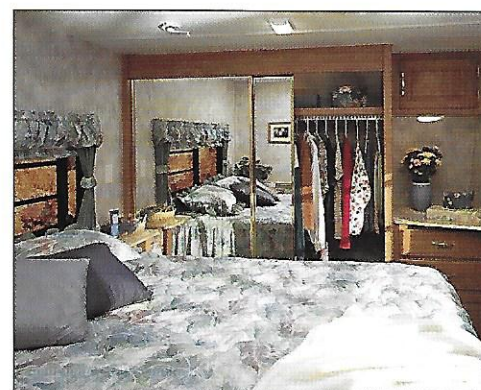

*ABOVE: Closet and storage space abounds in this Royal bedroom. Beds have beautiful quilted bedspreads, and pillow shams, matching the coordinated window treatments.*

Federal Blue

Wedgewood

Meadowland



# FEATURES GALORE!

A complete photo album would be required to fully display the many features and innovations of Royal travel trailers and wheels. Here are just a few of the many features available from Coachmen.

Coachmen's optional ducted roof air conditioning system is the best of its kind. Every angle, seal and vent has been carefully designed for maximum cooling with minimum condensation. ▶



Most Royal beds are equipped with a bed-lift storage system that features hydraulic cylinder lift struts for ease of operation. ▼



Another Coachmen innovation is the fantastic under-sink silverware and utensil drawer. ▼

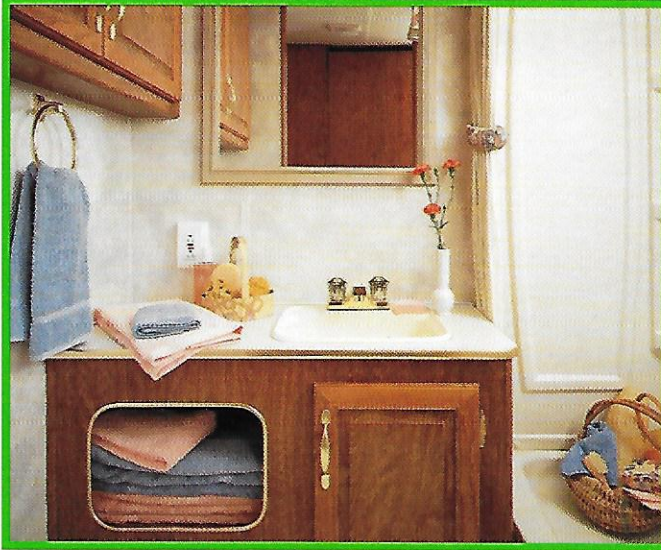

◀ Coachmen pays special attention to bathrooms, for adequate room around the toilet, counter space and linen storage. All models feature a molded tub/shower wall liner, double sealed to protect against water damage.



◀ Floor-ducted heat system provides balanced heat distribution. The duct system itself is sealed and insulated to avoid an inefficient loss of heat.

The optional microwave oven boasts a huge 1.3 cu.ft. interior space, making preparation of large dishes a breeze. ▼



▲ Mere words cannot convey the superior operation of the Royal's interior drawers. This metal and caster slide system is standard equipment.

The three-burner range with a high-output front burner has space for large pots and enough capacity to quickly heat the contents. ▼



# FLOORPLANS & TECHNICAL SPECIFICATIONS

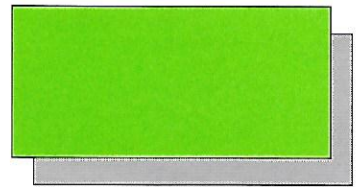

# 1996 ROYAL TRAVEL TRAILERS & FIFTH WHEELS

## ROYAL TRAVEL TRAILER FLOORPLANS

### 298FK FRONT KITCHEN

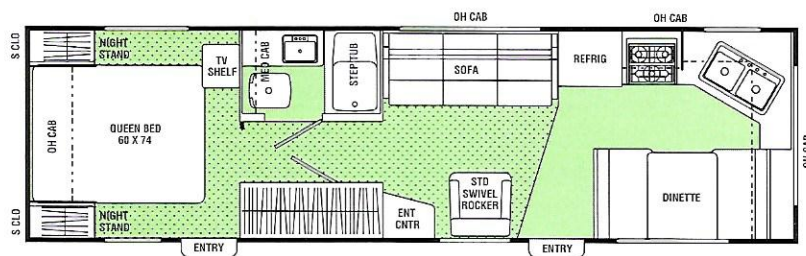
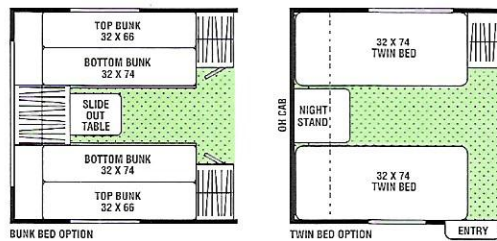

### 310WB WALK THRU BATH

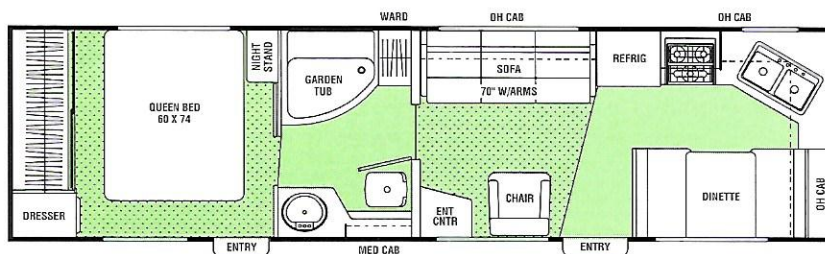

 Indicates Carpeting

# ROYAL FIFTH WHEEL FLOORPLANS

## 285RKHP

REAR KITCHEN  
HIGH PROFILE

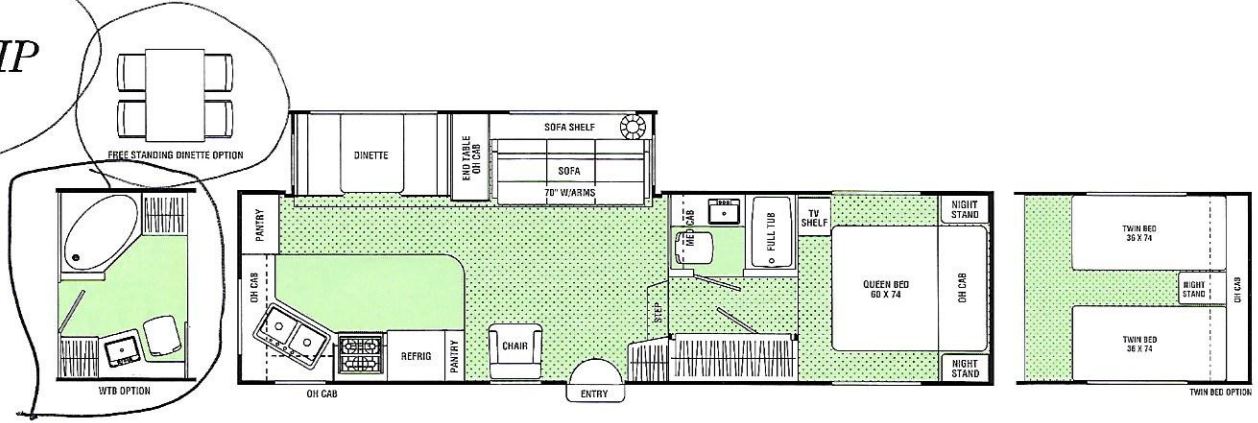

## 315RLHP

REAR LOUNGE  
HIGH PROFILE

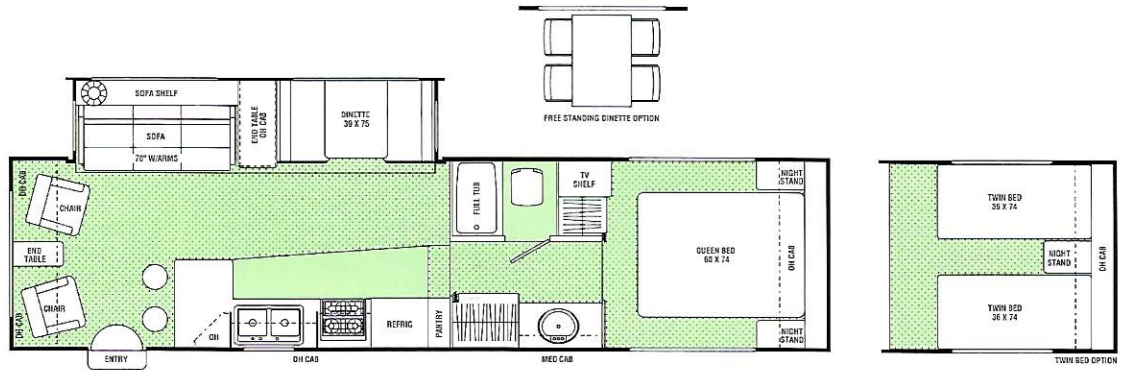

## 360RKHP

REAR KITCHEN  
HIGH PROFILE

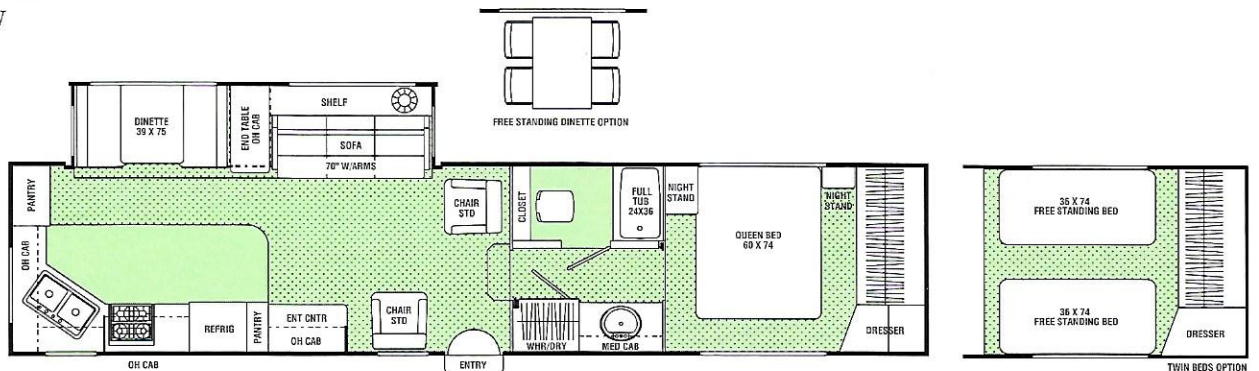

Indicates Carpeting

# ROYAL FIFTH WHEEL FLOORPLANS

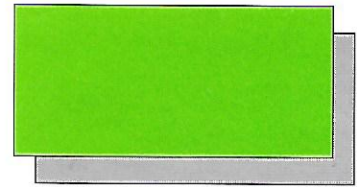

## 370RLHP REAR LOUNGE HIGH PROFILE

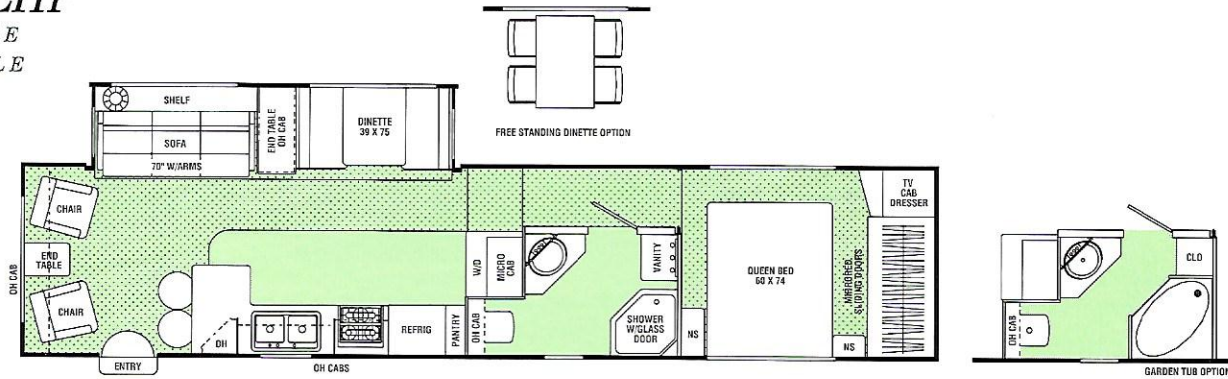

	Travel Trailers		Fifth Wheels			
	298 FK	310 WB	285 RK	315 RL	360 RK	370 RL
Base Weight	@5,520	@5,831	@8,165	@8,985	@10,048	@9,944
GVWR	7,600	7,600	@9,490	@13,910	@13,970	@13,870
Carrying Capacity	@2,080	@1,767	@1,365	@4,845	@3,912	@4,046
Hitch Weight	@975	@1,000	@1,530	@1,830	@1,960	@1,990
Axle Weight	@4,545	@4,831	@6,635	@7,155	@8,088	@7,954
Interior Height	6'6"	6'6"	6'10"	6'10"	6'10"	6'10"
Exterior Height*	8'11"	8'11"	12'2"	12'2"	12'2"	12'2"
Exterior Length	30'5"	32'5"	29'11"	33'0"	36'10"	36'10"
Exterior Width	93½"	93½"	93½"	93½"	93½"	93½"
Hitch Pin Height	19"	19"	45"	45"	45"	45"
Sleeping Capacity Std/Opt	6/8	6/6	6/4	6/4	6/4	6/4
Fresh Water Capacity (gal.)	30	30	45	45	45	45
Waste Water Capacity (gal.)	40	40	48	48	48	48
Grey Water Capacity (gal.)	35	30	48	48	48	48
Water Heater Capacity	6	6	6	6	6	6
LP Gas Capacity (lb.)	60	60	60	60	60	60
Furnace Rating (x 1000) BTU	30	30	30	40	40	40
Tire Size	ST205/75R15C	ST205/75R15C	ST225/75R15C	LT245/75R16E	LT245/75R16E	LT225/75R16E

\* Add 14" for Roof Air Conditioner on Travel Trailers

\*Add 10" for Roof Air Conditioner on Fifth Wheels

@ Estimated at time of printing

**Base Weight:** Dry weight of the unit with no fluids, cargo, optional equipment or accessories.

**GVWR (Gross Vehicle Weight Rating):** The maximum recommended loaded weight of the unit, including the base weight plus all fluids, cargo, optional equipment and accessories. For safety and product performance, do not exceed the GVWR.

**Carrying Capacity:** The difference between the base weight and the GVWR. This is the amount of weight available for all fluids, cargo, optional equipment and accessories. The actual "loaded" weight will depend on the equipped unit and the owner's individual choice of cargo, etc.

**Wider Widths:** Numerous Coachmen floorplans feature the "wide body" design concept, which gives you significantly enhanced interior living space and innovative floorplans.

In making your purchase decision, you should be aware that a few states restrict access on some or all state roads to 96" in width, though special road usage permits are generally available. Vehicles up to 102"

in width are permitted on all federal highways, and in the vast majority of states. You may wish to confirm the road usage laws in the states of interest to you before making your purchase decision. If width is of concern to you, we invite you to consider the broad array of other Coachmen models offered in the standard 96" width.

All information contained in this brochure is believed to be accurate at the time of publication. However, during the model year, it may be necessary to make revisions and Coachmen reserves the right to make all such changes without notice, including changes in prices, colors, materials, equipment and specifications, as well as the addition of new models and the discontinuance of models shown in this brochure. Therefore, please consult with your Coachmen dealer and confirm the existence of any materials, design or specifications that are material to your purchase decision.

# ROYAL TRAVEL TRAILER STANDARD FEATURES & OPTIONS

## STANDARD FEATURES

### INTERIOR AND DECOR

- Deluxe Velvet Fabrics
- Hardwood Raised Panel Oak Doors & Drawer Fronts
- Residential Metal Drawer Glides
- Partial Carpet with Pad
- Linoleum Flooring - Kitchen
- Lambrequins - Coach
- Day/Night Shades - Coach
- Roller Shades - Bedroom
- Mini Blind - Kitchen
- Upgraded Interior Light Package
- Radius Windows
- Jack Knife Sofa
- Swivel Rocker
- Four Prewired Stereo Speakers
- Cable TV Jack
- TV Antenna Ready
- TV Shelf - Bedroom
- LP Leak Alarm

### GALLEY

- Microwave Ready
- 3-Burner (High Output) Range with Oven
- Power/Lighted Range Hood
- Flush Mount, Double Door Refrigerator
- Raised Panel Hardwood Refrigerator Fronts

- Monitor Panel
- Stainless Steel Sink
- Silverware Drawer

### SLEEPING

- Queen Bed
- Bedspread and Pillow Shams
- Deluxe Innerspring Mattress - 312 Coil
- Bedlift System

### ELECTRICAL/HEATING/AC

- GFI Circuit
- Outside Receptacle GFI
- Patio Light
- Off-Door-Side Utility Light
- LP Light
- Double 30 LB. LP Bottles w/Auto Change-Over
- 31,000 BTU E.I. Furnace
- In-Floor Ducted Heating
- Prewired for Roof Air Conditioning

### BATH AND WATER

- Marine Toilet
- Power Bath Vent
- One-Piece ABS Tub Surround
- Solid Glass Shower Door (298FK)
- 6-Gallon Water Heater
- Water Heater By-Pass
- Demand Water Pump
- Decorative Bath Hardware
- Medicine Cabinet

### EXTERIOR/CONSTRUCTION

- Front and Rear Fiberglass Caps
- Deluxe Exterior Graphics Package
- Rubber Roof
- Fiberglass Insulation
- Gutter Rail With Down Spouts
- Double Entry Step - Primary Door
- Single Entry Step - Secondary Door
- Rear Entry Door
- Dead Bolt Lock(s)
- Rear Hose Storage Steel Bumper
- LP Bottle Cover
- Chrome Bumper Cover
- Rally Wheels
- Radial Tires

- Outside Shower
- Foam Core Insulation - Sidewalls
- Tinted Safety Glass - Radius Windows (Safety Glass Is Mandatory In Certain States)
- Ducted Roof Air Conditioning
- 13,500 BTU Roof Air Conditioner (Except with Ducted Roof A/C)
- 2nd 13,500 BTU Roof Air Conditioner (310WB)
- Wire and Frame For 2nd Roof A/C (310WB) (Mandatory with Ducted Roof A/C Option)
- Power Hitch Jack
- Continental Spare Tire Kit
- Retractable Stabilizer Jacks
- Straight Axle
- Awning
- California Code (310WB) (Mandatory in California with Second Roof A/C and Wire & Frame for 2nd Roof A/C Options)
- CSA Upfit

## OPTIONAL FEATURES

- Twin Beds (298FK)
- Bunk Beds (298FK)
- Wood Plank Flooring - Kitchen
- Free Standing Wood Dinette w/2 Chairs
- Residential Style AM/FM Cassette Stereo
- Outside Entertainment Center
- TV Antenna and Rotor Package
- Large Double Door Refrigerator
- Residential Size Microwave Oven - 1.3 Cu.Ft.
- 6-Gallon E.I. Water Heater

# ROYAL FIFTH WHEEL STANDARD FEATURES & OPTIONS

## STANDARD FEATURES

### INTERIOR AND DECOR

- Deluxe Velvet Fabrics
- Hardwood Raised Panel Oak Door & Drawer Fronts
- Residential Metal Drawer Glides
- Carpet with Pad - Living Room
- Carpet with Pad - Bedroom
- Linoleum Flooring - Kitchen
- Lambrequins - Coach
- Day/Night Shades - Coach
- Roller Shades - Bedroom
- Mini Blind - Kitchen
- Upgraded Interior Light Package
- Radius Windows
- Side Dinette
- Jack Knife Sofa
- Swivel Rocker
- Second Swivel Rocker (315 Thru 370)
- Four Prewired Stereo Speakers
- TV Antenna Ready
- Cable TV Jack
- TV Shelf - Bedroom
- LP Leak Alarm
- Trash Can

- Bedspread and Pillow Shams
- Bedlift System on Island QB

### ELECTRICAL/HEATING/AC

- 30-Amp. Power Cord
- GFI Circuit
- Outside Receptacle GFI
- Patio Light
- Off-Door-Side Utility Light
- Hitch Light
- Double 30 LB. LP Bottles w/Auto Change-Over
- In-Floor Ducted Heat
- 31,000 BTU E.I. Furnace (285RK)
- 40,000 BTU E.I. Furnace (315RL, 360RK, 370RL)
- Prewired for Roof Air Conditioning

### BATH AND WATER

- Marine Toilet
- Power Bath Vent
- One-Piece ABS Tub Surround
- Solid Glass Shower Door
- 6-Gallon Water Heater
- Water Heater By-Pass
- Demand Water Pump
- Decorative Bath Hardware
- Medicine Cabinet

### EXTERIOR/CONSTRUCTION

- Front and Rear Fiberglass Caps
- Deluxe Exterior Graphics
- Rubber Roof
- Fiberglass Insulation
- Gutter Rail With Down Spouts
- Triple Entry Step - Primary Door
- Dead Bolt Lock(s)
- Rear Hose Storage Steel Bumper
- Chrome Bumper Cover
- Hydraulic Slide Room

- Retractable Stabilizer Jacks
- Rally Wheels
- Radial Tires

## OPTIONAL FEATURES

- Twin Beds (Except on 370RL)
- Wood Plank Flooring - Kitchen
- Two Bar Stools (315RL, 370RL)
- Free-Standing Dinette with Four Chairs
- Deluxe Sofa w/Hide-A-Bed (285RK, 360RK)
- Residential AM/FM Cassette Stereo
- Outside Entertainment Center
- Combo Washer/Dryer (315 thru 370) (Includes 10 Gallon E.I. Water Heater) (Requires 50 Amp. Service for California)
- TV Antenna and Rotor Package
- Phone Jack
- Wall Hugger Recliner
- 2nd Wall Hugger Recliner (315RL, 370RL)
- Slide-Out Pantry - Kitchen (Slide-Out Pantry is not available with Side-By-Side Refer.)
- Side-By-Side Refer/Freezer (285 thru 370) (Slide-Out Pantry is not available with Side-By-Side Refer.)
- Flush Mount, Large, Double Door Refrigerator
- Residential Size Microwave Oven, -1.3 Cu.Ft.
- Plumbing For Washer/Dryer (315 thru 370) (Includes 10 Gallon E.I. Water Heater) (Requires 50 Amp. Service for California)
- 6-Gallon E.I. Water Heater
- Walk-Thru Bath w/Garden Tub (285RK)
- Garden Tub (370RL)
- Outside Shower
- Foam Core Insulation - Sidewalls
- 42" Ceiling Fan
- Tinted Safety Glass - Radius Windows (Safety Glass is Mandatory in Certain States)
- Ducted Roof Air Conditioning
- 13,500 Roof Air Conditioner (Except with Ducted Roof A/C Option)
- 2nd 13,500 Roof Air Conditioner (Requires 50 Amp. Service for California)
- Wire and Framed For 2nd Roof Air Conditioner (Mandatory with Ducted A/C) (315 thru 370) (Requires 50 Amp. Service for California)
- 50-Amp. Service (Mandatory in California)
- Electric Front Jack(s)
- Continental Spare Tire Kit (285RK)
- Continental Spare Tire Kit (315RL,360RK,370RL) (16" Wheels)
- Luggage Rack and Ladder
- Shock Absorbers
- Awning
- Slide-Out Room Awning
- CSA Upfit

### GALLEY

- Microwave Ready
- 3-Burner (High Output) Range with Oven
- Power/Lighted Range Hood
- Flush Mount Double Door Refrigerator
- Raised Panel Hardwood Refrigerator Front
- Monitor Panel
- Stainless Steel Sink
- Silverware Drawer

### SLEEPING

- Queen Bed
- Deluxe Innerspring Mattress - 312 Coil



# WHAT YOU CAN'T SEE USUALLY COUNTS THE MOST.

Coachmen believes its owners are entitled to quality and sturdy construction even if it's hidden from view. Hidden quality does cost more, and the uneducated buyer may not always understand the difference. But, those differences can be critical to long-term satisfaction and future resale value.

"Hidden" quality features from Coachmen include:

### • All Copper L.P. Lines

Most brands use copper at the appliances, then switch to a much less expensive black steel pipe under the floor.

Coachmen uses copper tubing for its entire L.P. gas system, inside and outside the coach. Further, the copper tubing is mechanically double-flared at the fittings, to provide a stronger, 2-ply seal. Under the coach, care is taken to run the copper lines encased in a plastic sleeve through the frame, so they are protected from potential road damage.



### • Superior Undercarriage

To protect the underside of the unit from road damage and the elements, Coachmen first applies automotive undercoating to the wheel wells, then installs Darco, a rugged fiber-laminated polypropylene material, along the undercarriage. Darco has the highest puncture and solvent resistance, and passes the surface burn requirements of F.M.V.S.S. #302. Don't be fooled by less-expensive, look-alike materials used by other brands, which offer inferior protection.

### • Seamless Exterior Metal

Exterior seams lead to leaks and structural damage. Coachmen products have no seams in the exterior metal, even though "patching" shorter pieces together would be less expensive.

Beneath our exterior metal is high quality #2 Grade North American

lumber, with roofs and sidewalls on 16" centers.

### • Structurwood® Floor

Consistent with residential construction, Coachmen uses Structurwood for its flooring, which has been proven to be 10% stronger, and resists water absorption far better than plywood.

### • Box Channel Steel Frame

Coachmen uses a heavy-gauge cambered "Box" steel frame with cross-members on 48" centers. The frame is primed and painted with two rust inhibiting coats of paint.



Some brands use a Box channel on the visible parts of the frame, then switch to the weaker and less expensive "C" channel for the hidden undercarriage.

### • Insulation

Coachmen towable products feature Owens-Corning spun fiberglass insulation. Its R-7 rating is 40% greater than many competitors. Each piece of insulation is carefully measured, and packed into every crevice by hand, then mechanically secured. This costly process insures insulation protection that does not shift downward with vibration.

Be sure to check out these and other hidden quality features, to ensure your long-term pleasure and peace of mind.



## BUYER'S CHECKLIST

*To help you make an informed purchase decision you'll enjoy for many years to come, refer to this list of Coachmen features. Please compare us to the competition!*

- ✓ Hydraulic Slide Room System on all double and super slides
- ✓ Seamless exterior metal
- ✓ Box-channel cambered steel frame, primed and painted with two coats
- ✓ Darco undercarriage shield
- ✓ Wheel-well undercoating
- ✓ Copper L.P. lines; entire system
- ✓ Crowned, seamless roof for water protection
- ✓ Roof rain gutters and down spouts
- ✓ Owens-Corning R-7 insulation, hand cut and packed
- ✓ 2"x2" North American #2 grade wall studs, on 16" centers
- ✓ 2"x 6" door headers with 2"x 4" door jambs
- ✓ Electrical wiring routed through studs and protective metal sleeves
- ✓ Finished and sealed exterior storage compartments
- ✓ Heavy-duty, stain resistant upholstery
- ✓ Stain-repellent carpet and superior padding
- ✓ Optimum window design; sliders and jalousies
- ✓ Wood door frame/cabinet construction
- ✓ Residential drawer glide system
- ✓ Silverware and utensil drawer
- ✓ Tub/shower liner
- ✓ Bed lift system
- ✓ Extensive 12V and 110V lighting
- ✓ Deluxe 312 coil innerspring mattress
- ✓ Two-Year Structural Warranty

## UP-FRONT DESIGN FOR LONG TERM COMFORT.

Founded in 1964, Coachmen is one of the oldest, continuous producing manufacturers of recreational vehicles. A secret of our success is our commitment to the continuous improvement of our products.

With over three decades of experience, we have learned that quality must be designed and built *in to* the products, up front. Combining our experience with the latest technological advances, we are able to prevent problems before they arise, through proper analysis and testing. Coachmen goes the extra mile to provide our customers with quality products.

### DESIGN & ANALYSIS

It is now fairly common for companies to use C.A.D. as a drafting tool. Coachmen, however, takes computerized technology far beyond elementary applications.

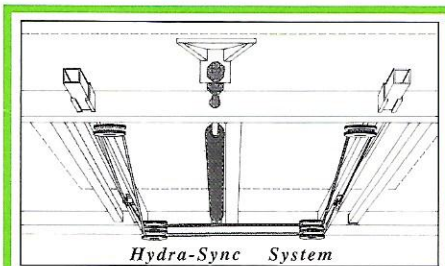

All Coachmen Double and Super Size Slide out rooms feature reliable and powerful hydraulic systems. The Hydra-Sync system from Dewald Manufacturing, Inc. utilizes a single hydraulic cylinder powered by an electric motor. The system also uses strong cables that keep the room traveling in synchronization. The system offers more power to move large slide rooms and also provides for tight and positive seals.

Through significant capital and manpower investments, Coachmen uses computers to see that everything fits—up front—so we can minimize gimp, trims and other “cover-up” techniques seen so often in other brands.

We also use the computer for advance testing made possible by technology programming. **Weight testing** is performed on every new model. Before

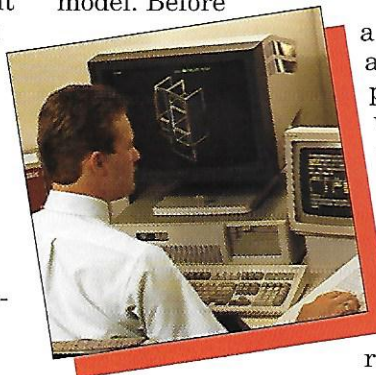

a floorplan is approved for production, we know the approximate weights, including dry and loaded, front and rear axle

weights and even side-to-side weights which affect towability. After a model is built, the computer analysis is manually verified.

Another important use of the computer is Coachmen's unique utilization of **Finite Element Analysis**. This technique, based on computer modeling, enables Coachmen to predict, and avoid, many problems caused by inappropriate stress. Examples of analysis and proof of validity include our cambered frame and cross-member design, the thickness and composition of our flooring and our slide rooms and their impact on the structural integrity of the entire coach.

With this investment in technology, we try to anticipate and solve problems before they occur.

### LEAK PREVENTION

Due to the complexity of the product, compounded by road vibration, water leaks can be a problem. Coachmen's quest is to eliminate this frustrating

and potentially damaging problem.



Our outer skins are seamless, and every corner—at the roof, floor and sidewalls—is wrapped, sealed and secured. All

roof and sidewall openings receive framing reinforcement, and are sealed with a non-shrinking, pliable silicone.

Finally, every unit we produce is tested for leaks in a high-pressure rain chamber, designed to simulate a driving rain, not just a spring shower.

### PERFORMANCE TESTING

Coachmen does not want, nor expect, our customers to be the “proving ground.” We believe it is our job to adequately test our products, before they reach our customers.

Coachmen subjects its new models to a myriad of advance tests, before



introduction to the customer. Rigorous road tests, sometimes up to 15,000 simulated miles, are performed on actual production units, to verify computer modeling. Studies are made of structural integrity, stress analysis, cabinetry durability, weight loading, vibration analysis and handling.

There can be little doubt that Coachmen has superior quality—by design.

# LONG TERM ENJOYMENT

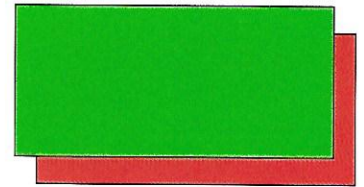

## A WARRANTY TO COUNT ON.

### BUCKSTOPPER WARRANTY

We work very hard to see that our products out-perform your expectations. But, should something go wrong with the workmanship or materials during the warranty period, we will fix it. As the saying goes, the buck stops here.

Your Owner's Registration Card and our famous Buckstopper Warranty are your passport to worry-free travel. Throughout the United States and Canada, our network of over 300 independent dealers stands ready to provide you with courteous, dependable service.



### TWO-YEAR STRUCTURAL WARRANTY

We are very confident about our products, for reasons explained in this brochure. Our owners share in our confidence, with Coachmen's exclusive TWO-YEAR LIMITED STRUCTURAL WARRANTY. Only with Coachmen do you receive extended peace of mind and warranty coverage for your floor, ceiling assembly and any laminated structural components.

### TRANSFERABLE WARRANTY

Your Buckstopper Warranty may be transferred to a subsequent owner for a small registration fee, if you sell your coach during the term of your one-year Buckstopper Warranty. This feature greatly enhances the resale value of your Coachmen product. (Sorry, the Extended Limited Structural Warranty may not be transferred.)

When making your purchase decision, you should select a company you can count on, with a warranty you can depend on. **Nobody protects you better than Coachmen...for the long haul!**

See your Coachmen dealer for complete details on our generous warranty program.

## FRIENDS & FUN FOR LIFE.

Your purchase of a Coachmen recreational vehicle qualifies you for a **free, one-year membership** in the International Coachmen Caravan, one of the nation's largest RV clubs. Consisting of over 10,000 member families, the Coachmen Caravan was

formed in 1966 to help our owners enjoy RV ownership to the fullest.

With Coachmen, unlimited opportunities exist for you and your family to form lifelong friendships; improve and share your unique talents, skills and crafts; be active in running your

club; and exchange ideas, information and helpful hints—all these, plus the many benefits outlined below, are uniquely yours through the International Coachmen Caravan.

### INCREDIBLE MEMBERSHIP BENEFITS!

In addition to automatically expanding your circle of friends, your Caravan membership brings you a multitude of benefits:

- Free \$5,000 Accidental Death and Dismemberment Insurance policy, with additional policies available for \$5 a year.
- Emergency road service and RV insurance at low rates.
- Free trip-planning service.
- 10% Discounts at over 2,500 campgrounds in the U.S. and Canada.
- Free annual Campground Directory.
- Hassle-free group travel to popular destinations.

- Free lost-key return service.
- Organized campouts, meetings and parties.
- Free subscription to COACHMEN CAPERS, the club's quarterly magazine.
- Annual International Rally Week.
- Free I.D. card, Caravan key ring, vehicle decals and I.D. numbers.
- A Coachmen Caravan MasterCard with no annual fee and low interest.
- Discounts on club clothing, accessories, film developing and selected RV publications.

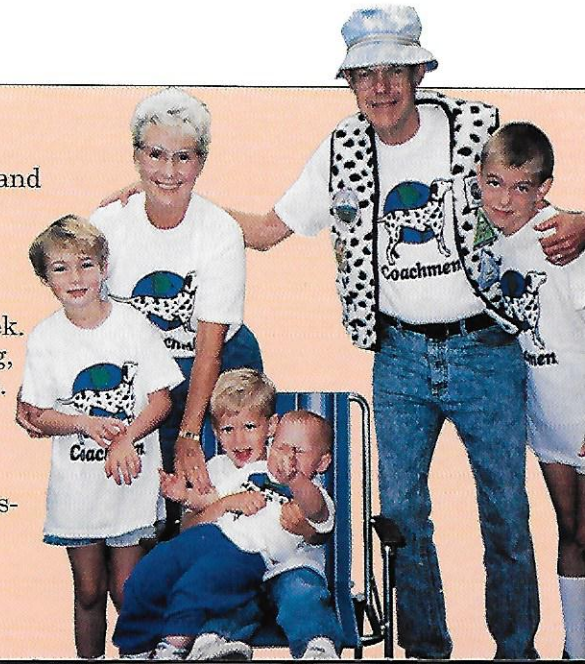

# THE COMPANY

## COACHMEN: LEADER TO THE GREAT OUTDOORS.

Coachmen Recreational Vehicle Company has manufacturing facilities in Middlebury, Indiana, and Fitzgerald, Georgia, and occupies over 600,000 square feet on nearly 120 acres. The Coachmen name is one of the most recognized names in our industry, and our products provide recreational enjoyment throughout North America and Europe.

From our beginning in 1964, we have been, "Dedicated to the Enrichment of Your Life." You will find proof of this dedication in our innovative and user-friendly products and our smorgasbord of customer benefits and services.

We are driven by a deep concern for your safety, comfort, pride of ownership and pleasure—in short, **your satisfaction.**

Coachmen knows what it takes to make an RV great. Join us! We'll lead the way to the great outdoors.

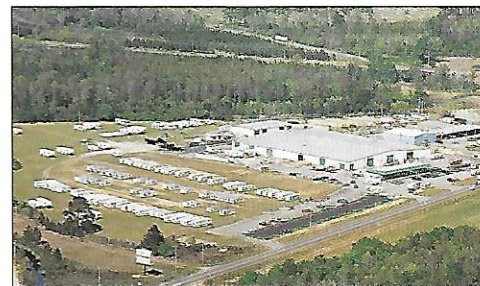

*Come visit us at our Georgia facility (above right), or our Complex in Indiana (top) where you can relax at our Visitor's Center (above left) and enjoy guided tours of the assembly plants.*

### MEET PETE THE COACHMEN DALMATIAN.

Pete, the Dalmatian, has been a vital part of Coachmen since 1964, when he joined our newly formed company as watchdog, playmate and friend.

Pete became our official mascot when we learned that, coincidentally, the

Dalmatian is the official "coach dog."

Since then, Pete has guided Coachmen and America to the best in products, quality and customer satisfaction.

Follow Pete to the Great Outdoors.



**JERRY'S TRAILERS & CAMPERS**  
2601 S. 13th St.  
Norfolk, NE 68701



P.O. Box 30, Middlebury, IN 46540 • P.O. Box 948, Fitzgerald, GA 31750

