

# Coachmen®

1996 CLIPPER AND SPORT CAMPING TRAILERS

**FEATURES & VALUE  
BEYOND COMPARE**

**ECONOMICAL SPORT  
NEW FOR '96**

**WARRANTY  
COVERAGE YOU  
CAN COUNT ON**

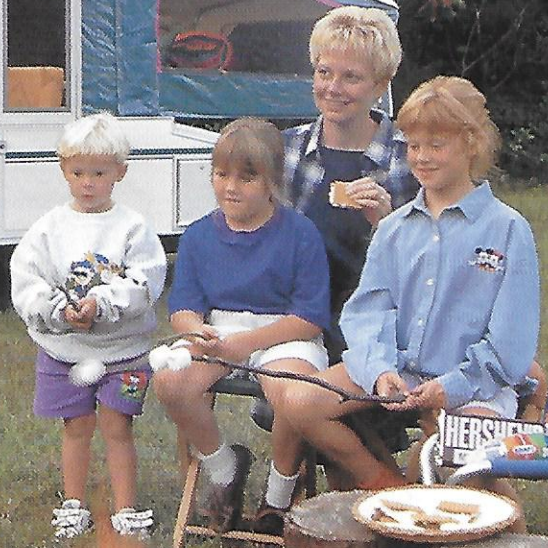

**FREE!  
OWNER'S CLUB  
MEMBERSHIP &  
BENEFITS!**

# GREAT NEW CHOICES FOR FAMILY CAMPING FUN

Coachmen's selection of floorplans and styles provides a camping trailer for nearly any budget and camping need. Choose from the popular Clipper series, featuring wide-body design and a variety of versatile floorplans, or the all new standard width Sports series which combines outstanding economy and value.

Both models are loaded with great features and equipment such as convenient inside/outside three burner range tops, decorator drapes and valances, free standing portable dinette tables, sectionalized vinyl tent and 4" high density foam dinette and bunk cushions. Popular options such as awnings and screen rooms are also available to help make camping in your Coachmen as comfortable as it is fun.

Take a close look at both Clipper and Sport and you'll see why they are both a favorite choice for both beginning and veteran campers alike.

- **Independent Rubberized Suspension.** This specially designed system helps prevent excessive swaying and bouncing when you're towing. It makes Clipper a joy to tow.

- **Wide Track Tires.** Coachmen uses larger tires than most manufacturers to assure better performance and safety. All eight and ten foot box campers feature 12" tires while all 12 foot models are equipped with 13" tires.

- **Stucco Embossed Metal.** This baked on finish will protect your camping trailer for years. It's highly resistant to scratches that can easily occur on smooth paint finishes.

- **Sectionalized Vinyl Tent.** The five-piece sectionalized vinyl tent provides durable, practical and reliable alternative to other materials being used in many camping trailers today. When repairs are necessary to the tent, sections can be removed and replaced without the need to remove



*ABOVE: Clipper comes in five wide-body floorplans with sleeping capacities of up to eight people in some models.*



*ABOVE: Economical Sport camping trailers provide unbeatable comfort and livability as well as the value of Coachmen quality.*

the entire tent. The vinyl is also more water resistant and less likely to mold or mildew.

- **Crowned Laminated Roof.** Newly designed roof has the strength and durability only found in laminated construction. The crowned design allows for controlled water runoff which eliminates standing water. All roofs are reinforced for roof air conditioners.

- **Deluxe Cushions.** When it comes to our interiors, we don't cut corners. Coachmen uses only high density,

closed cell, 4" urethane cushions. These cushions will stay firm and comfortable for years to come.

- **Structurwood Flooring.** The 5/8" Structurwood flooring provides a sturdy foundation. Structurwood is 10% stronger than plywood. It's also more resistant to water and has no seams that can buckle or bow.

Compare Coachmen's Clipper with any other brand of camper on the market today. You'll see why Coachmen is "Leader To The Great Outdoors."

# FLOORPLANS & SPECIFICATIONS

### 086 Sport

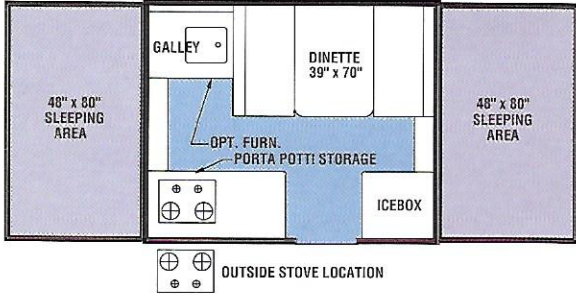

### 1080 Clipper

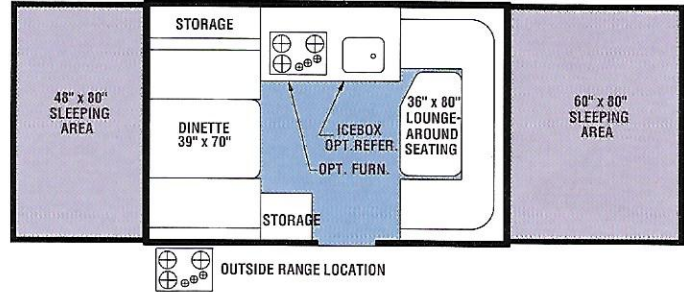

### 106 Sport / 1060 Clipper

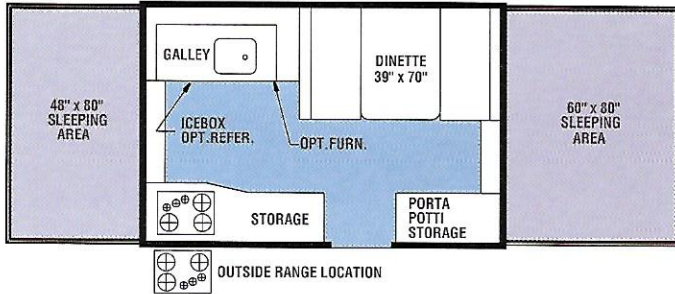

### 1260 Clipper

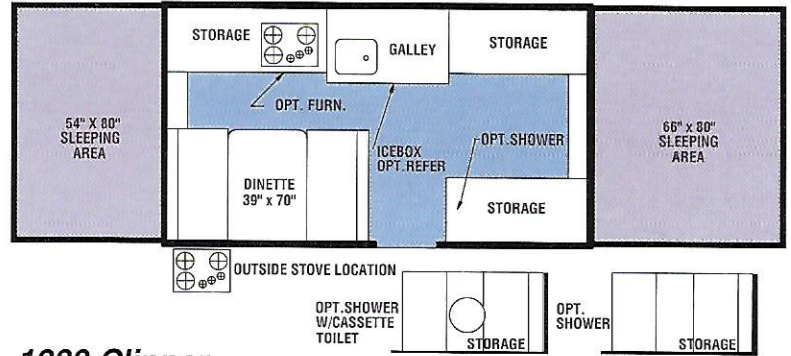

### 1070ST Clipper

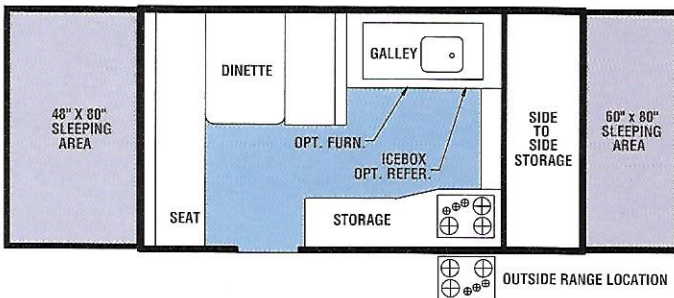

### 1280 Clipper

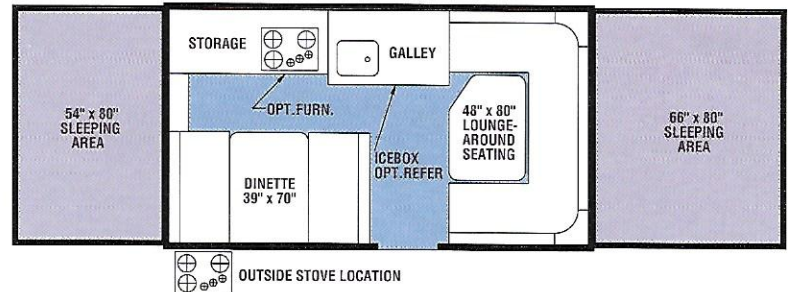

	Sport		Clipper				
	086	106	1060	1070ST	1080	1260	1280
Frame Length	12'1"	14'2"	14'3"	16'9"	14'3"	16'1"	16'1"
Body Length	8'	10'	10'	12'	10'	12'	12'
Open Length	17'1"	20'0"	20'0"	20'0"	20'0"	23'0"	23'0"
Width	85'	85'	85'	85'	85'	85'	85'
Closed Height	52'	52'	50'	50'	50'	50'	50'
Open Height (Interior)	6'6"	6'6"	6'6"	6'6"	6'6"	6'6"	6'6"
Axle Weight (lbs.)	970	1180	1230	1600	1385	1490	1510
Tongue Weight (lbs.)	150	170	180	100	170	210	210
Base Weight (lbs.)	1120	1350	1410	1700	1555	1700	1720
Carrying Capacity (lbs.)	864	654	970	600	815	710	690
GVWR (lbs.)	1984	2004	2380	2300	2370	2410	2410
Tire Size	4:80x12C	4:80x12C	B78x13C	B78x13C	B78x13C	B78x13C	B78x13C
Pressure	90 PSI	90 PSI	50 PSI	50 PSI	50 PSI	50 PSI	50 PSI

**Base Weight:** Dry weight of the unit with no fluids, cargo, optional equipment or accessories.  
**GVWR (Gross Vehicle Weight Rating):** The maximum recommended loaded weight of the unit, including the base weight plus all fluids, cargo, optional equipment and accessories. For safety and product performance, do not exceed the GVWR.

**Carrying Capacity:** The difference between the base weight and the GVWR. This is the amount of weight available for all fluids, cargo, optional equipment and accessories. The actual "loaded" weight will depend on the equipped unit and the owner's individual choice of cargo, etc.

\* Some models have have widths of 6'6".

# STANDARDS & OPTIONS

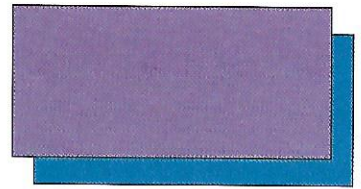

## STANDARD FEATURES

### INTERIOR AND DECOR

- Deluxe Picture Frame Cabinet Doors (Clipper Only)
- 1/2" Foil Edged Doors (Sport)
- Eye Catching Fabric Colors
- Decorator Drapes & Valances
- Bunk End Privacy Drapes
- Easy-Care Linoleum Flooring
- Inside/Outside Free-Standing Portable Dinette Table
- 4" High Density Foam Dinette and Bunk Cushions
- Plywood Seat Boxes with Hinged Lids
- Fire Extinguisher
- Clothes Bar (Clipper Only)

### GALLEY

- 2-Burner Inside/Outside Range Top (086)
- 3-Burner Inside/Outside Range Top (106), (Clipper Only)
- 35lb. Ice Box
- Flip-Over Galley (Sport)
- Stainless Steel Galley Sink
- Swing-Up Galley (Clipper)

### ELECTRICAL

- 6-AMP Power Converter
- 12-AMP Power Converter
- 25-Foot Power Cord
- Interior and Exterior 110-Volt Outlets
- 12-Volt Lighting
- Amber Porch Light

### BATH AND WATER

- Porta Potti Storage Area
- City Water Fill System with Brass Connections
- 12-Gallon Water Tank
- Hand Galley Pump
- Gravity Water Fill

### EXTERIOR AND CONSTRUCTION

- 3" Tubular Steel Frame (Sport)
- 4" Tubular Steel Frame (Clipper Only)
- Laminated Metal Sidewalls
- Crowned Laminated Roof
- A/C Steel Reinforced Roof
- Slide Out Entrance Step
- 14x14 Roof A/C Vent
- 5/8" 5-ply Plywood Bunk Beds
- Built-in Awning Rail

- Super Wide Axle w/Leaf Spring Suspension (Sport)
- Super Wide Axle w/Torflex Suspension (Clipper)
- 2" Coupler
- Steel Bumper
- 2 Stabilizer Jacks (086)
- 4 Stabilizer Jacks (106 thru 235RD)
- 3-Way Tongue Jack w/Dolly Wheel
- Spare Tire, Bracket and Cover
- Styled Wheels w/Cap
- 20lb. LP Bottle
- 12-Volt Outlet
- One-Piece Marine Base Structurwood Floor
- Hinged Bunk Bows w/Tension Rafter
- Teal Five Piece Sectionalized Vinyl Tent with Colorful Accent Trim
- Two Way Tent Windows with Fine Mesh Screen
- Colorful Exterior Graphics

## OPTIONAL FEATURES

- Three-Way Refrigerator
- 16,000 BTU E.I. Furnace
- Battery Rack, Battery Box & Wiring
- Electric Brakes
- Shower (Clipper)
- Trim Line Awning
- Trim Line Screen Room
- CSA Upfit

All information contained in this brochure is believed to be accurate at the time of publication. However, during the model year, it may be necessary to make revisions and Coachmen reserves the right to make all such changes without notice, including changes in prices, colors, equipment

and specifications as well as the addition of new models and the discontinuance of models shown in this brochure. Therefore, please consult with your Coachmen dealer and confirm the existence of any materials, design or specifications that are material to your purchase decision.

## A WARRANTY TO COUNT ON.

### BUCKSTOPPER WARRANTY

We work very hard to see that our products out-perform your expectations. But, should something go wrong with the workmanship or materials during the warranty period, we will fix it. As the saying goes, the buck stops here.

Your Owner's Registration Card and our famous Buckstopper Warranty are your passport to worry-free travel. Throughout the United States and Canada, our network of over 300 independent dealers stands ready to provide you with courteous, dependable service.

### ADDITIONAL COVERAGE.

Clipper Warranty coverage is comprehensive. Aside from the one-year Buckstopper Warranty, Clipper camping trailers feature additional warranty protection on several components and systems.

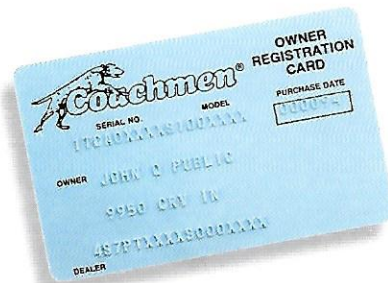

- **Structurwood Floor**- 10 year warranty.
- **Vinyl Tent**- 5 year warranty covering functional defects and workmanship.
- **Crank Lift System**- Lifetime limited warranty covering functional defects and workmanship.
- **Independent Suspension**- 5 year warranty covering functional defects and workmanship.

When making your purchase decision, you should select a company you can count on, with a warranty you can depend on. **Nobody protects you better than Coachmen..for the long haul!**

See your Coachmen dealer for complete details on our generous warranty program.

# FEATURES GALORE!

A complete photo album would be required to fully display the many features and innovations of Coachmen's affordable camping trailers. Here are just a few.

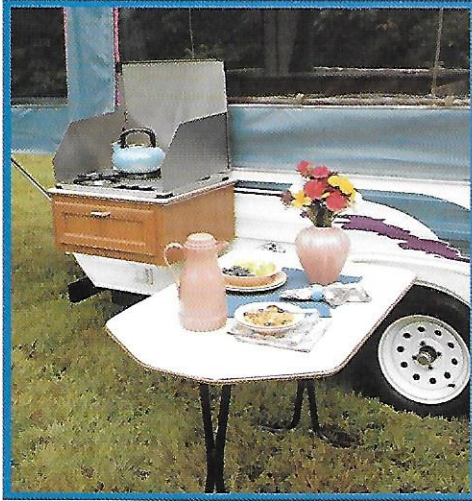

▲ Range tops are designed for use both inside and outside the camper. Dinette tables also are portable for dining under the sun or stars.

The Clipper 1070 ST features popular front trunk storage. This storage area is accessible from both inside and outside the camper. The outside doors are lockable.

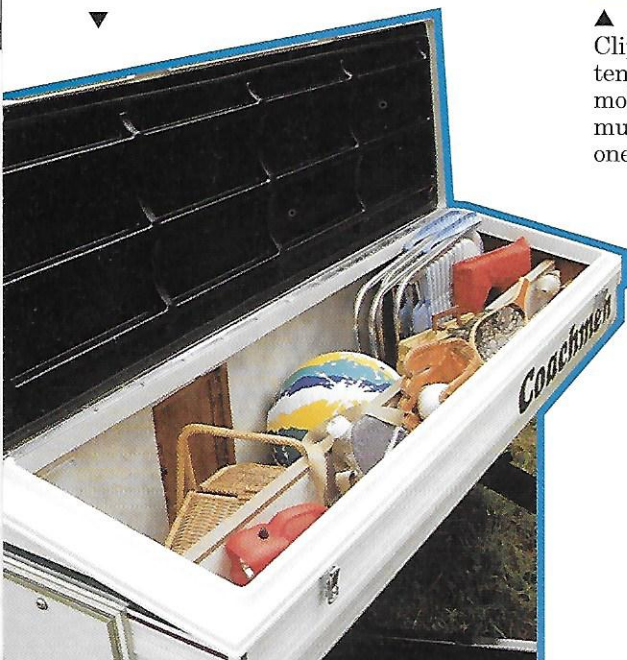

◀ This handy ceiling mounted wardrobe bar helps keep clothes neat and easy to reach in the Clipper.

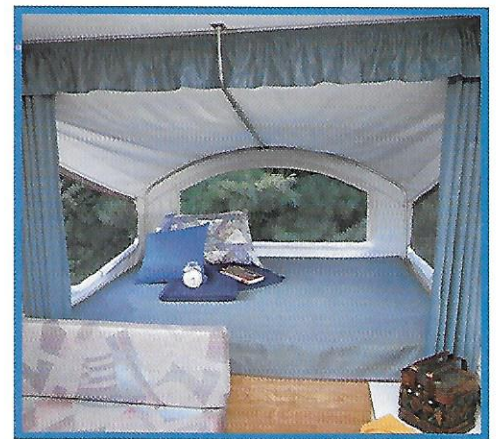

▲ Bunk areas feature firm and comfortable 4" high density closed cell foam cushions for outstanding durability. Optional bunk lights are also available to add even more convenience and livability.



▲ Clipper's five-piece sectionalized vinyl tent is water resistant to help prevent mold and mildew and, when necessary, much easier to repair than conventional one-piece tents.

Galleys feature a beautiful and rugged residential style countertop and stainless steel sink. ▶

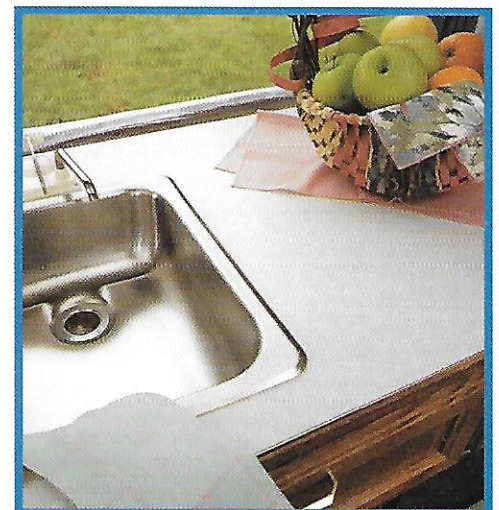

# COACHMEN: LEADER TO THE GREAT OUTDOORS.

Coachmen Recreational Vehicle Company has manufacturing facilities in Middlebury, Indiana, and Fitzgerald, Georgia, and occupies over 600,000 square feet on nearly 120 acres. The Coachmen name is one of the most recognized names in our industry, and our products provide recreational enjoyment throughout North America and Europe.

From our beginning in 1964, we have been, "Dedicated to the Enrichment of Your Life." You will find proof of this dedication in our innovative and user-friendly products and our smorgasbord of customer benefits and services.

We are driven by a deep concern for your safety, comfort, pride of ownership and pleasure—in short, **your satisfaction.**

Coachmen knows what it takes to make an RV great. Join us! We'll lead the way to the great outdoors.



*Come visit us at our Georgia facility or our Complex in Indiana (pictured), where you can relax at our Visitor's Center and enjoy guided tours of the assembly plants.*

## FRIENDS & FUN FOR LIFE.

Your purchase of a Coachmen recreational vehicle qualifies you for a **free, one-year membership** in the International Coachmen Caravan, one of the nation's largest RV clubs. Consisting of over 10,000 member families, the Coachmen Caravan was formed in 1966 to help our owners enjoy RV ownership to the fullest.

With Coachmen, unlimited opportunities exist for you and your family to form lifelong friendships; improve and share your unique talents, skills and crafts; be active in running your club; and exchange ideas, information and helpful hints—all these, plus the many benefits outlined below, are uniquely yours through the International Coachmen Caravan.

### INCREDIBLE MEMBERSHIP BENEFITS!

In addition to automatically expanding your circle of friends, your Caravan membership brings you a multitude of benefits:

- Free \$5,000 Accidental Death and Dismemberment Insurance policy, with additional policies available for \$5 a year.
- Emergency road service and RV insurance at low rates.
- Free trip-planning service.
- 10% Discounts at over 2,500 campgrounds in the U.S. and Canada.
- Free annual Campground Directory.
- Hassle-free group travel to popular destinations.
- Free lost-key return service.
- Organized campouts, meetings and parties.
- Free subscription to COACHMEN CAPERS, the club's quarterly magazine.
- Annual International Rally Week.
- Free I.D. card, Caravan key ring, vehicle decals and I.D. numbers.
- A Coachmen Caravan MasterCard with no annual fee and low interest.
- Discounts on club clothing, accessories, film developing and selected RV publications.

### JERRY'S TRAILERS & CAMPERS

2601 S. 13th St.  
Norfolk, NE 68701



P.O. Box 30, Middlebury, IN 46540 • P.O. Box 948, Fitzgerald, GA 31750

