

1994 Catalina Class A Motorhomes



Value for the long haul.

Coachmen's Catalina Class A lineup for 1994 is sure to offer something for just about every motorhome enthusiast.

Fresh new styling, exciting new floorplans and the addition of an available rear diesel model put the Catalina truly in a class of its own. Equipped with an outstanding list of standard features, Catalina is a great combination of economy and quality.

Catalina features fully laminated construction, seamless one piece rubber roof, and beautiful interior appointments that are as durable as they are comfortable. Choose from three tastefully coordinated deluxe velvet decors.

Select from floorplans ranging in length from 29 to 35 feet. If you prefer diesel power, Catalina offers the 300 mid bath based on the economical and efficient Spartan 1-K chassis. This rear diesel chassis features a 6.5 litre engine and 190 horsepower to provide the perfect blend of power and fuel economy.

Whether you are considering your first motorhome or you're just ready for a change, you owe it to yourself to test drive a Catalina. There's no better value on the market. After all, it is a Coachmen.



Catalina's roomy front lounge is great for entertaining or simply taking in the sights.



Rich velvet cherry cabinetwork and plush deluxe velvet fabrics give Catalina that extra touch of class.

Catalina Class A Floor Plans and Technical Specifications

When it comes to space utilization, Coachmen has no equal. That's because designing for livability is one of our first and foremost concerns. Whether studying our floorplans or comparing our specifications to the competition, you'll find that you get more for your money when you choose Coachmen.

290_{QB} Queen Bed

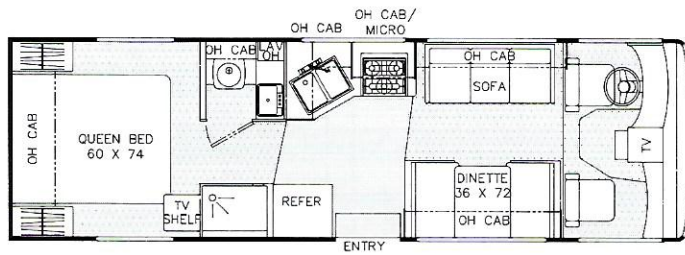

300_{MB} Mid Bath Rear Diesel

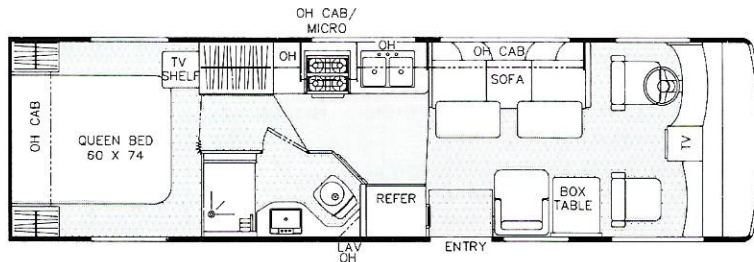

320_{MB} Mid Bath

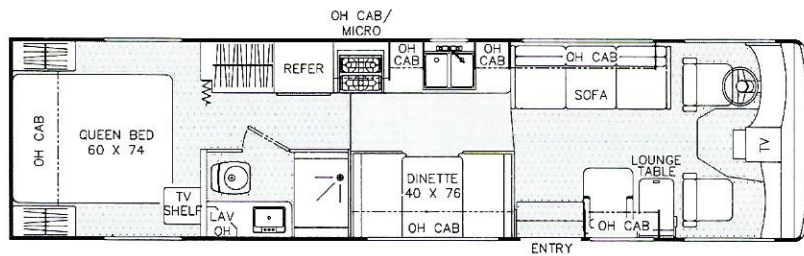

350_{SI} Side Aisle

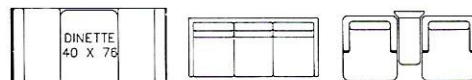
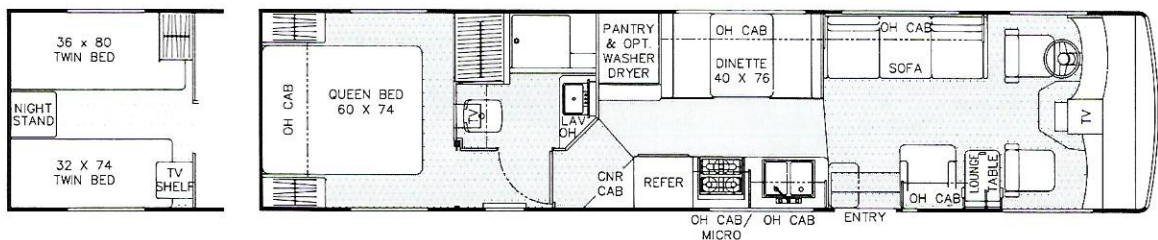

Catalina Class A Motorhomes

	Gasoline					Rear Diesel
	290 QB	320 MB	320 MB	350 SI	350 SI	300 MB
Chassis	Chevrolet	Chevrolet	Ford	Chevrolet	Ford	Spartan
Exterior Length	28'9"	32'4"	32'4"	35'1"	35'1"	30'6"
Exterior Clearance Height†	10'3"	11'1"	11'1"	11'1"	11'1"	10'8"
GVWR Pounds*	12,300	16,000	17,000	16,000	17,000	16,000
UVW Pounds**	N/A	N/A	N/A	13,008	13,192	13,068
GAWR Front*** Pounds	4,880	5,500	6,000	5,500	6,000	5,000
GAWR Rear*** Pounds	7,500	10,500	11,000	10,500	11,000	11,000
GCWR**** Pounds	19,500	19,500	25,000	19,500	25,000	20,000
Chassis Model	CP31432	CP31932	F53	CP32032	F53	KC2242-190
Engine Size—Cubic Inch	454	454	460	454	460	396
Wheel Base	158.5"	190"	190"	208"	208"	190"
Rear Axle Ratio	4.10	4.63	5.13	4.63	5.13	N/A
Fuel Capacity (gal.)	40	80	75	80	75	60
Alternator Amps	105	105	100	105	100	105
Fresh Water Capacity (gal.)	40	51	51	80	80	45
Waste Water Capacity (gal.)	37	45	45	55	55	42
Grey Water Capacity (gal.)	42	45	45	45	45	45
Water Heater Capacity	6	6	6	6	6	6
LP Gas Capacity (lb.)	60	85	85	85	85	85
Furnace Rating (x 1000) BTU	30	34	34	34	34	30
Tire Size	‡	△	▲	△	▲	8R x 19.5E

- *GVWR** **Gross Vehicle Weight Rating:** Maximum loaded weight of a vehicle as established by the manufacturer. (NHTSA)
- **UVW** **Unloaded Vehicle Weight Rating:** The weight of a unit and maximum fluid capacity for operation of the unit but without cargo, occupants, or accessories that ordinarily are removed from the vehicle when it is not in use (NHTSA). Rating shown is for unit with no factory or dealer installed options.
- ***GAWR** **Gross Axle Weight Rating:** Total weight an axle, suspension and tires are designed to carry.
- ****GCWR** **Gross Combined Weight Rating:** Total loaded weight of a unit and towed vehicle combination as established by the manufacturer. Includes unit and tow vehicle weight, equipment, gas, water, passengers and payload.

NOTES: All specifications are approximate. NA=Not available at time of printing.
 ‡=7.5R x 16D △=8R x 19.5D ▲=LT235/85R16E
 †Add 10" for Roof Air Conditioner.

NOTE: All capacities are approximate. All fuel and liquid capacities are approximate all dimensions are nominal. Coachmen motorhomes are designed to allow for a variety of uses. Each unit features optimum seating, fluid storage and sleeping capacity. Although all seats are equipped with seatbelts for your safety, seats occupied while vehicle is in motion will depend on your total load. While the customer is the beneficiary of this design, the customer also bears the responsibility to select the proper combination of load/cargo and passengers without exceeding the chassis weight capacities. Coachmen assists you in this decision by posting a weight calculation form stating actual unit weight with factory installed options inside a wardrobe/cabinet.



High Output Range

For years, the traditional four-burner range has been an aggravation because the burners were too low powered to heat anything quickly. To add further insult, the four burners were so closely spaced that four pots or pans couldn't even fit on them at the same time.

We are delighted to offer, as a standard feature, a new high-output gas range from Magic Chef that answers your needs. This newly improved design has two rear burners with a 5,200 BTU output, and the front burner has a powerful output of 7,100 BTU's. In layman's terms the new high-output burner will heat four cups of water 28.6% faster than before.

From now on, boiling water for spaghetti will be a pleasure.

Catalina Class A Motorhomes

Items	Model	290 QB	320 MB	350 SI	300 MB
Interior & Decor					
Raised Panel Doors		■	■	■	■
Deluxe Velvet Decor		■	■	■	■
Side Dinette		■	■	■	■
Jack Knife Sofa		■	■	■	■
Reclining, Swivel Pilot Seats		■	■	■	■
Lounge Chair		■	■	■	■
Roller Shades—Bedroom		■	■	■	■
Mini Blinds—Coach		■	■	■	■
Partial Carpet with Pad		■	■	■	■
Color TV—Coach		■	■	■	■
AM/FM Cassette Stereo		■	■	■	■
TV Antenna with Rotor		■	■	■	■
Cable TV and Phone Jack		■	■	■	■
Second TV Jack—Bedroom		■	■	■	■
TV Shelf—Bedroom		■	■	■	■
Fire Extinguisher		■	■	■	■
Smoke Detector		■	■	■	■
LP Leak Alarm		■	■	■	■
Carbon Monoxide Detector		■	■	■	■
Galley					
Microwave Ready		■	■	■	■
3 Burner High Output Range with Oven		■	■	■	■
Double Door Refrigerator		■	■	■	■
Power Range Hood with Light		■	■	■	■
Monitor Panel		■	■	■	■
Double Stainless Steel Sink		■	■	■	■
Silverware Drawer Below Sink		■	■	■	■
Cutting Board Sink Cover		■	■	■	■
Linoleum Flooring		■	■	■	■
Sleeping					
Queen Bed		■	■	■	■
Innerspring Mattress		■	■	■	■
Bedsread and Pillow Shams		■	■	■	■
Privacy Drape—Cab		■	■	■	■
Electrical/Heating/AC					
30' Power Cord		■	■	■	■
110/12V Power Converter		■	■	■	■
Emergency Start Switch		■	■	■	■
Generator Prep with Mount Kit		■	■	■	■
Battery Disconnect		■	■	■	■
Auxiliary Battery		■	■	■	■
Outside Receptacle		■	■	■	■
Defroster Fan		■	■	■	■
Prewired for Roof AC		■	■	■	■
Floor Ducted Heat		■	■	■	■
Radius Slider Windows		■	■	■	■
Power Entrance Step		■	■	■	■
Patio Light		■	■	■	■
Bath and Water					
Double Pedal Toilet		■	■	■	■
One Piece ABS Tub Surround		■	■	■	■
Medicine Cabinet		■	■	■	■
Power Bath Vent		■	■	■	■
Folding Shower Door		■	■	■	■
Six Gallon EI Water Heater		■	■	■	■
Demand Water Pump		■	■	■	■
Automotive/Exterior					
Rubber Roof		■	■	■	■
Basement Floor Design		■	■	■	■
Tilt Wheel		■	■	■	■
Cruise Control		■	■	■	■
Intermittent Wipes		■	■	■	■
Rear Mud Flaps		■	■	■	■
Towing Hitch		■	■	■	■
Dash Air Conditioning		■	■	■	■
Wheel Covers		■	■	■	■
Luggage Rack and Ladder		■	■	■	■
Remote Power Mirrors		■	■	■	■

Options

- Full Carpet with Pad
- Microwave
- VCP Video Player
- Three Speed Fan
- Roof AC
- Washer/Dryer Combo (Some Models) with 10 Gallon EI Water Heater
- Plumbing for Washer and Dryer
- 4.0 or 6.5 KW Generator
- Wheel Inserts
- Awning
- Driver's Door with Electric Window
- Spare Tire Carrier
- Twin Beds (Some Models)

Consult your Coachmen dealer for details on available options. Some options are included in options packages. Not all options are available on all models.

All illustrations and specifications contained herein are based upon the most recent product information at the time of publication. Because Coachmen Industries, Inc., its divisions and various other suppliers reserve the right during the product model year to make changes in the component parts (including but not limited to prices, colors, materials, equipment and specifications) and reserve the right to discontinue models of recreational vehicles at any time without notice, you should confirm the existence of any illustration and/or specification contained herein that is material to your decision to purchase any recreational vehicle described herein. Coachmen assumes no responsibility for any error in type or print reproduction of specifications contained herein. You should check with your Coachmen dealer if you have specific unanswered questions.

■=Standard



Floor Ducted Heating

You'll appreciate the difference in our floor-ducted heating system. Just like fine homes, our duct work is durable aluminum, which gives you better air flow. This sturdy ducting is also nearly puncture proof, which can be very important since ducting is often hard to access for repairs. We locate our furnaces nearest the center of the coach, so maximum air flow can reach all areas of the vehicle. And, for your living convenience, every effort is made to locate the heat ducts out of high traffic areas.

Coachmen's commitment to giving the most for your money does not stop with your purchase . . . it goes on and on.

You Can Count On Us!

Warranty protection is something you can count on with Coachmen. In fact, nobody protects you better.

Since the early days of our history, thirty years ago, we've believed in our products and our customers. That's why we were one of the first companies to offer a warranty. Our famous Buckstopper Warranty policy insures you that we stand behind all of our products with pride. The only way we could make it any better would be to extend it!

We are pleased to provide you with a two-year Extended Limited Structural Warranty, for peace of mind regarding the floor, ceiling assembly and laminated structural compo-



nents. Please ask your Coachmen dealer for complete details on our generous warranty programs.

The Coachmen Owner's Registration Card is your passport to worry-free travel. No matter where you visit throughout the United States and Canada, our network of independent dealers stand ready to provide you with courteous, dependable service.

Coachmen also gives you enhanced resale value, because the Buckstopper Warranty may be transferred to a subsequent owner for a small registration fee. (Sorry, the Extended Limited Structural Warranty may not be transferred.)

We work hard to see that our products perform to your satisfaction, but should something go wrong with our workmanship or materials during the warranty period, we will fix it.

When making your investment in a recreational vehicle, you should select a company you can count on, with a warranty you can depend upon. We invite you to compare ours to the competition.

Friends and Fellowship

One of the nicest joys of RV ownership is to share good times with good people. To enhance your ownership experience, we offer you a free, one-year membership in the International Coachmen Caravan Club, with the purchase of any new Coachmen brand recreational vehicle.

In addition to an automatic expansion of your circle of friends, your Caravan membership brings you lots of other benefits, like: ■ A 10% discount at over 2,500 participating campgrounds in the United States and Canada ■ Free \$5,000 Accidental Death & Dismemberment Insurance Policy ■ Free trip planning services ■ Free Lost Key Return Service, and ■ Free Campground Directory and membership magazines.

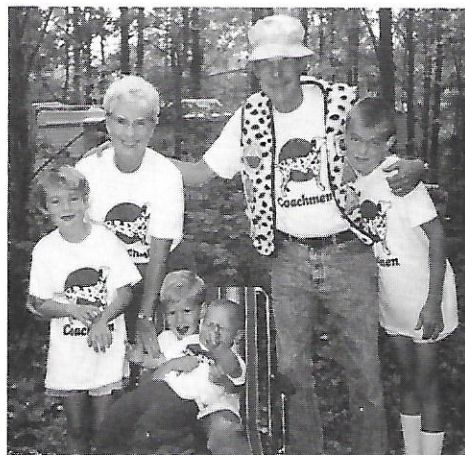

Other benefits that are yours at an optional low cost include: ■ Frequent special interest trips and tours ■ Rallies ■ Emergency Road Service Program ■ Long-term Health Care Insurance policy, and ■ Eligibility for our own Coachmen Caravan Master Card.

The list of benefits from your free membership in the Coachmen Caravan is very long. But, the most important benefit is the enjoyment you find in shared memories with friends and family. This benefit is uniquely yours from Coachmen.



RVIA Seal of Approval

All Coachmen recreational vehicles bear the Recreational Vehicle Industry Association Seal which certifies compliance with national health and safety rules.



Catalina bedrooms are as functional as they are beautiful and comfortable.



Choose From These Beautifully Coordinated Decor Fabrics

Coachmen uses only high-grade, stain-repellent fabrics for all seating. Our fabrics pass the highest quality standards set for fine home furnishings, and must satisfy Automated Durability Testing to meet our requirements.



Honeynut



Caspian Blue



Aspen



Thirty Years of Commitment to Excellence

Coachmen Quality— “World Class”

Your Coachmen Dealer is:

Thirty years ago, three brothers had a vision of the business opportunities in the emerging recreational vehicle industry. Combining their experience in finance, marketing and manufacturing, Claude, Keith and Tom Corson founded what is now known as Coachmen Recreational Vehicle Company.

The Corsons' confidence in the RV industry was well-founded. From first-year production that included 12 travel trailers, one pick-up truck camper and 80 truck caps, the company has become a diversified, full-line manufacturer of recreational vehicles. The Company's RV product lines include Class A motorhomes, mini-motorhomes, travel trailers, fifth wheels, truck campers and camping trailers.

Over the years, Coachmen RV Company has far surpassed the vision of its founders. The company has become a recognized leader in the design, manufacture and marketing of recreational vehicles.

The tremendous success of Coachmen Recreational Vehicle

According to Ford Motor Company, an international leader in overall quality management, Coachmen Recreational Vehicle Company is a **“Customer Driven Company . . . Fully Active in World Class Quality Process Methodology.”**

That assessment was made recently after Ford quality experts thoroughly inspected virtually all aspects of Coachmen's management and manufacturing processes. Coachmen is the **First and Only** manufacturer to be so recognized at this time.

Ford said Coachmen's quality program is so effective due to: ■ Outstand-

Company helped to form Coachmen Industries, Inc., a publicly held corporation with stock listed on the New York Stock Exchange under the COA symbol. Coachmen Industries, Inc., aside from its core business of recreational vehicles, has thriving interests in the modular housing, specialty vehicles and contract office furniture industries.

Coachmen RV owes a great deal of its long time success to its quality dealer network and its support of products and programs in the marketplace worldwide. Coachmen has always been known for its commitment to outstanding customer service at both the wholesale and retail level.

The products of Coachmen Recreational Vehicle Company are designed and manufactured in over 565,000 square feet of facilities located in Middlebury, Indiana and Fitzgerald, Georgia. Dealers are located throughout the United States and Canada, as well as parts of Europe.

ing Management Commitment to Quality ■ Excellent Quality Control Applications ■ Proven Customer Service Support ■ Dedicated Response to Quality Concerns ■ Thorough and Sound Engineering Practices ■ Comprehensive and Exemplary Process Controls ■ Great Overall Employee Involvement ■ Complete Vehicle Inspection and Sign-Off.

It's all part of the most comprehensive quality and customer satisfaction program in the recreational vehicle industry today. Protect your investment. Buy a Coachmen!



Recreational Vehicle Company
P.O. Box 30, Middlebury, IN 46540

