

Maxxum

BY COACHMEN



Wide Body Design Means Enhanced Livability

Step inside one of Coachmen's new Maxxum travel trailers or fifth wheels and you'll immediately experience the difference. There's extra living space galore!

The Maxxums are designed with both wider bodies and higher ceilings bringing new dimensions to recreational vehicle livability and utility. Their innovative wide floorplans result in significantly more usable interior space. That translates into a lot more comfort and convenience for you. Best of all, Maxxum is affordably priced, so you get much more RV for the money.

Maxxum is also equipped for value with a long list of standard features including: TV antenna and rotor, cable TV jack, deluxe velvet decor, roller shades, six gallon electronic ignition water heater and monitor panel.

For a wider range of value, there is no better choice than Maxxum by Coachmen.

Coachmen Adds Value

When selecting a travel trailer or fifth wheel, you are making a sizable investment. Coachmen works for your investment, and is by far the best value you will find.

We design our products for your long-term satisfaction and enjoyment. Many other brands cut corners in areas that are hidden from you . . . until after the purchase.

Coachmen doesn't cut corners. We add performance and safety features that aren't always easy to see, but are very easy to appreciate down the road.

We care about your total cost of ownership, and so should you. Cost of ownership may include the initial purchase price, but it's also a lot more: it's quality, product performance, safety, ease of maintenance, resale value, a company and warranty you can rely on, and even camping fellowship.

Coachmen pays careful attention to all of these factors. Here are just some of the ways Coachmen gives you the most for your money, both today and tomorrow.



Maxxum's spacious interiors provide for the ultimate in both comfort and utility.



For your sleeping comfort, all Maxxum beds feature custom made deluxe inner-spring mattresses.



Maxxum's laminated walls utilize aluminum structural ribbing to provide durability and strength with the benefits of lighter weight.

Solid Laminated Construction

Unlike other brands in the economy class, Maxxum travel trailers and fifth wheels provide unbeatable value by combining an affordable price with exciting new wide-body floorplans and solid laminated construction.

Every Maxxum features fully-laminated aluminum framed sidewall construction to combine the benefits of lighter weight with great strength and durability. Covered with an attractive mesa fiberglass skin, the two-inch thick sidewalls are insulated with polystyrene, which is one of the densest insulations available.

(Continued on page 7.)

Maxxum Travel Trailers and Fifth Wheels Floor Plans and Technical Specifications

When it comes to space utilization, Coachmen has no equal. That's because designing for livability is one of our first and foremost concerns. Whether studying our floorplans or comparing our specifications to the competition, you'll find that you get more for your money when you choose Coachmen.

298FK FRONT KITCHEN TRAVEL TRAILER

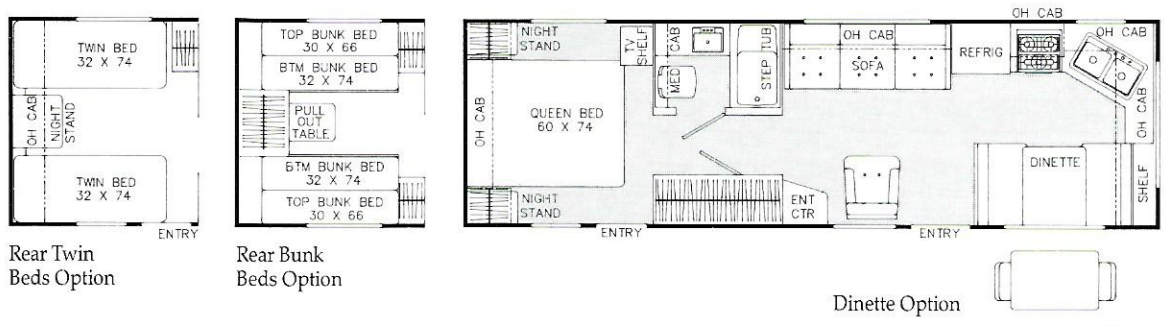

310TB TWO BEDROOM TRAVEL TRAILER

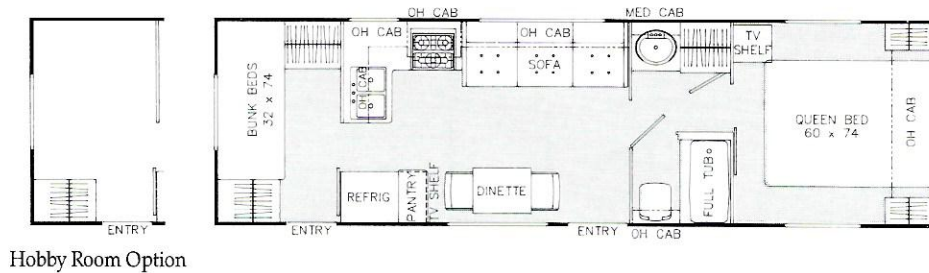

287RL REAR LOUNGE FIFTH WHEEL

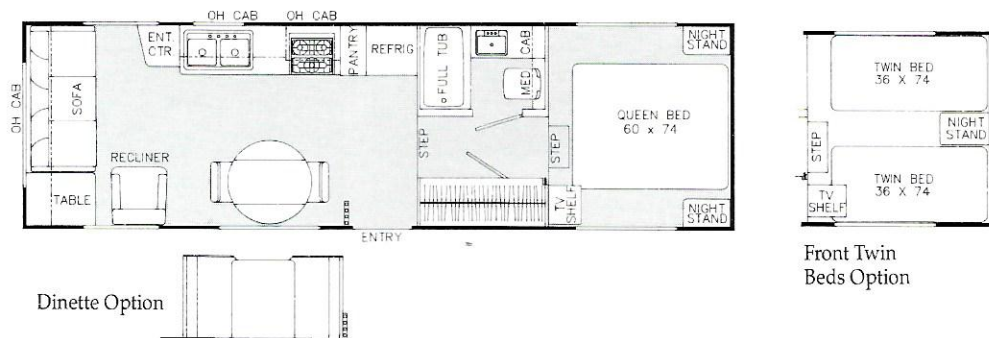

320RK REAR KITCHEN FIFTH WHEEL

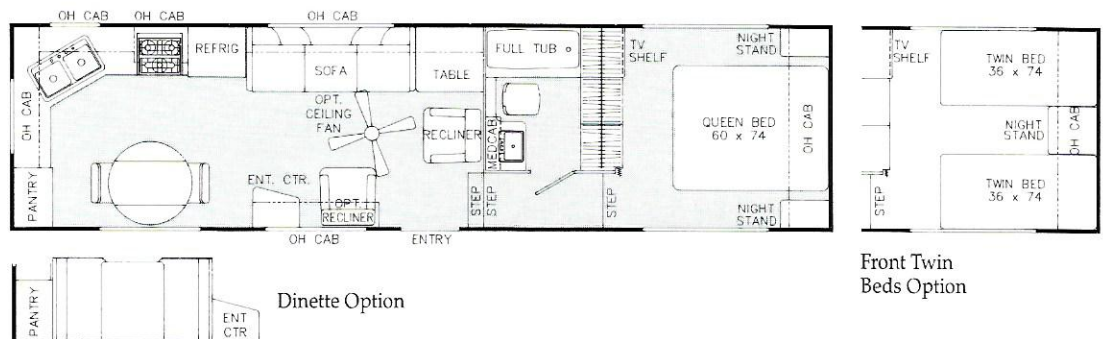

Maxxum Travel Trailers and Fifth Wheels

	Travel Trailers		Fifth Wheels	
	298 FK	310 TB	287 RL	320 RK
GVWR	7,600	7,600	N/A	11,750
Base weight	5,870	6,145	N/A	7,530
Axle weight	4,940	5,265	N/A	5,780
Hitch weight	930	880	N/A	1,750
Carrying capacity	1,730	1,455	N/A	4,210
Interior height	84"	84"	84"	84"
Exterior height	114"	114"	N/A	139"
Exterior length	368"	383"	N/A	395"
Exterior width	100.5"	100.5"	100.5"	100.5"
Hitch pin height	17.5"	17.5"	—	—
Sleeping capacity std.	6	6	4	4
Fresh water tank capacity (gal.)	30	30	N/A	40
Waste water tank capacity (gal.)	40	40	N/A	40
Gray water tank capacity (gal.)	30	40	N/A	40
Water heater capacity (gal.)	6	6	6	6
L.P. gas capacity (lb.)	60	60	60	60
Furnace rating (x 1,000 BTU) std.	30	30	30	30
Tire size	ST225/75R15B	ST225/75R15B	ST225/75R15C	ST225/75R15D

*GVWR Gross Vehicle Weight Rating: Maximum loaded weight of a vehicle as established by the manufacturer. (NHTSA)

NOTES: All specifications are approximate. N/A=Not available at time of printing.

High Output Range

For years, the traditional four-burner range has been an aggravation, because the burners were too low powered to heat anything quickly. To add further insult, the four burners were so closely spaced that four pots or pans couldn't even fit on them at the same time.

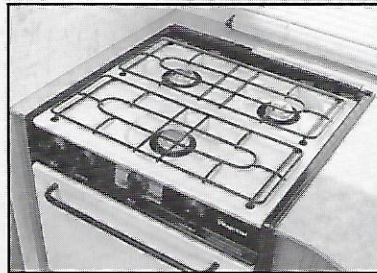

We are delighted to offer, as a standard feature, a new high-output gas range from Magic Chef that answers your needs. This newly improved design has two rear burners with a 5,200 BTU output, and the front burner has a powerful output of 7,100 BTU's. In layman's terms, the new high-output burner will heat four cups of water 28.6% faster than before.

From now on, boiling water for spaghetti will be a pleasure!

Floor Ducted Heating

You'll appreciate the difference in our floor-ducted heating system. Just like fine homes, our duct work is durable aluminum, which gives you better air flow. This sturdy ducting is also nearly puncture proof, which can be very important since ducting is often hard to access for repairs. We locate our furnaces nearest the center of the coach, so maximum air flow can reach all areas of the vehicle. And, for your living convenience, every effort is made to locate the heat ducts out of high traffic areas.

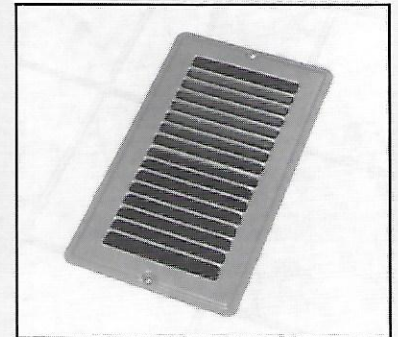

Maxxum Travel Trailers and Fifth Wheels

Items	Model	Travel Trailers		Fifth Wheels	
		298 FK	310TB	287 RK	320 RK
Interior & Decor					
Hard Valances		•	•	•	•
Wooden Drawers with Travel Lock		•	•	•	•
LP Leak Alarm		•	•	•	•
Picture Frame Raised Panel Cabinet Doors		•	•	•	•
Cutting Board Sink Cover		•	•	•	•
Partial Carpet with Padding		•	•	•	•
Swivel Rocker		•			
Recliner				•	•
Silverware Drawer		•	•	•	•
Galley					
High Output 3-Burner Almond Range with Oven		•	•	•	•
Lighted Range Hood		•	•	•	•
Large Stainless Steel Kitchen Sink		•	•	•	•
Single Lever Kitchen Faucet		•	•	•	•
Smoke Detector		•	•	•	•
Microwave Ready		•	•	•	•
Flush Mounted Double Door Refrigerator		•	•	•	•
Electrical					
110/12V Power Center 45 Amp. w/Charger		•	•	•	•
Patio Light		•	•	•	•
Hitch Light		•	•	•	•
Utility Light, ODS		•	•	•	•
30 Ft. 30 Amp Power Cord in Locking Compartment		•	•	•	•
Ground Fault Interrupter Circuit		•	•	•	•
Bath & Water System					
Single Pedal Toilet		•	•	•	•
One Piece Tub Surround		•	•	•	•
Electronic Ignition Water Heater		•	•	•	•
Wall Switch in Bathroom		•	•	•	•
Decorative Bath Hardware		•	•	•	•
Sleeping					
Front Queen Bed			•	•	•
Rear Queen Bed		•			
Side Jack-Knife Sofa		•	•		•
Rear Jack-Knife Sofa				•	
Bed Lift System		•	•	•	•
Bedsread(s)		•	•	•	•
Pillow Shams		•	•	•	•
Headboard(s)		•	•	•	•
Deluxe Innerspring Mattress		•	•	•	•
Fold Down Dinette		•			
Free Standing Wood Dinette			•	•	•

Value Added Maxxum Standard Features

Aluminum Frame Sidewalls
Laminated 2" Sidewalls
Floor Ducted Heating
Radius Windows
Power Vent in Bath
Dead Bolt Locks
Wire and 4 Speakers
Monitor Panel
TV Antenna and Rotor Package
TV Shelf in Bedroom
Outside Receptacle
12 Volt Demand Pump
Pull Shades in Bedroom
Water Heater Bypass
One Piece Seamless Rubber Roof

Options¹

□ Microwave oven □ Residential style AM/FM stereo w/cassette □ Ducted air conditioning □ Day/night shades coach □ Outside shower □ Awning □ Large double door refrigerator □ Luggage rack and ladder □ Spare tire kit □ Retractable stabilizer jacks.

¹Consult your Coachmen dealer for details on available options. Some options are included in options packages. Not all options are available on all models.

Please Note: The Maxxum is an exciting product that features a wider body design of 100". This small added width gives you significantly enhanced interior living space and innovative floorplans to choose from.

In making your purchase decision, you should be aware that several states restrict access on some or all state roads to 96" in body width. However, special road useage permits may be available in these states.

At the time of this printing, 70% or 35 states allow 102" body width on all highways. Another 22%, or 11 states allow 102" body width on major highways and state roads.

Before making your purchase decision, you may wish to confirm the road useage laws in the states of interest to you.

If width is of concern to you, we invite you to consider the broad array of other Coachmen products offered in the standard 96" width.

The Coachmen recreational vehicles described in this brochure incorporate components produced by Coachmen Industries, its divisions, and various other suppliers. During the product year, it may become necessary to produce Coachmen products with different components than initially scheduled. All such changes are approved for use by Coachmen in order to maintain the quality standards associated with the Coachmen name. All illustrations and specifications contained in this catalog are based on the latest product information at time of publication. Coachmen reserves the right to make changes in prices, colors, materials, equipment, and specifications and to discontinue models at any time without notice. Coachmen assumes no responsibility for any error in type or print reproduction of specifications in this brochure. Check with your Coachmen dealer for more information if you have specific questions.

Coachmen's commitment to giving the most for your money does not stop with your purchase . . . it goes on and on.



Friends and Fellowship

One of the nicest joys of RV ownership is to share good times with good people. To enhance your ownership experience, we offer you a free, one-year membership in the International Coachmen Caravan Club, with the purchase of any new Coachmen brand recreational vehicle.

In addition to an automatic expansion of your circle of friends, your Caravan membership brings you lots of other benefits, like: ■ A 10% discount at over 2,500 participating campgrounds in the United States and Canada



- Free \$5,000 Accidental Death & Dismemberment Insurance Policy
- Free trip planning services
- Free Lost Key Return Service, and
- Free Campground Directory and membership magazines.

Other benefits that are yours at an optional low cost include: ■ Frequent special interest trips and tours ■ Rallies ■ Emergency Road Service Program ■ Long-term Health Care Insurance policy, and ■ Eligibility for our own Coachmen Caravan Master Card.

The list of benefits from your free membership in the Coachmen Caravan is very long. But, the most important benefit is the enjoyment you find in shared memories with friends and family. This benefit is uniquely yours from Coachmen.



RVIA Seal of Approval

All Coachmen recreational vehicles bear the Recreational Vehicle Industry Association Seal which certifies compliance with national health and safety rules.

You Can Count On Us!



With Coachmen, you get a company and warranty you can count on. Since the early days of our history, over twenty-eight years ago, we've believed in our products and our customers. That's why we were one of the first companies to offer a warranty. Our famous **Buckstopper Warranty** policy insures you that we stand behind all of our products with pride.

New for 1993 models, we are very pleased to provide you with an **Extended Limited Structural Warranty**, for peace of mind regarding the floor, ceiling assembly and laminated structural components. Please ask your Coachmen dealer for complete details on our generous warranty programs.

The Coachmen **Owner's Registration Card** is your passport to worry-free travel. No matter where you visit throughout the United States and Canada, our network of independent dealers stand ready to provide you with courteous, dependable service.

Coachmen also gives you enhanced resale value, because the **Buckstopper Warranty** may be **transferred** to a **subsequent owner** for a small registration fee. (Sorry, the Extended Limited Structural Warranty may not be transferred.)

As you've read throughout this brochure, we work very hard to see that our products perform to your satisfaction. But should something go wrong with our workmanship or materials during the warranty period, we will fix it.

When making your investment in a recreational vehicle, you should select a company you can count on, with a warranty you can depend upon. We invite you to compare ours to the competition.

We are confident that Nobody does it better!!

Coachmen. Value for the long haul.

Beautiful Livability

Maxxum's wide-body design provides the comfort and convenience of additional living space. And, the Maxxum interior appointments are beautifully designed for extra durability so you can truly enjoy your added space.

The interior decor schemes of many new travel trailers and fifth wheels may look attractive, but major differences do exist between RV interior furnishings. This is a deceiving area where you truly get what you pay for.

Coachmen uses only high-grade, stain-repellent upholstery fabrics for all seating. Our fabrics must pass the quality standards set for fine home furnishings, and satisfy Automated Durability Testing to satisfy our requirements.

Our velvets are woven on jacquard looms, so the color and pattern are integrated into the fabric. Other brands use a mock "velvet" which really are filaments glued to a backing, then printed to achieve color and/or pattern. This flocking technique, much like flocked wallpaper, tends to rub off on your hands and clothing in a short period of time.

Your privacy is another important aspect in regards to overall livability. The window treatments in your RV need to be as functional as they are beautiful. Coachmen uses full-privacy roller shades (or optional coach day/night shades) in Maxxum products. Many manufacturers may use shades that initially appear to be attractive, but are nearly



transparent and fail to provide the privacy you require.

Seating comfort and durability largely depend on the seating construction itself. We specify a heavy foam density, to assure that your furniture and cushions don't rapidly compress or disintegrate. Other competitive brands often cut costs in this hidden area. Be wary of cushions that are too thin or too soft at the outset.

The carpet in all Coachmen products is durable, continuous filament nylon that greatly reduces fraying. It is also Scotchguard™ treated for stain protection, and has an anti-static backing. We enhance the durability of our quality carpets by using dense carpet padding. You'll learn that other brands use either a cheap padding, or perhaps none at all.

Innerspring mattresses are also not all alike. The durability and long-term comfort of your mattress is determined by the number of coils, or springs, inside the mattress. The more coils in your mattress, the more your body weight will be supported for a good night's rest.

Other brands today offer queen-size innerspring mattresses that have about 180 coils. Our queen innerspring, custom-made to our specifications, has 312 coils, which are string-tied for durability and wrapped with high density foam for maximum comfort. Our mattresses are also thicker. Other brands measure about 5" deep, while ours is about 7½" deep. The extra thickness means you won't "bottom out." (All sizes of our innerspring mattresses have these same design characteristics.)

Cabinetry is another area where sometimes a difference in quality may not be readily apparent. Coachmen uses solid oak framed cabinet doors for natural beauty and long-lasting durability. All of our drawers are constructed with sturdy natural wood sides. Competitive brands may use cheap substitutes that you'll pay for down the road.

Product Performance

You want your recreational vehicle to perform with reliability. Coachmen takes pains to see that our products do just that.

(Continued on back page)

Choose From These Beautifully Coordinated Decor Fabrics



Beechnut



Blueberry



Seafoam

Get the most for your money. Choose Coachmen.

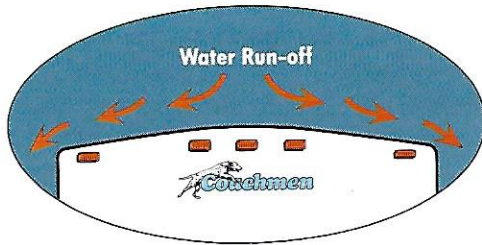

As this illustration shows, our crowned roof provides critical structural integrity and water drainage, so important for strength and leak protection. While flat roofs may save some money initially, the initial savings can be rapidly consumed by much higher repairs and maintenance costs due to sagging roofs and water problems.

One thing you expect is a good roof over your head. Every Maxxum unit has a heavy-duty seamless rubber roof, bonded to a sturdy sub-straat and secured to insulated, extra-wide crowned rafters. Years of application in industrial construction has proven rubber to be much more effective in leak prevention than metal roofing materials. In addition, it provides extra insulation and a sound barrier, plus it is much easier to maintain. Coachmen's crowned rafter system provides important water drainage . . . though more expensive to construct, it can save you many headaches in the future.

A good foundation is equally important, and we are proud of ours. Our nearly 30 years of experience has convinced us that a tubular steel frame is far stronger than the often-used, less expensive C-channel configuration. And to prevent sagging problems, we design in a generous number of cross members and out-riggers. These design characteristics are not obvious to the casual observer, but are certainly worth your investigation.

Appliances are also important to product performance. Coachmen uses only name brand appliances, which means both reliability and availability of warranty and replacement parts. And, we take extra steps to ensure that the appliance performs satisfactorily. For example, we line all of our refrigerator compartments with fiberglass insulation. Though it takes extra effort, we have found that this technique improves your cooling effectiveness, particularly in warmer temperatures.

Designed For Durability

Durability means fewer problems, less maintenance and a better trade-in value. Coachmen takes extra care in this area.

For example, we install a full length gutter rail on both sides of every travel trailer and fifth wheel. This helps provide extra stain and water leak protection.

Coachmen further protects against water damage by minimizing the use of

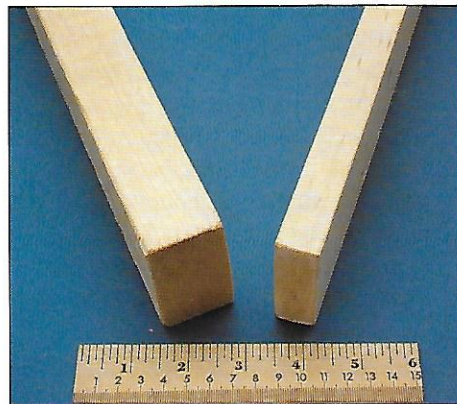

In many cases Coachmen crowned roof rafters are twice as thick as the competition.

Copper Tubing for Durability and Safety



Coachmen uses only heavy-duty copper tubing for our L.P. gas lines. The copper protects against dangerous corrosion and resulting leaks. (Many other brands use inexpensive black pipe.) For a tight seal, the copper tubing has a double flare at each joint. We also run our L.P. lines through the frame or sub-flooring to protect against road damage.

exterior screws, which create holes and leak potential. We incorporate a rain gutter directly into our entrance door frame, and our fender skirts are designed to be secured with a minimum of fasteners. As part of your purchase decision, be sure to count the number of exterior screws (and screw holes).

And speaking of screws, all exterior screws used by Coachmen are the more expensive galvanized-coated to protect against rust streaks. Also our frames and L.P. bottles are coated with rust-inhibiting paints.

These are just a few of the reasons why Coachmen gives you the most for your money. In addition to these design elements, please be sure to read about our Coachmen Caravan Club and Buck-Stopper Warranty.

We and your dealer welcome the opportunity to tell you more about the wonderful value of Maxxum travel trailers and fifth wheels by Coachmen Recreational Vehicle Company.



Recreational Vehicle Co.
P.O. Box 30, Middlebury, IN 46540

