

Ranger & Sport Truck Campers



(Ranger Interior Shown on Cover)

Ranger Truck Camper

The Ranger truck camper by Coachmen provides a combination of value and livability that simply can't be beat. With a choice of five roomy floorplans, Ranger fits the needs of a wide variety of outdoor enthusiasts.

Ranger's quality begins with fully laminated construction, including walls, floor and ceilings for added strength and insulation. Basement enclosed tanks provide additional storage and comfortable year-round camping.

Enjoy outstanding livability with features such as a large single door refrigerator, three-burner high output range with power hood, dual 20lb LP bottles with automatic changeover, monitor panel, solid oak framed cabinet doors with raised panel inserts, 16,000 BTU electronic ignition furnace and a deluxe velvet decor.

Get the most from your camping experience. Choose the quality and value of Ranger by Coachmen.



It's easy to relax in Sport's comfortable and well equipped interior.



Sport Truck Camper

When you need a Truck camper that's short on price and long on features, Coachmen's Sport is the answer. The Sport has the quality, convenience and equipment you need when you enjoy the great outdoors.

Boasting such features as an aluminum roof, large single door refrigerator, three burner high output range with power hood, 12,000 BTU electronic ignition furnace, bathroom and shower, and a 25 amp. power center, the Sport is equipped for a satisfying stay at your favorite camp. Sport offers three versatile floorplans from which to choose.

The Sport Truck Camper by Coachmen. Ultimate value at an economical price.

Choose From These Beautifully Coordinated Decor Fabrics

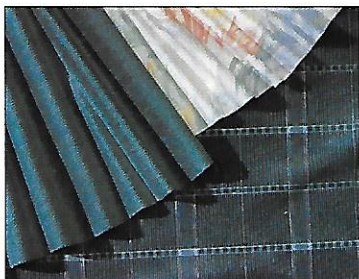

Spruce (Ranger Only)



Sable (Ranger & Sport)



Cinnamon (Sport Only)



Heather (Sport Only)

Ranger and Sport Truck Camper Floor Plans and Technical Specifications

When it comes to space utilization, Coachmen has no equal. That's because designing for livability is one of our first and foremost concerns. Whether studying our floorplans or comparing our specifications to the competition, you'll find that you get more for your money when you choose Coachmen.

Ranger

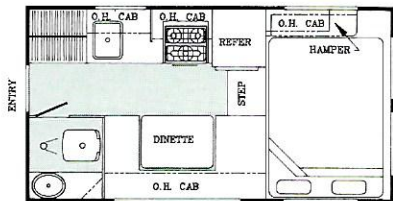

095 Side Dinette

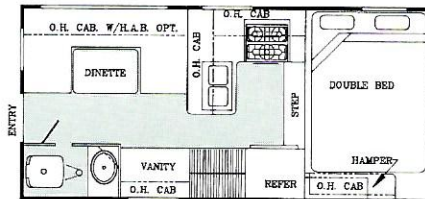

115 Side Dinette Options A or B

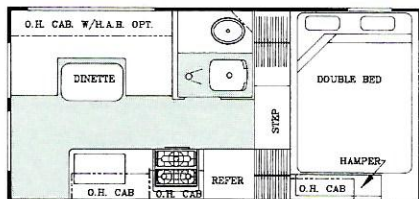

115 Side Entry Options A or B

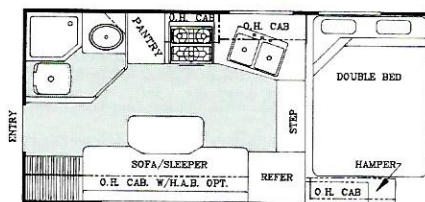

115 Side Lounge Options A or B

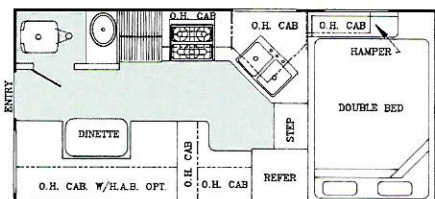

115 Rear Dinette Options A or B

Ranger Options

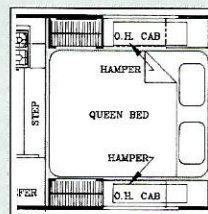

OPTION A
Front Queen
Bunk Extended
Cab Option

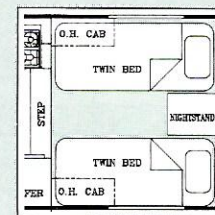

OPTION B
Front Twin
Beds Extended
Cab Option

Sport

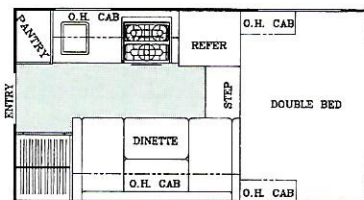

080 Side Dinette

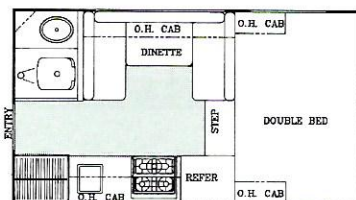

085 Side Dinette

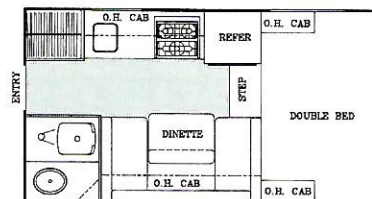

095 Side Dinette

Ranger & Sport Truck Campers

	Sport			Ranger				
	080 SD	085 SD	095 SD	095 SD	115 SE	115 RD	115 SD	115 SL
Exterior length (incl. cabover) (inches)	163.5	171.00	178.5	178.5	198.5/219.25*	204.5/225.25*	198.5/219.25*	198.5/219.25*
Exterior box length (inches)	99.0	106.5	114.0	114.0	134.0	140.0	134.0	134.0
Interior height (inches)	79.0	79.0	79.0	76.0	76.0	76.0	76.0	76.0
Exterior height (inches)	92.0	92.0	92.0	95.5	95.5	95.5	95.5	95.5
Interior width (inches)	82.5	90.75	90.75	90.25	90.25	90.25	90.25	90.25
Exterior width (inches)	84.25	92.5	92.5	92.5	92.5	92.5	92.5	92.5
Cabover headroom (inches)	32.75	32.75	32.75	37.0	37.0	37.0	37.0	37.0
Sleeping capacity	4	4	4	4	4/6	4/6	4/6	4/6
Fresh water tank capacity (gal.)	20	20	20	20	20	30	30	30
Grey water tank capacity (gal.)	—	—	—	18	16	16	18	14
Waste tank capacity (gal.)	—	10	10	10	16	11	16	16
Base weight (lbs.)	1528	1786	1846	2043	2250	N/A	2423	N/A
Federal weight (lbs.)	1708	1966	2026	2243	2450	N/A	2695	N/A
Distance for wheel well clearance (inches)	47.75	47.75	47.75	47.75	47.75	47.75	47.75	47.75
Distance for tailgate clearance (inches)	58.25	58.25	58.75	58.25	58.25	58.25	58.75	58.25
Distance from front to end of wheel well (inches)	75.75	75.75	75.75	75.75	75.75	75.75	75.75	75.75
Distance from back of wheel well to end of truck bed (inches)	27.0	27.0	27.0	27.0	27.0	27.0	27.0	27.0
Rear overhang (inches)	0	1.5	11.5	11.5	31.5	37.75	31.5	31.5
Distance from floor to cabover (inches)	46.25	46.25	46.25	46.25	46.25	46.25	46.25	46.25
Distance from front wall to center of gravity (inches)	38.3	45.5	48.4	48.7	52.8	N/A	56.4	N/A

*Standard and Extended Cab Lengths

Items	Model	Sport				Ranger				Items	Model	Sport				Ranger													
		080 SD	085 SD	095 SD	095 SD	115 SE	115 RD	115 SD	115 SL			080 SD	085 SD	095 SD	095 SD	115 SE	115 RD	115 SD	115 SL										
Interior & Decor										Electrical/Power System																			
Deluxe Velvet Decor					•	•	•	•	•	110/12V Power Center 25 Amp	•	•	•	•						110/12V Power Center 32 Amp	•	•	•	•					
Stain Resistant Fabrics		•	•	•	•	•	•	•	•	Single 20lb LP Gas - Bottle	•	•	•							Dble 20lb LP Gas - Btls, Auto Changeover				•	•	•	•		
Drawer Sides - Painted		•	•	•	•	•	•	•	•	G.F.I. Circuit	•	•	•	•	•	•	•	•	•	Outside G.F.I. Recept.	•	•	•	•	•	•	•	•	
Cabinet Door - Flat Panel		•	•	•						All Copper Double Flared LP Gas Lines	•	•	•	•	•	•	•	•	•										
Cabinet Door - Raised Picture Frame					•	•	•	•	•	Bath & Water System																			
Kitchen Blinds		•	•	•	•	•	•	•	•	Bath with Shower		•	•	•	•	•	•	•	•	Outside Shower			•	•	•	•	•	•	
Pedestal Table		•	•	•	•	•	•	•	•	Enclosed Heated Holding Tanks					•	•	•	•	•	Enclosed Heated Fresh Water Tanks	•	•	•	•	•	•	•	•	
Padded Door Overhead		•	•	•	•	•	•	•	•	6-Gallon Fast Recovery Water Heater		•	•	•	•	•	•	•	•	12 Volt Demand Pump		•	•	•	•	•	•	•	
Front Double Bed		•	•	•	•	•	•	•	•	Monitor Panel		•	•	•	•	•	•	•	•	Vinyl Board Tub Surround	•	•	•	•	•	•	•	•	
Side Gaucho										Decorative Bath Hardware		•	•	•	•	•	•	•	•										
Privacy Drape		•	•	•	•	•	•	•	•	Exterior and Construction																			
Appliances										3 Corner Jacks - Heavy Duty					•	•	•	•											
Three-Burner High-Output Range		•	•	•	•	•	•	•	•	3 Corner Jacks - 1 Heavy Duty, 2 Lite	•	•	•	•						Insulated Basement Floors				•	•	•	•		
Power/Lighted Range Hood		•	•	•	•	•	•	•	•	Full Length Entry Door with Dead Bolt	•	•	•	•	•	•	•	•	•	Single Slideout Step			•	•	•	•	•	•	
Flush Mount Refrigerator		•	•	•	•	•	•	•	•	Double Foldout Step										Seamless Rubber Roof			•	•	•	•	•	•	
Stainless Steel Kitchen Sink		•	•	•	•	•	•	•	•	Fully Laminated Construction													•	•	•	•	•		
Microwave Ready					•	•	•	•	•	Luggage Rack & Ladder	•	•	•	•	•	•	•	•	•				•	•	•	•	•		
Heating, Ventilating & Air Conditioning																													
12,000 BTU Electronic Ignition Furnace		•	•	•																									
16,000 BTU Electronic Ignition Furnace					•	•	•	•	•																				
Wire and Frame for Roof Air		•	•	•	•	•	•	•	•																				
Safety Glass Windows		•	•	•	•	•	•	•	•																				
Power Vent - Bath					•	•	•	•	•																				
Roof Vents		1	1	1	1	2	2	2	2																				
Super Exit Dome		•	•	•	•	•	•	•	•																				
Electrical/Power System																													
Porch Light		•	•	•	•	•	•	•	•																				

Options¹

- Four Hydraulic Corner Jacks □ Microwave Oven □ 3-Burner High Output Range with 16" Oven □ 7,000 BTU Roof Air Conditioner □ 20,000 BTU Electronic Ignition Furnace
- 6-Gallon Electronic Ignition Water Heater □ AM/FM Stereo Cassette with 2 Speakers □ TV Antenna and Rotor □ TV Ready Package.

¹Not all options are available on all models. Some optional equipment available on Ranger only. Consult your Coachmen dealer for details.

Clipper Truck Campers

	070 SD	080 SD
Body Length (inches)	126	140
Floor Length (inches)	86	96
Overhang (inches)	40	44
Cab Height (inches)	41	45
Up & Out (inches)	17	21
Width (inches)	78	88
Base Width (inches)	38	48
Closed Height (inches)	56	60
Open Height (inches)	80	80
Gross Weight (lbs)	905	1040
Sleeping Capacity	4	4
Water Tank Capacity (gal.)	12	12

- Options
- 16,000 BTU Forced Air Furnace with Electronic Ignition
 - 3-Tripod Jacks Air Conditioner Two-way Refrigerator
 - Porta Potti Screen Door.

The Coachmen recreational vehicles described in this brochure incorporate components produced by Coachmen Industries, its divisions, and various other suppliers. During the product year, it may become necessary to produce Coachmen products with different components than initially scheduled. All such changes are approved for use by Coachmen in order to maintain the quality standards associated with the Coachmen name. All illustrations and specifications contained in this catalog are based on the latest product information at time of publication. Coachmen reserves the right to make changes in prices, colors, materials, equipment, and specifications and to discontinue models at any time without notice. Coachmen assumes no responsibility for any error in type or print reproduction of specifications in this brochure. Check with your Coachmen dealer for more information if you have specific questions.

Items	Model 070 SD	080 SD
Interior & Decor		
Double Bed	•	•
Vinyl Floor Covering	•	•
4" Cushions and Mats	•	•
3-Way Windows	•	•
Safety Glass Windows	•	•
LP Leak Detector	•	•
Truck Cab Access Window	•	•
Window and Privacy Curtains	•	•
Appliances		
Three-Burner Range		•
Two-Burner Range	•	
35lb Ice Box	•	•
Electrical/Power System		
110/12V Power Center 6 Amp	•	•
12 V Lights	2	2
110 V Outlets	1	1
20 Amp recepts	1	1
G.F.I. Recept	1	1
20lb LP Bottle	•	•
Exterior & Construction		
One Piece Floor	•	•
.024 Smooth Exterior	•	•
Metal Up & Out	•	•
Laminated Roof	•	•
One-Piece Structurwood Bunk	•	•
Full Perimeter Entrance Door	•	•
Blue Vinyl Tent	•	•
Side Storage Compartment		•
Heco Lift System	•	•
Steel Frame	•	•

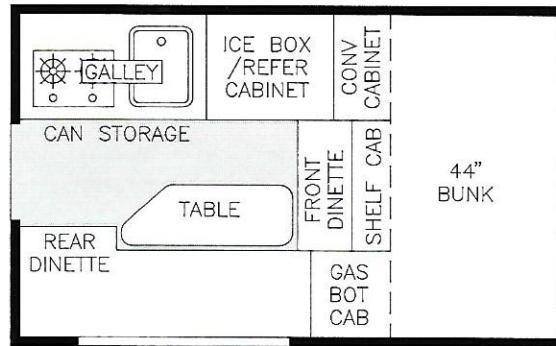

070 Side Dinette

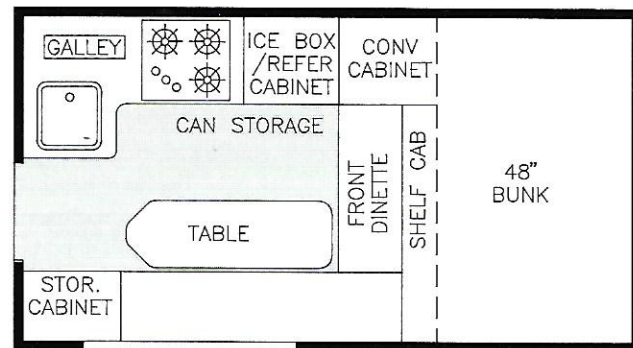

080 Side Dinette

Coachmen's commitment to giving the most for your money does not stop with your purchase . . . it goes on and on.



Friends and Fellowship

One of the nicest joys of RV ownership is to share good times with good people. To enhance your ownership experience, we offer you a free, one-year membership in the International Coachmen Caravan Club, with the purchase of any new Coachmen brand recreational vehicle.

In addition to an automatic expansion of your circle of friends, your Caravan membership brings you lots of other benefits, like: ■ A 10% discount at over 2,500 participating campgrounds in the United States and Canada

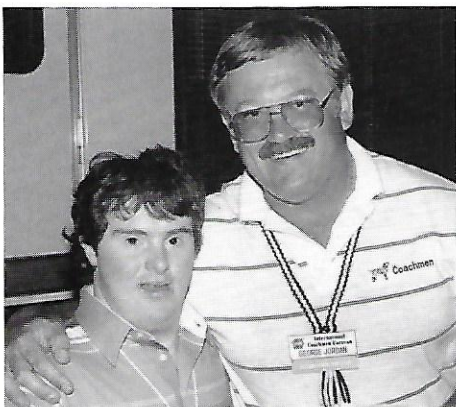

- Free \$5,000 Accidental Death & Dismemberment Insurance Policy
- Free trip planning services
- Free Lost Key Return Service, and
- Free Campground Directory and membership magazines.

Other benefits that are yours at an optional low cost include: ■ Frequent special interest trips and tours ■ Rallies ■ Emergency Road Service Program ■ Long-term Health Care Insurance policy, and ■ Eligibility for our own Coachmen Caravan Master Card.

The list of benefits from your free membership in the Coachmen Caravan is very long. But, the most important benefit is the enjoyment you find in shared memories with friends and family. This benefit is uniquely yours from Coachmen.



RVIA Seal of Approval

All Coachmen recreational vehicles bear the Recreational Vehicle Industry Association Seal which certifies compliance with national health and safety rules.

You Can Count On Us!

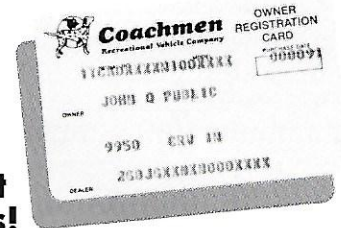

With Coachmen, you get a company and warranty you can count on. Since the early days of our history, over twenty-eight years ago, we've believed in our products and our customers. That's why we were one of the first companies to offer a warranty. Our famous **Buckstopper Warranty** policy insures you that we stand behind all of our products with pride.

New for 1993 models, we are very pleased to provide you with an **Extended Limited Structural Warranty**, for peace of mind regarding the floor, ceiling assembly and laminated structural components. Please ask your Coachmen dealer for complete details on our generous warranty programs.

The Coachmen **Owner's Registration Card** is your passport to worry-free travel. No matter where you visit throughout the United States and Canada, our network of independent dealers stand ready to provide you with courteous, dependable service.

Coachmen also gives you enhanced resale value, because the **Buckstopper Warranty** may be **transferred** to a **subsequent owner** for a small registration fee. (Sorry, the Extended Limited Structural Warranty may not be transferred.)

As you've read throughout this brochure, we work very hard to see that our products perform to your satisfaction. But should something go wrong with our workmanship or materials during the warranty period, we will fix it.

When making your investment in a recreational vehicle, you should select a company you can count on, with a warranty you can depend upon. We invite you to compare ours to the competition.

We are confident that Nobody does it better!!

Clipper Truck Campers



Clipper Truck Camper

Coachmen's all new Clipper Truck Campers. Ideal for outdoorsmen who prefer a smaller truck and a lighter weight camper.

The Clipper is available in seven and eight foot floor lengths, both designed to provide maximum comfort and convenience for up to four campers. Each model is equipped with standards including, two or three burner range, self-draining ice box, 6 amp power converter, laminated roof, 4" cushions and mats, full perimeter entrance door, and the reliable Heco Lift system.

Easy to own, use and haul, the Clipper is an outstanding example of Coachmen quality and value.



Once in camp, Clipper expands to provide plenty of comfort and convenience features.



Choose From These Beautifully Coordinated Decor Fabrics

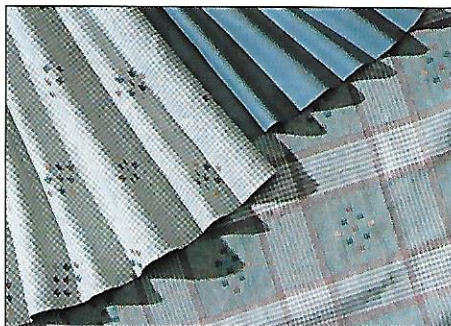

Greenmist



Forest

Get the most for your money. Choose Coachmen.

Coachmen Adds Value

When selecting a recreational vehicle, you are making an investment. Coachmen works for your investment, and is by far the best value you will find.

That's because we design our products for your long-term satisfaction and enjoyment. Other brands cut corners in areas that are hidden from you... until after the purchase.

Coachmen doesn't cut corners. We add performance and safety features that aren't always easy to see, but are very easy to appreciate down the road.

Coachmen cares about your total cost of ownership, and so do you. Cost of ownership includes the initial purchase price, plus a whole lot more. It's the value of quality, product performance, safety, ease of maintenance, resale value, a company and warranty you can count on, and even camping fellowship.

Coachmen pays careful attention to each of these factors. Here are just some of the ways Coachmen gives you the most for your money, today and tomorrow.

Beautiful Livability

Coachmen uses only high-grade, stain-repellent upholstery fabrics for all seating. Our fabrics must pass the quality standards set for fine home furnishings, and satisfy automated durability testing to satisfy our requirements.

Our velvets are woven on jacquard looms, so the color and pattern are integrated into the fabric. Other brands use a mock "velvet" which really are filaments glued to a backing, then printed to

achieve color and/or pattern. This flocking technique, much like flocked wallpaper, tends to rub off on your hands and clothing in a short period of time.

Seating comfort and durability also largely depends on the seating construction itself. Though much less expensive foam is available, we specify a heavy foam density, to assure that your furniture and cushions don't rapidly compress or disintegrate. Other competitive brands often cut costs in this hidden area.

Copper Tubing for Durability and Safety



Coachmen uses only heavy-duty copper tubing for our L.P. gas lines. The copper protects against dangerous corrosion and resulting leaks. (Many other brands use inexpensive black pipe.) For a tight seal, the copper tubing has a double flare at each joint. We also run our L.P. lines through the frame or sub-flooring to protect against road damage.

Product Performance

You want your recreational vehicle to perform with reliability. Coachmen takes pains to see that our products do just that.

The roofs of Ranger Truck Campers feature a heavy-duty seamless rubber outer skin. Years of application in industrial construction has proven rubber to be

much more effective in leak prevention than metal roofing materials. In addition, it provides extra insulation and a sound barrier, plus it is much easier to maintain.

Appliances are also important to product performance. Coachmen uses only name brand appliances, which means both reliability and availability of warranty and replacement parts in the future. And, we take extra steps to ensure that the appliance performs satisfactorily. For example, we line all of our refrigerator compartments with fiberglass insulation. As simple as this seems, we have found that this improves its cooling effectiveness, particularly in warmer temperatures.

Designed For Durability

Durability means fewer problems, less maintenance and a better trade-in value. Coachmen takes extra care in this area.

Coachmen protects against water leaks by minimizing the use of exterior screws, which create holes and leak potential. We incorporate a rain gutter into our entrance door frame; others attach a "drip cap" with numerous screws.

These are just some of the reasons why Coachmen gives you the most for your money.

In addition to these design elements, please see page 6 for a description of our Coachmen Caravan Club and Buck Stopper Warranty.

We and your dealer welcome the opportunity to tell you more about the wonderful value of products by Coachmen Recreational Vehicle Company.



Recreational Vehicle Co.
P.O. Box 30, Middlebury, IN 46540

