



# Coachmen®



1991  
TRAVEL TRAILER  
& FIFTH WHEEL  
FLOOR PLANS



# COACHMEN TRAVEL TRAILERS

# FLOOR PLANS

## 210MB

Mid-Bath  
(Catalina)

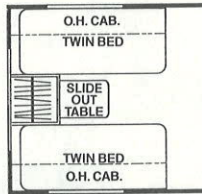

Rear Twin  
Beds Option

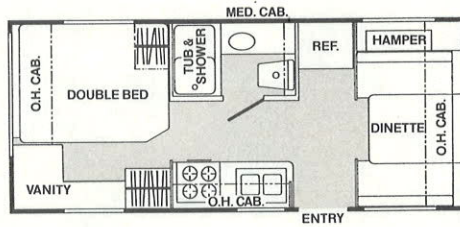

## 235MB

Mid-Bath  
(Catalina)

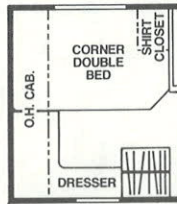

Rear Double  
Bed Option

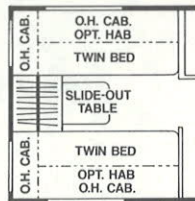
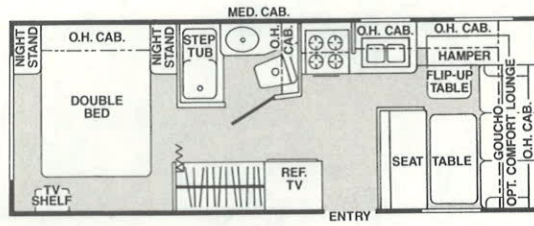

Rear Twin  
Beds Option

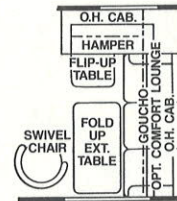

Front Lounge  
Option



# 250TB

**Two Bedroom**  
(Catalina)

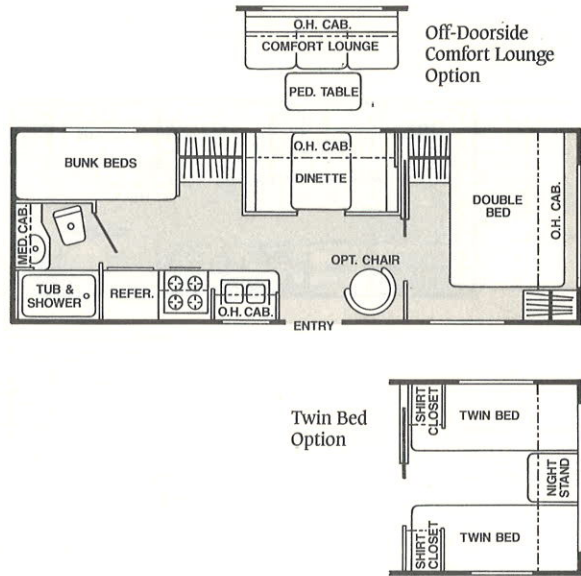

# 260FK

**Front Kitchen**  
(Catalina)

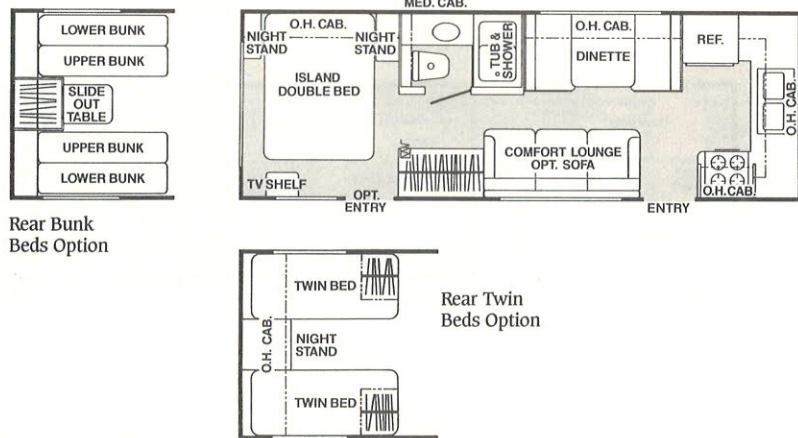

# 265RB

**Rear Bath**  
(Catalina)

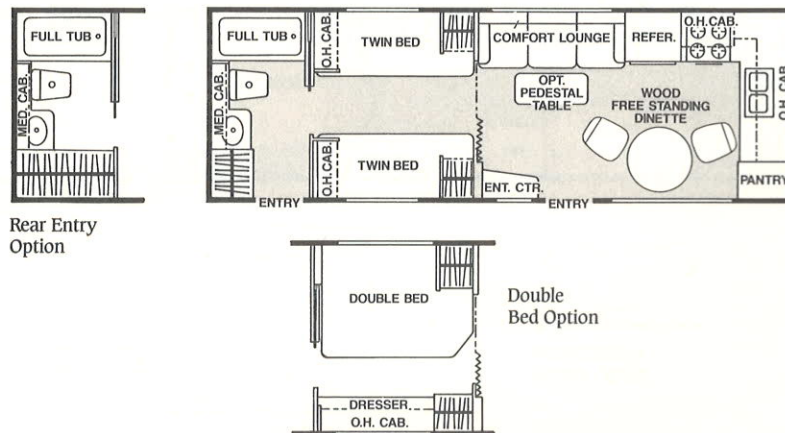

# COACHMEN TRAVEL TRAILERS

# FLOOR PLANS

**275RB**

**Rear Bath**  
(Catalina)

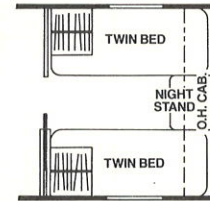
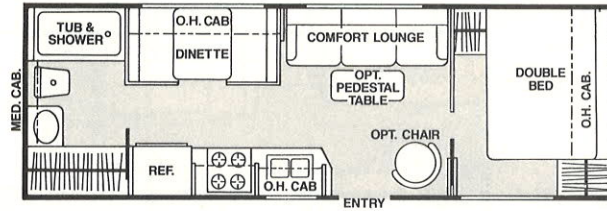

Front Twin  
Beds Option

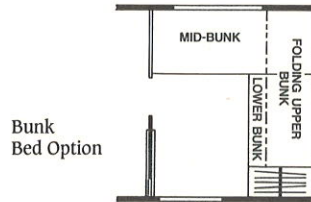

Bunk  
Bed Option

**290WB**

**Walk Thru Bath**  
(Catalina & Prestige)

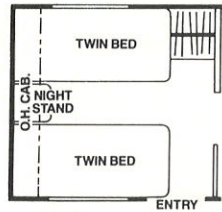

Rear Twin  
Beds Option

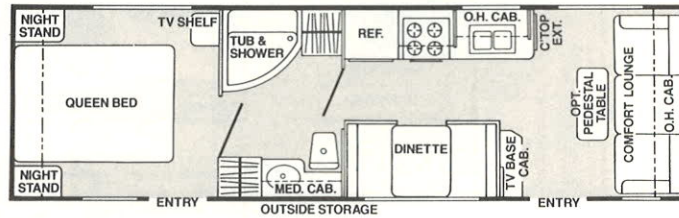

Free-standing  
Dinette Option



# 290FK

**Front Kitchen**  
(Catalina & Prestige)

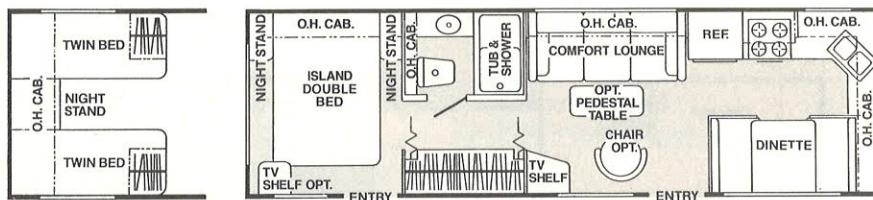

Rear Twin  
Beds Option

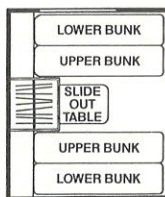

Rear Bunk  
Beds Option



Free-standing  
Dinette Option

# 295TB

**Two Bedroom**  
(Catalina)

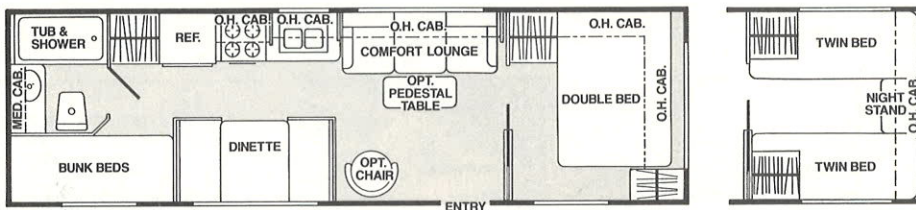

Front Twin  
Beds Option

# 330WB

**Walk Thru Bath**  
(Catalina & Prestige)

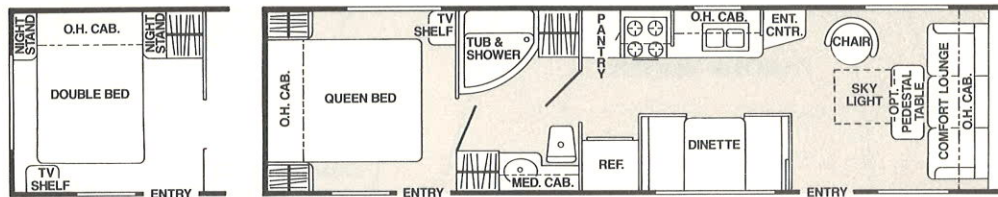

Rear Double  
Bed Option

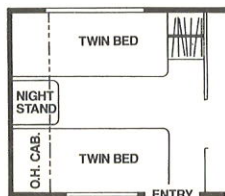

Rear Twin  
Beds Option



Free-standing  
Dinette Option

# COACHMEN TRAVEL TRAILERS

# FLOOR PLANS

## 330FS

**Front Slide-Out**  
(Catalina & Prestige)

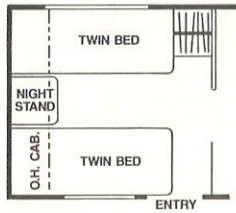

Rear Twin  
Beds Option

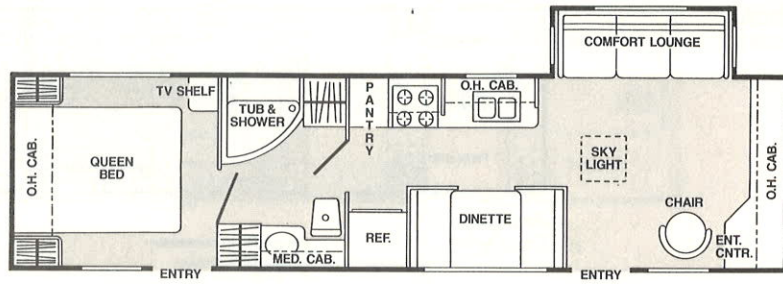

Free-standing  
Dinette Option

## 340FK

**Front Kitchen**  
(Catalina & Prestige)

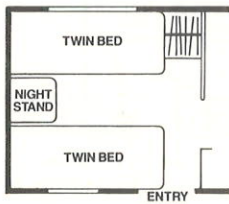

Rear Twin  
Beds Option

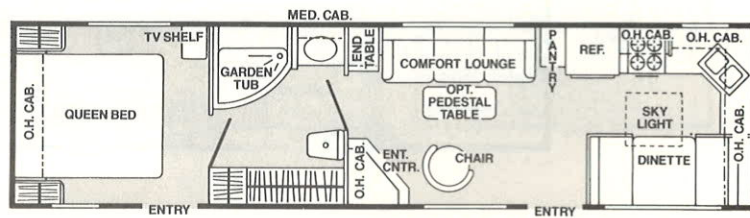

Free-standing  
Dinette Option



# CONSTRUCTION FEATURES

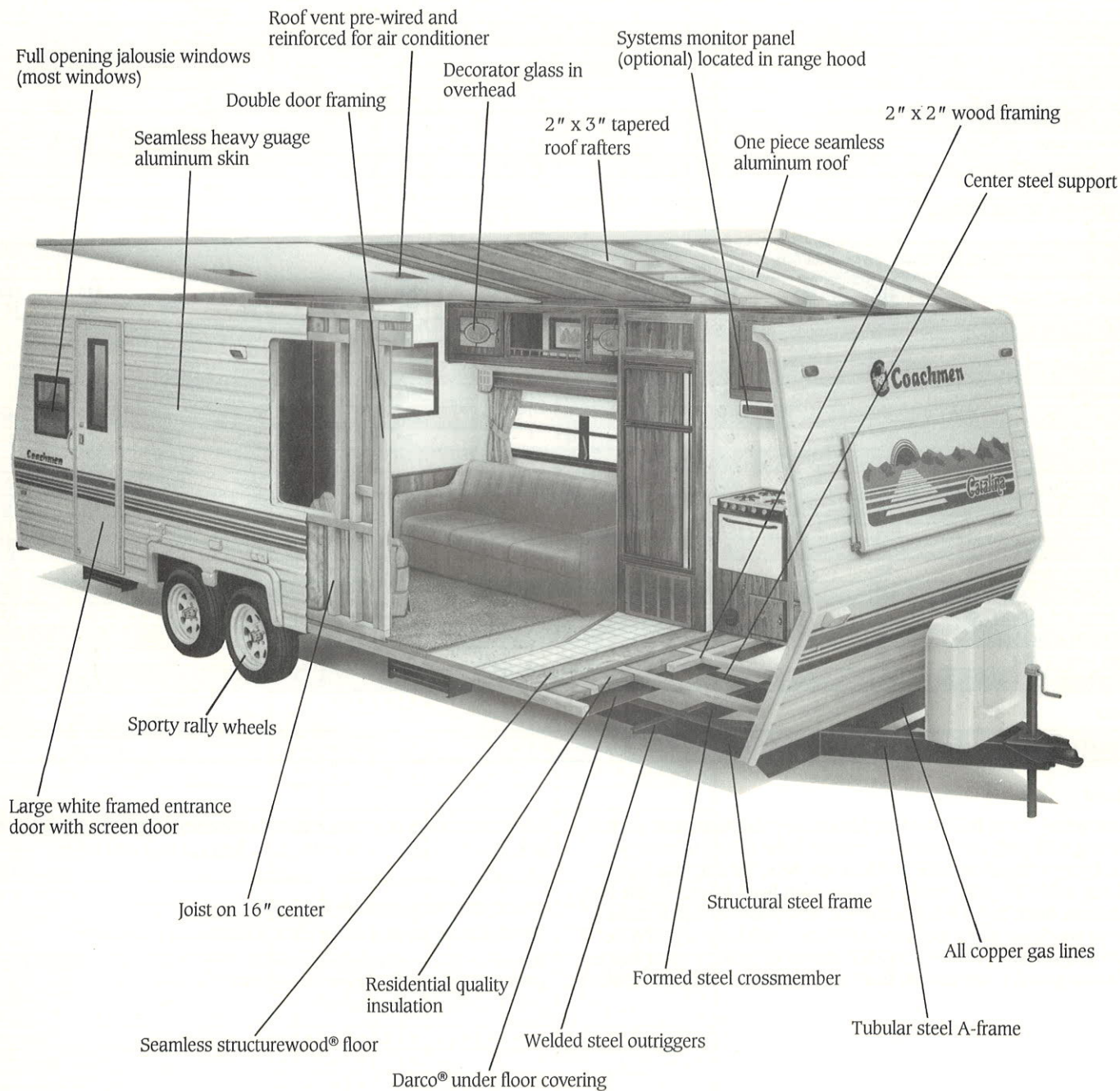

All Coachmen Travel Trailers are built with the same construction features including but not limited to full opening jalousie windows, double door framing, tubular steel framing, and crowned roof. Some features listed may not be standard on the Prestige. Contact your Coachmen dealer for details.

# COACHMEN TRAVEL TRAILERS SPECIFICATIONS & FEATURES

Prestige Travel Trailers	290 FK	290 WB	330 FS	330 WB	340 FK
GVWR	7220	7290	8040	7600	7600
Base weight	5021	5330	6498	5905	5872
Axle weight	4241	4480	5670	5145	5042
Hitch weight	780	850	1040	760	830
Carrying capacity	2199	1960	1542	1680	1728
Interior height	78"	78"	78"	78"	78"
Exterior height	107"	107"	107"	107"	107"
Exterior length	354"	357"	408"	408"	410"
Exterior width	93½"	93¼"	93½"	93½"	93½"
Hitch pin height	18"	17½"	18"	18"	18"
Sleeping capacity std.	6	6	6	6	6
Water system capacity (gal.)	54	54	54	54	54
Waste water tank capacity (gal.)	40	40	35	35	35
Gray water tank capacity (gal.)	30	30	30	30	30
Water heater capacity (gal.)	6	6	6	6	6
L.P. gas capacity (lb.)	60	60	60	69	60
Furnace rating (x 1,000 BTU) std.	30m	30m	30m	30m	30m
Tire size	□	□	H78-15 STC	H78-15 STC	H78-15 STC

NOTES: All specifications are approximate □=P225/75B15

Catalina Travel Trailer	210 MB	235 MB	250 TB	260 FK	265 RB	275 RB	290 WB	290 FK	295 TB	330 WB	330 FS	340 FK
GVWR	5940	6040	6510	6530	6440	6380	7360	7280	7120	7600	8040	7600
Base weight	3554	4050	4140	4570	4150	4380	5463	4796	5065	5312	6498	5555
Axle weight	3054	3450	3510	3920	3590	3880	4543	3956	4385	4652	5670	4755
Hitch weight	500	600	630	650	640	500	810	840	680	660	1040	800
Carrying capacity	2386	1990	2370	1960	2290	2000	2817	2484	2055	2288	1542	2045
Interior height	78"	78"	78"	78"	78"	78"	78"	78"	78"	78"	78"	78"
Exterior height	107"	107"	107"	107"	107"	107"	107"	107"	107"	107"	107"	107"
Exterior length	262"	296"	302"	314"	320"	330"	359"	354"	360"	408"	407"	410"
Exterior width	93½"	93½"	93½"	93½"	93½"	93½"	93½"	93½"	93½"	93½"	93½"	93½"
Hitch pin height	17½"	17½"	17½"	17½"	17½"	17½"	17½"	17½"	17½"	18"	18"	18"
Sleeping capacity std.	4	5	4	6	6	6	6	6	9	6	6	6
Water system capacity (gal.)	35	35	54	35	35	54	54	35	54	54	54	54
Waste water tank capacity (gal.)	30	25	40	40	40	40	40	40	40	35	35	35
Gray water tank capacity (gal.)	29	29	30	30	30	30	30	30	35	30	30	30
Water heater capacity (gal.)	6	6	6	6	6	6	6	6	6	6	6	6
L.P. gas capacity (lb.)	40	60	60	60	60	60	60	60	60	60	60	60
Furnace rating (x 1,000 BTU) std.	20m	20m	20m	24m	24m	24m	24m	24m	30m	30m	30m	30m
Tire size	●	●	■	■	■	■	□	□	□	H78-15 STC	H78-15 STC	□

NOTES: All specifications are approximate ●=P205/75B15 ■=P215/75B15 □=P225/75B15

## Options<sup>1</sup>

Deluxe velvet decor, free standing dinette, free standing chair, partial carpeting with pad, countertop extension, bake-n-broil microwave oven, larger refrigerator, wire and four speakers, TV antenna & rotor package, cable TV jack, smoke detector, twin beds, island double bed, bunk beds, bunk bed, LP bottle cover, safety glass windows, radius jalousie windows, larger roof air conditioner, bath liner, 6 gallon electronic ignition water heater, 10 gallon electronic ignition water heater, rear stone guard, spare tire kit, foam core insulation walls and roof,

interior convenience group, exterior convenience group, power hitch jack, stabilizer jacks, rear entry door, luggage rack and ladder.

<sup>1</sup>Not all options are available on all models.

Consult your Coachmen dealer for details.

Some optional equipment shown above is standard on the Prestige.

Some state laws require the installation of safety glass in Travel Trailers. Please contact your dealer for the current requirements in your state.

Catalina

Prestige

Items	Model	Catalina										Prestige						
		210 MB	235 MB	250 TB	260 FK	265 RB	275 RB	290 WB	290 FK	295 TB	330 FS	330 WB	340 FK	290 WB	290 FK	330 WB	330 FS	340 FK
<b>Interior &amp; Decor</b>																		
Hard valances		•	•	•	•	•	•	•	•	•	•	•	•	•	•	•	•	•
Lumbar-eze dinette													•	•	•	•	•	•
Wooden drawers with travel lock		•	•	•	•	•	•	•	•	•	•	•	•	•	•	•	•	•
LP Leak Alarm		•	•	•	•	•	•	•	•	•	•	•	•	•	•	•	•	•
Oak framed cabinet doors		•	•	•	•	•	•	•	•	•	•	•	•	•	•	•	•	•
Skylight													•	•	•	•	•	•
Cutting board		•	•	•	•	•	•	•	•	•	•	•	•	•	•	•	•	•
Easy care linoleum		•	•	•	•	•	•	•	•	•	•	•	•	•	•	•	•	•
Partial carpet with padding													•	•	•	•	•	•
Swivel rocker																•	•	•
Silverware drawer		•	•	•	•	•	•	•	•	•	•	•	•	•	•	•	•	•
<b>Galley</b>																		
4-burner almond range with cover		•	•	•	•	•	•	•	•	•	•	•	•	•	•	•	•	•
Black glass oven door													•	•	•	•	•	•
Lighted range hood		•	•	•	•	•	•	•	•	•	•	•	•	•	•	•	•	•
Double porcelain kitchen sink		•	•	•	•	•	•	•	•	•	•	•	•	•	•	•	•	•
Sprayer on kitchen sink													•	•	•	•	•	•
Single lever kitchen faucet													•	•	•	•	•	•
Smoke detector				•		•	•	•	•	•	•	•	•	•	•	•	•	•
Microwave ready		•	•	•	•	•	•	•	•	•	•	•	•	•	•	•	•	•
Flush mounted refrigerator													•	•	•	•	•	•
<b>Electrical</b>																		
110/12V power center 32 amp w/charger		•	•															
110/12V power center 45 amp w/charger				•	•	•	•	•	•	•	•	•	•	•	•	•	•	•
Patio light													•	•	•	•	•	•
Hitch light													•	•	•	•	•	•
Automatic wardrobe light													•	•	•	•	•	•
Trunk light													•	•	•	•	•	•
30 ft. power cord in locking comp.		•	•	•	•	•	•	•	•	•	•	•	•	•	•	•	•	•
Decorator wall light													•	•	•	•	•	•
Ground fault interrupter		•	•	•	•	•	•	•	•	•	•	•	•	•	•	•	•	•
<b>Bath &amp; Water System</b>																		
Single pedal toilet		•	•	•	•	•	•	•	•	•	•	•						
Double pedal toilet													•	•	•	•	•	•
Bath liner													•	•	•	•	•	•
Shower curtain		•	•	•	•	•	•	•	•	•	•	•	•	•	•	•	•	•
Electronic ignition water heater													•	•	•	•	•	•
Wall switch in bathroom		•	•	•	•	•	•	•	•	•	•	•	•	•	•	•	•	•
Decorative bath hardware		•	•	•	•	•	•	•	•	•	•	•	•	•	•	•	•	•
<b>Sleeping</b>																		
Rear corner double bed		•																
Rear double bed			•		•				•						•			
Rear bunk bed				•						•								
Rear queen bed						•				•	•	•	•		•	•	•	•
Front double bed				•		•				•								
Mid twin beds					•													
Front jack-knife sofa													•		•			
Comfort lounge					•	•	•	•	•	•	•	•						
Side jack-knife sofa															•		•	•
Bedsread(s)		•	•	•	•	•	•	•	•	•	•	•	•	•	•	•	•	•
Headboard(s)		•	•	•	•	•	•	•	•	•	•	•	•	•	•	•	•	•
Privacy drape bedroom		•	•	•	•				•	•								
Innerspring mattress		•	•	•	•	•	•	•	•	•	•	•	•	•	•	•	•	•
Fold down dinette		•	•	•	•	•	•	•	•	•	•	•	•	•	•	•	•	•

Standard features found in Prestige & Catalina Travel Trailers.

Wall mounted thermostats
Residential quality cabinet fronts
Decorator glass overhead cabinet doors
Cutting board in sink
Durable laminated counter top
Fold-down dinette table
Luxurious quilted-cover innerspring mattress (except bunks)
Wire & frame for roof air
Automotive clearance lights
12-volt demand pump
Locking fresh city water fill compartment
Freeze resistant plumbing
Electric brakes
Rally wheels
Slide out step (double in front of Prestige)
Awning rail
Colonial white exterior
Screen door
Fiberglass insulation
T-bar door restraint
Locking exterior storage
Large jalousie windows
Structurewood® floor
2" x 3" tapered roof rafters
Flush entry door handles
All copper gas lines
Electronic ignition furnace

# COACHMEN FIFTH WHEELS FLOOR PLANS

**235RK**

**Rear Kitchen**  
(Catalina)

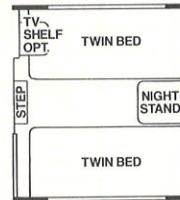
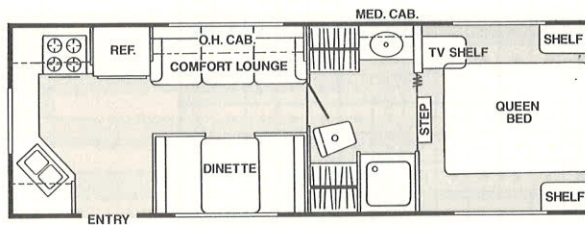

Front Twin  
Beds Option



Executive Lounge Option

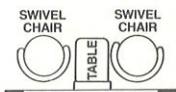

**250RB**

**Rear Bath**  
(Catalina)

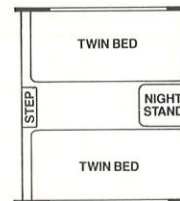
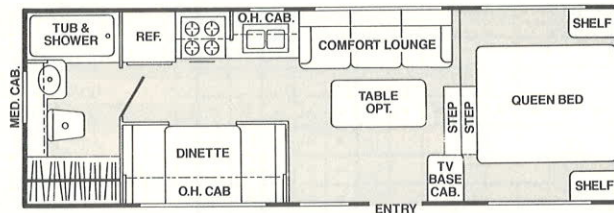

Front Twin  
Beds Option

**260WB**

**Walk Thru Bath**  
(Catalina)

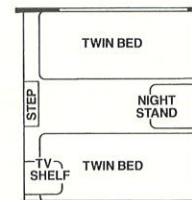
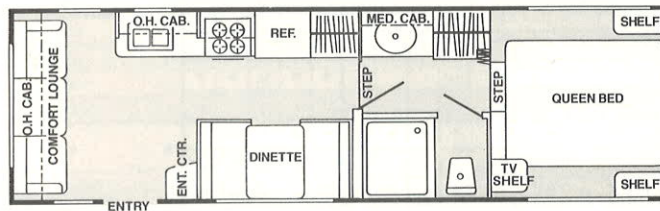

Front Twin  
Beds Option

**275RK**

**Rear Kitchen**  
(Catalina)

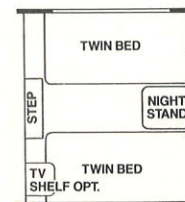
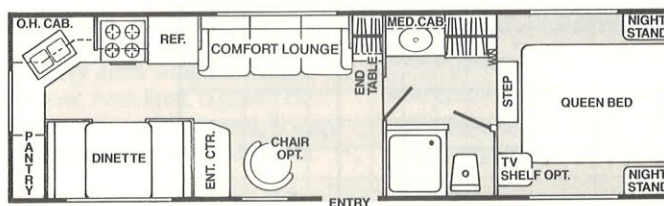

Front Twin  
Beds Option

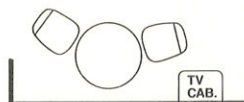

Free-standing  
Dinette Option



# 290WB

Walk Thru Bath  
(Catalina)

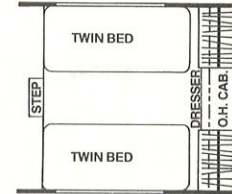
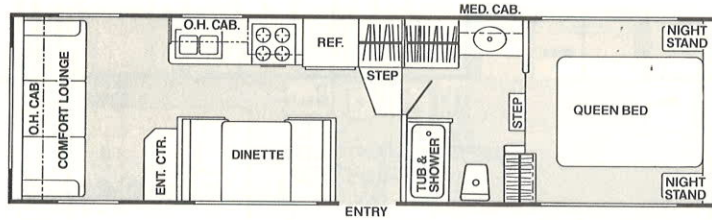

Front Twin Beds Option

# 295RS

Rear Slide-Out  
(Catalina & Prestige)

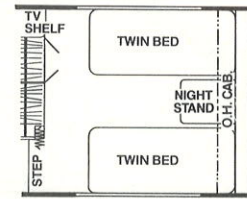
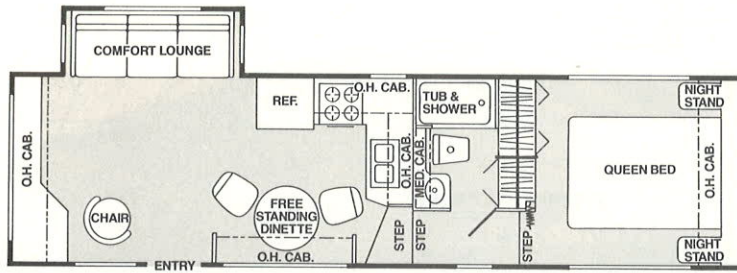

Front Twin Beds Option

# 295SI

Slide Aisle  
(Catalina & Prestige)

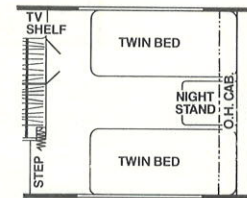
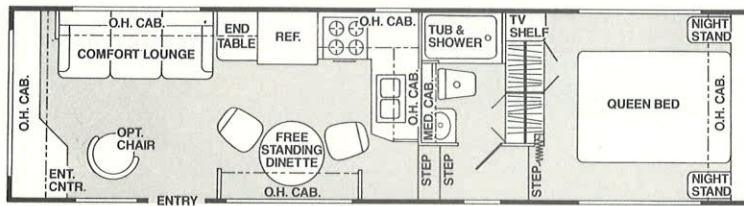

Front Twin Beds Option

# 320MB

Mid Bath  
(Catalina & Prestige)

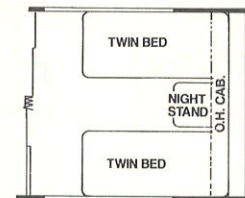
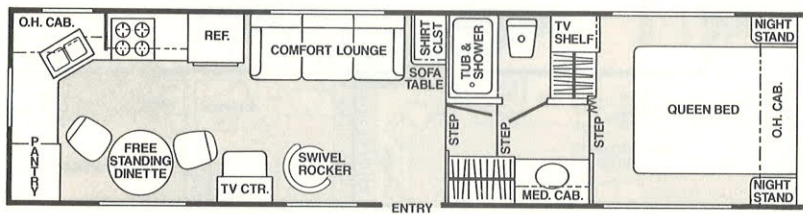

Front Twin Beds Option



Dinette Option

# COACHMEN FIFTH WHEELS

## FLOOR PLANS

**320MS**

**Mid Slide-Out**  
(Prestige)

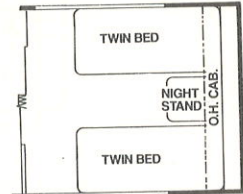
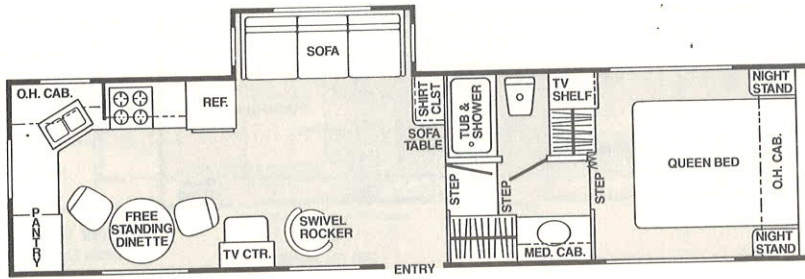

Front Twin  
Beds Option

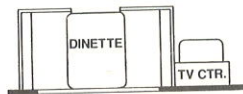

Dinette Option

**360MS**

**Mid Slide-Out**  
(Prestige)

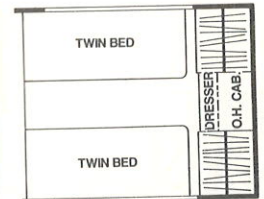
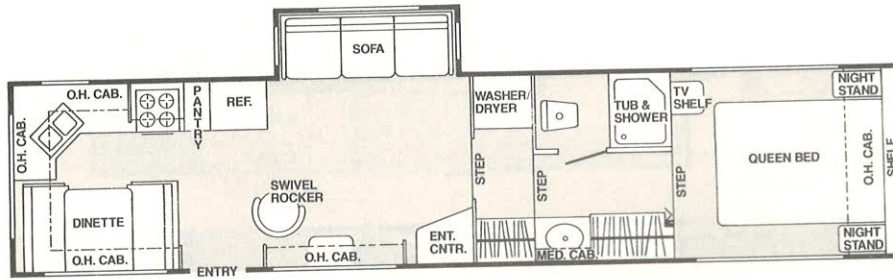

Front Twin  
Beds Option

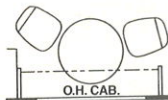

Free-standing  
Dinette Option

**360RS**

**Rear Slide-Out**  
(Prestige)

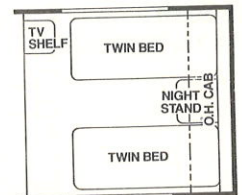
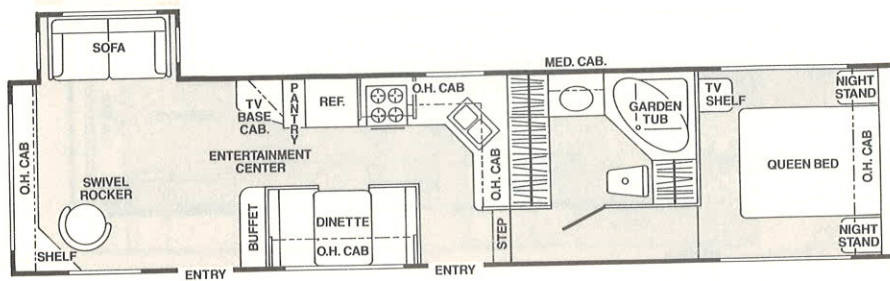

Front Twin  
Beds Option

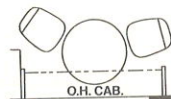

Free-standing  
Dinette Option



# CONSTRUCTION FEATURES

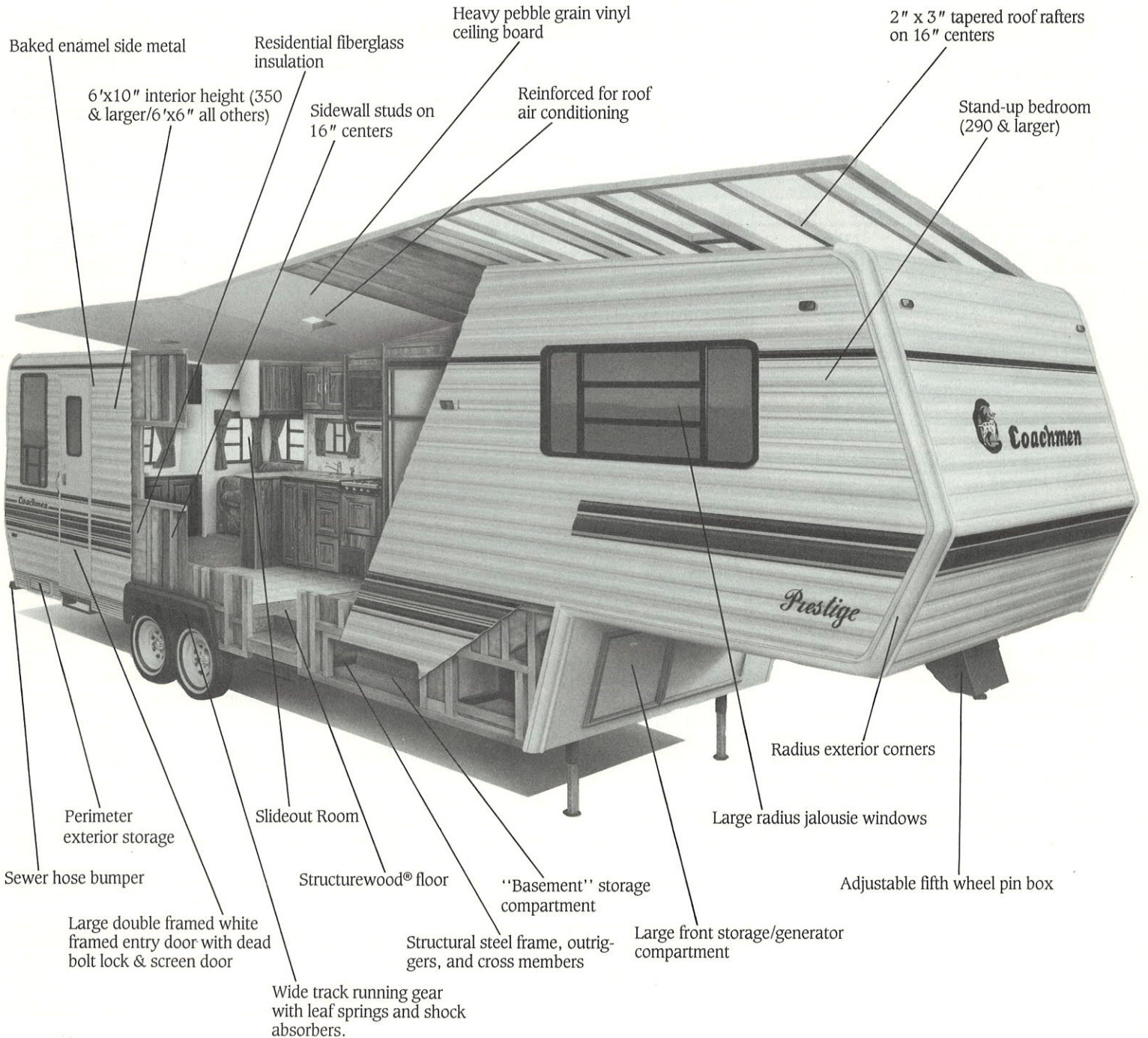

All Coachmen Fifth Wheels are built with the same construction features including but not limited to structured steel frame, double frame entry door, radius jalousie windows, and crowned roof. Some features listed above may be optional on the Catalina. Contact your Coachmen dealer.

# COACHMEN FIFTH WHEELS SPECIFICATIONS & FEATURES

Prestige Fifth Wheel	295 RS	295 SI	320 MS	320 MB	360 RS	360 MS
GVWR	11,320	11,400	NA	NA	NA	NA
Base weight	7895	7,590	NA	NA	NA	9282
Axle weight	6575	6190	NA	NA	NA	7542
Hitch weight	1320	1400	NA	NA	NA	1740
Carrying capacity	3425	3810	NA	NA	NA	1938
Interior height	80"/72"	80"/72"	80"/72"	80"/72"	80"/72"	80"/72"
Exterior height	138"	138"	138"	138"	80"/72"	80"/72"
Exterior length	359"	359"	394"	394"	442"	437"
Exterior width	94" †	94"	94"	94" †	94" †	94" †
Sleeping capacity std.	4	4	4	4	6	6
Water system capacity (gal.)	56	56	56	56	56	56
Waste water tank capacity (gal.)	40	40	40	40	40	40
Gray water tank capacity (gal.)	40	40	40	40	40	40
Water heater capacity (gal.)	6	6	6	6	6	6
L.P. gas capacity (lb.)	60	60	60	60	60	60
Furnace rating (x 1,000 BTU) std.	30m	30m	34m	34m	40m	40m
Tire size	•	•	○	○	○	○

NOTES: All specifications are approximate. NA=Not Available at time of printing. †=Without Slideout •=225/75R15C ○=225/75R15D

Catalina Fifth Wheel	235 RK	250 RB	275 RK	260 WB	290 WB	295 RS	295 SI	320 MB
GVWR	6330	6440	7630	8060	NA	9460	9540	NA
Base weight	4893	4821	4677	5185	NA	7855	7540	NA
Axle weight	4003	3821	4090	4125	NA	6535	6140	NA
Hitch weight	890	1000	630	1060	NA	1320	1400	NA
Carrying capacity	1437	1619	2953	2875	NA	1605	2000	NA
Interior height	78"/50"	78"/50"	78"/50"	78"/50"	89"/72"	80"/72"	80"/72"	78"/72"
Exterior height	117"	117"	117"	117"	134"	136"	136"	136"
Exterior length	301"	306"	NA	325"	359"	359"	359"	394"
Exterior width	94"	94"	94"	94"	94"	94"	94"	94"
Sleeping capacity std.	4	6	6	6	6	4	4	4
Water system capacity (gal.)	54	54	54	54	54	54	54	54
Waste water tank capacity (gal.)	40	40	40	40	40	40	40	40
Gray water tank capacity (gal.)	40	40	40	40	40	40	40	40
Water heater capacity (gal.)	6	6	6	6	6	6	6	6
L.P. gas capacity (lb.)	60	60	60	60	60	60	60	60
Furnace rating (x 1,000 BTU) std.	24m	24m	30m	30m	30m	30m	30m	34m
Tire size	†	†		H78-15 STC	H78-15 STC	H78-15 STC	H78-15 STC	H78-15 STC

NOTES: All specifications are approximate NA=Not Available at time of printing †=P205/75B15

## Options<sup>1</sup>

Side dinette, pedestal table, free-standing chair, living room carpet w/pad, ottoman, swivel rocker, deluxe velvet decor, bak n broil microwave oven, larger refrigerator, wire and 4-speakers, AM/FM cassette with 4 speakers, TV antenna package, cable TV jack, smoke detector, combination washer/dryer, twin beds, generator ready, 4.0 generator, 6.5 generator, safety glass windows, radius jalousie windows, roof air conditioners, heat strip for roof air, wire and frame for roof air conditioners, tinted glass, bath liner, 6 gallon electronic ignition water heater, 10 gallon electronic ignition water heater, spare tire kit, foam

core insulation roof/walls, luggage rack and ladder, interior convenience group, exterior convenience group, electronic jacks, retractable stabilizer jacks.

<sup>1</sup>Not all options are available on all models.

Some optional equipment shown above is standard on the Prestige.

See your Coachmen dealer for details.

Some state laws require the installation of safety glass in Fifth Wheels. Please contact your dealer for the current requirements in your state.

Catalina

Prestige

Items	Model	Catalina										Prestige			
		235 RK	250 RB	260 WB	275 RK	290 WB	295 RS	295 SJ	320 MB	295 SJ	295 RS	320 MS	320 MB	360 RS	360 MS
<b>Interior &amp; Decor</b>															
Hard valances		•	•	•	•	•	•	•	•	•	•	•	•	•	•
Skylight											•	•	•	•	•
Cedar lined wardrobe											•	•	•	•	•
Silverware drawer		•	•	•	•	•	•	•	•	•	•	•	•	•	•
Cutting board in sink		•	•	•	•	•	•	•	•	•	•	•	•	•	•
Lumbar-eze dinette											•	•	•	•	•
Tufted 5" cushions		•	•	•	•	•	•	•	•	•	•	•	•	•	•
Heated holding tank under floor											•	•	•	•	•
Partial carpet w/pad		•	•	•	•	•	•	•	•	•	•	•	•	•	•
Basement storage											•	•	•	•	•
Oak framed cabinet doors		•	•	•	•	•	•	•	•	•	•	•	•	•	•
Wood drawer with travel lock		•	•	•	•	•	•	•	•	•	•	•	•	•	•
<b>Galley</b>															
Porcelain sink		•	•	•	•	•	•	•	•	•	•	•	•	•	•
Sprayer in kitchen sink											•	•	•	•	•
4-burner range with oven		•	•	•	•	•	•	•	•	•	•	•	•	•	•
Black glass oven door											•	•	•	•	•
Range top cover											•	•	•	•	•
Wastebasket on door											•	•	•	•	•
Power lighted range hood											•	•	•	•	•
Microwave ready		•	•	•	•	•	•	•	•	•	•	•	•	•	•
Single lever faucet											•	•	•	•	•
Flush mount refrigerator											•	•	•	•	•
Free-standing dinette-wood											•	•	•	•	•
<b>Sleeping</b>															
Bed lift system (queen beds)		•	•	•	•	•	•	•	•	•	•	•	•	•	•
Front queen bed		•	•	•	•	•	•	•	•	•	•	•	•	•	•
Innerspring mattress		•	•	•	•	•	•	•	•	•	•	•	•	•	•
Bedspread(s)		•	•	•	•	•	•	•	•	•	•	•	•	•	•
Headboard(s)											•	•	•	•	•
Comfort lounge		•	•	•	•	•	•	•	•	•					
Side jack-knife sofa											•	•	•	•	•
Fold down dinette table		•	•	•	•	•	•	•	•	•					
Bifold door-bedroom area		•	•	•	•	•	•	•	•	•	•	•	•	•	•
Shades		•	•	•	•	•	•	•	•	•					
Stand up bedroom											•	•	•	•	•
<b>Electrical</b>															
110/12V power center 45 amp w/charger			•	•	•	•	•	•	•	•	•	•	•	•	•
Patio light											•	•	•	•	•
LP light											•	•	•	•	•
LP Leak Detector		•	•	•	•	•	•	•	•	•	•	•	•	•	•
30' power cord in locking compartment		•	•	•	•	•	•	•	•	•	•	•	•	•	•
Ground fault interrupter		•	•	•	•	•	•	•	•	•	•	•	•	•	•
Decorator wall-lights											•	•	•	•	•
Composite taillights											•	•	•	•	•
Wire reinforced for roof air		•	•	•	•	•	•	•	•	•	•	•	•	•	•
<b>Bath &amp; Water Systems</b>															
Brass-like 4-bulb make-up mirror											•	•	•	•	•
Power bath vent											•	•	•	•	•
Wall switch in bathroom		•	•	•	•	•	•	•	•	•	•	•	•	•	•
Single pedal toilet		•	•	•	•	•	•	•	•	•					
Double pedal toilet											•	•	•	•	•
Electronic ignition water heater											•	•	•	•	•

Standard features found in both Prestige and Catalina Fifth Wheels.

- Wall mounted thermostats
- Residential quality cabinet fronts
- Decorator glass overhead cabinet doors
- Cutting board in sink
- Durable laminated counter top
- Fold-down dinette table
- Wire & frame for roof air
- Automotive clearance lights
- 12-volt demand pump
- Locking fresh/city waterfill compartment
- Freeze resistant plumbing
- Electric brakes
- Rally wheels
- Slide-out steps
- Awning rail
- Colonial white exterior
- Screen door
- Fiberglass insulation
- T-bar door restraint
- One-piece aluminum roof (Catalina)
- Rubber Roof (Prestige)
- Large jalousie windows
- Structurewood® floor
- 2" x 4" tapered roof rafters (Prestige)
- All copper gas lines
- Side mounted LP compartment

# Coachmen. We're here for the long haul.

At Coachmen, we've been building the highest-quality RV's for more than 25 years. Building an RV company that's become a leader in the industry. While year after year other RV makers have fallen by the wayside.

As a dynamic company with strong financial resources and stability, Coachmen offers you quality and services you can't find anywhere else.

While other companies man-

ufacture a partial line of RV's, Coachmen has the most complete line in the industry — including luxurious Class A's, sleek and affordable Class C motorhomes, fifth wheels with slide-out rooms, spacious travel trailers, basement truck campers and sporty camping trailers.

You can see Coachmen's financial strength in our wide network of dealers all over the United States.

So when you head into the great unknown, you have the comfort of knowing we're there. And you can experience Coachmen's leadership with the International Coachmen Caravan Club for fun and fellowship, personalized trip planning and discounts at participating campgrounds.

Take a look at the full line of Coachmen RV's at your dealer soon. The long road ahead looks beautiful.



  
**Coachmen**  
Recreational Vehicle Company  
P.O. Box 30, Middlebury, Indiana 46540

© 1990 Coachmen Recreational Vehicle Company

Your Coachmen dealer is . . .

**JERRY'S TRAILERS & CAMPERS**  
2601 S. 13th St.  
Norfolk, NE 68701